

F.A.P. RTE.	SECTION	COUNTY	TOTAL SHEET SHEETS NO.
704	(1N & TS-1	McLEAN	497 174
STA. 0+275.000 TO STA. 0+408.500		ILLINOIS FED. AID PROJECT	
FED. ROAD DIST. NO.		CONTRACT NO. 70514	

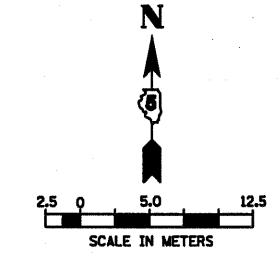

LEGEND:
 (TB 3.2) TRENCH BACKFILL QUANTITY (CUBIC METERS)

DATE	BY

FINAL SURVEYED BY DATE
 SURVEY PLOTTED BY DATE
 NOTE BOOK TEMPLATE NO.
 TRENCH AREAS CHECKED
 NO.

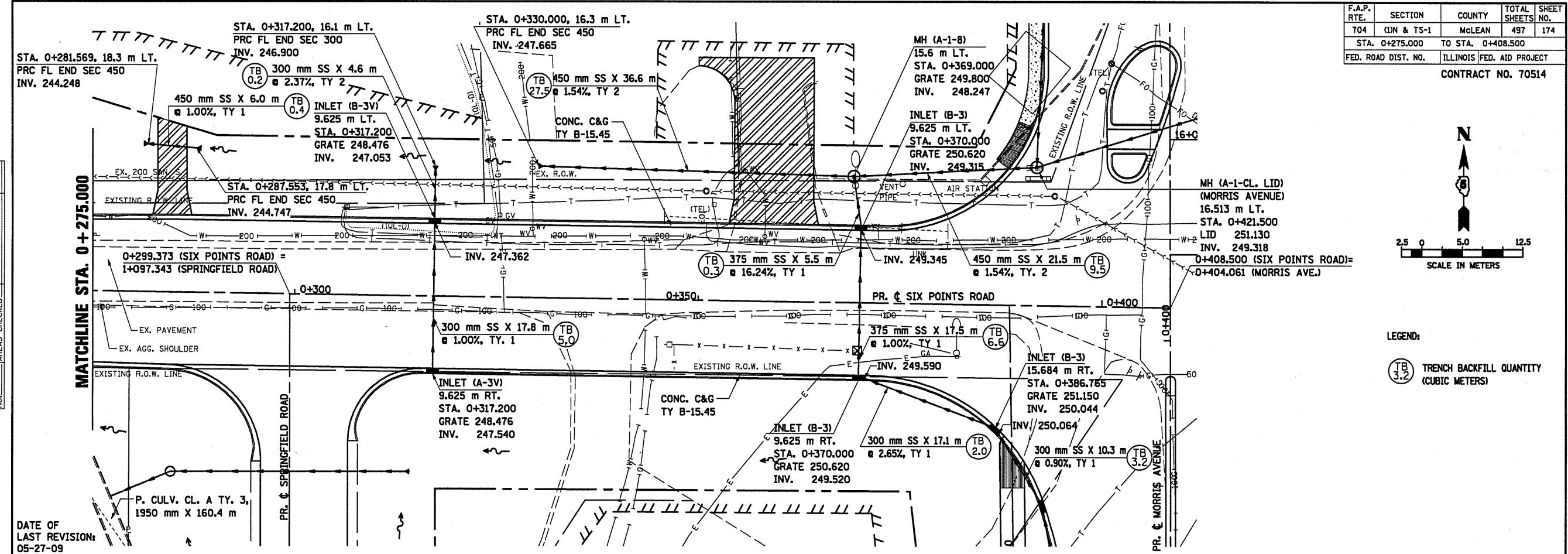

DATE OF LAST REVISION: 05-27-09

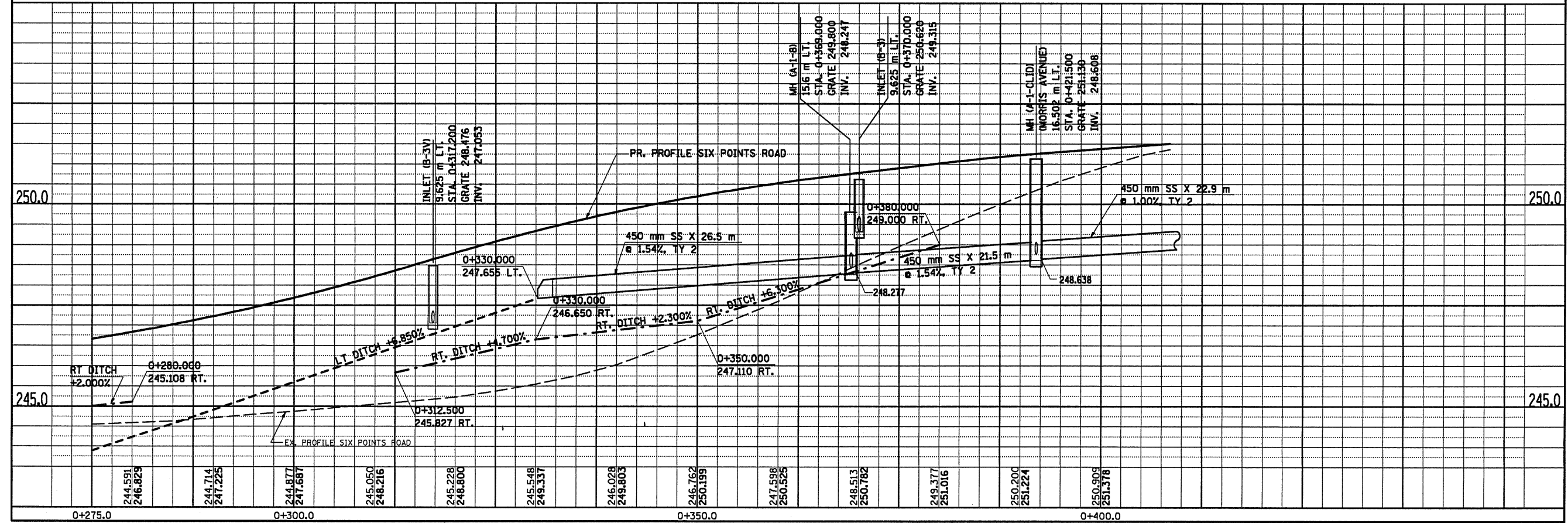

REVISOR'S MARK: A REVISED SHEET 10/25/10