

BENCHMARKS			
MARK	STATION/OFFSET	ELEVATION	DESCRIPTION
BM #TA4	± 556+98.7, 17.6' RT	498.80	CHISELED "□" " SOUTHWEST WINGWALL OF SN 085-0016
BM #TA5	± 561+83.2, 17.7' LT	496.97	CHISELED "□" " NORTHEAST WINGWALL OF SN 085+0016

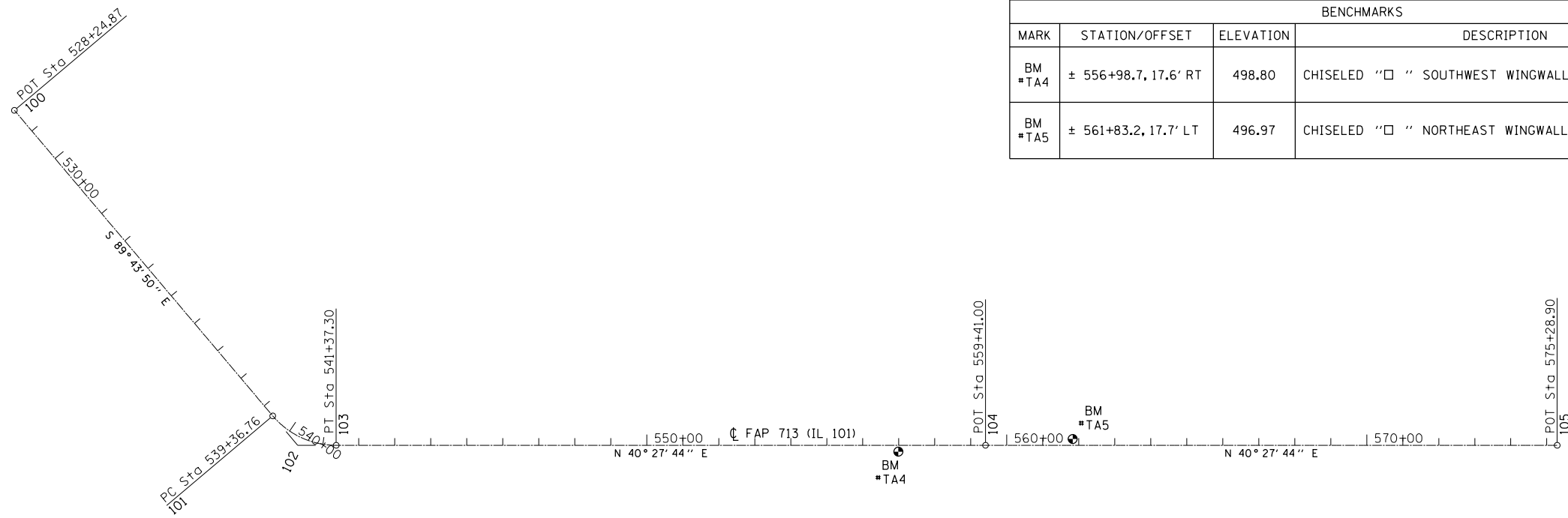

EXIST. CURVE 215  
 102 P.I. STA. = 540+43.86  
 $\Delta = 49^\circ 48' 26''$  (LT)  
 $D = 24^\circ 50' 13''$   
 $R = 230.69'$   
 $T = 107.10'$   
 $L = 200.54'$   
 $E = 23.65'$   
 101 P.C. STA. = 539+36.76  
 103 P.T. STA. = 541+37.30

CONTROL POINTS		
POINT	NORTHING	EASTING
100	1,296,677.5609	2,128,652.0624
101	1,296,672.3310	2,129,763.9386
102	1,296,671.8272	2,129,871.0374
103	1,296,753.3126	2,129,940.5395
104	1,298,125.6297	2,121,111.0434
105	1,299,333.7588	2,132,141.5048

