

STATE OF ILLINOIS  
DEPARTMENT OF TRANSPORTATION

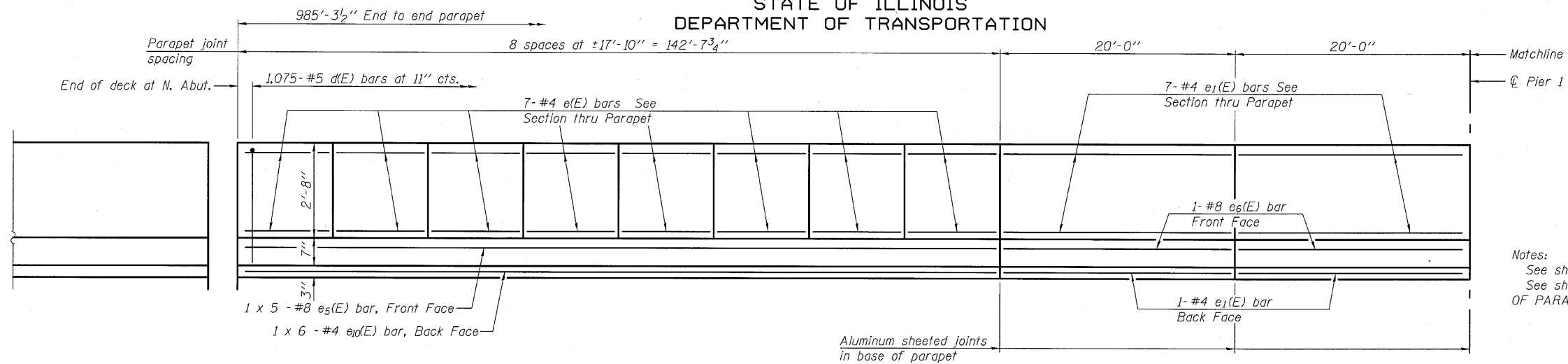

INSIDE ELEVATION OF PARAPET - SPAN 1

**MINIMUM BAR LAP**

(Parapet)  
#4 bar = 2'-0"  
#8 bar = 5'-2"

Notes:  
See sheet 18 of 48 for parapet joint details.  
See sheet 18 of 48 for "INSIDE ELEVATION OF PARAPET - SPAN 4".

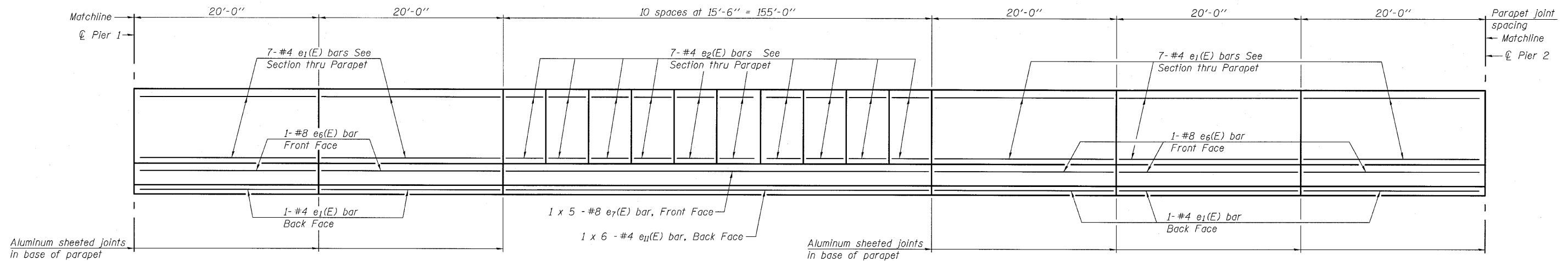

INSIDE ELEVATION OF PARAPET - SPAN 2

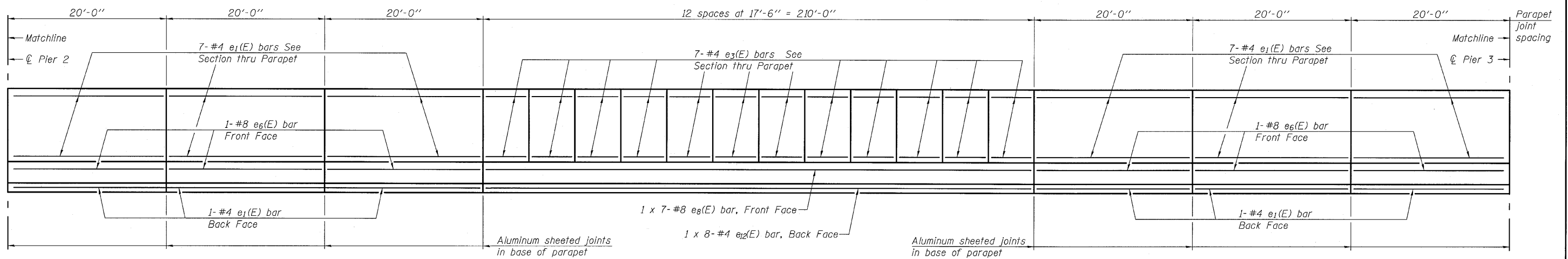

INSIDE ELEVATION OF PARAPET - SPAN 3

**SUPERSTRUCTURE DETAILS**  
**STRUCTURE NO. 082-0038**

DESIGNED	JJD
CHECKED	EML
DRAWN	AJF
CHECKED	JJD

**HORNER & SHIFRIN, INC.**  
ENGINEERS

SHEET NO. 17 48 SHEETS	F.A.P. RTE.	SECTION	COUNTY	TOTAL SHEETS	SHEET NO.
	312	64-1VBR	ST. CLAIR	259	69
CONTRACT NO. 76882					
ILLINOIS FED. AID PROJECT					