

STATE OF ILLINOIS
DEPARTMENT OF TRANSPORTATION

Waterproofing Membrane, cost included with Concrete Structures. Refer to Overall Plan General Notes, Sheet 2

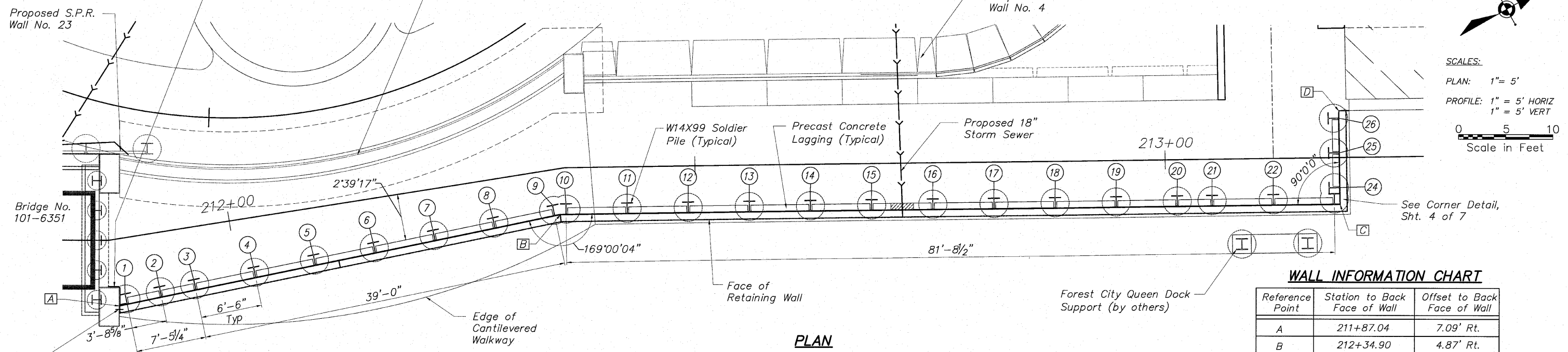

SCALES:
PLAN: 1" = 5'
PROFILE: 1" = 5' HORIZ
1" = 5' VERT

0 5 10
Scale in Feet

WALL INFORMATION CHART

Reference Point	Station to Back Face of Wall	Offset to Back Face of Wall
A	211+87.04	7.09' Rt.
B	212+34.90	4.87' Rt.
C	213+18.55	5.00' Rt.
D	213+18.55	5.00' Lt.

PLAN

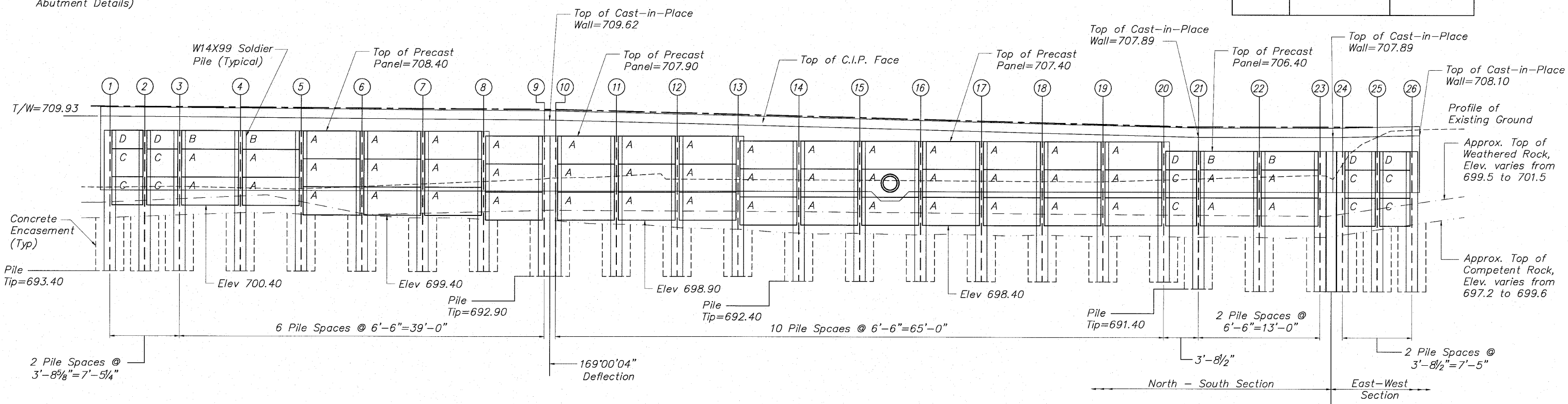

ELEVATION (Showing Precast Panels)
(Looking @ Front Face of Wall)

PRECAST PANEL SCHEDULE

PANEL	NOMINAL SIZE	No.	Sq. Ft. PANELS
A	3' x 6'	50	900
B	2' x 6'	4	48
C	3' x 3'-3"	10	97.5
D	2' x 3'-3"	5	32.5
Total			1078

SP WALL No. 24 DETAILS
PLAN AND PRECAST ELEVATION
PEDESTRIAN RIVERWALK
ALONG THE ROCK RIVER
WINNEBAGO COUNTY
SECTION NO. 06-00543-00-BT
STATION 211+87.04 TO
STATION 213+18.55

DESIGNED	CTB
CHECKED	AAG
DRAWN	JAW
CHECKED	JWH

McClure
Engineering Associates, Inc.
2282 Argus Drive
Rockford, Illinois 61107-5837
(815) 399-2332 Fax (815) 399-2456
Design Firm License: Illinois #184-000816
Copyright 2009 By McClure Engineering Associates, Inc.

SHEET NO. 2
7 SHEETS

F.A. RTE.	SECTION	COUNTY	TOTAL SHEETS	SHEET NO.
	06-00543-00-BT	WINNEBAGO	148	100
FED. ROAD DIST. NO.	ILLINOIS	FED. AID PROJECT	CONTRACT NO. 85521	

H:\08-008 RIVERWALK MUSEUM\DESIGN\DRAWINGS\STRUCTURAL\GP&E\08-008 SP-WALL 24.rvt DET-24 (1) 8/30/2010 4:35:19 PM 11, JWH