

STATE OF ILLINOIS  
DEPARTMENT OF TRANSPORTATION  
DIVISION OF HIGHWAYS

**PROPOSED  
LOCAL AGENCY IMPROVEMENT  
SAFE ROUTES TO SCHOOL PROGRAM  
VILLAGE OF DIAMOND  
VARIOUS LOCATIONS  
SECTION 10-00005-00-SW  
PROJECT SRTS-4009 (075)  
JOB NO. C-40-057-09  
INSTALL SIDEWALKS**



**INDEX OF SHEETS**

- 1 COVER SHEET
- 2 DETAILS AND QUANTITIES
- 3 SCHEDULE OF QUANTITIES
- 4 DIVISION STREET (IL. RTE. 113)
- 5 DAISY PLACE WEST
- 6-7 DAISY PLACE EAST
- 8 MAPLE STREET
- 9 SPRING ROAD
- 10-11 BERTA ROAD
- 12 McGINTY STREET
- 13 HOLCOMB STREET
- 14-15 RATHBURN STREET

**STANDARDS**

- 000001-05 STANDARD SYMBOLS, ABBREVIATIONS, & PATTERNS
- 424001-05 CURB RAMPS FOR SIDEWALKS
- 701001-02 OFF-ROAD OPERATIONS, 2L, 2W, MORE THAN 4.5m (15') AWAY
- 701006-03 OFF-ROAD OPERATIONS, 2L, 2W, 4.5m (15') TO 600mm FROM PAVEMENT EDGE
- 701301-03 LANE CLOSURE, 2L, 2W, SHORT TIME OPERATIONS
- 701501-05 URBAN LANE CLOSURE, 2L, 2W, UNDIVIDED
- 701801-04 LANE CLOSURE, MULTILANE 1W OR 2W CROSSWALK OR SIDEWALK CLOSURE
- 701901-01 TRAFFIC CONTROL DEVICES

**DESIGN GUIDELINES**

BUREAU OF LOCAL ROADS AND STREETS MANUAL

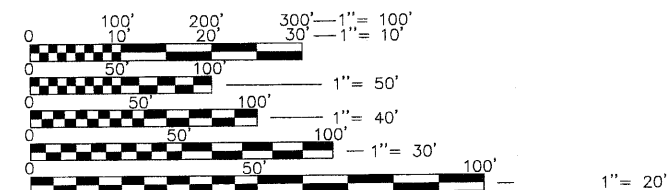

FULL SIZE PLANS HAVE BEEN PREPARED USING STANDARD ENGINEERING SCALES. REDUCED SIZED PLANS WILL NOT CONFORM TO STANDARD SCALES. IN MAKING MEASUREMENTS ON REDUCED PLANS, THE ABOVE SCALES MAY BE USED.

J.U.L.I.E.  
JOINT UTILITY LOCATION INFORMATION FOR EXCAVATION  
1-800-892-0123  
OR 811

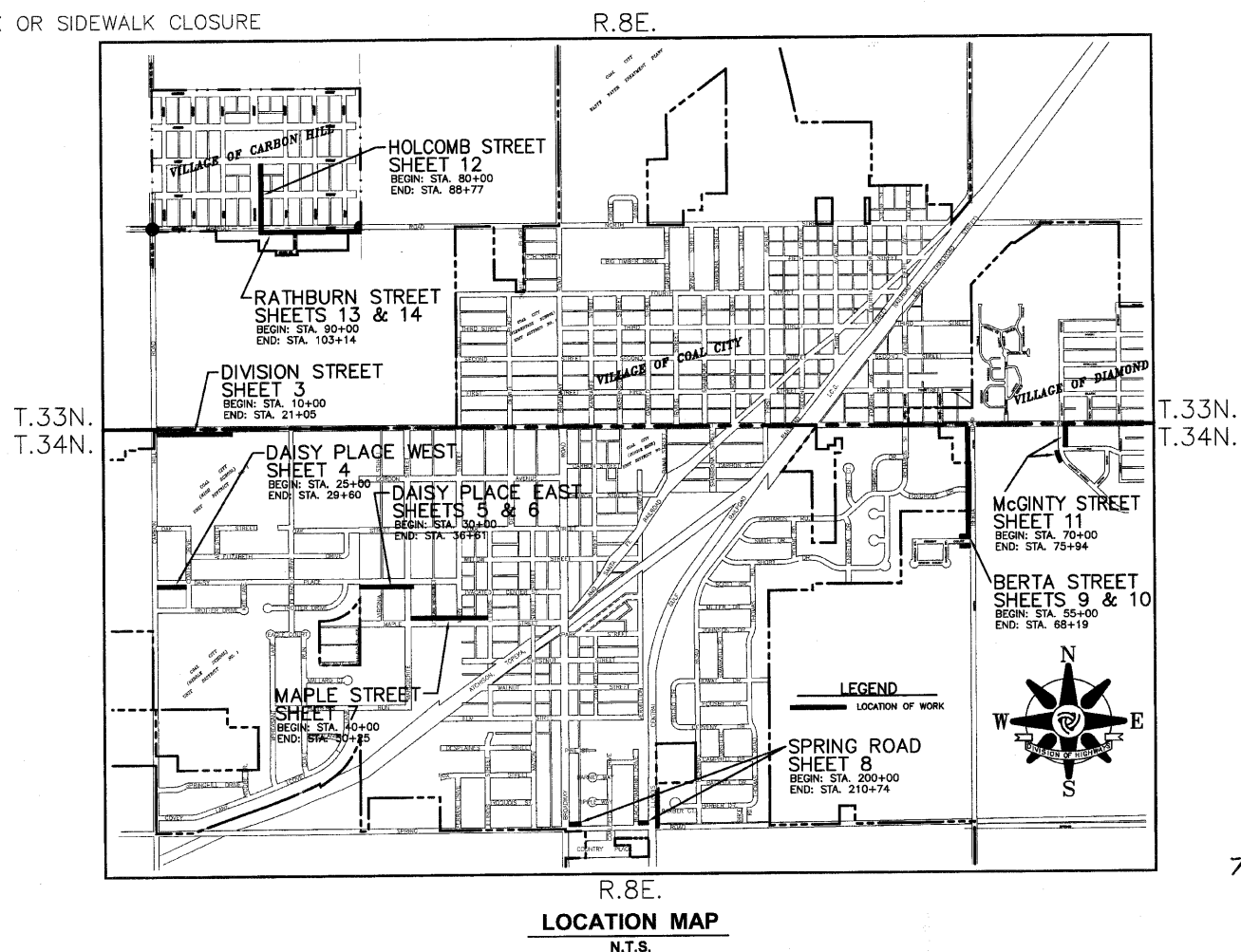

**LOCATION MAP**  
N.T.S.  
GROSS LENGTH OF IMPROVEMENT: 8,266 FT.  
NET LENGTH OF IMPROVEMENT: 7,356 FT.

STATE OF ILLINOIS  
DEPARTMENT OF TRANSPORTATION  
DIVISION OF HIGHWAYS

APPROVED Aug. 26, 2019  
*[Signature]*  
PRESIDENT, VILLAGE OF DIAMOND

PASSED \_\_\_\_\_ 20\_\_\_\_\_  
*[Signature]*  
DISTRICT 3 IMPLEMENTATION ENGINEER

RELEASED FOR BID \_\_\_\_\_ 20\_\_\_\_\_  
ON LIMITED REVIEW *[Signature]*  
DEPUTY DIRECTOR OF HIGHWAYS, REGION 2 ENGINEER

PRINTED BY THE AUTHORITY OF  
OF THE STATE OF ILLINOIS



CONTRACT NO. 87458

**GENERAL NOTES**

FOR STABILIZATION, ALL TYPE III BARRICADES SHALL REQUIRE A MINIMUM OF FOUR SAND BAGS PER LEG.  
 ANY REFERENCE TO A STANDARD IN THESE PLANS SHALL BE INTERPRETED TO MEAN THE EDITION AS INDICATED BY THE SUBNUMBER SHOWN IN THE LIST OF STANDARDS INCLUDED IN THESE PLANS.

MEMBERS OF J.U.L.I.E. KNOWN TO BE WITHIN THE LIMITS OF THE IMPROVEMENT ARE:  
 A.T.&T. (SBC)  
 COM ED  
 NICOR GAS  
 COMCAST  
 DIAMOND WATER & SEWER DEPARTMENT  
 COAL CITY WATER & SEWER DEPARTMENT  
 CARBON HILL WATER & SEWER DEPARTMENT

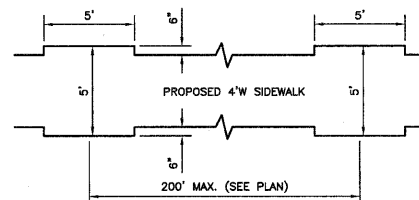

**ACCESSIBLE PASSING AREA DETAIL**

N.T.S.

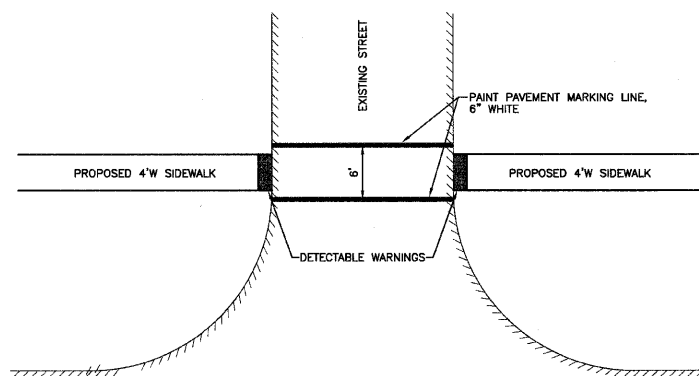

**LOW VOLUME CROSSWALK DETAIL**

N.T.S.

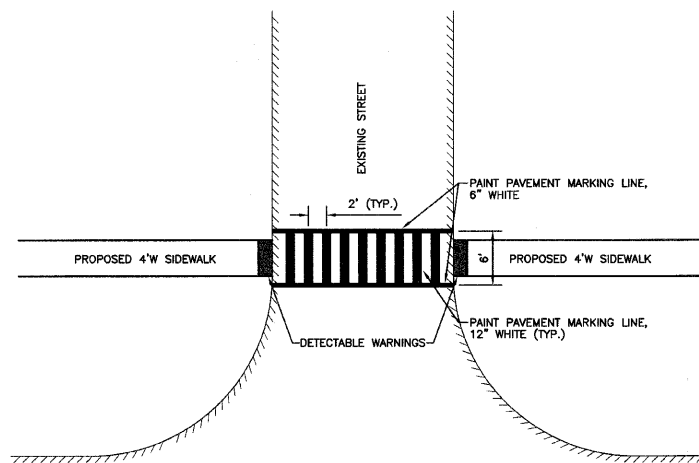

**HIGH VOLUME CROSSWALK DETAIL**

N.T.S.

**SUMMARY OF QUANTITIES**

| PAY ITEM NUMBER | PAY ITEM  | UNIT   | QUANTITY | CONST. TYPE CODE |        |
|-----------------|---|--------|----------|------------------|--------|
|                 |   |        |          | SFTY-1B          |        |
| 20200100        | EARTH EXCAVATION                                | CU.YD. | 1,125    |                  | 1,125  |
| 35102000        | AGGREGATE BASE COURSE, TYPE B, 8"               | SQ.YD. | 42       |                  | 42     |
| 40200700        | AGGREGATE SURFACE COURSE, TYPE B, 8"            | SQ.YD. | 66       |                  | 66     |
| *42400100       | PORTLAND CEMENT CONCRETE SIDEWALK, 4"           | SQ.FT. | 26,714   |                  | 26,714 |
| *42400300       | PORTLAND CEMENT CONCRETE SIDEWALK, 6"           | SQ.FT. | 2,347    |                  | 2,347  |
| 42400800        | DETECTABLE WARNINGS                             | SQ.FT. | 180      |                  | 180    |
| 44000200        | DRIVEWAY PAVEMENT REMOVAL                       | SQ.YD. | 84       |                  | 84     |
| *44000300       | CURB REMOVAL                                    | FOOT   | 56       |                  | 56     |
| 44201773        | CLASS D PATCHES, TYPE I, 11"                    | SQ.YD. | 42       |                  | 42     |
| 54200220        | PIPE CULVERTS, CLASS D, TYPE 1, 15"             | FOOT   | 26       |                  | 26     |
| 67100100        | MOBILIZATION                                    | LSUM   | 1        |                  | 1      |
| 70102620        | TRAFFIC CONTROL AND PROTECTION, STANDARD 701501 | LSUM   | 1        |                  | 1      |
| 70102640        | TRAFFIC CONTROL AND PROTECTION, STANDARD 701801 | LSUM   | 1        |                  | 1      |
| 78001130 Δ      | PAINT PAVEMENT MARKING LINE, 6"                 | FOOT   | 910      |                  | 910    |
| 78001150 Δ      | PAINT PAVEMENT MARKING LINE, 12"                | FOOT   | 412      |                  | 412    |
| *XX006425       | RESTORATION                                     | SQ.YD. | 1,439    |                  | 1,439  |

\* INDICATES SPECIAL PROVISION  
 Δ INDICATES SPECIALTY ITEMS

**HMA PATCH DETAIL**

|                     | HMA PATCH  |
|---------------------|------------|
| PG GRADE            | PG64-22    |
| DESIGN AIR VOIDS    | 4.0% @ N50 |
| MIXTURE COMPOSITION | IL 19.0    |
| FRICTION AGGREGATE  |            |
| DENSITY TEST METHOD | CORES      |

\*\* When more than 20% RAP is used, a softer asphalt binder (PG58-22) may be required as determined by the Engineer.

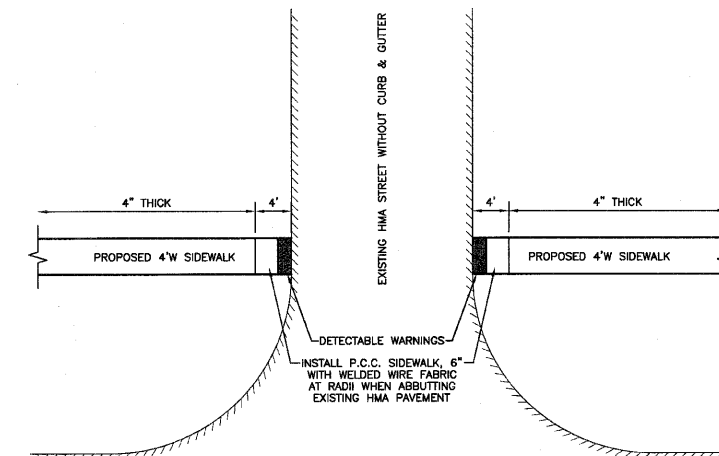

**P.C.C. SIDEWALK DETAIL  
 ABUTTING EXISTING HMA PAVEMENT**

N.T.S.

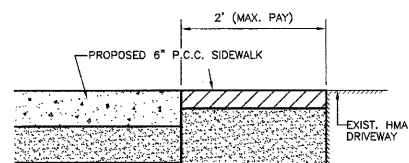

**P.C.C. SIDEWALK DETAIL**

N.T.S.

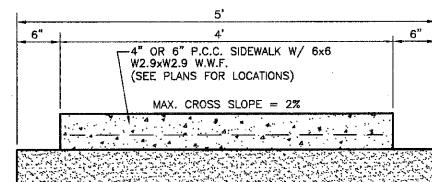

**P.C.C. SIDEWALK DETAIL**

N.T.S.

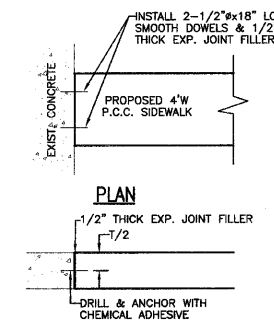

**P.C.C. SIDEWALK DETAIL  
 ABUTTING EXISTING CONCRETE**

N.T.S.

|                 |               |           |
|-----------------|---------------|-----------|
| DRAWN BY: RGP   | DATE: 7/19/10 | REVISIONS |
| CHECKED BY: MWP |               |           |

**CHAMLIN ASSOCIATES**  
 PERU MORRIS ILLINOIS

**SAFE ROUTES TO SCHOOLS**  
 VILLAGE OF COAL CITY, GRUNDY COUNTY, ILLINOIS

**DETAILS AND QUANTITIES**

|                 |         |
|-----------------|---------|
| SCALE: NONE     | SHEET 2 |
| FILE NO.: 13032 | OF 15   |

**SCHEDULE OF QUANTITIES**

|  | EARTH EXCAVATION (CU.YD.) | AGGREGATE BASE COURSE TYPE B, 8" (SQ.YD.) | AGGREGATE SURFACE COURSE TYPE B, 8" (SQ.YD.) | PCC SIDEWALK, 4" (SQ.FT.) | PCC SIDEWALK, 6" (SQ.FT.) | CURB REMOVAL (FOOT) | DETECTABLE WARNINGS (SQ.FT.) | CLASS D PATCHES TYPE I, 6" (SQ.YD.) | PIPE CULVERTS, CLASS D, TYPE 1, 15" (FOOT) | PAINT PAVEMENT MARKING LINE, 6" (FOOT) | PAINT PAVEMENT MARKING LINE, 12" (FOOT) | RESTORATION (SQ.YD.) |
|--|---------------------------|---|--|---------------------------|---------------------------|---------------------|------------------------------|-------------------------------------|--|--|---|----------------------|
| <b>DIVISION STREET (ILL. RTE. 113)</b> |                           |   |  |                           |                           |                     |                              |                                     |  |  |   |                      |
| STA. 10+38 to STA. 15+45 (RT)          | 90                        |   |  | 2595                      | 20                        | 7                   | 6                            |                                     |  | 85                                     | 124                                     | 116                  |
| STA. 15+49 to STA. 15+87 (RT)          |                           |   |  |                           | 20                        | 7                   | 6                            |                                     |  |  |   |                      |
| STA. 15+97 to STA. 16+13 (RT)          |                           |   |  |                           | 16                        |                     | 6                            |                                     |  |  |   | 100                  |
| STA. 16+13 to STA. 20+45 (RT)          | 79                        |   |  | 2227                      | 20                        | 7                   | 6                            |                                     |  | 66                                     | 98                                      |                      |
| STA. 20+49 to STA. 20+85 (RT)          |                           |   |  |                           | 20                        | 7                   | 6                            |                                     |  |  |   |                      |
| STA. 20+89 to STA. 21+04 (RT)          | 4                         |   |  | 96                        |                           |                     | 6                            |                                     |  |  |   | 4                    |
| <b>DAISY PLACE WEST</b>                |                           |   |  |                           |                           |                     |                              |                                     |  |  |   |                      |
| STA. 25+32 to STA. 26+23 (RT)          | 16                        |   |  | 365                       |                           |                     |                              |                                     |  |  |   | 20                   |
| STA. 28+08 to STA. 29+08 (RT)          | 17                        |   |  | 400                       | 16                        |                     | 6                            |                                     |  | 85                                     |   | 22                   |
| STA. 29+12 to STA. 29+58 (RT)          |                           |   |  |                           |                           |                     |                              |                                     |  |  |   |                      |
| <b>DAISY PLACE EAST</b>                |                           |   |  |                           |                           |                     |                              |                                     |  |  |   |                      |
| STA. 30+02 to STA. 31+35 (RT)          | 23                        |   |  | 531                       |                           |                     |                              |                                     |  |  |   | 30                   |
| STA. 31+55 to STA. 32+81 (RT)          | 22                        |   |  | 505                       | 16                        |                     | 6                            |                                     |  | 30                                     |   | 28                   |
| STA. 32+85 to STA. 33+00 (RT)          |                           |   |  |                           | 16                        |                     | 6                            |                                     |  |  |   | 52                   |
| STA. 33+04 to STA. 35+36 (RT)          | 41                        |   |  | 934                       |                           |                     |                              |                                     |  |  |   | 11                   |
| STA. 35+53 to STA. 36+04 (RT)          | 10                        |   |  | 205                       | 16                        |                     | 6                            |                                     |  | 56                                     |   |                      |
| STA. 36+08 to STA. 36+36 (RT)          |                           |   |  |                           | 16                        |                     | 6                            |                                     |  |  |   | 9                    |
| STA. 36+40 to STA. 36+61 (RT)          | 8                         |   |  | 153                       | 16                        |                     | 6                            |                                     |  | 56                                     |   |                      |
| <b>MAPLE STREET</b>                    |                           |   |  |                           |                           |                     |                              |                                     |  |  |   |                      |
| STA. 40+34 to STA. 41+45 (LT)          | 23                        | 5   |  | 510                       | 16                        |                     | 6                            | 5                                   |  | 74                                     |   | 28                   |
| STA. 41+49 to STA. 41+66 (LT)          |                           |   |  |                           | 86                        |                     |                              |                                     |  |  |   | 10                   |
| STA. 41+66 to STA. 42+08 (LT)          | 8                         | 7   |  | 173                       | 115                       |                     |                              | 7                                   |  |  |   | 19                   |
| STA. 42+08 to STA. 42+36 (LT)          |                           |   |  |                           |                           |                     |                              |                                     |  |  |   |                      |
| STA. 42+36 to STA. 43+22 (LT)          | 15                        |   |  | 341                       | 16                        |                     | 6                            |                                     |  |  |   | 24                   |
| STA. 43+26 to STA. 43+45 (LT)          |                           |   |  |                           | 16                        |                     | 6                            |                                     |  | 39                                     |   | 4                    |
| STA. 43+49 to STA. 44+60 (LT)          | 20                        | 6   |  | 439                       | 111                       |                     | 6                            | 6                                   |  |  |   | 25                   |
| STA. 44+60 to STA. 44+87 (LT)          | 3                         |   |  | 74                        | 110                       |                     |                              | 6                                   |  |  |   |                      |
| STA. 44+87 to STA. 45+08 (LT)          |                           |   |  |                           |                           |                     |                              |                                     |  |  |   |                      |
| STA. 45+08 to STA. 45+33 (LT)          | 20                        | 6   |  | 449                       | 16                        |                     | 6                            |                                     |  | 62                                     |   | 75                   |
| STA. 45+33 to STA. 46+45 (LT)          |                           |   |  |                           |                           |                     | 6                            |                                     |  |  |   |                      |
| STA. 46+49 to STA. 46+83 (LT)          |                           |   |  |                           |                           |                     | 6                            |                                     |  |  |   |                      |
| STA. 46+83 to STA. 46+89 (LT)          |                           |   |  |                           |                           |                     |                              |                                     |  |  |   |                      |
| STA. 46+89 to STA. 50+25 (LT)          | 56                        |   |  | 1356                      | 16                        |                     |                              |                                     |  |  |   |                      |
| <b>SPRING ROAD</b>                     |                           |   |  |                           |                           |                     |                              |                                     |  |  |   |                      |
| STA. 200+48 to STA. 201+79 (LT)        | 23                        |   | 4  | 525                       | 36                        |                     |                              |                                     |  |  |   | 29                   |
| STA. 201+79 to STA. 201+88 (LT)        | 1                         |   |  | 29                        |                           |                     |                              |                                     |  |  |   | 3                    |
| STA. 201+88 to STA. 201+88 (LT)        |                           |   |  |                           |                           |                     |                              |                                     |  |  |   | 29                   |
| STA. 209+44 to STA. 210+74 (LT)        | 23                        |   |  | 520                       |                           |                     |                              |                                     |  |  |   |                      |
| <b>BERTIA ROAD</b>                     |                           |   |  |                           |                           |                     |                              |                                     |  |  |   |                      |
| STA. 55+05 to STA. 55+53 (RT)          | 26                        |   |  | 594                       | 16                        | 7                   | 6                            |                                     |  | 80                                     |   | 34                   |
| STA. 55+53 to STA. 57+47 (RT)          | 32                        |   |  | 725                       | 16                        |                     | 6                            |                                     |  |  |   | 41                   |
| STA. 57+47 to STA. 57+70 (RT)          |                           |   | 5  |                           | 92                        | 7                   | 6                            |                                     |  |  |   | 28                   |
| STA. 57+70 to STA. 58+96 (RT)          | 22                        |   | 5  | 506                       | 92                        |                     |                              |                                     |  |  |   | 68                   |
| STA. 58+96 to STA. 59+19 (RT)          | 53                        |   |  | 1218                      | 16                        |                     | 6                            |                                     |  |  |   | 83                   |
| STA. 59+19 to STA. 62+24 (RT)          |                           |   |  |                           |                           |                     | 6                            |                                     |  |  |   | 22                   |
| STA. 62+24 to STA. 62+81 (RT)          |                           |   |  |                           | 16                        |                     | 6                            |                                     |  |  |   | 4                    |
| STA. 62+81 to STA. 65+52 (RT)          | 65                        |   |  | 1483                      |                           |                     |                              |                                     |  | 56                                     |   |                      |
| STA. 65+52 to STA. 66+79 (RT)          | 17                        |   |  | 389                       |                           |                     |                              |                                     |  | 47                                     |   |                      |
| STA. 66+79 to STA. 67+77 (RT)          |                           |   |  |                           |                           |                     |                              |                                     |  |  |   |                      |
| STA. 67+77 to STA. 67+99 (RT)          |                           |   |  |                           |                           |                     |                              |                                     |  |  |   |                      |
| STA. 67+99 to STA. 68+14 (RT)          | 4                         |   |  | 60                        | 16                        |                     | 6                            |                                     |  |  |   |                      |
| STA. 68+14 to STA. 68+18 (LT)          |                           |   |  |                           |                           |                     |                              |                                     |  |  |   |                      |
| <b>MCGINITY STREET</b>                 |                           |   |  |                           |                           |                     |                              |                                     |  |  |   |                      |
| STA. 70+75 to STA. 72+02 (LT)          | 24                        |   |  | 551                       | 23                        |                     | 6                            |                                     |  |  |   | 31                   |
| STA. 72+02 to STA. 72+22 (RT)          |                           |   |  |                           | 23                        |                     | 6                            |                                     |  |  |   |                      |
| STA. 72+22 to STA. 73+30 (RT)          | 26                        | 5   |  | 610                       | 84                        |                     |                              | 5                                   |  |  |   | 34                   |
| STA. 73+30 to STA. 74+03 (RT)          |                           |   |  |                           |                           |                     |                              |                                     |  |  |   | 37                   |
| STA. 74+03 to STA. 75+57 (RT)          | 29                        |   |  | 708                       | 20                        |                     | 6                            |                                     |  | 48                                     | 70                                      |                      |
| STA. 75+57 to STA. 75+81 (RT)          |                           |   |  |                           |                           | 7                   | 6                            |                                     |  |  |   |                      |
| STA. 75+81 to STA. 75+86 (RT)          | 2                         |   |  |                           | 35                        | 7                   | 6                            |                                     |  |  |   | 2                    |
| STA. 75+86 to STA. 75+93 (RT)          |                           |   |  |                           |                           |                     |                              |                                     |  |  |   |                      |
| <b>HOLCOMB STREET</b>                  |                           |   |  |                           |                           |                     |                              |                                     |  |  |   |                      |
| STA. 80+00 to STA. 80+14 (RT)          |                           |   |  |                           | 16                        |                     | 6                            |                                     |  | 45                                     | 66                                      | 23                   |
| STA. 80+14 to STA. 81+04 (RT)          | 18                        |   |  | 401                       | 100                       |                     |                              |                                     |  |  |   | 18                   |
| STA. 81+04 to STA. 81+29 (RT)          |                           |   | 6  |                           |                           |                     |                              |                                     |  |  |   | 4                    |
| STA. 81+29 to STA. 82+09 (RT)          | 14                        |   | 3  | 326                       | 59                        |                     |                              |                                     |  |  |   | 16                   |
| STA. 82+09 to STA. 82+24 (RT)          | 3                         |   |  | 75                        | 54                        |                     |                              |                                     |  |  |   | 19                   |
| STA. 82+24 to STA. 82+43 (RT)          |                           |   |  |                           |                           |                     |                              |                                     |  |  |   |                      |
| STA. 82+43 to STA. 82+57 (RT)          | 12                        |   | 3  | 288                       | 54                        |                     |                              |                                     |  |  |   | 12                   |
| STA. 82+57 to STA. 83+27 (RT)          |                           |   |  |                           |                           |                     |                              |                                     |  |  |   | 17                   |
| STA. 83+27 to STA. 83+41 (RT)          | 15                        |   | 3  | 347                       | 16                        |                     | 6                            |                                     |  | 40                                     |   | 59                   |
| STA. 83+41 to STA. 84+19 (RT)          |                           |   |  |                           |                           |                     |                              |                                     |  |  |   |                      |
| STA. 84+19 to STA. 84+23 (RT)          |                           |   |  |                           |                           |                     |                              |                                     |  |  |   |                      |
| STA. 84+23 to STA. 84+43 (RT)          |                           |   |  |                           |                           |                     |                              |                                     |  |  |   |                      |
| STA. 84+43 to STA. 84+86 (RT)          | 9                         |   |  | 193                       | 71                        |                     | 6                            |                                     |  |  |   |                      |
| STA. 84+86 to STA. 85+04 (RT)          |                           |   | 4  |                           |                           |                     |                              |                                     |  |  |   |                      |
| STA. 85+04 to STA. 85+79 (RT)          | 13                        |   |  | 300                       | 81                        |                     |                              |                                     |  |  |   |                      |
| STA. 85+79 to STA. 85+99 (RT)          | 46                        |   | 5  | 1065                      | 16                        |                     | 6                            |                                     |  | 41                                     | 54                                      |                      |
| STA. 85+99 to STA. 88+56 (RT)          |                           |   |  |                           |                           |                     |                              |                                     |  |  |   |                      |
| STA. 88+56 to STA. 88+77 (RT)          |                           |   |  |                           |                           |                     |                              |                                     |  |  |   |                      |
| <b>RATHBURN STREET</b>                 |                           |   |  |                           |                           |                     |                              |                                     |  |  |   |                      |
| STA. 90+38 to STA. 90+52 (RT)          | 18                        | 4   |  | 405                       | 74                        |                     | 6                            |                                     | 26   |  |   | 23                   |
| STA. 90+52 to STA. 91+39 (RT)          |                           |   |  |                           |                           |                     |                              | 4                                   |  |  |   | 67                   |
| STA. 91+39 to STA. 91+58 (RT)          |                           |   |  |                           |                           |                     |                              |                                     |  |  |   | 22                   |
| STA. 91+58 to STA. 94+57 (RT)          | 52                        | 4   | 4  | 1200                      | 74                        |                     |                              | 4                                   |  |  |   | 5                    |
| STA. 94+57 to STA. 94+75 (RT)          | 17                        |   |  | 395                       | 85                        |                     |                              |                                     |  |  |   | 35                   |
| STA. 94+75 to STA. 95+74 (RT)          |                           |   |  |                           |                           |                     |                              |                                     |  |  |   |                      |
| STA. 95+74 to STA. 95+95 (RT)          | 4                         |   | 5  | 93                        | 80                        |                     |                              |                                     |  |  |   | 3                    |
| STA. 95+95 to STA. 96+18 (RT)          |                           |   |  |                           |                           |                     |                              |                                     |  |  |   |                      |
| STA. 96+18 to STA. 96+38 (RT)          |                           |   | 4  |                           |                           |                     |                              |                                     |  |  |   |                      |
| STA. 96+38 to STA. 97+93 (RT)          | 27                        |   |  | 621                       | 92                        |                     |                              | 5                                   |  |  |   | 64                   |
| STA. 97+93 to STA. 98+18 (RT)          |                           | 5   |  |                           |                           |                     |                              |                                     |  |  |   | 8                    |
| STA. 98+18 to STA. 98+28 (RT)          | 2                         |   |  | 47                        | 52                        |                     |                              |                                     |  |  |   | 19                   |
| STA. 98+28 to STA. 98+40 (RT)          |                           |   |  |                           |                           |                     |                              |                                     |  |  |   |                      |
| STA. 98+40 to STA. 101+28 (RT)         | 50                        |   | 3  | 1153                      | 71                        |                     |                              |                                     |  |  |   | 3                    |
| STA. 101+28 to STA. 101+45 (RT)        |                           |   |  |                           |                           |                     |                              |                                     |  |  |   |                      |
| STA. 101+45 to STA. 101+82 (RT)        | 6                         |   |  | 148                       | 62                        |                     |                              |                                     |  |  |   |                      |
| STA. 101+82 to STA. 101+98 (RT)        |                           |   |  |                           |                           |                     |                              |                                     |  |  |   |                      |
| STA. 101+98 to STA. 102+83 (RT)        | 15                        |   | 3  | 342                       | 79                        |                     |                              |                                     |  |  |   |                      |
| STA. 102+83 to STA. 103+03 (RT)        |                           |   |  |                           |                           |                     |                              |                                     |  |  |   |                      |
| STA. 103+03 to STA. 103+14 (RT)        | 2                         |   | 5  | 44                        |                           |                     |                              |                                     |  |  |   |                      |
| <b>TOTALS</b>                          |                           |   |  |                           |                           |                     |                              |                                     |  |  |   |                      |
|  | 1125                      | 42  | 66   | 26714                     | 2347                      | 42                  | 180                          | 56                                  | 26   | 910                                    | 412                                     | 1439                 |

|                 |                             |               |         |
|-----------------|-----------------------------|---------------|---------|
| DRAWN BY: RGP   | 114099-001 CAD/DWG: DETAILS | REVISIONS     |         |
| CHECKED BY: MWP | DATE: 7/19/10               | DATE: 8/9/10  | BY: MAB |
|                 |                             | DATE: 8/23/10 | BY: MAB |



PERU MORRIS  
ILLINOIS

**SAFE ROUTES TO SCHOOLS**  
VILLAGE OF COAL CITY, GRUNDY COUNTY, ILLINOIS

SCHEDULE OF QUANTITIES

|                 |         |
|-----------------|---------|
| SCALE: NONE     | SHEET 3 |
| FILE NO.: 13032 | OF 15   |

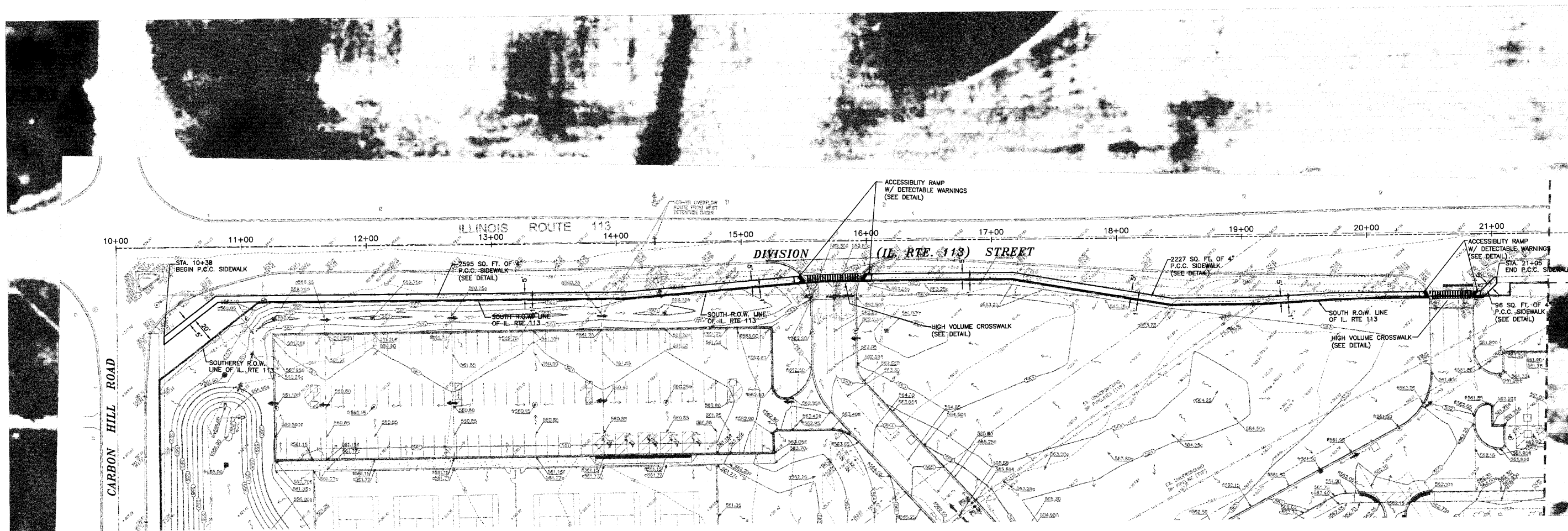
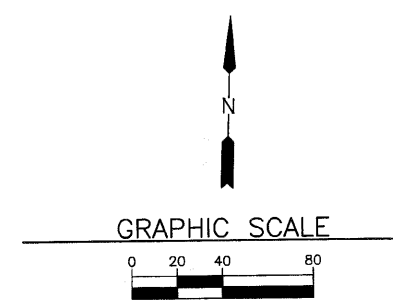

PROJ. NO. SRTS-4009 (010)  
 CONTRACT NO. 87458

|                 |                                    |           |     |
|-----------------|------------------------------------|-----------|-----|
| DRAWN BY: RGP   | CAD/DWG: SAFERTE-BASE<br>XREF/DWG: | REVISIONS |     |
|                 |                                    | DATE      | BY  |
| CHECKED BY: MWP | DATE: 7/19/10                      | 8/9/10    | MAB |
|                 |                                    | 8/23/10   | MAB |

**CHAMLIN & ASSOCIATES**  
 PERU MORRIS  
 ILLINOIS

**SAFE ROUTE TO SCHOOLS**  
 VILLAGE OF COAL CITY, GRUNDY COUNTY, ILLINOIS

**DIVISION STREET (ILL. RTE. 113)**

|                 |         |
|-----------------|---------|
| SCALE: 1" = 80' | SHEET 4 |
| FILE NO.: 13032 | OF 15   |

Chamlin and Assoc., Inc.



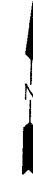

GRAPHIC SCALE

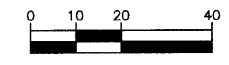

PROJ. NO. SRTS-4009 (010)  
CONTRACT NO. 87458

DRAWN BY: RGP  
CHECKED BY: MWP

114092-00  
CAD/DWG: SAFERTE-BASE  
XREF/DWG:  
DATE: 7/19/10

| REVISIONS |     |
|-----------|-----|
| DATE      | BY  |
| 8/9/10    | MAB |



PERU MORRIS  
ILLINOIS

SAFE ROUTE TO SCHOOLS  
VILLAGE OF COAL CITY, GRUNDY COUNTY, ILLINOIS

DAISY PLACE (WEST END)

SCALE: 1" = 40'  
FILE NO.: 13032

SHEET 5  
OF 15

Chamlin and Assoc., Inc.

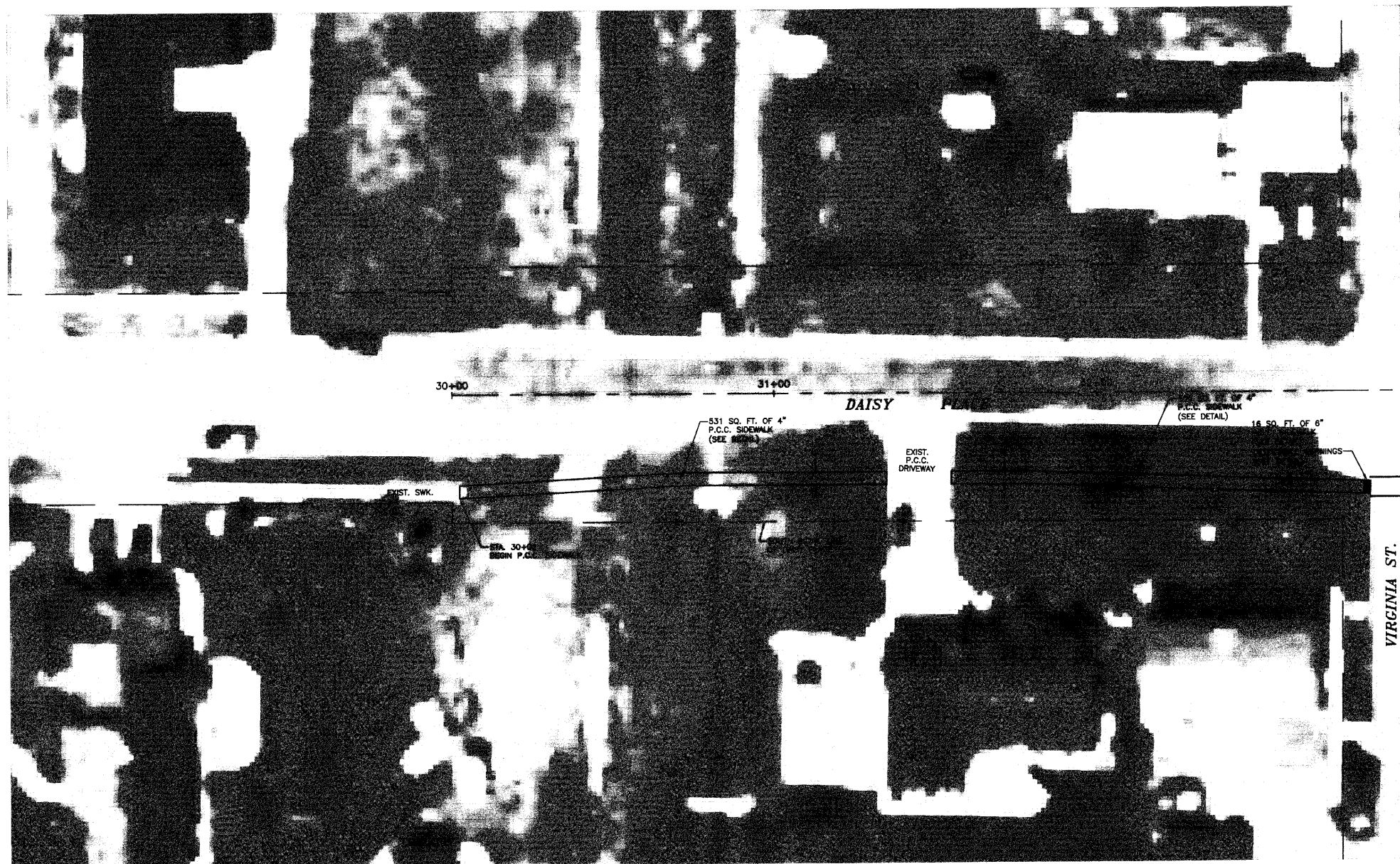
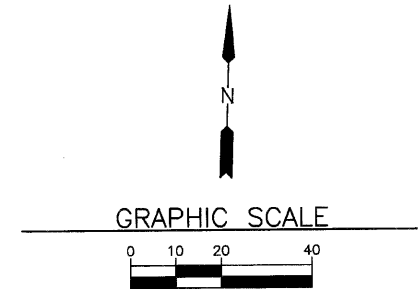

MATCHLINE SEE SHEET 6

PROJ. NO. SRTS-4009 (010)  
 CONTRACT NO. 87458

| DRAWN BY: RGP   | V14092-001<br>CAD/DWG: SAFERTE-BASE<br>XREF/DWG: | <table border="1" style="font-size: 8px;"> <thead> <tr> <th colspan="2">REVISIONS</th> </tr> <tr> <th>DATE</th> <th>BY</th> </tr> </thead> <tbody> <tr> <td>8/9/10</td> <td>MAB</td> </tr> </tbody> </table> | REVISIONS |  | DATE | BY | 8/9/10 | MAB | <br><b>CHAMLIN &amp; ASSOCIATES</b> | PERU MORRIS<br>ILLINOIS | <b>SAFE ROUTE TO SCHOOLS</b><br>VILLAGE OF COAL CITY, GRUNDY COUNTY, ILLINOIS | <b>DAISY PLACE (EAST)</b> | SCALE: 1" = 40'<br>FILE NO.: 13032 | SHEET 6<br>OF 15 |
|-----------------|--|--|-----------|--|------|----|--------|-----|-------------------------------------|-------------------------|---|---------------------------|------------------------------------|------------------|
| REVISIONS       |  |  |           |  |      |    |        |     |                                     |                         |   |                           |                                    |                  |
| DATE            | BY   |  |           |  |      |    |        |     |                                     |                         |   |                           |                                    |                  |
| 8/9/10          | MAB  |  |           |  |      |    |        |     |                                     |                         |   |                           |                                    |                  |
| CHECKED BY: MWP | DATE: 7/19/10                                    |  |           |  |      |    |        |     |                                     |                         |   |                           |                                    |                  |

Chamlin and Assoc., Inc.



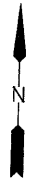

GRAPHIC SCALE

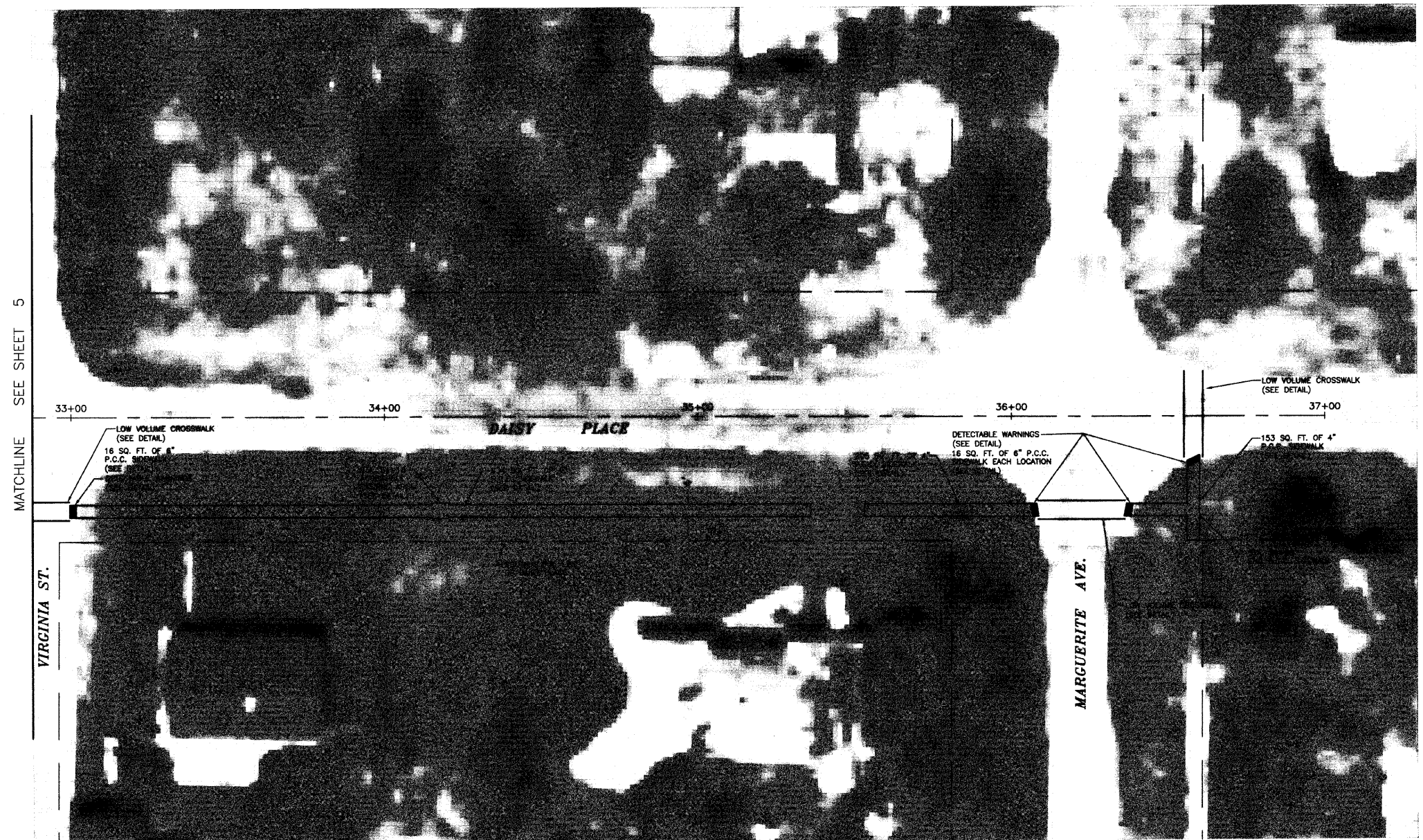
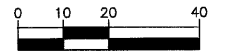

PROJ. NO. SRTS-4009 (010)  
CONTRACT NO. 87458

DRAWN BY: RGP  
CHECKED BY: MWP

114092-001  
CAD/DWG: SAFERTE-BASE  
XREF/DWG:  
DATE: 7/19/10

| REVISIONS |     |
|-----------|-----|
| DATE      | BY  |
| 8/9/10    | MAB |



PERU MORRIS  
ILLINOIS

SAFE ROUTE TO SCHOOLS  
VILLAGE OF COAL CITY, GRUNDY COUNTY, ILLINOIS

DAISY PLACE (EAST)

SCALE: 1" = 40'  
FILE NO.: 13032

SHEET 7  
OF 15

Chamlin and Assoc., Inc.

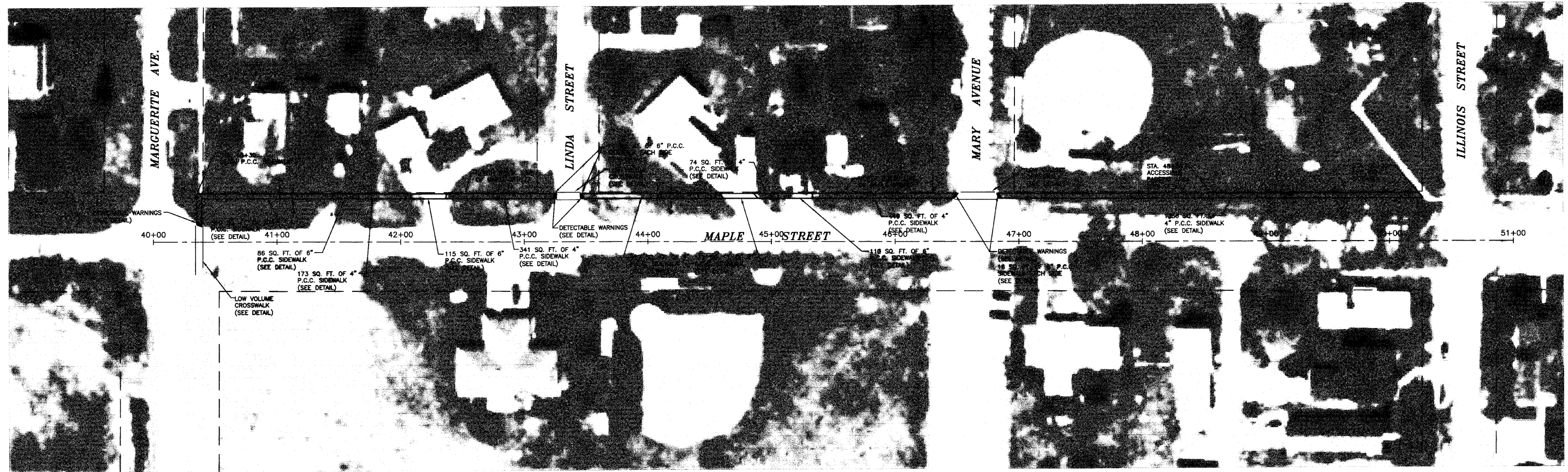
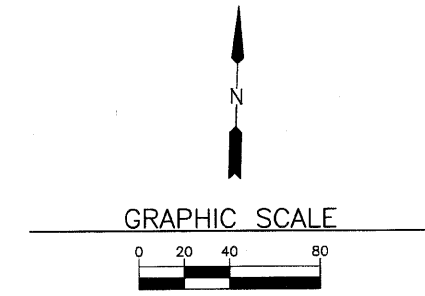

PROJ. NO. SRTS-4009 (010)  
 CONTRACT NO. 87458

|               |  |                 |               |  |                         |   |                     |                 |         |
|---------------|--|-----------------|---------------|--|-------------------------|---|---------------------|-----------------|---------|
| DRAWN BY: RGP | 114099-001<br>CAD/DWG: SAFERTE-BASE<br>XREF/DWG: | REVISIONS       |               |  | PERU MORRIS<br>ILLINOIS | <b>SAFE ROUTE TO SCHOOLS</b><br>VILLAGE OF COAL CITY, GRUNDY COUNTY, ILLINOIS | <b>MAPLE STREET</b> | SCALE: 1" = 80' | SHEET 8 |
|               |  | CHECKED BY: MWP | DATE: 7/19/10 |  |                         |   |                     | FILE NO.: 13032 | OF 15   |

Chamlin and Assoc., Inc.



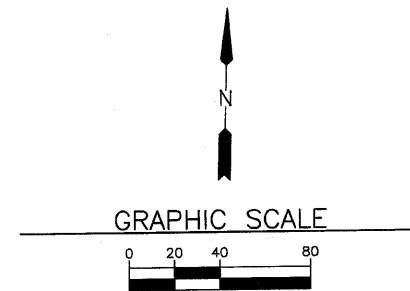

PROJ. NO. SRTS-4009 (010)  
 CONTRACT NO. 87458

|                 |                                      |                          |           |  |                         |   |             |                 |         |
|-----------------|--------------------------------------|--------------------------|-----------|--|-------------------------|---|-------------|-----------------|---------|
| DRAWN BY: RGP   | CAD/.DWG: SAFERTE-BASE<br>XREF/.DWG: | REVISIONS                |           |  | PERU MORRIS<br>ILLINOIS | <b>SAFE ROUTE TO SCHOOLS</b><br>VILLAGE OF COAL CITY, GRUNDY COUNTY, ILLINOIS | SPRING ROAD | SCALE: 1" = 80' | SHEET 9 |
|                 |                                      | DATE<br>8/8/10           | BY<br>MAB |  |                         |   |             | FILE NO.: 13032 | OF 15   |
| CHECKED BY: MWP | DATE: 7/19/10                        | Chamlin and Assoc., Inc. |           |  |                         |   |             |                 |         |

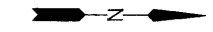

GRAPHIC SCALE

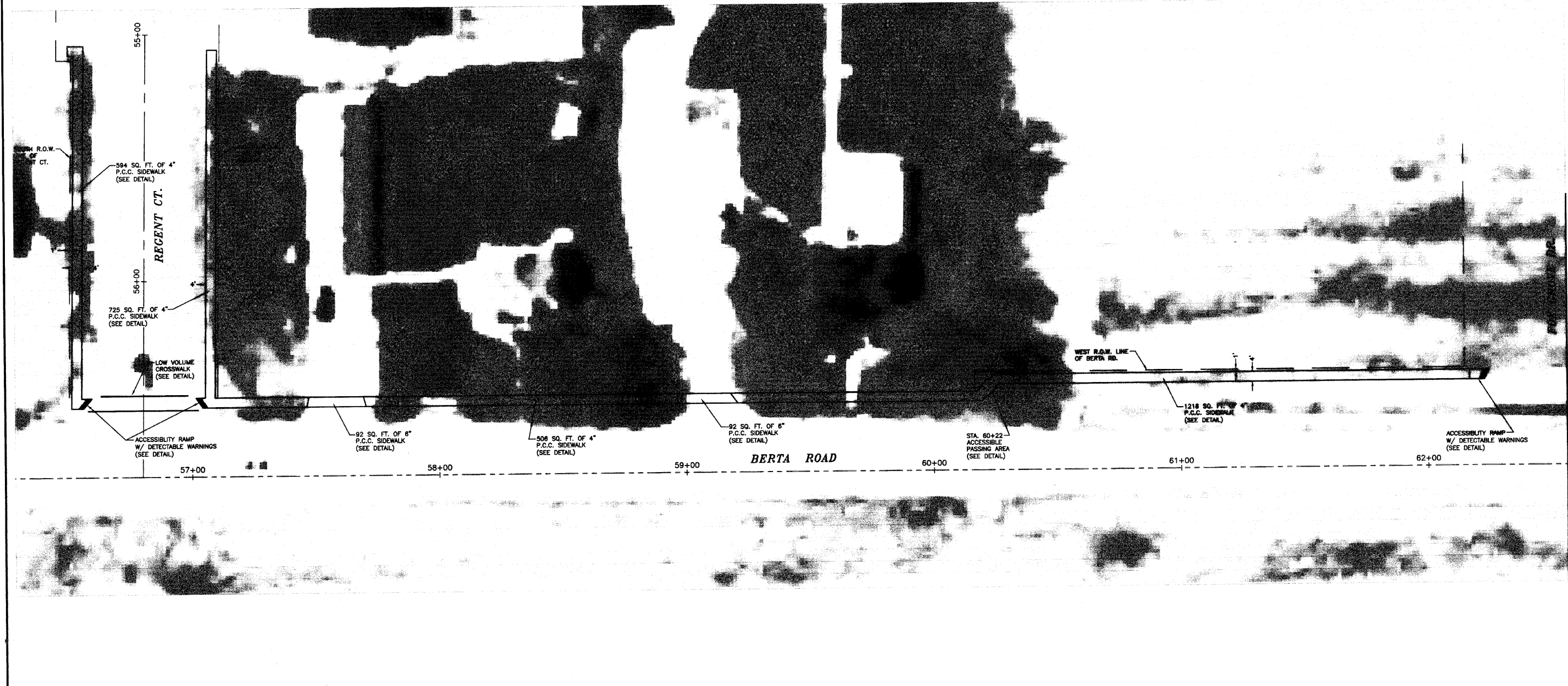
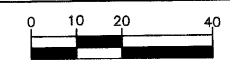

MATCHLINE SEE SHEET 10

PROJ. NO. SRTS-4009 (010)  
CONTRACT NO. 87458

DRAWN BY: RGP  
 CHECKED BY: MWP  
 DATE: 7/19/10

| REVISIONS |     |
|-----------|-----|
| DATE      | BY  |
| 8/9/10    | MAB |
|           |     |
|           |     |



PERU MORRIS  
ILLINOIS

**SAFE ROUTE TO SCHOOLS**  
VILLAGE OF COAL CITY, GRUNDY COUNTY, ILLINOIS

BERTA ROAD

SCALE: 1" = 40'  
FILE NO.: 13032

SHEET 10  
OF 15

Chamlin and Assoc., Inc.

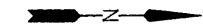

GRAPHIC SCALE

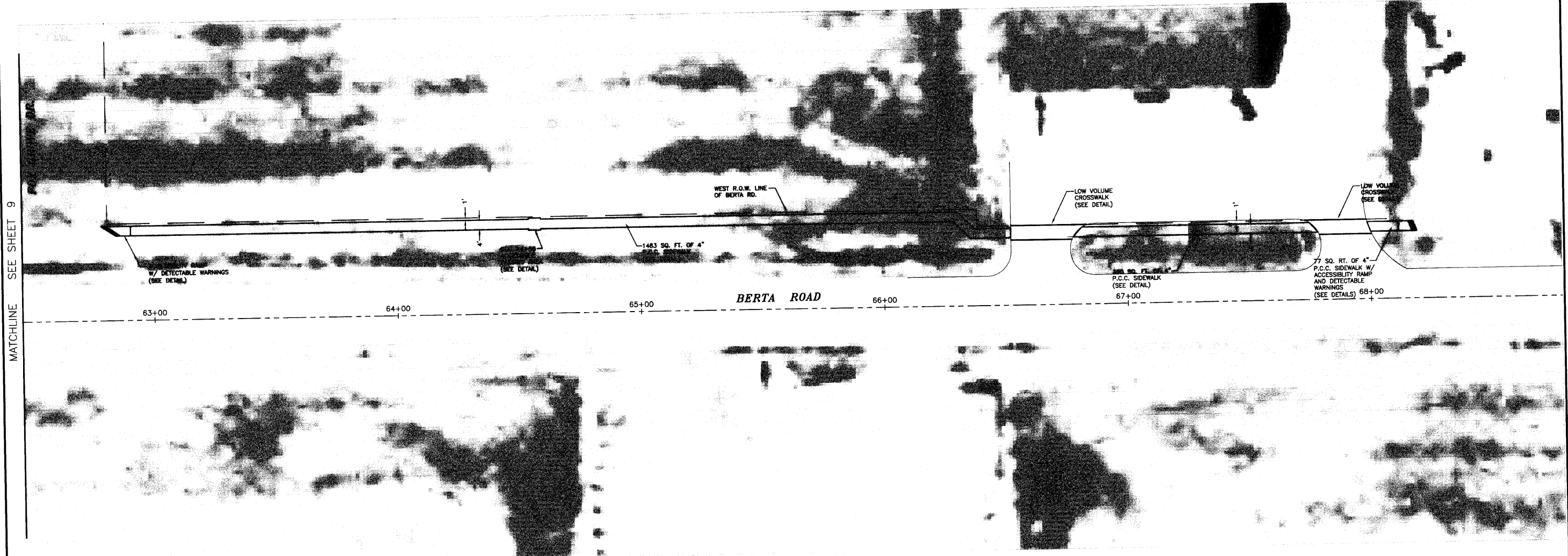
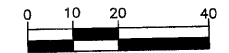

MATCHLINE SEE SHEET 9

PROJ. NO. SRTS-4009 (010)  
CONTRACT NO. 87458

|                 |   |                |           |                         |  |            |                          |          |
|-----------------|---|----------------|-----------|-------------------------|--|------------|--------------------------|----------|
| DRAWN BY: RGP   | 14099-001<br>CAD/DWG: SAFERTE-BASE<br>XREF/DWG: | REVISIONS      |           | PERU MORRIS<br>ILLINOIS | SAFE ROUTE TO SCHOOLS<br>VILLAGE OF COAL CITY, GRUNDY COUNTY, ILLINOIS | BERTA ROAD | SCALE: 1" = 40'          | SHEET 11 |
|                 |   | DATE<br>8/9/10 | BY<br>MAB |                         |  |            | FILE NO.: 13032          | OF 15    |
| CHECKED BY: MWP | DATE: 7/19/10                                   |                |           |                         |  |            | Chamlin and Assoc., Inc. |          |



Chamlin and Assoc., Inc.



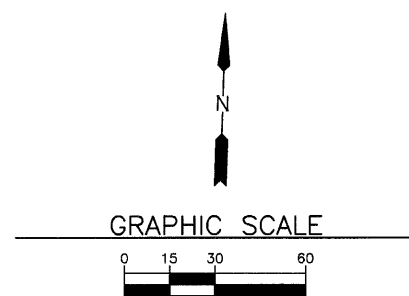
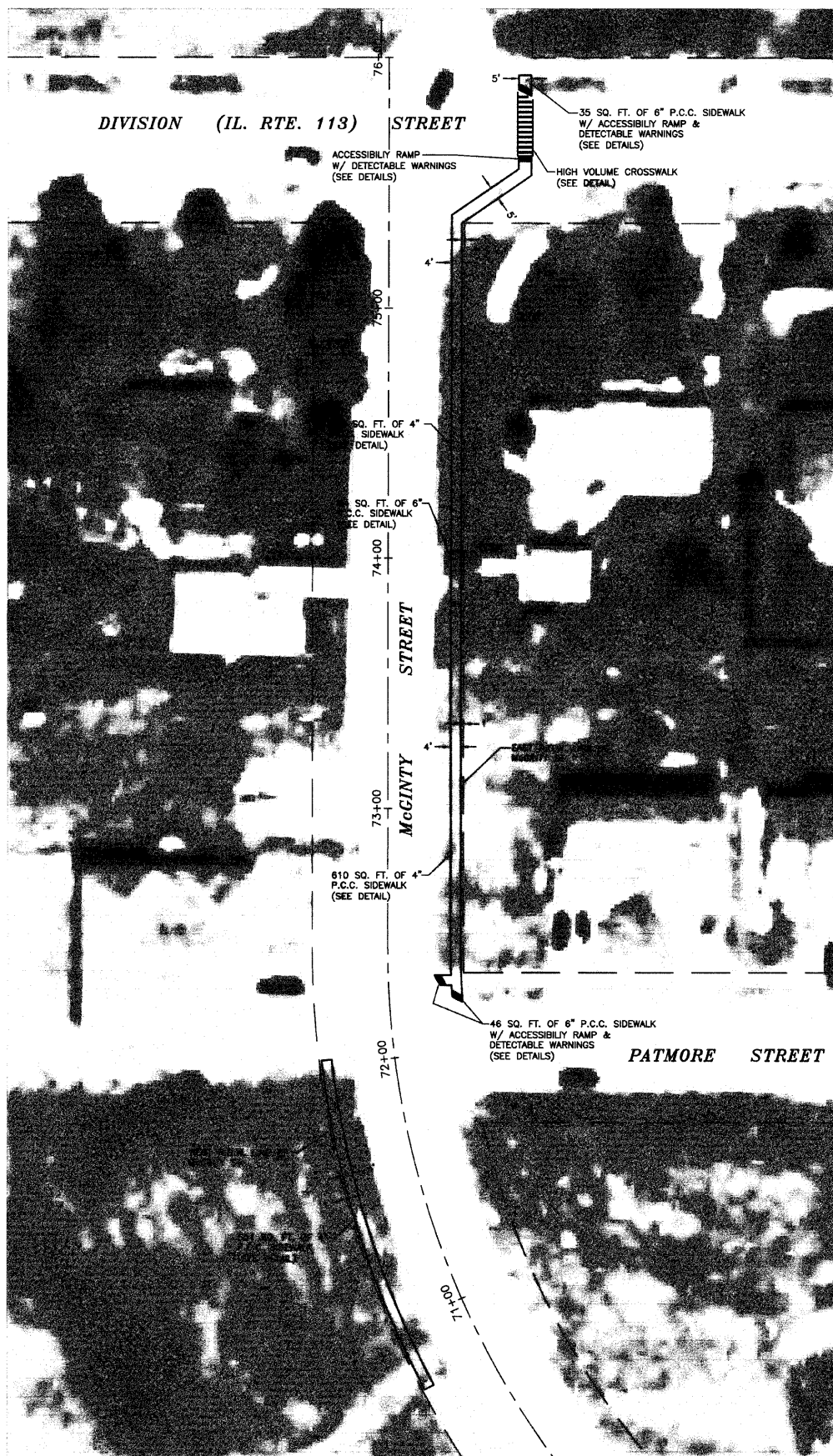

PROJ. NO. SRTS-4009 (010)  
 CONTRACT NO. 87458

DRAWN BY: RGP  
 CHECKED BY: MWP

DATE: 7/19/10

| REVISIONS |     |
|-----------|-----|
| DATE      | BY  |
| 8/9/10    | MAB |
| 8/23/10   | MAB |



PERU MORRIS  
 ILLINOIS

**SAFE ROUTE TO SCHOOLS**  
 VILLAGE OF DIAMOND, GRUNDY COUNTY, ILLINOIS

**McGINTY STREET**

|                 |          |
|-----------------|----------|
| SCALE: 1" = 60' | SHEET 12 |
| FILE NO.: 13032 | OF 15    |

Chamlin and Assoc., Inc.

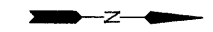

GRAPHIC SCALE

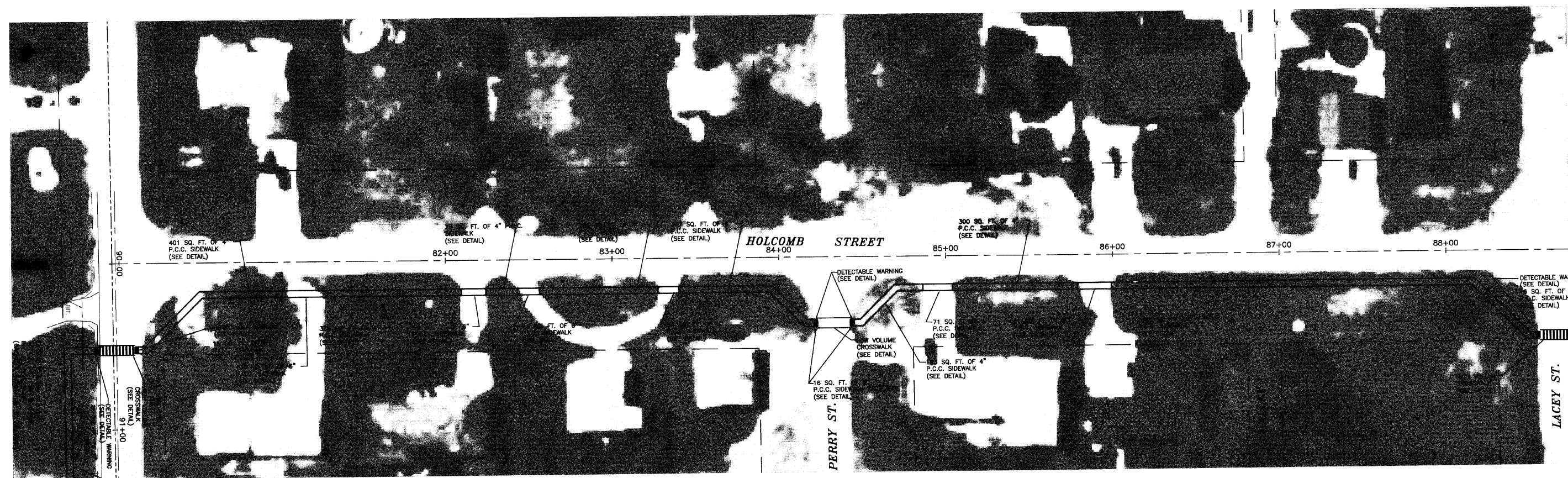
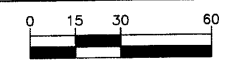

PROJ. NO. SRTS-4009 (010)  
CONTRACT NO. 87458

|                 |  |           |     |                         |  |                |                 |          |
|-----------------|--|-----------|-----|-------------------------|--|----------------|-----------------|----------|
| DRAWN BY: RGP   | 14099-00<br>CAD/DWG: SAFERTE-BASE<br>XREF/DWG: | REVISIONS |     | PERU MORRIS<br>ILLINOIS | SAFE ROUTE TO SCHOOLS<br>VILLAGE OF CARBON HILL, GRUNDY COUNTY, ILLINOIS | HOLCOMB STREET | SCALE: 1" = 60' | SHEET 13 |
|                 |  | DATE      | BY  |                         |  |                | FILE NO.: 13032 | OF 15    |
| CHECKED BY: MWP | DATE: 7/19/10                                  | 8/9/10    | MAB |                         |  |                |                 |          |



Chamlin and Assoc., Inc.

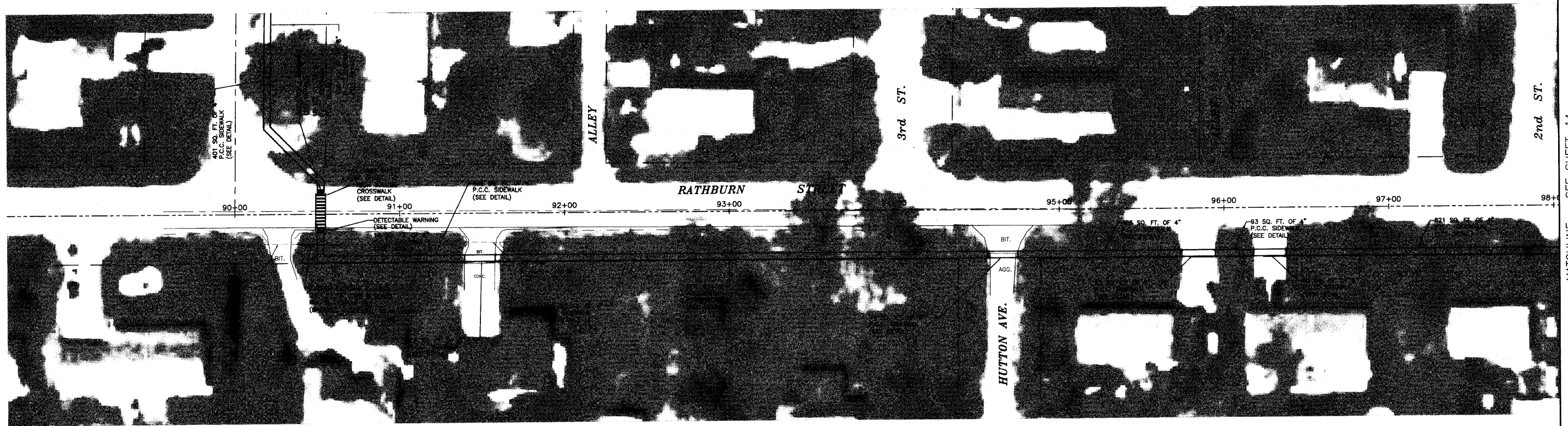
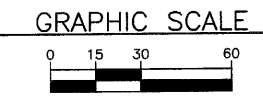
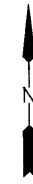

MATCHLINE SEE SHEET 14

PROJ. NO. SRTS-4009 (010)  
CONTRACT NO. 87458

|                 |                                     |  |
|-----------------|-------------------------------------|--|
| DRAWN BY: RGP   | V14092-001<br>CAD/DWG: SAFERTE-BASE |  |
|                 | XREF/DWG:                           |  |
| CHECKED BY: MWP | DATE: 7/19/10                       |  |

| REVISIONS |     |
|-----------|-----|
| DATE      | BY  |
| 8/9/10    | MAB |



PERU MORRIS  
ILLINOIS

**SAFE ROUTE TO SCHOOLS**  
VILLAGE OF CARBON HILL, GRUNDY COUNTY, ILLINOIS

RATHBURN STREET

|                 |          |
|-----------------|----------|
| SCALE: 1" = 60' | SHEET 14 |
| FILE NO.: 13032 | OF 15    |

Chamlin and Assoc., Inc.



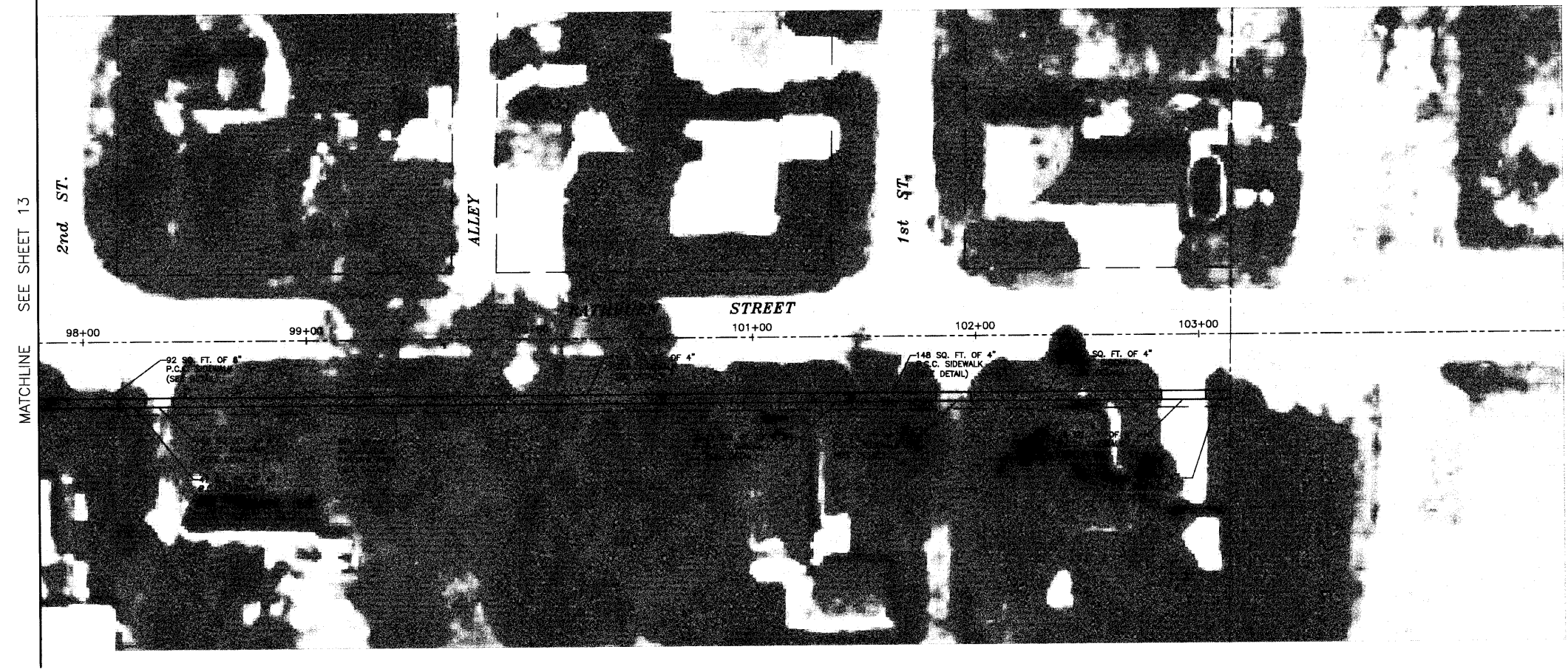
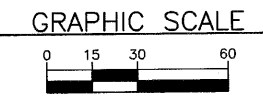
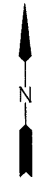

PROJ. NO. SRTS-4009 (010)  
CONTRACT NO. 87458

DRAWN BY: RGP  
CHECKED BY: MWP  
DATE: 7/19/10

| REVISIONS |     |
|-----------|-----|
| DATE      | BY  |
| 8/9/10    | MAB |

**CHAMLIN**  
ASSOCIATES

PERU MORRIS  
ILLINOIS

**SAFE ROUTE TO SCHOOLS**  
VILLAGE OF CARBON HILL, GRUNDY COUNTY, ILLINOIS

**RATHBURN STREET**

|                 |          |
|-----------------|----------|
| SCALE: 1" = 60' | SHEET 15 |
| FILE NO.: 13032 | OF 15    |

Chamlin and Assoc., Inc.