

F.A. RTE.	SECTION	COUNTY	TOTAL SHEETS	SHEET NO.
---	00-P4002-03-BT	PEORIA	53	13
STA. 100+36.27		TO STA. 179+51.94		
FED. ROAD DIST. NO. 1		ILLINOIS FED. AID PROJECT		

PROP. CURVE CL-9
 PI STA. = 177+36.85
 $\Delta = 16^\circ 24' 12''$ (LT)
 $D = 0^\circ 58' 16''$
 $R = 5,900.00'$
 $T = 850.38'$
 $L = 1,689.12'$
 $E = 60.97'$
 $e = \text{-----}$
 $T.R. = \text{-----}$
 $S.E. RUN = \text{-----}$
 $P.C. STA. = 168+86.48$
 $P.T. STA. = 185+75.60$

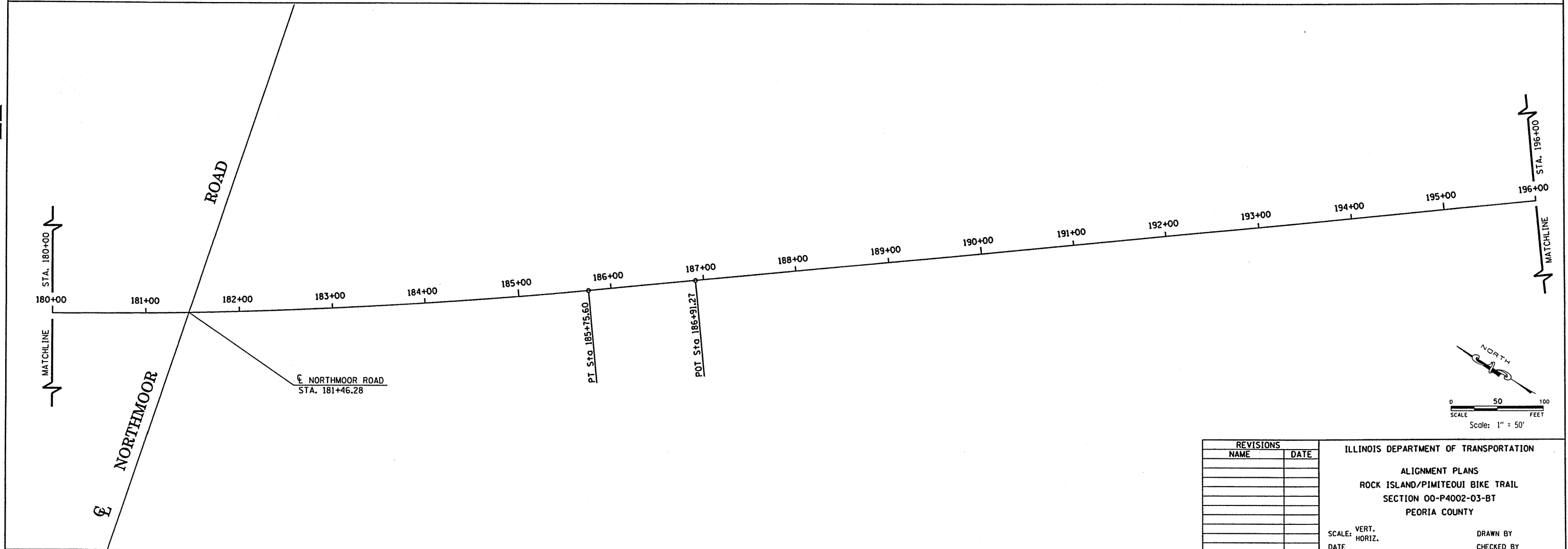
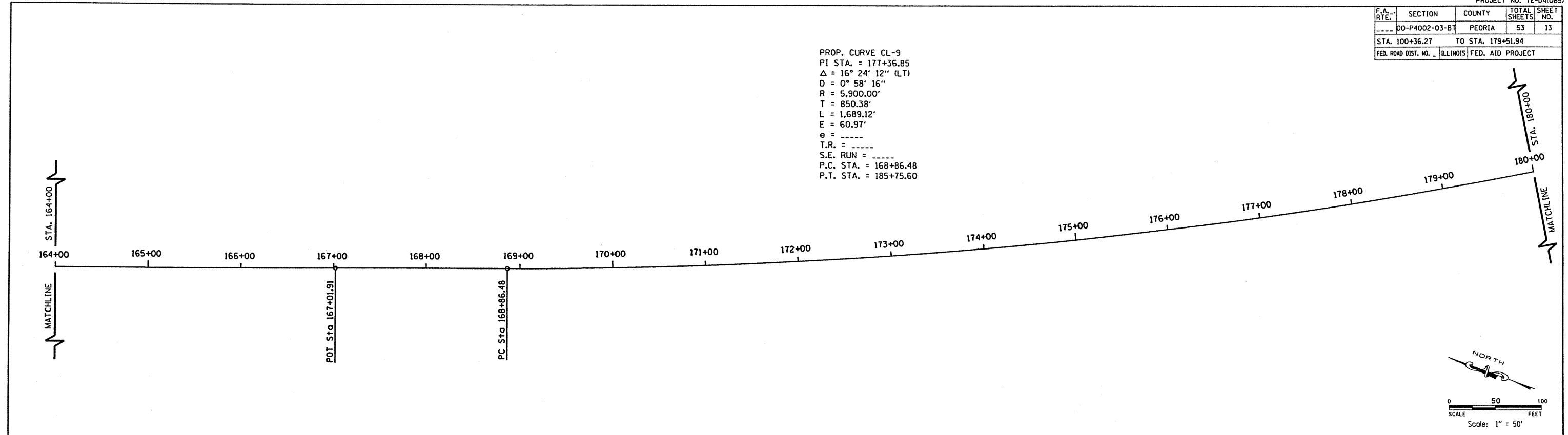

MAURER & STUTZ, INC.
 ENGINEERS SURVEYORS

REVISIONS	
NAME	DATE

ILLINOIS DEPARTMENT OF TRANSPORTATION

ALIGNMENT PLANS
 ROCK ISLAND/PIMITEOUI BIKE TRAIL
 SECTION 00-P4002-03-BT
 PEORIA COUNTY

SCALE: VERT. _____
 HORIZ. _____
 DATE _____

DRAWN BY _____
 CHECKED BY _____