

- LEGEND**
- CONSTRUCTION WORK ZONE
 - DRUM, BARRICADE, OR CHANNELIZER CONE WITH STEADY BURN LIGHTS (PLACED AT 25' CENTERS)
 - TYPE III BARRICADE WITH FLASHING LIGHTS
 - DIRECTION OF TRAFFIC

- KEY NOTES**
- (A) THE CONTRACTOR SHALL PROVIDE "NO LEFT TURN" SIGNS AT BAUGH DRIVE AND ANGELA DRIVE AS SHOWN ON THE TRAFFIC CONTROL PLAN AND AS DIRECTED BY THE ENGINEER. TURN PROHIBITION SIGNS SHALL BE USED FOR THE DURATION OF STAGE I CONSTRUCTION OR AS DIRECTED BY THE ENGINEER.
 - (B) THE CONTRACTOR SHALL PROVIDE ADDITIONAL TYPE III BARRICADES, "NO LEFT TURN" SIGNS AND "ONE WAY" SIGNS FOR THE EXISTING ENTRANCE AT STA. 35+18.9 LT. ON VERNON AVENUE AS SHOWN ON THE TRAFFIC CONTROL PLAN OR AS DIRECTED BY THE ENGINEER.
 - (C) THE EXISTING ENTRANCE SHALL BE CLOSED FOR THE DURATION OF STAGE I CONSTRUCTION OR AS DIRECTED BY THE ENGINEER. IMPACTED RESIDENTS SHALL BE PROVIDED ON-STREET PARKING AS DIRECTED BY THE ENGINEER.

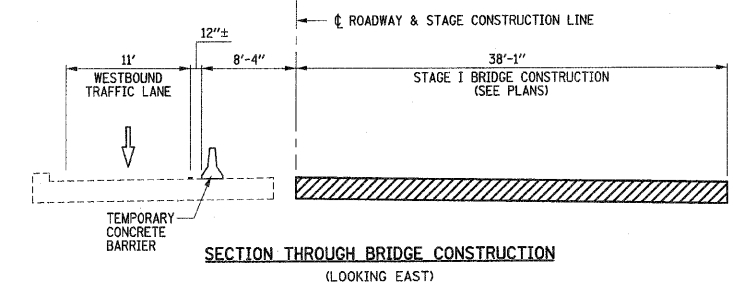

PAVEMENT MARKING TAPE
TYPE III 4" (YELLOW)
= 995 FOOT

TEMPORARY CONCRETE BARRIER = 687.5 FOOT
SEE STANDARDS 701321 AND 704001

140' TAPER (STANDARD 701606)
FROM STA. 42+50, 9.3' LT.
TO STA. 43+90

- SUGGESTED STAGE I CONSTRUCTION SEQUENCE**
1. CLOSE BROOKWOOD DRIVE AND KATHLEEN DRIVE AT VERNON AVENUE IN ACCORDANCE WITH STANDARD BLR 21. CLOSE EASTBOUND VERNON AVENUE TO ALL THRU TRAFFIC AT BLAIR DRIVE IN ACCORDANCE WITH STANDARD BLR 22. CLOSE EASTBOUND VERNON AVENUE TO ALL TRAFFIC AT BAUGH DRIVE IN ACCORDANCE WITH STANDARD BLR 21. CLOSE EASTBOUND VERNON AVENUE TO ALL TRAFFIC AT ANGELA DRIVE IN ACCORDANCE WITH STANDARD 701901.
 2. REDUCE WESTBOUND VERNON AVENUE TO ONE THRU LANE AT ANGELA DRIVE IN ACCORDANCE WITH STANDARD 701606 AND AS SHOWN ON THE TRAFFIC CONTROL PLAN. PROVIDE A "REDUCED SPEED AHEAD" SIGN IN ADVANCE OF THE "ROAD CONSTRUCTION AHEAD" SIGN REQUIRED FOR STANDARD 701606. PROVIDE A CONSTRUCTION SPEED LIMIT SIGN ASSEMBLY BETWEEN THE "ROAD CONSTRUCTION AHEAD" AND "LEFT LANE CLOSED AHEAD" SIGNS REQUIRED FOR STANDARD 701606. THE SIGN SPACING SHALL BE IN ACCORDANCE WITH STANDARD 701606. PROVIDE AN ADDITIONAL CONSTRUCTION SPEED LIMIT SIGN ASSEMBLY AT ANGELA DRIVE AS DIRECTED BY THE ENGINEER. PROVIDE AN "END WORK ZONE SPEED LIMIT" SIGN FOR WESTBOUND VERNON AVENUE AS DIRECTED BY THE ENGINEER. PROVIDE "ROAD CONSTRUCTION AHEAD" SIGNS ON BAUGH DRIVE, BROOKWOOD DRIVE, SHERIDAN ROAD, ETHELL PARKWAY, KATHLEEN DRIVE, ANGELA DRIVE AND OTHER SIDE STREETS IN ACCORDANCE WITH STANDARD 701606 AND AS DIRECTED BY THE ENGINEER.
 3. PROVIDE TEMPORARY CONCRETE BARRIER AND A TEMPORARY IMPACT ATTENUATOR IN ACCORDANCE WITH THE DETAILS SHOWN ON STANDARD 701321. PROVIDE ADDITIONAL TYPE III BARRICADES WITH FLASHING LIGHTS AS SHOWN ON STANDARD 701321.
 4. CLOSE EXISTING CONSTITUTION TRAIL AND THE EXISTING SIDEWALKS ON VERNON AVENUE, BROOKWOOD DRIVE, AND KATHLEEN DRIVE WITHIN THE PROJECT LIMITS IN ACCORDANCE WITH STANDARD 701801, THE PROPOSED DETOUR PLAN, AND AS DIRECTED BY THE ENGINEER.
 5. CONSTRUCT THE SOUTH HALF OF THE BRIDGE ON VERNON AVENUE. REFER TO THE PROPOSED BRIDGE PLANS FOR ADDITIONAL INFORMATION.
 6. CONSTRUCT THE STORM DRAINAGE AND WATER MAIN IMPROVEMENTS WITHIN THE STAGE I LIMITS. THE WATER MAIN SHOULD BE CONSTRUCTED TO APPROXIMATELY 3 FEET NORTH OF THE CENTERLINE OF VERNON AVENUE DURING THIS STAGE. REFER TO THE PROPOSED WATER MAIN PLANS FOR ADDITIONAL INFORMATION. THE CONTRACTOR SHALL TEMPORARILY PLUG THE PROPOSED STORM SEWERS WHOSE OUTLETS ARE NOT CONSTRUCTED DURING STAGE I.
 7. CONSTRUCT THE PROPOSED IMPROVEMENTS ON THE SOUTH HALF OF VERNON AVENUE FROM STA. 34+05 TO STA. 43+05.

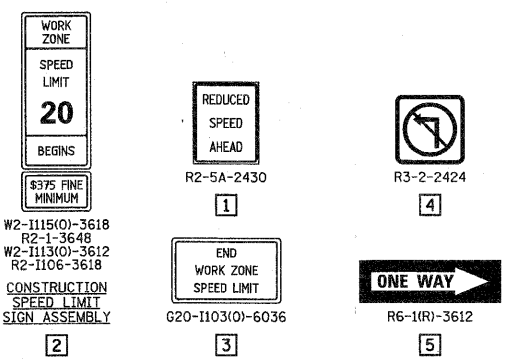

SIGN	STATION	OFFSET SIDE	NOTES
SIGN 1 (SEE SIGN DETAILS)	53+90	LT	SEE NOTE 2
ROAD CONSTRUCTION AHEAD	51+90	LT	SEE STANDARD 701606
SIGN 2 (SEE SIGN DETAILS)	49+90	LT	SEE NOTE 2
LEFT LANE CLOSED AHEAD	47+90	LT	SEE STANDARD 701606
WORKERS or FLAGGER	45+90	LT	SEE STANDARD 701606
SIGN 2 (SEE SIGN DETAILS)	43+90	LT	SEE NOTE 2
SIGN 3 (SEE SIGN DETAILS)	23+90	LT	SEE NOTE 2
SIGN 4 (SEE SIGN DETAILS)	33+42	LT	SEE KEY NOTE A
SIGN 4 (SEE SIGN DETAILS)	44+35	RT	SEE KEY NOTE A
SIGN 4 (SEE SIGN DETAILS)	35+18.9	LT	SEE KEY NOTE B
SIGN 5 (SEE SIGN DETAILS)	35+18.9	LT	SEE KEY NOTE B

NOTES:
THE ADDITIONAL TRAFFIC CONTROL DEVICES REQUIRED FOR THIS STAGE SHALL BE INCLUDED IN THE LUMP SUM PRICE OF TRAFFIC CONTROL COMPLETE.
THE CONTRACTOR SHALL PROVIDE TEMPORARY DRAINAGE AS REQUIRED DURING THIS STAGE. THIS WORK SHALL BE INCLUDED IN THE LUMP SUM PRICE OF TRAFFIC CONTROL COMPLETE.

FILE NAME = p:\n0240062\plans\sheet\11top.dgn
PLOT DATE = 6/5/2010 5:00:36 PM

DESIGNED - SMW	REVISED -
DRAWN - SMW	REVISED -
CHECKED - JAJ	REVISED -
DATE - 06/2010	REVISED -

STATE OF ILLINOIS
DEPARTMENT OF TRANSPORTATION

TRAFFIC CONTROL PLANS
STAGE I

F.A.U. RTE.	SECTION	COUNTY	TOTAL SHEETS	SHEET NO.
6354	06-00230-00-BR	MCLEAN	64	17

VERNON AVENUE, TOWN OF NORMAL CONTRACT NO. 91430
FED. ROAD DIST. NO. 5 ILLINOIS FED. AID PROJECT