

SEC. 35, T.24N., R.2E., 3rd P.M.
MCLEAN COUNTY, ILLINOIS

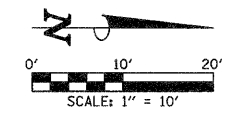
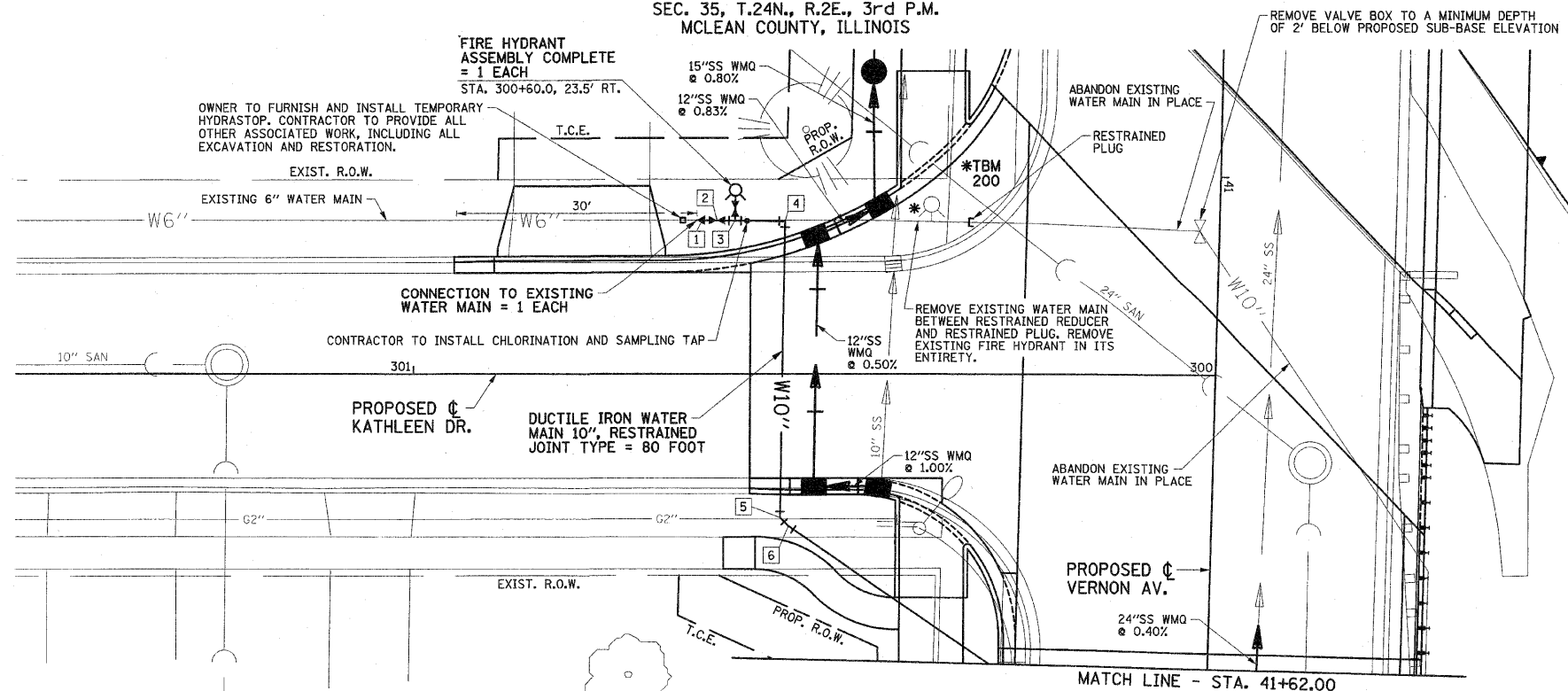

ABANDONMENT OF EXISTING WATER MAINS = 1 L SUM
STA. 300+64.2 RT. TO STA. 42+52.4 LT.

- NOTES:
- THE CONTRACTOR SHALL INSTALL TEMPORARY CHLORINATION AND SAMPLING TAPS AT THE LOCATIONS SHOWN ON THE PLANS OR AS OTHERWISE DIRECTED BY THE ENGINEER.
 - THE CONTRACTOR SHALL EXCAVATE AND RESTRAIN 20' OR 30' (AS SHOWN ON THE DRAWINGS) MINIMUM OF THE EXISTING WATER MAINS BEYOND THE PROPOSED CONNECTIONS TO THE EXISTING WATER MAINS.
 - THE CONTRACTOR SHALL VERIFY DEPTHS PRIOR TO CONSTRUCTION. WHEN CONNECTIONS ARE TO BE MADE TO EXISTING PIPING AND FITTINGS, THE LOCATION AND ELEVATION OF THE EXISTING PIPING SHALL BE FIELD DETERMINED AND THE APPROPRIATE ADJUSTMENTS MADE.
 - THE CONTRACTOR SHALL PROVIDE ALL PIPING & GASKETS, FITTINGS, AND HARDWARE NECESSARY TO EXISTING WATER MAINS.
 - AFTER WATER MAIN PIPING HAS BEEN INSTALLED AND DISINFECTED, THE CONTRACTOR SHALL COORDINATE WITH THE OWNER BEFORE CONNECTING TO THE EXISTING WATER MAINS. THE OWNER WILL OPERATE THE EXISTING VALVES AND HYDRASTOPS ADJACENT TO THE PROPOSED CONNECTIONS. THE CONTRACTOR SHALL REMOVE THE SECTIONS OF THE EXISTING PIPING AND CONNECT TO THE EXISTING WATER MAINS AS SHOWN.
- SUGGESTED CONSTRUCTION SEQUENCE:
- CONSTRUCT THE WATER MAIN IMPROVEMENTS WITHIN THE STAGE I LIMITS AND TO APPROXIMATELY 3 FEET NORTH OF THE CENTERLINE OF VERNON AVENUE. TEMPORARILY PLUG THE PROPOSED WATER MAIN NORTH OF THE CENTERLINE. PERFORM PRESSURE TEST ON THE WATER MAIN IMPROVEMENTS CONSTRUCTED DURING STAGE I.
 - CONSTRUCT THE WATER MAIN IMPROVEMENTS WITHIN THE STAGE II LIMITS. PERFORM PRESSURE TEST ON THE WATER MAIN IMPROVEMENTS CONSTRUCTED DURING STAGE I AND STAGE II. DISINFECT THE ENTIRE WATER MAIN IMPROVEMENTS.
 - SEE THE TRAFFIC CONTROL PLANS FOR ADDITIONAL INFORMATION.

| # | STATION | OFFSET | FITTING |
|---|----------|-----------|------------------------------|
| 1 | 300+64.2 | 19.6' RT. | 10" x 6" RESTRAINED REDUCER |
| 2 | 300+62.2 | 19.6' RT. | GATE VALVE AND BOX, 10" |
| 3 | 300+60.0 | 19.6' RT. | 10" x 6" RESTRAINED TEE |
| 4 | 300+53.8 | 19.6' RT. | 10" - 90° RESTRAINED ELBOW |
| 5 | 300+54.2 | 18.0' LT. | 10" - 45° RESTRAINED ELBOW |
| 6 | 300+53.2 | 19.1' LT. | 10" - 11/4° RESTRAINED ELBOW |

| BILL OF MATERIALS | | | |
|-------------------|--|-------|----------------|
| CODE NUMBER | ITEM | UNIT | TOTAL QUANTITY |
| X0325846 | ABANDONMENT OF EXISTING WATER MAINS | L SUM | 1 |
| X0326983 | DUCTILE IRON WATER MAIN 10", RESTRAINED JOINT TYPE | FOOT | 235 |
| X0469600 | CONNECTION TO EXISTING WATER MAIN | EACH | 3 |
| X5640150 | FIRE HYDRANT ASSEMBLY COMPLETE | EACH | 1 |
| XX007524 | GATE VALVE AND BOX, 10" | EACH | 3 |

TBM 200: TOP CAP BOLT (NOT OPERATOR NUT) OF FIRE HYDRANT AT SW QUADRANT OF VERNON AVE. & KATHLEEN DR. INTERSECTION. ELEVATION = 786.99

VERTICAL DATUM BASED ON TOWN OF NORMAL RM 314-4 BEING A CHISELED SQUARE ATOP CENTER OF EAST CONCRETE RAIL OF BRIDGE ON TOWANDA AVE. BETWEEN VERNON AVE. AND BAUGH DR., ELEVATION = 796.44 (NGVD 1929 DATUM)

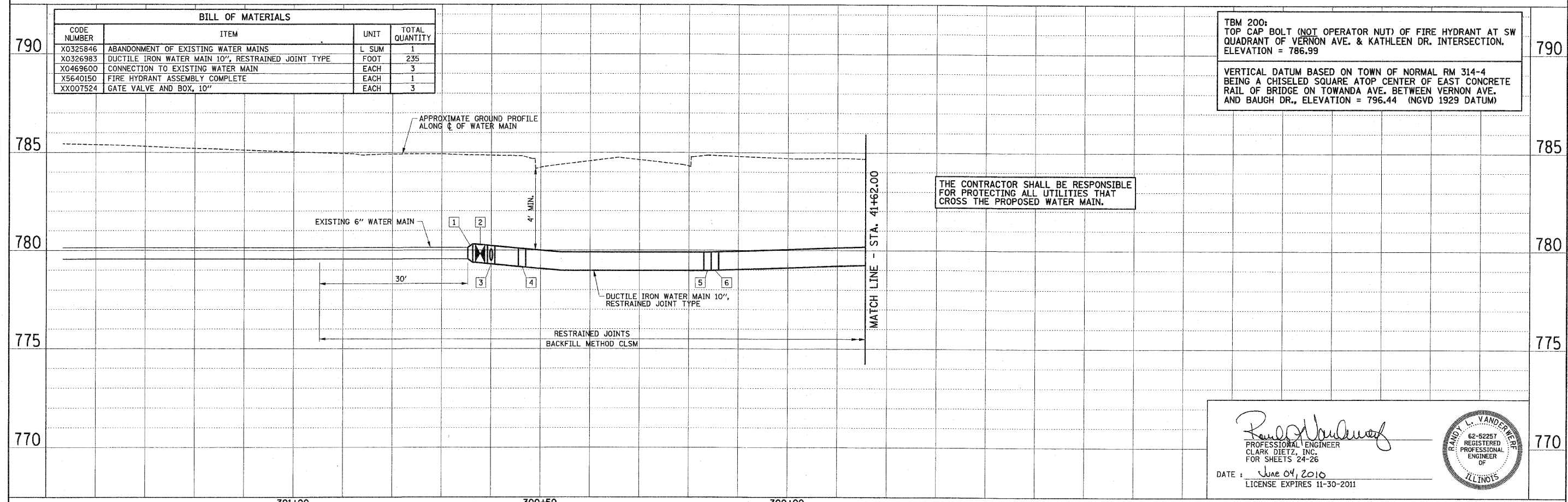

Randy L. Vanderweide
PROFESSIONAL ENGINEER
CLARK DIETZ, INC.
FOR SHEETS 24-26
DATE: June 04, 2010
LICENSE EXPIRES 11-30-2011

| | | | | | | | | | | |
|--|----------------|-----------|---|-----------------------------|--|----------------|--------|--------------|-----------|--|
| FILE NAME = p:\n0240062\plans\sheet110water.dgn | DESIGNED - RLV | REVISED - | STATE OF ILLINOIS DEPARTMENT OF TRANSPORTATION | WATER MAIN PLAN AND PROFILE | F.A.I. RTE. | SECTION | COUNTY | TOTAL SHEETS | SHEET NO. | |
| PLOT DATE = 6/5/2010 5:00:46 PM | DRAWN - JAJ | REVISED - | | | 6354 | 06-00230-00-BR | MCLEAN | 64 | 24 | |
| | CHECKED - RLV | REVISED - | | | VERNON AVENUE, TOWN OF NORMAL CONTRACT NO. 91430 | | | | | |
| | DATE - 06/2010 | REVISED - | | | FED. ROAD DIST. NO. 5 ILLINOIS FED. AID PROJECT | | | | | |