

STATE OF ILLINOIS
DEPARTMENT OF TRANSPORTATION

Notes:
Approach slab and parapet concrete shall be paid for as Concrete Superstructure.
Approach footing concrete shall be paid for as Concrete Structures.
Reinforcement shall be paid for as Reinforcement Bars, Epoxy Coated.
For $v_1(E)$ and $v_2(E)$ bar details, see sheet 18 of 26.
The approach footing maximum applied service bearing pressure (Q_{max}) = 2.0 ksf.
For bar splicer details, see sheet 24 of 26.
Cost of excavation for approach footing included with Concrete Structures.
For Porous Granular Embankment (Special) and drainage treatment details, see sheet 2 of 26.
For additional parapet details, see sheet 10 of 26.

* Tilt #9 $b_8(E)$ bars as required to maintain clearance.
*** Cost included with Concrete Superstructure.

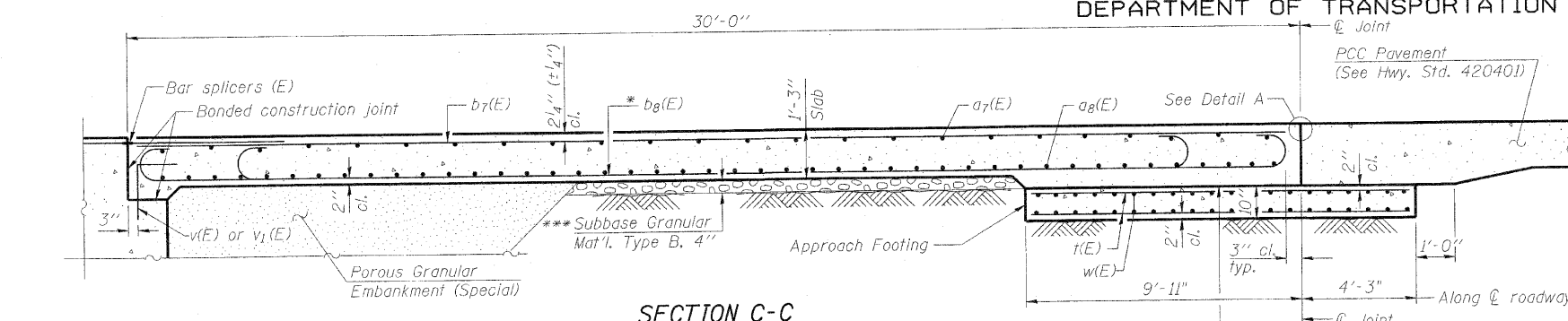

SECTION C-C

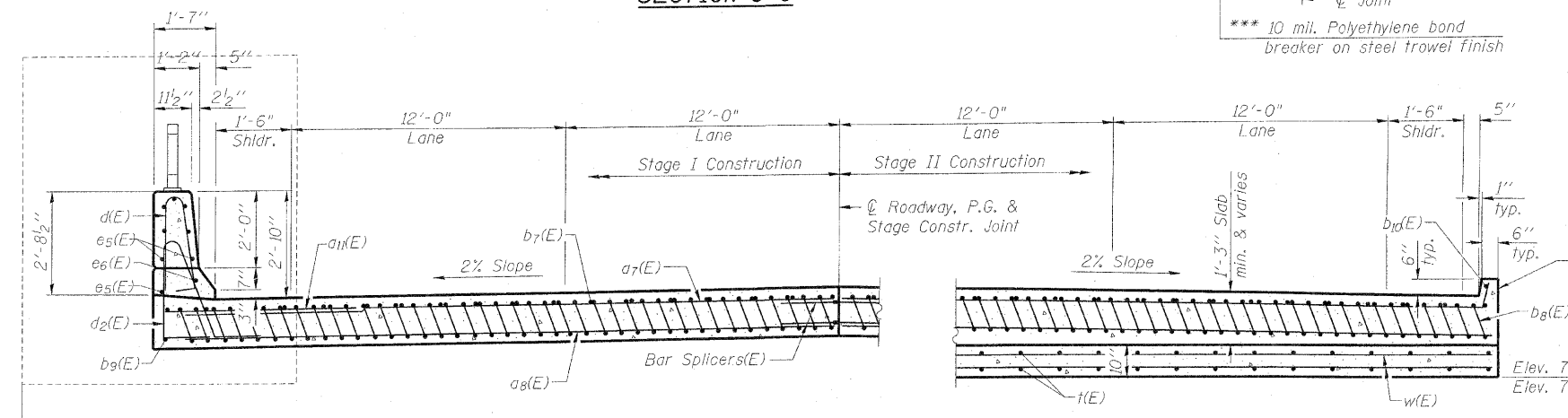

SECTION D-D

AT APPROACH FOOTING

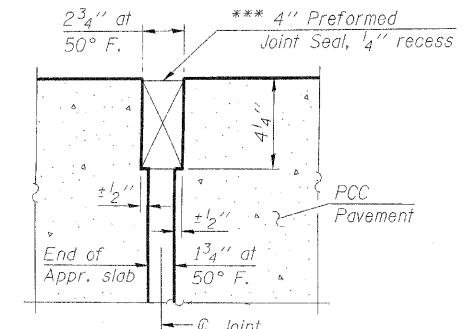

RIGID PAVEMENT

DETAIL A

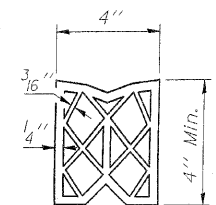

PREFORMED JOINT SEAL

WEST APPROACH
BILL OF MATERIAL

| Bar | No. | Size | Length | Shape |
|----------------------------------|---------|------|---------|-------|
| $a_7(E)$ | 50 | #4 | 37'-1" | — |
| $a_8(E)$ | 92 | #5 | 37'-0" | — |
| $a_{11}(E)$ | 24 | #6 | 6'-6" | — |
| $b_7(E)$ | 54 | #4 | 29'-8" | — |
| $b_8(E)$ | 126 | #9 | 29'-9" | — |
| $b_9(E)$ | 2 | #4 | 14'-8" | — |
| $b_{10}(E)$ | 2 | #4 | 15'-8" | — |
| $d(E)$ | 34 | #5 | 5'-7" | ▲ |
| $d_2(E)$ | 34 | #5 | 7'-11" | ▲ |
| $e_5(E)$ | 16 | #4 | 14'-8" | — |
| $e_6(E)$ | 2 | #8 | 14'-8" | — |
| $f(E)$ | 108 | #4 | 13'-10" | — |
| $w(E)$ | 80 | #5 | 37'-0" | — |
| Concrete Superstructure | Cu. Yd. | | 85.4 | |
| Concrete Structures | Cu. Yd. | | 23.1 | |
| Reinforcement Bars, Epoxy Coated | Pound | | 23,100 | |

(Sheet 2 of 2)
WEST APPROACH SLAB DETAILS
STRUCTURE NO. 057-7800

NEAR ABUTMENT
Southwest parapet shown, see section below for Northwest parapet details.

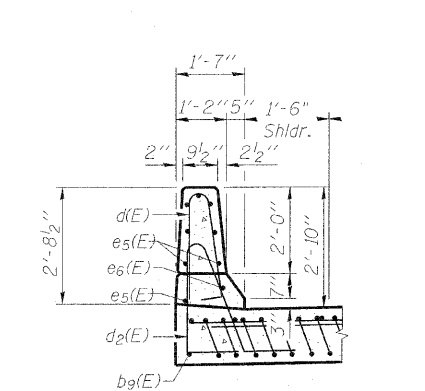

NORTHWEST PARAPET SECTION

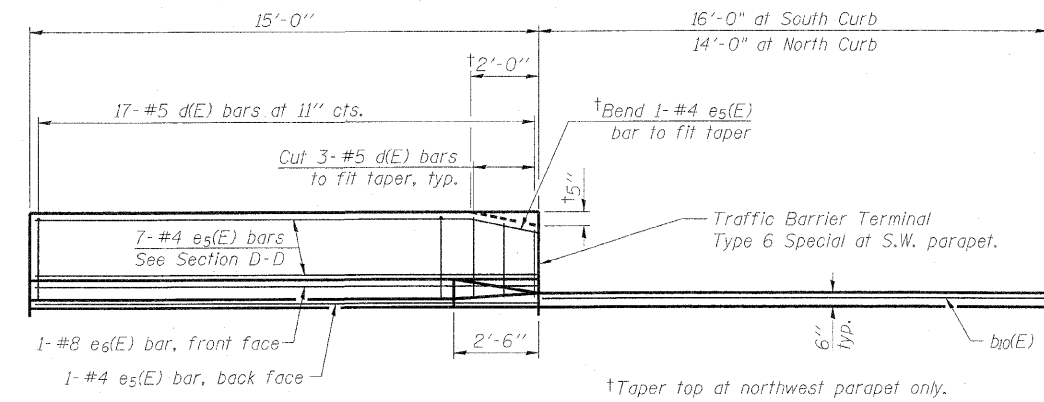

VIEW E-E

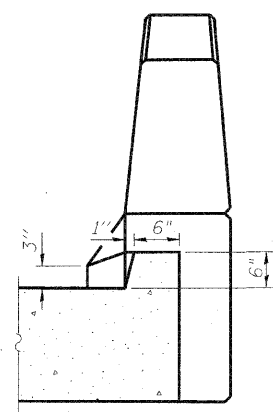

VIEW B-B

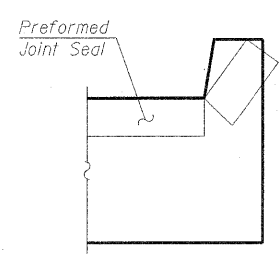

VIEW F-F

Angle Preformed Joint Seal at 45° at curbs when req'd for drainage.

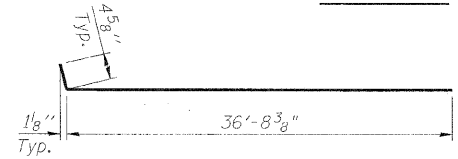

BAR $a_7(E)$

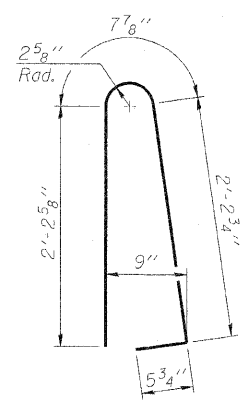

BAR $d(E)$

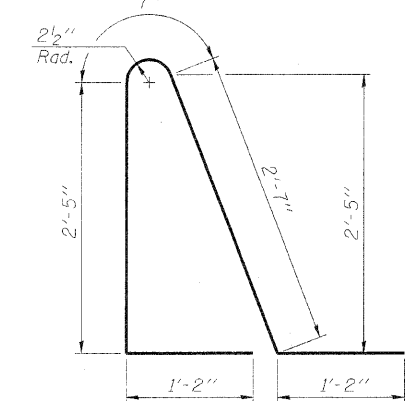

BAR $d_2(E)$

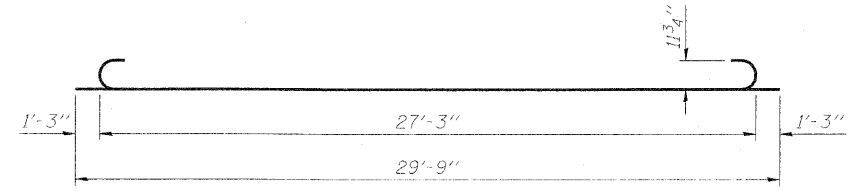

BAR $b_8(E)$

| | |
|----------|------|
| DESIGNED | SMM |
| CHECKED | MAES |
| DRAWN | SMM |
| CHECKED | MAES |

| | | | | | |
|---|-------------|-----------------|--------------------|--------------|-----------|
| SHEET NO.13 | F.A.U. RTE. | SECTION | COUNTY | TOTAL SHEETS | SHEET NO. |
| 26 SHEETS | 6354 | 06-002300-00-BR | MCLEAN | 64 | 42 |
| SN 057-7800 | | | CONTRACT NO. 91430 | | |
| FED. ROAD DIST. NO. 5 ILLINOIS FED. AID PROJECT | | | | | |