

PLANT SCHEDULE

QUANTITY	DESIGNATION	BOTANICAL NAME	COMMON NAME	SIZE
TREES				
3	AF	ACER x FREEMANII 'AUTUMN BLAZE'	AUTUMN BLAZE MAPLE	3" BB
3	AG	AMELANCHIER X GRANDIFLORA 'AUTUMN BRILLIANCE' - SINGLE STEM	AUTUMN BRILLIANCE SERVICEBERRY	2", BB TREE FORM
SHRUBS				
21	IGS	ILEX GLABRA 'SHAMROCK'	SHAMROCK INKBERRY HOLLY	5-GAL. 24" HT.
31	JSB	JUNIPERUS SABINA 'BUFFALO'	BUFFALO JUNIPER	3-GAL. WELL DEVELOPED
GROUNDCOVERS				
95	EP	ECHINACEA PURPUREA 'PIXIE MEADOWBRITE'	PIXIE MEADOWBRITE PURPLE CONEFLOWER	1-GAL. WELL DEVELOPED
66	HF	HOSTA 'FRANCEE'	FRANCEE HOSTA	1-GAL. WELL DEVELOPED
190	HBS	HEMEROCALLIS 'BLACK EYED STELLA'	BLACK EYED STELLA DAYLILY	1-GAL. WELL DEVELOPED
550	LS	LIRIOPE SPICATA	CREeping LILYTURF	1 QUART. WELL DEVELOPED
635	ND	NARCISSUS 'DUTCH MASTER'	DUTCH MASTER DAFFODIL	1 PREMIUM BULB
200	RFP	RUBBECKIA FULGIDA 'POT OF GOLD'	POT OF GOLD BLACK-EYED SUSAN	1-GAL. WELL DEVELOPED
144	SAJ	SEDUM 'AUTUMN JOY'	AUTUMN JOY SEDUM	1-GAL. WELL DEVELOPED
76	SH	SPOROBOLUS HETEROLEPIS 'TARA'	TARA DWARF PRAIRIE DROPSEED	1-GAL. WELL DEVELOPED

NOTES:

- CONTRACTOR TO VERIFY QUANTITIES ON THE PLAN PRIOR TO ORDERING PLANT MATERIAL.
- GROUNDCOVER PLANTING TO BE HELD 18" AWAY FROM TREE TRUNKS.
- ALL PLANTS AND PLANTING BEDS TO BE MULCH WITH 4" MEDIUM-TEXTURE HARDWOOD MULCH.
- PLANTERS TO BE FILLED AND MULCHED BY CONTRACTOR. PLANTERS TO BE PLANTED BY OTHERS.

LEGEND

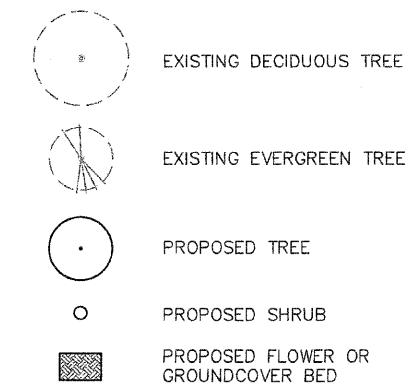

FILE NAME = \$FILEL\$	USER NAME = \$USER\$	DESIGNED - KM	REVISED 2-12-10	STATE OF ILLINOIS DEPARTMENT OF TRANSPORTATION	CITY OF RUSHVILLE DOWNTOWN BRICK ST. SQUARE RESTORATION PLAN PLANTING PLAN		F.A. - RTE. N/A	SECTION 05-00017-00-FP	COUNTY SCHUYLER	TOTAL SHEETS 49	SHEET NO. 38	
	PLOT SCALE = 1" = 20'	DRAWN - NFB	REVISED 8-11-10		SCALE: 1"=20'	SHEET NO. 38 OF 49 SHEETS	STA. _____ TO STA. _____	CONTRACT NO. 093541				
	PLOT DATE = 11-23-09	CHECKED - KM	REVISED -		FED. ROAD DIST. NO. _____ ILLINOIS FED. AID PROJECT							
		DATE - 11-23-09	REVISED -									