

**INDEX OF SHEETS**

- 1 COVER SHEET
- 2 SUMMARY OF QUANTITIES & TYPICAL SECTIONS

- STANDARDS:
- 701006-03 TRAFFIC CONTROL
  - 701306-02 TRAFFIC CONTROL
  - 701311-03 TRAFFIC CONTROL
  - 701301-03 TRAFFIC CONTROL
  - 701901-01 TRAFFIC CONTROL DEVICES
  - ~~720001-01 TRAFFIC CONTROL~~
  - ~~720006-02 TRAFFIC CONTROL DEVICES~~
  - 780001-02 PAVEMENT MARKINGS

STATE OF ILLINOIS  
 DEPARTMENT OF TRANSPORTATION  
 DIVISION OF HIGHWAYS  
 PLANS FOR PROPOSED  
 SURFACE TRANSPORTATION RURAL  
 AND AMERICAN RECOVERY & REINVESTMENT ACT PROJECT  
 CRAWFORD COUNTY  
 SECTION 10-00095-00-RS  
 FAS 696 (CH 6)  
 PROJECT ARA-RS-696(108)  
 JOB NO. C-97-004-11

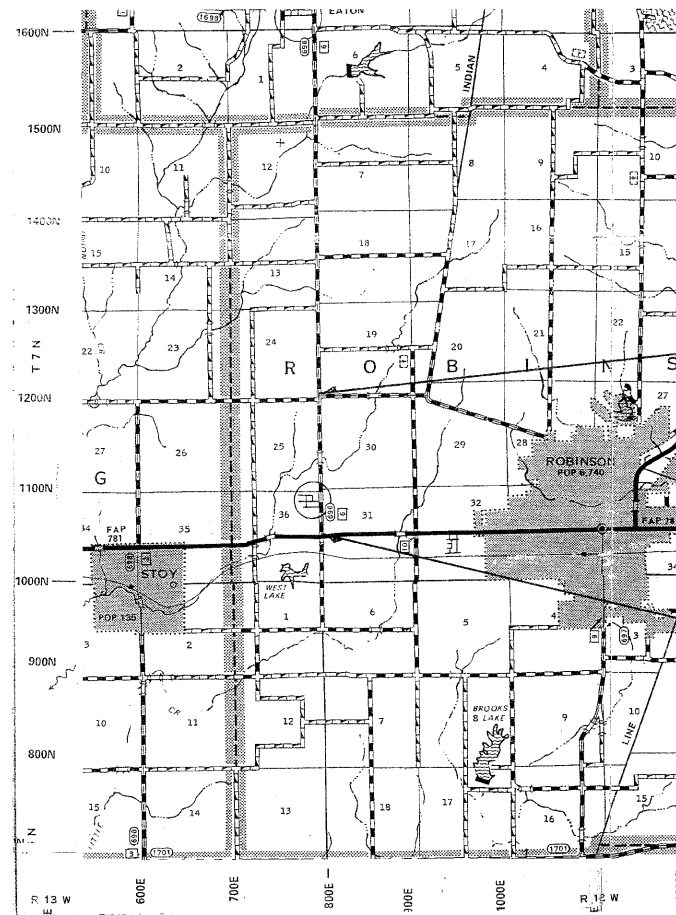

SECTION 10-00095-00-RS  
 ENDS STA. 83+00

SECTION 10-00095-00-RS  
 BEGINS STA. 0+93

FUNCTIONAL CLASS - RURAL MAJOR COLLECTOR  
 ADT = 1900  
 DESIGN SPEED = 60 MPH

**LOCATION MAP**

APPROXIMATE SCALE: 1 INCH = 1 MILE  
 NET LENGTH = 8,207 FEET = 1.554 MILES

TOLL FREE JOINT UTILITY LOCATING  
 INFORMATION FOR EXCAVATORS (J.U.L.I.E.)  
 TELEPHONE NO. 1-800-892-0123

CONNOR & CONNOR, INC.  
 PROFESSIONAL DESIGN FIRM #184-000832

*John A. Stone*  
  
 ILLINOIS REGISTERED PROFESSIONAL ENGINEER # 55012  
 LICENSE EXPIRES NOVEMBER 30, 2011  
 08/27/2010

ILLINOIS DEPARTMENT OF TRANSPORTATION
APPROVED: <u>August 31</u> , 2010 <i>Justin R. Child</i> CRAWFORD COUNTY ENGINEER
PASSED: <u>9/8</u> , 2010 <i>Maureen East</i> DISTRICT SEVEN ENGINEER OF LOCAL ROADS & STREETS
RELEASING FOR BID BASED ON LIMITED REVIEW <u>9/8</u> , 2010 <i>Roger L. Durbell</i> DEPUTY DIRECTOR OF HIGHWAYS, REGION FOUR ENGINEER