

STATE OF ILLINOIS
DEPARTMENT OF TRANSPORTATION

F.A.P. SITE	SECTION	COUNTY	TOTAL SHEETS	SHEET NO.
338	2020-122-1	WILL	22	1
		ILLINOIS	CONTRACT NO. 62M00	

FOR INDEX OF SHEETS, SEE SHEET NO. 2

THIS PROJECT IS LOCATED IN THE VILLAGE OF PLAINFIELD AND CITY NAPERVILLE

PROPOSED
HIGHWAY PLANS

FAP ROUTE 338: IL 59
DUPAGE CO LINE TO N OF PHEASANT CHASE DR
SECTION: 2020-122-1

CRACK AND JOINT SEALING
WILL COUNTY
C-91-320-20

TRAFFIC DATA:

IL 59:
ADT (2019) = 49300
SPEED LIMIT = 45 MPH

PROJECT ENDS
STA 352 + 71

PROJECT BEGINS
STA 15 + 05

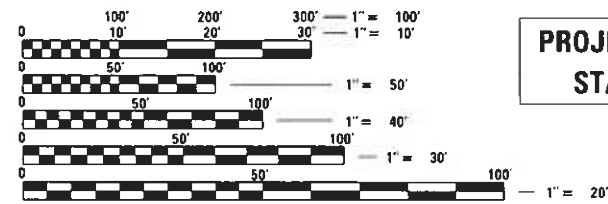

FULL SIZE PLANS HAVE BEEN PREPARED USING STANDARD ENGINEERING SCALES. REDUCED SIZED PLANS WILL NOT CONFORM TO STANDARD SCALES. IN MAKING MEASUREMENTS ON REDUCED PLANS, THE ABOVE SCALES MAY BE USED.

J.U.L.I.E.
JOINT UTILITY LOCATION INFORMATION FOR EXCAVATION
1-800-892-0123
OR 811

PROJECT ENGINEER: VESELIN VELICHKOV (847) 705-4432
PROJECT MANAGER: FAWAD AQUEEL (847) 705-4247

CONTRACT NO. 62M00

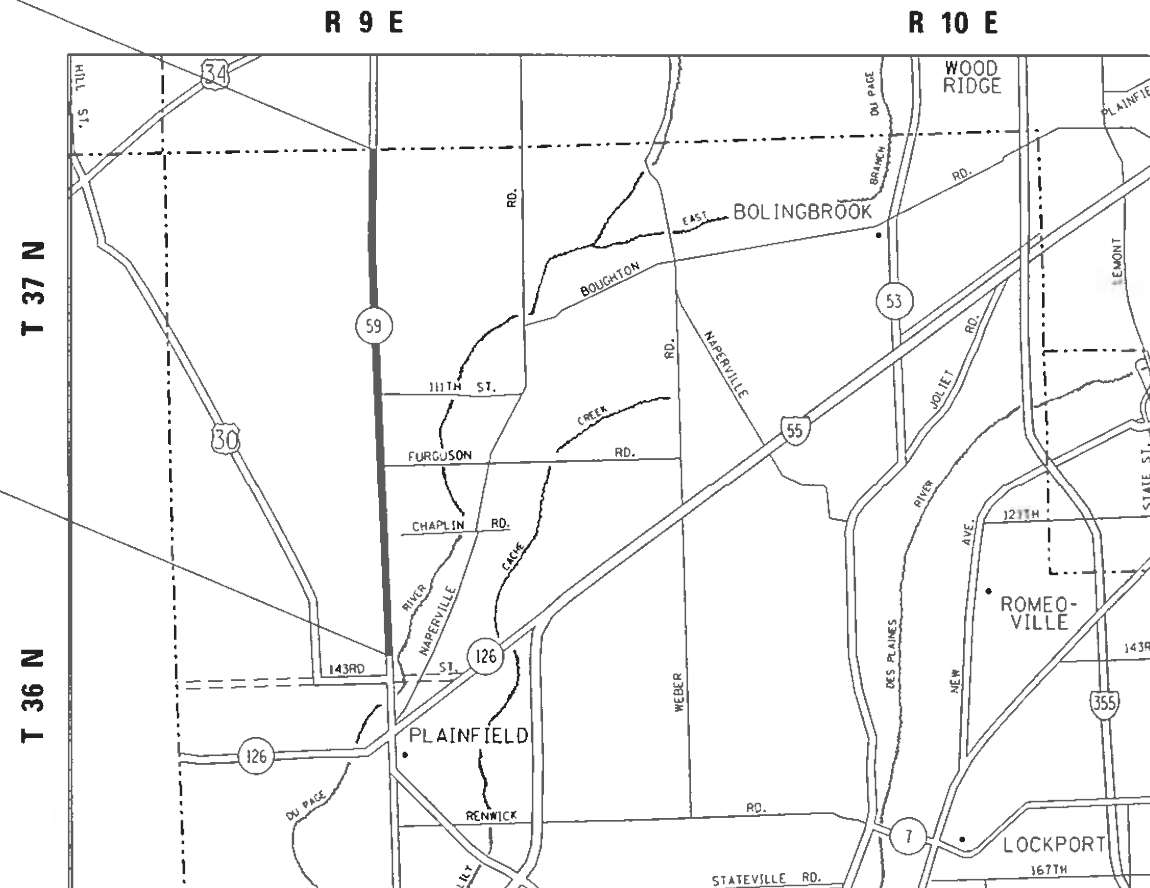

LOCATION MAP (NOT TO SCALE)

D-91-522-20

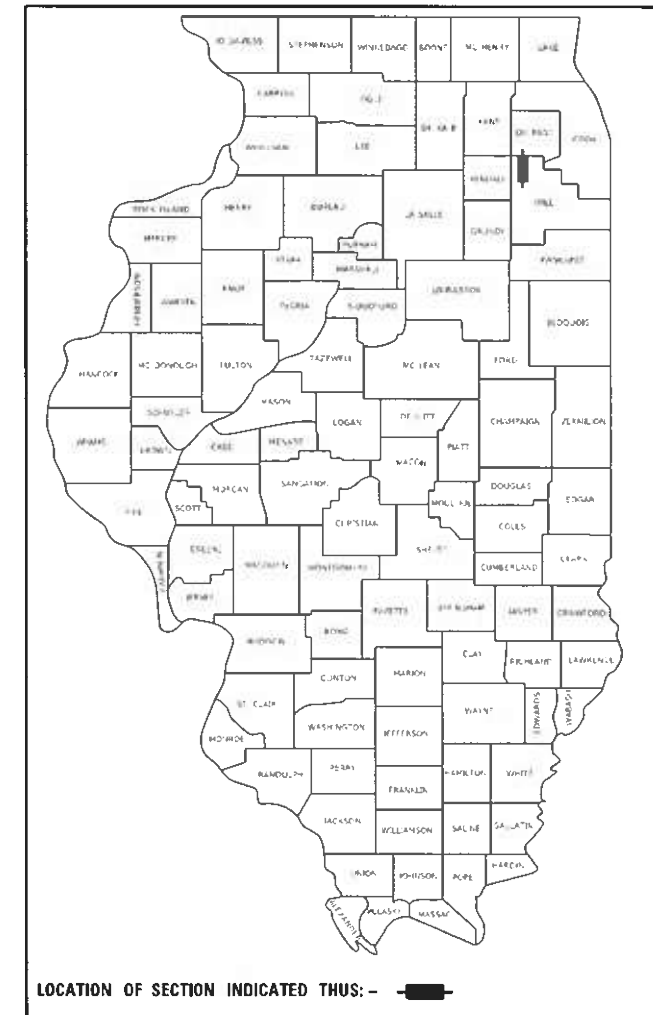

LOCATION OF SECTION INDICATED THUS: - [black rectangle]

STATE OF ILLINOIS
DEPARTMENT OF TRANSPORTATION
SUBMITTED July 28 2020
Andy J. Dringler / OAB REGIONAL ENGINEER
October 2, 2020
Scott A. Elk ENGINEER OF DESIGN AND ENVIRONMENT
October 2, 2020
James J. Gu DIRECTOR OF HIGHWAYS PROJECT IMPLEMENTATION

PRINTED BY THE AUTHORITY
OF THE STATE OF ILLINOIS

GROSS LENGTH = 33766 FT. = 6.395 MILES
NET LENGTH = 33766 FT. = 6.395 MILES

GENERAL NOTES

1. BEFORE STARTING ANY EXCAVATION, THE CONTRACTOR SHALL CALL "J.U.L.I.E". AT (800) 892-0123 OR 811 FOR FIELD LOCATIONS OF BURIED ELECTRIC, TELEPHONE AND GAS UTILITIES. 48 HOUR NOTIFICATION IS REQUIRED.
2. THE CONTRACTOR SHALL COORDINATE CONSTRUCTION ACTIVITIES WITH UTILITY COMPANIES OF THE CITY OF NAPERVILLE AND THE VILLAGE OF PLAINFIELD.
3. ALL DAMAGE TO EXISTING PAVEMENT MARKINGS OR RAISED REFLECTIVE PAVEMENT MARKERS OUTSIDE THE REMOVAL LINE SHOWN ON THE PLANS SHALL BE REPLACED AT NO ADDITIONAL COST TO THE DEPARTMENT.
4. THE CONTRACTOR WILL NOT BE ALLOWED TO SET UP A YARD OR FIELD OFFICE ON STATE PROPERTY WITHOUT WRITTEN PERMISSION FROM THE DEPARTMENT.
5. IT SHALL BE THE CONTRACTOR'S RESPONSIBILITY TO VERIFY ALL DIMENSIONS AND CONDITIONS EXISTING IN THE FIELD PRIOR TO CONSTRUCTION AND ORDERING OF MATERIALS.
6. THE CONTRACTOR SHALL CONTACT THE DISTRICT ONE TRAFFIC CONTROL SUPERVISOR AT KALPANA.KANNAN-HOSADURGA@ILLINOIS.GOV A MINIMUM OF 72 HOURS IN ADVANCE OF BEGINNING WORK.
7. THE ENGINEER SHALL CONTACT EMAD ALHUSSEINI AREA TRAFFIC FIELD ENGINEER AT EMAD.ALHUSSEINI@ILLINOIS.GOV A MINIMUM OF TWO (2) WEEKS PRIOR TO THE PLACEMENT OF PERMANENT PAVEMENT MARKINGS.
8. ALL CRACK ROUTING & CRACK SEALING LOCATIONS WILL BE DETERMINED IN THE FIELD BY THE ENGINEER. CRACK ROUTING SHALL BE OMITTED WHERE VEHICLE DETECTOR LOOPS & RAISED REFLECTIVE PAVEMENT MARKERS ARE PRESENT IN THE PAVEMENT.
9. MATERIALS RESULTING FROM THE ROUTING OF CRACKS IN THE EXISTING PAVEMENT MAY BE PLACED, SHAPED AND COMPACTED TO THE SATISFACTION OF THE ENGINEER ALONG EXISTING AGGREGATE SHOULDERS ADJACENT TO THE PAVEMENT. ALL MATERIALS RESULTING FROM THE ROUTING OF CRACKS IN PAVEMENTS WITHOUT AGGREGATE SHOULDERS AND SURPLUS MATERIALS RESULTING FROM THE ROUTING OF CRACKS IN PAVEMENTS WITH AGGREGATE SHOULDERS, WHERE ALL MATERIALS ARE NOT PLACED ALONG EXISTING AGGREGATE SHOULDERS, SHALL BE DISPOSED OF AS SPECIFIED IN ARTICLE 202.03 OF THE STANDARD SPECIFICATIONS.
10. MODIFIED URETHANE PAVEMENT MARKING SHALL BE PLACED IMMEDIATELY AFTER C & J SEALER TEMPERATURE HAS COOLED DOWN AND DOES NOT AFFECT THE APPLICATION OF THE MODIFIED URETHANE PAVEMENT MARKING.
11. DURING CONSTRUCTION OPERATIONS, IF ANY LOOSE MATERIAL IS DEPOSITED IN THE FLOW LINE OF DRAINAGE STRUCTURES SUCH THAT THE NATURAL FLOW OF WATER IS OBSTRUCTED, THE MATERIAL SHALL BE REMOVED AT THE CLOSE OF EACH WORKING DAY. AT THE CONCLUSION OF CONSTRUCTION OPERATION, ALL UTILITY STRUCTURES SHALL BE FREE FROM DUST AND DEBRIS. THE WORK SPECIFIED ABOVE WILL NOT BE PAID FOR SEPARATELY BUT SHALL BE INCLUDED IN THE COST OF THE CONTRACT.
12. DO NOT SCALE PLANS FOR CONSTRUCTION DIMENSIONS.
13. BEFORE BEGINNING ANY WORK, THE CONTRACTOR SHALL RETAIN AND RECORD FOR FUTURE REFERENCE, ALL EXISTING PAVEMENT MARKING LINES (AND RAISED REFLECTIVE PAVEMENT MARKERS) IN ORDER THAT THESE LOCATIONS CAN BE RE-ESTABLISHED FOR STRIPING. EXACT LOCATIONS OF ALL PAVEMENT MARKINGS SHALL BE AS DIRECTED BY THE ENGINEER.

INDEX OF SHEETS

<u>SHEET NO.</u>	<u>DESCRIPTION</u>
1	COVER SHEET
2	INDEX OF SHEETS, STATE STANDARDS AND GENERAL NOTES
3	SUMMARY OF QUANTITIES
4-16	PROPOSED ROADWAY AND PAVEMENT MARKING PLANS
17	CRACK AND JOINT SEALING DETAIL
18	CURB OR CURB AND GUTTER REMOVAL AND REPLACEMENT (BD-24)
19	TRAFFIC CONTROL AND PROTECTION FOR SIDE ROADS, INTERSECTIONS, AND DRIVEWAYS (TC-10)
20	DISTRICT ONE TYPICAL PAVEMENT MARKINGS (TC-13)
21	TRAFFIC CONTROL AND PROTECTION AT TURN BAYS (TO REMAIN OPEN TO TRAFFIC) (TC-14)
22	ARTERIAL ROAD INFORMATION SIGNING (TC-22)

STATE STANDARDS

000001-07	STANDARD SYMBOLS, ABBREVIATIONS AND PATTERNS
442101-09	CLASS B PATCHES
606001-07	CONCRETE CURB TYPE B AND COMBINATION CONCRETE CURB AND GUTTER
701101-05	OFF-ROAD OPERATIONS, MULTILANE, 15' TO 24" FROM PAVEMENT EDGE
701426-09	LANE CLOSURE, MULTILANE, INTERMITTENT OR MOVING OPERATION, FOR SPEEDS ≥ 45 MPH
701601-09	URBAN LANE CLOSURE, MULTILANE, 1W OR 2W WITH NONTRAVERSABLE MEDIAN
701701-10	URBAN LANE CLOSURE, MULTILANE INTERSECTION
701801-06	SIDEWALK, CORNER OR CROSSWALK CLOSURE
701901-08	TRAFFIC CONTROL DEVICES

**STATE OF ILLINOIS
DEPARTMENT OF TRANSPORTATION**

**IL 59 (DUPAGE CO LINE TO N OF PHEASANT CHASE DR)
INDEX OF SHEETS, STATE STANDARDS & GENERAL NOTES**

SCALE: SHEET OF SHEETS STA. TO STA.

F.A.P. RTE.	SECTION	COUNTY	TOTAL SHEETS	SHEET NO.
338	2020-122-I	WILL	22	2
				CONTRACT NO. 62M00
		ILLINOIS	FED. AID PROJECT	

SUMMARY OF QUANTITIES				CONSTRUCTION TYPE CODE					SUMMARY OF QUANTITIES				CONSTRUCTION TYPE CODE				
CODE NO	ITEM	UNIT	TOTAL QUANTITIES URBAN	100% STATE 0005					CODE NO	ITEM	UNIT	TOTAL QUANTITIES URBAN	100% STATE 0005				
42001300	PROTECTIVE COAT	SO YD	2600	2600					* 78009000	MODIFIED URETHANE PAVEMENT MARKING - LETTERS AND SYMBOLS	SO FT	5526	5526				
44200050	WELDED WIRE REINFORCEMENT	SO YD	1316	1316					* 78009004	MODIFIED URETHANE PAVEMENT MARKING - LINE 4"	FOOT	21489	21489				
44200970	CLASS B PATCHES, TYPE II, 10 INCH	SO YD	658	658					* 78009006	MODIFIED URETHANE PAVEMENT MARKING - LINE 6"	FOOT	36165	36165				
44200974	CLASS B PATCHES, TYPE III, 10 INCH	SO YD	658	658					* 78009008	MODIFIED URETHANE PAVEMENT MARKING - LINE 8"	FOOT	1964	1964				
44200976	CLASS B PATCHES, TYPE IV, 10 INCH	SO YD	658	658					* 78009012	MODIFIED URETHANE PAVEMENT MARKING - LINE 12"	FOOT	6077	6077				
44201299	DOWEL BARS 1 1/2"	EACH	2412	2412					* 78009024	MODIFIED URETHANE PAVEMENT MARKING - LINE 24"	FOOT	2311	2311				
44213200	SAW CUTS	FOOT	3462	3462					X4400501	COMBINATION CURB AND GUTTER REMOVAL AND REPLACEMENT LESS THAN OR EQUAL TO 10 FEET	FOOT	2027	2027				
45200100	JOINT OR CRACK ROUTING (PC CONCRETE PAVEMENT AND SHOULDER)	FOOT	26129	26129					Z0004562	COMBINATION CONCRETE CURB AND GUTTER REMOVAL AND REPLACEMENT	FOOT	676	676				
45200300	JOINT OR CRACK FILLING	POUND	82116	82116					Z0030850	TEMPORARY INFORMATION SIGNING	SO FT	539.7	539.7				
67000400	ENGINEER'S FIELD OFFICE, TYPE A	CAL MO	12	12					Ø Z0076600	TRAINEES	HOURS	500	500				
67100100	MOBILIZATION	L SUM	1	1					Ø Z0076604	TRAINEES - TRAINING PROGRAM GRADUATE	HOURS	500	500				
70102630	TRAFFIC CONTROL AND PROTECTION, STANDARD 701601	L SUM	1	1													
70102635	TRAFFIC CONTROL AND PROTECTION, STANDARD 701701	L SUM	1	1													
70102640	TRAFFIC CONTROL AND PROTECTION, STANDARD 701801	L SUM	1	1													

Ø 0042
REV-SEP

* = SPECIALTY ITEMS

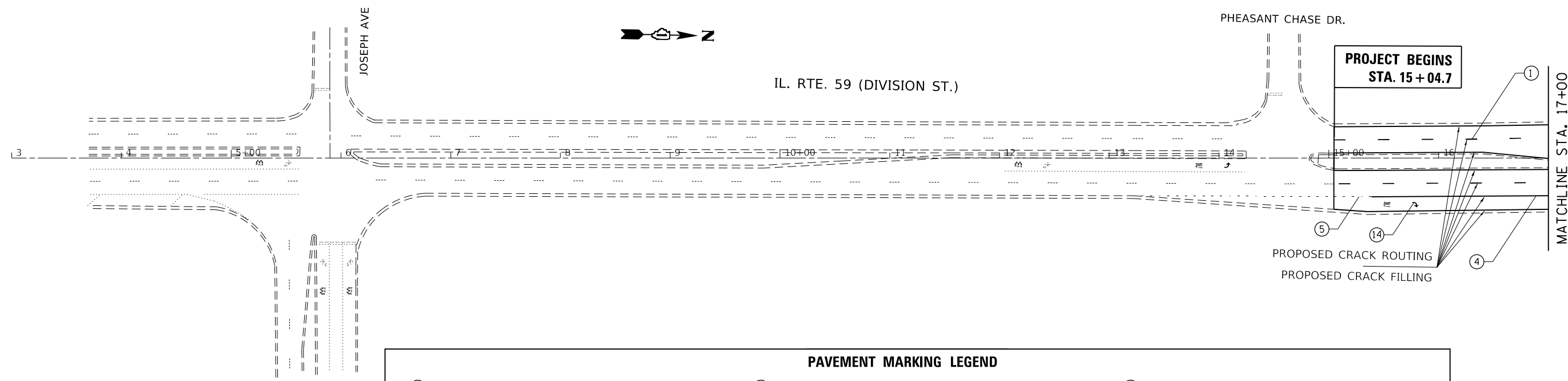

PAVEMENT MARKING LEGEND

① PROP. MODIFIED URETHANE PAVEMENT MARKING LINE, 4" SKIP DASH WHITE LANE LINE @ 30' SKIP & 10' DASH	⑥ PROP. MODIFIED URETHANE PAVEMENT MARKING LINE, 6" SOLID WHITE CROSSWALK LINE, 2 @ 6' C-C	⑪ PROP. MODIFIED URETHANE PAVEMENT MARKING LINE, 12" DIAGONAL SOLID YELLOW LINE @ 75' SPACING OR 5 MIN.
② PROP. MODIFIED URETHANE PAVEMENT MARKING LINE, 4" SOLID WHITE LINE	⑦ PROP. MODIFIED URETHANE PAVEMENT MARKING LINE, 8" SOLID WHITE GORE MARKING AND CHANNELIZING LINES	⑫ PROP. MODIFIED URETHANE PAVEMENT MARKING LINE, 12" DIAGONAL SOLID WHITE LINE @ 75' SPACING OR 5 MIN.
③ PROP. MODIFIED URETHANE PAVEMENT MARKING LINE, 4" DOUBLE SOLID YELLOW LINE, 2 @ 11" C-C	⑧ PROP. MODIFIED URETHANE PAVEMENT MARKING LINE, 12" SOLID WHITE GORE MARKINGS @ 45 DEG.	⑬ PROP. MODIFIED URETHANE PAVEMENT MARKING LETTERS & SYMBOLS, SOLID WHITE
④ PROP. MODIFIED URETHANE PAVEMENT MARKING LINE, 6" SOLID WHITE TURN LANE	⑨ PROP. MODIFIED URETHANE PAVEMENT MARKING LINE, 12" SOLID WHITE LONGITUDINAL BAR @ 90°, 2' SPACING	⑭ PROP. MODIFIED URETHANE PAVEMENT MARKING LINE, 24" SOLID WHITE STOP BAR
⑤ PROP. MODIFIED URETHANE PAVEMENT MARKING LINE, 6" SKIP DASH WHITE TURN LANE @ 6' SKIP & 2' DASH	⑩ PROP. MODIFIED URETHANE PAVEMENT MARKING LINE, 12" SOLID WHITE LONGITUDINAL BAR @ 45°, 2' SPACING	⑮ PROP. MODIFIED URETHANE PAVEMENT MARKING LINE, 6" SOLID WHITE GORE MARKING AND CHANNELIZING LINES

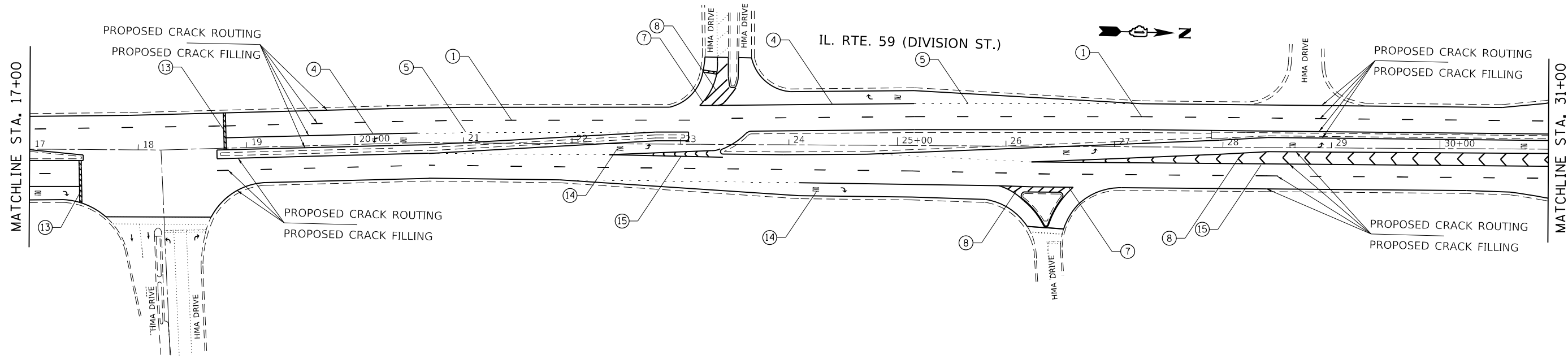

MODEL: Default
 FILE: \\blm1c:\pub\lancorn\dat\illinois.gov\PI\DOT\Documents\IBDOT\Office\lancorn\1\Projects\152220\CaddData\Design\152220-01c-pav.dgn

USER NAME = elkhatibaj	DESIGNED -	REVISED -
PLOT SCALE = 100,0000' / in.	DRAWN -	REVISED -
PLOT DATE = 8/14/2020	CHECKED -	REVISED -
	DATE -	REVISED -

**STATE OF ILLINOIS
DEPARTMENT OF TRANSPORTATION**

IL 59 (DUPAGE CO LINE TO N OF PHEASANT CHASE DR) PROPOSED ROADWAY AND PAVEMENT MARKING PLANS			
SCALE: 1"=50'	SHEET	OF	SHEETS
	STA. 13+21.7	TO	STA. 31+00

F.A.P. RTE.	SECTION	COUNTY	TOTAL SHEETS	SHEET NO.
338	2020-122-I	WILL	22	4
CONTRACT NO. 62M00				
ILLINOIS FED. AID PROJECT				

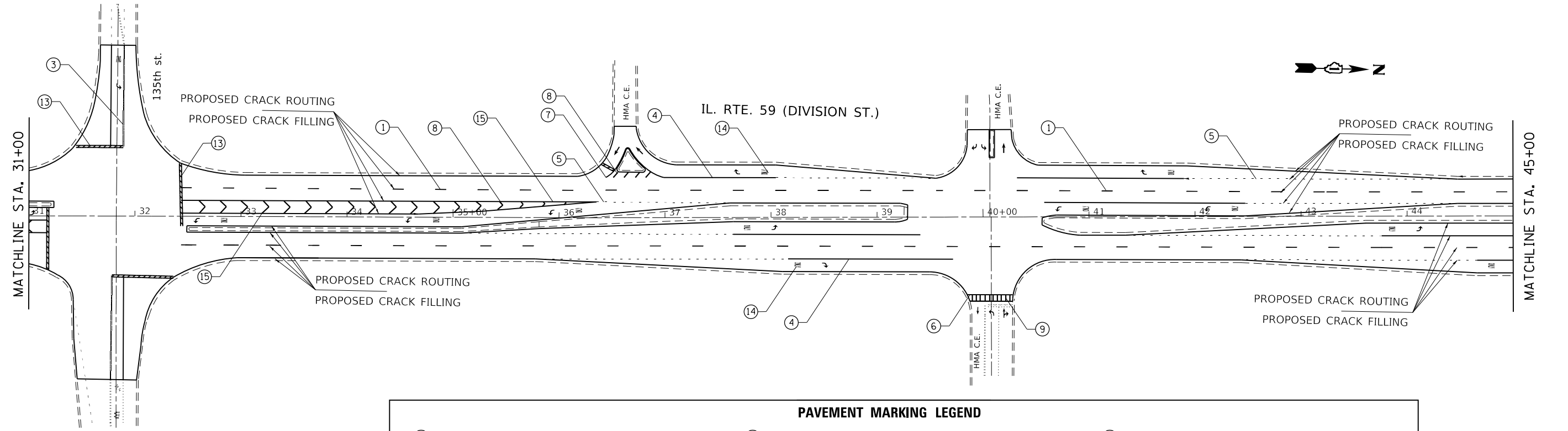

PAVEMENT MARKING LEGEND

<ul style="list-style-type: none"> ① PROP. MODIFIED URETHANE PAVEMENT MARKING LINE, 4" SKIP DASH WHITE LANE LINE @ 30' SKIP & 10' DASH ② PROP. MODIFIED URETHANE PAVEMENT MARKING LINE, 4" SOLID WHITE LINE ③ PROP. MODIFIED URETHANE PAVEMENT MARKING LINE, 4" DOUBLE SOLID YELLOW LINE, 2 @ 11" C-C ④ PROP. MODIFIED URETHANE PAVEMENT MARKING LINE, 6" SOLID WHITE TURN LANE ⑤ PROP. MODIFIED URETHANE PAVEMENT MARKING LINE, 6" SKIP DASH WHITE TURN LANE @ 6' SKIP & 2' DASH 	<ul style="list-style-type: none"> ⑥ PROP. MODIFIED URETHANE PAVEMENT MARKING LINE, 6" SOLID WHITE CROSSWALK LINE, 2 @ 6' C-C ⑦ PROP. MODIFIED URETHANE PAVEMENT MARKING LINE, 8" SOLID WHITE GORE MARKING AND CHANNELIZING LINES ⑧ PROP. MODIFIED URETHANE PAVEMENT MARKING LINE, 12" SOLID WHITE GORE MARKINGS @ 45 DEG. ⑨ PROP. MODIFIED URETHANE PAVEMENT MARKING LINE, 12" SOLID WHITE LONGITUDINAL BAR @ 90°, 2' SPACING ⑩ PROP. MODIFIED URETHANE PAVEMENT MARKING LINE, 12" SOLID WHITE LONGITUDINAL BAR @ 45°, 2' SPACING 	<ul style="list-style-type: none"> ⑪ PROP. MODIFIED URETHANE PAVEMENT MARKING LINE, 12" DIAGONAL SOLID YELLOW LINE @ 75' SPACING OR 5 MIN. ⑫ PROP. MODIFIED URETHANE PAVEMENT MARKING LINE, 12" DIAGONAL SOLID WHITE LINE @ 75' SPACING OR 5 MIN. ⑬ PROP. MODIFIED URETHANE PAVEMENT MARKING LETTERS & SYMBOLS, SOLID WHITE ⑭ PROP. MODIFIED URETHANE PAVEMENT MARKING LINE, 24" SOLID WHITE STOP BAR ⑮ PROP. MODIFIED URETHANE PAVEMENT MARKING LINE, 6" SOLID WHITE GORE MARKING AND CHANNELIZING LINES
--	---	--

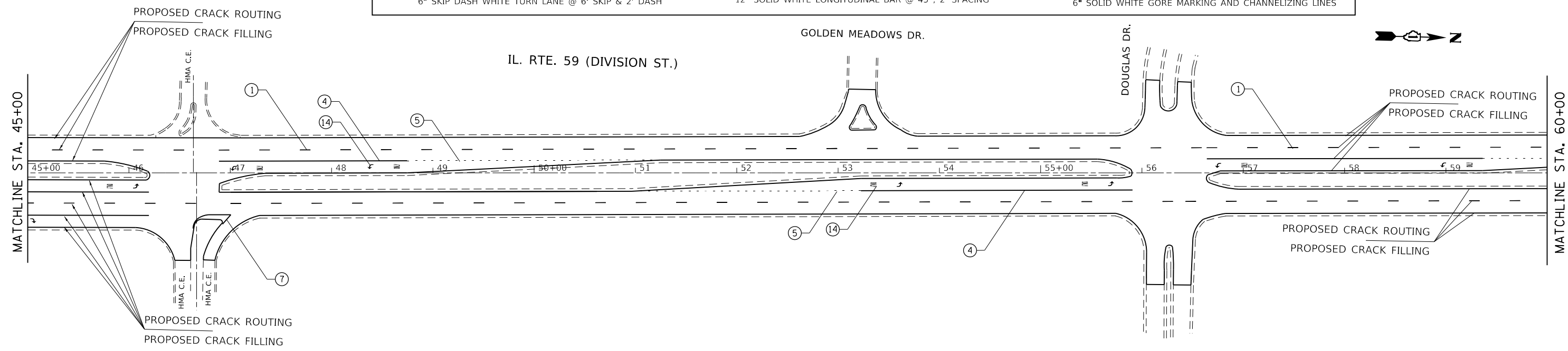

MODEL: Default
 FILE: \\blm1c:\pub\blmroom\dat\illinois\pwr\WIDOT\Documents\DOT_Offices\blm1c\1\Projects\152220\CaddData\Design\152220-01c-pblm.dgn

USER NAME = elkhatibaj	DESIGNED -	REVISED -
	DRAWN -	REVISED -
PLOT SCALE = 100,0000' / in.	CHECKED -	REVISED -
PLOT DATE = 8/14/2020	DATE -	REVISED -

**STATE OF ILLINOIS
DEPARTMENT OF TRANSPORTATION**

IL 59 (DUPAGE CO LINE TO N OF PHEASANT CHASE DR) PROPOSED ROADWAY AND PAVEMENT MARKING PLANS			
SCALE: 1"=50'	SHEET	OF SHEETS	STA. 31+00 TO STA. 60+00

F.A.P. RTE. 338	SECTION 2020-122-I	COUNTY WILL	TOTAL SHEETS 22	SHEET NO. 5
CONTRACT NO. 62M00				
ILLINOIS FED. AID PROJECT				

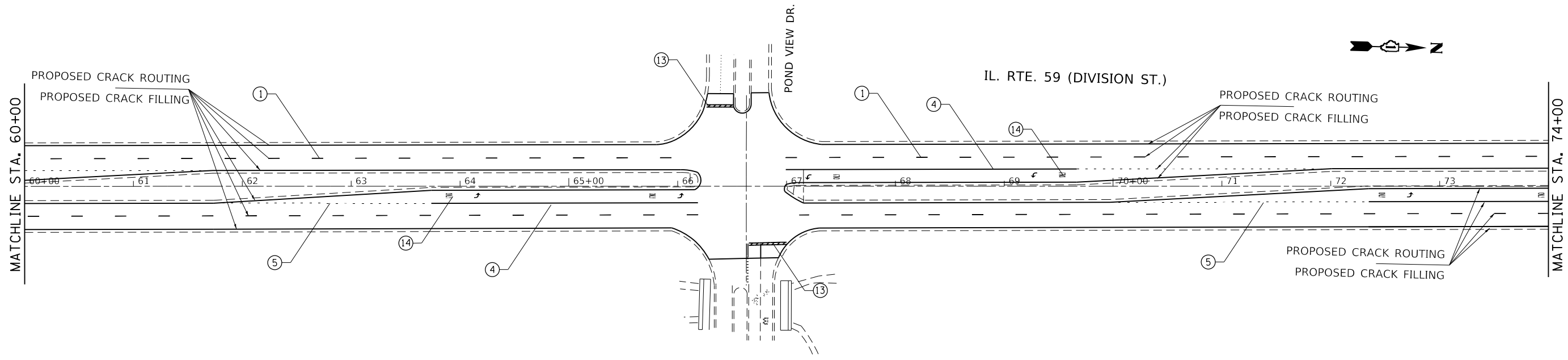

PAVEMENT MARKING LEGEND

<p>① PROP. MODIFIED URETHANE PAVEMENT MARKING LINE, 4" SKIP DASH WHITE LANE LINE @ 30' SKIP & 10' DASH</p> <p>② PROP. MODIFIED URETHANE PAVEMENT MARKING LINE, 4" SOLID WHITE LINE</p> <p>③ PROP. MODIFIED URETHANE PAVEMENT MARKING LINE, 4" DOUBLE SOLID YELLOW LINE, 2 @ 11" C-C</p> <p>④ PROP. MODIFIED URETHANE PAVEMENT MARKING LINE, 6" SOLID WHITE TURN LANE</p> <p>⑤ PROP. MODIFIED URETHANE PAVEMENT MARKING LINE, 6" SKIP DASH WHITE TURN LANE @ 6' SKIP & 2' DASH</p>	<p>⑥ PROP. MODIFIED URETHANE PAVEMENT MARKING LINE, 6" SOLID WHITE CROSSWALK LINE, 2 @ 6' C-C</p> <p>⑦ PROP. MODIFIED URETHANE PAVEMENT MARKING LINE, 8" SOLID WHITE GORE MARKING AND CHANNELIZING LINES</p> <p>⑧ PROP. MODIFIED URETHANE PAVEMENT MARKING LINE, 12" SOLID WHITE GORE MARKINGS @ 45 DEG.</p> <p>⑨ PROP. MODIFIED URETHANE PAVEMENT MARKING LINE, 12" SOLID WHITE LONGITUDINAL BAR @ 90°, 2' SPACING</p> <p>⑩ PROP. MODIFIED URETHANE PAVEMENT MARKING LINE, 12" SOLID WHITE LONGITUDINAL BAR @ 45°, 2' SPACING</p>	<p>⑪ PROP. MODIFIED URETHANE PAVEMENT MARKING LINE, 12" DIAGONAL SOLID YELLOW LINE @ 75' SPACING OR 5 MIN.</p> <p>⑫ PROP. MODIFIED URETHANE PAVEMENT MARKING LINE, 12" DIAGONAL SOLID WHITE LINE @ 75' SPACING OR 5 MIN.</p> <p>⑬ PROP. MODIFIED URETHANE PAVEMENT MARKING LETTERS & SYMBOLS, SOLID WHITE</p> <p>⑭ PROP. MODIFIED URETHANE PAVEMENT MARKING LINE, 24" SOLID WHITE STOP BAR</p> <p>⑮ PROP. MODIFIED URETHANE PAVEMENT MARKING LINE, 6" SOLID WHITE GORE MARKING AND CHANNELIZING LINES</p>
---	--	---

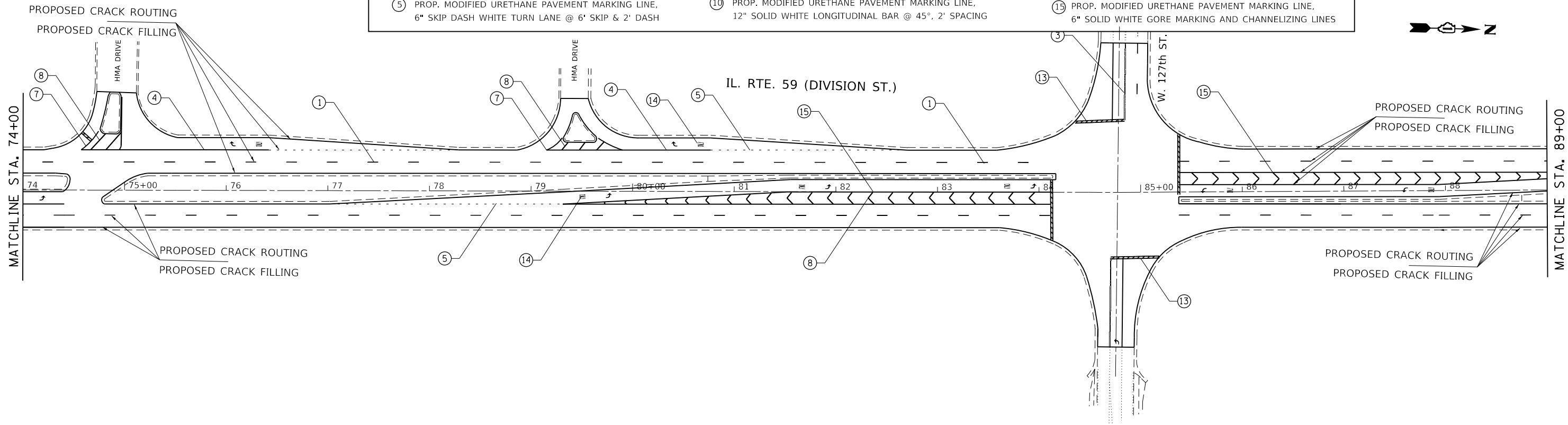

MODEL: Default
 FILE: h:\mhc\p\pub\harcam\dat\illinois\gov\PWIDOT\Documents\DOT_Offices\Illinet\1\Projects\152220\CaddData\Design\152220-01-01-01.dgn

USER NAME = elkhatibaj	DESIGNED -	REVISED -
PLOT SCALE = 100.0000' / in.	DRAWN -	REVISED -
PLOT DATE = 8/14/2020	CHECKED -	REVISED -
	DATE -	REVISED -

**STATE OF ILLINOIS
DEPARTMENT OF TRANSPORTATION**

IL 59 (DUPAGE CO LINE TO N OF PHEASANT CHASE DR) PROPOSED ROADWAY AND PAVEMENT MARKING PLANS			
SCALE: 1"=50'	SHEET	OF SHEETS	TO STA. 89+00

F.A.P. RTE. 338	SECTION 2020-122-I	COUNTY WILL	TOTAL SHEETS 22	SHEET NO. 6
CONTRACT NO. 62M00				
ILLINOIS FED. AID PROJECT				

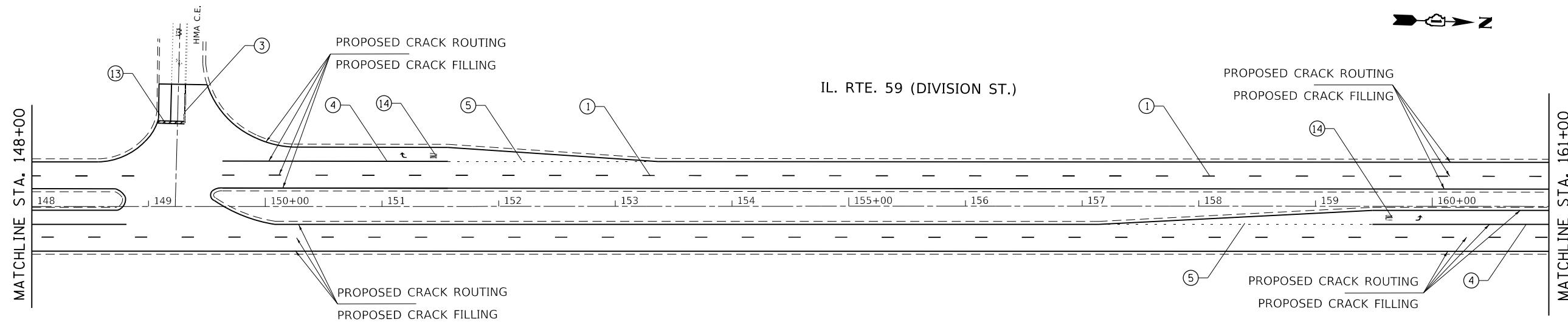

PAVEMENT MARKING LEGEND

<p>① PROP. MODIFIED URETHANE PAVEMENT MARKING LINE, 4" SKIP DASH WHITE LANE LINE @ 30' SKIP & 10' DASH</p> <p>② PROP. MODIFIED URETHANE PAVEMENT MARKING LINE, 4" SOLID WHITE LINE</p> <p>③ PROP. MODIFIED URETHANE PAVEMENT MARKING LINE, 4" DOUBLE SOLID YELLOW LINE, 2 @ 11" C-C</p> <p>④ PROP. MODIFIED URETHANE PAVEMENT MARKING LINE, 6" SOLID WHITE TURN LANE</p> <p>⑤ PROP. MODIFIED URETHANE PAVEMENT MARKING LINE, 6" SKIP DASH WHITE TURN LANE @ 6' SKIP & 2' DASH</p>	<p>⑥ PROP. MODIFIED URETHANE PAVEMENT MARKING LINE, 6" SOLID WHITE CROSSWALK LINE, 2 @ 6' C-C</p> <p>⑦ PROP. MODIFIED URETHANE PAVEMENT MARKING LINE, 8" SOLID WHITE GORE MARKING AND CHANNELIZING LINES</p> <p>⑧ PROP. MODIFIED URETHANE PAVEMENT MARKING LINE, 12" SOLID WHITE GORE MARKINGS @ 45 DEG.</p> <p>⑨ PROP. MODIFIED URETHANE PAVEMENT MARKING LINE, 12" SOLID WHITE LONGITUDINAL BAR @ 90°, 2' SPACING</p> <p>⑩ PROP. MODIFIED URETHANE PAVEMENT MARKING LINE, 12" SOLID WHITE LONGITUDINAL BAR @ 45°, 2' SPACING</p>	<p>⑪ PROP. MODIFIED URETHANE PAVEMENT MARKING LINE, 12" DIAGONAL SOLID YELLOW LINE @ 75' SPACING OR 5 MIN.</p> <p>⑫ PROP. MODIFIED URETHANE PAVEMENT MARKING LINE, 12" DIAGONAL SOLID WHITE LINE @ 75' SPACING OR 5 MIN.</p> <p>⑬ PROP. MODIFIED URETHANE PAVEMENT MARKING LETTERS & SYMBOLS, SOLID WHITE</p> <p>⑭ PROP. MODIFIED URETHANE PAVEMENT MARKING LINE, 24" SOLID WHITE STOP BAR</p> <p>⑮ PROP. MODIFIED URETHANE PAVEMENT MARKING LINE, 6" SOLID WHITE GORE MARKING AND CHANNELIZING LINES</p>
---	--	---

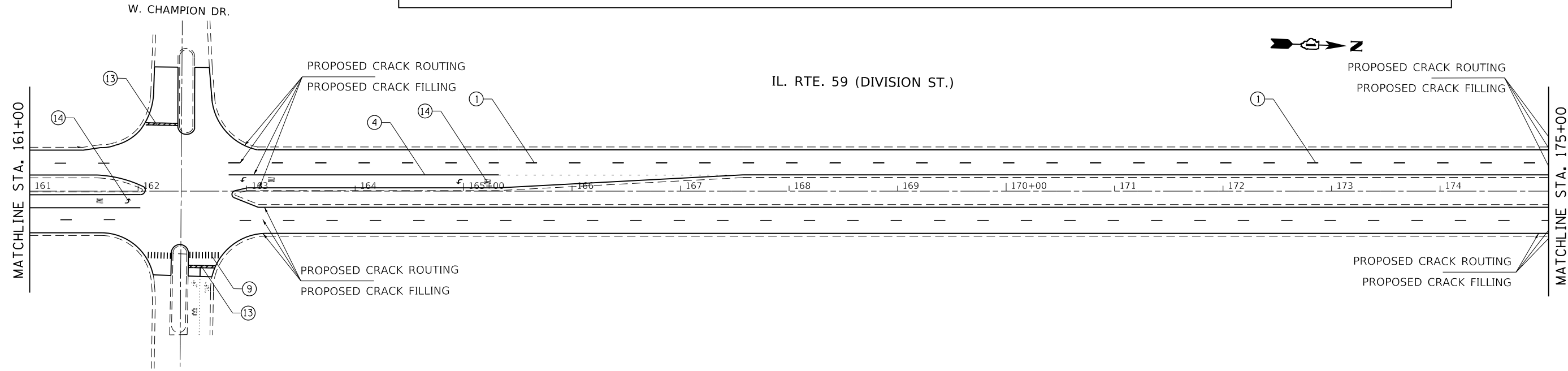

MODEL: Default
 FILE: \\blm1c:\pub\blmroom\dat\illinois.gov\PI\DOT\Documents\DOT_Offices\Illinlet\1\Projects\152220\CADD\Drawings\Design\152220-01-01-01.dgn

USER NAME = elkhajibaj	DESIGNED -	REVISED -
PLOT SCALE = 100,0000' / in.	DRAWN -	REVISED -
PLOT DATE = 8/14/2020	CHECKED -	REVISED -
	DATE -	REVISED -

**STATE OF ILLINOIS
DEPARTMENT OF TRANSPORTATION**

IL 59 (DUPAGE CO LINE TO N OF PHEASANT CHASE DR) PROPOSED ROADWAY AND PAVEMENT MARKING PLANS	
SCALE: 1"=50'	SHEET OF SHEETS STA. 148+00 TO STA. 175+00

F.A.P. RTE.	SECTION	COUNTY	TOTAL SHEETS	SHEET NO.
338	2020-122-I	WILL	22	9
CONTRACT NO. 62M00				
ILLINOIS FED. AID PROJECT				

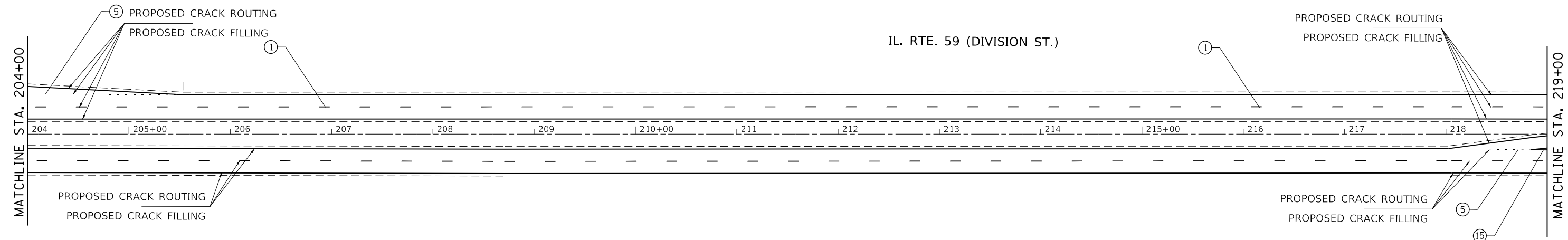

PAVEMENT MARKING LEGEND

<p>① PROP. MODIFIED URETHANE PAVEMENT MARKING LINE, 4" SKIP DASH WHITE LANE LINE @ 30' SKIP & 10' DASH</p> <p>② PROP. MODIFIED URETHANE PAVEMENT MARKING LINE, 4" SOLID WHITE LINE</p> <p>③ PROP. MODIFIED URETHANE PAVEMENT MARKING LINE, 4" DOUBLE SOLID YELLOW LINE, 2 @ 11" C-C</p> <p>④ PROP. MODIFIED URETHANE PAVEMENT MARKING LINE, 6" SOLID WHITE TURN LANE</p> <p>⑤ PROP. MODIFIED URETHANE PAVEMENT MARKING LINE, 6" SKIP DASH WHITE TURN LANE @ 6' SKIP & 2' DASH</p>	<p>⑥ PROP. MODIFIED URETHANE PAVEMENT MARKING LINE, 6" SOLID WHITE CROSSWALK LINE, 2 @ 6' C-C</p> <p>⑦ PROP. MODIFIED URETHANE PAVEMENT MARKING LINE, 8" SOLID WHITE GORE MARKING AND CHANNELIZING LINES</p> <p>⑧ PROP. MODIFIED URETHANE PAVEMENT MARKING LINE, 12" SOLID WHITE GORE MARKINGS @ 45 DEG.</p> <p>⑨ PROP. MODIFIED URETHANE PAVEMENT MARKING LINE, 12" SOLID WHITE LONGITUDINAL BAR @ 90°, 2' SPACING</p> <p>⑩ PROP. MODIFIED URETHANE PAVEMENT MARKING LINE, 12" SOLID WHITE LONGITUDINAL BAR @ 45°, 2' SPACING</p>	<p>⑪ PROP. MODIFIED URETHANE PAVEMENT MARKING LINE, 12" DIAGONAL SOLID YELLOW LINE @ 75' SPACING OR 5 MIN.</p> <p>⑫ PROP. MODIFIED URETHANE PAVEMENT MARKING LINE, 12" DIAGONAL SOLID WHITE LINE @ 75' SPACING OR 5 MIN.</p> <p>⑬ PROP. MODIFIED URETHANE PAVEMENT MARKING LETTERS & SYMBOLS, SOLID WHITE</p> <p>⑭ PROP. MODIFIED URETHANE PAVEMENT MARKING LINE, 24" SOLID WHITE STOP BAR</p> <p>⑮ PROP. MODIFIED URETHANE PAVEMENT MARKING LINE, 6" SOLID WHITE GORE MARKING AND CHANNELIZING LINES</p>
---	--	---

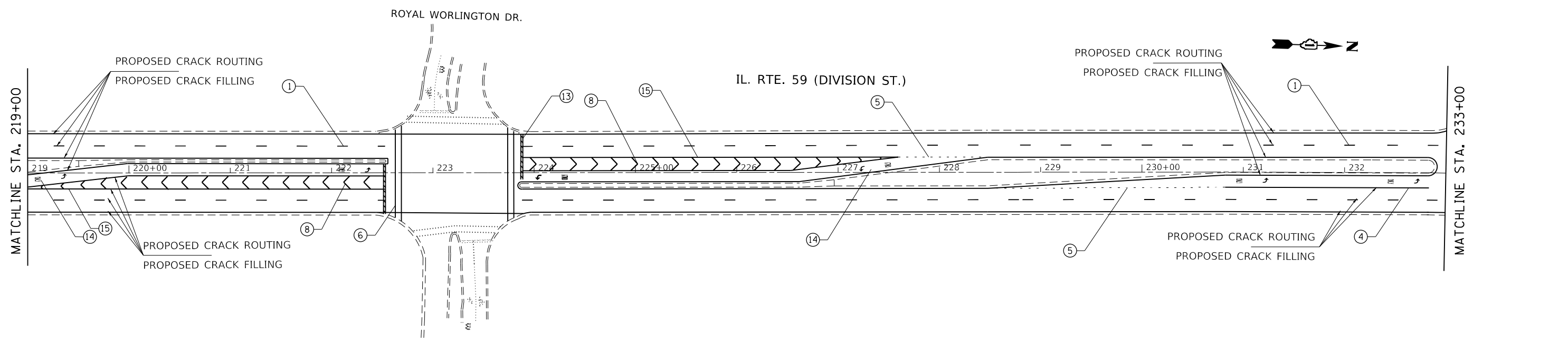

MODEL: Default
 FILE: \\harc...
 PROJECT: 152220\CaddData\Design\152220-01-01-01.dgn

USER NAME = elkhatibaj	DESIGNED -	REVISED -
PLOT SCALE = 100,0000' / in.	DRAWN -	REVISED -
PLOT DATE = 8/14/2020	CHECKED -	REVISED -
	DATE -	REVISED -

STATE OF ILLINOIS
DEPARTMENT OF TRANSPORTATION

IL 59 (DUPAGE CO LINE TO N OF PHEASANT CHASE DR)
PROPOSED ROADWAY AND PAVEMENT MARKING PLANS

SCALE: 1"=50' SHEET OF SHEETS STA. 204+00 TO STA. 233+00

F.A.P. RTE.	SECTION	COUNTY	TOTAL SHEETS	SHEET NO.
338	2020-122-I	WILL	22	11
CONTRACT NO. 62M00				
ILLINOIS FED. AID PROJECT				

MODEL: Default
 FILE: hma12c_pavplanroom.dwg
 PROJECT: I:\Projects\152220\CADDData\Design\152220-01c-pav.dwg

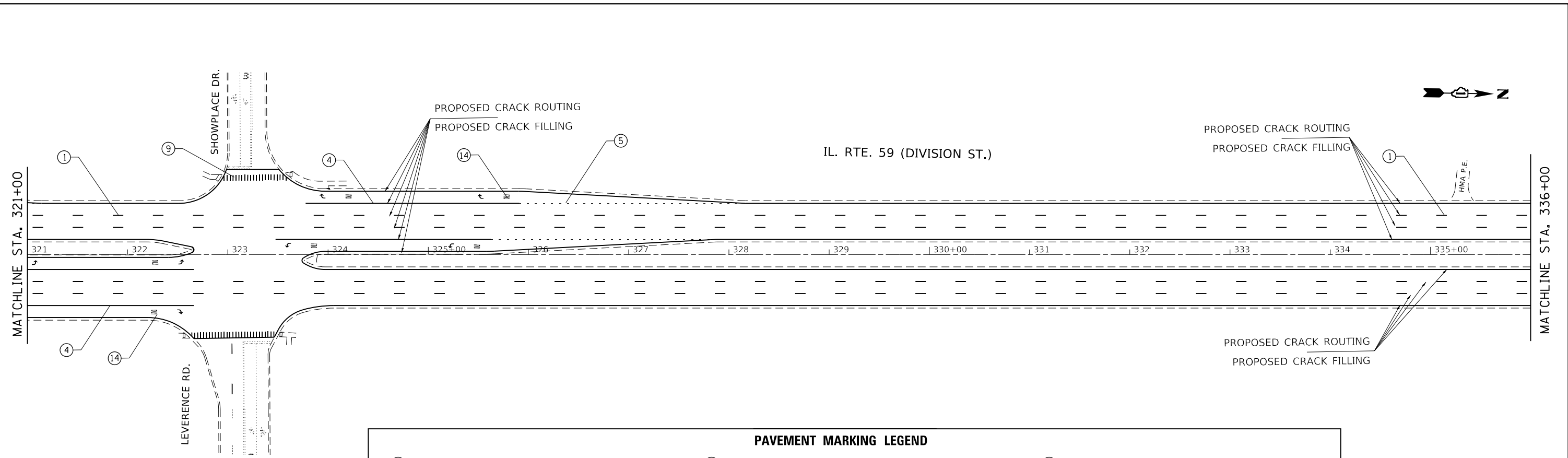

PAVEMENT MARKING LEGEND			
①	PROP. MODIFIED URETHANE PAVEMENT MARKING LINE, 4" SKIP DASH WHITE LANE LINE @ 30' SKIP & 10' DASH	⑪	PROP. MODIFIED URETHANE PAVEMENT MARKING LINE, 12" DIAGONAL SOLID YELLOW LINE @ 75' SPACING OR 5 MIN.
②	PROP. MODIFIED URETHANE PAVEMENT MARKING LINE, 4" SOLID WHITE LINE	⑫	PROP. MODIFIED URETHANE PAVEMENT MARKING LINE, 12" DIAGONAL SOLID WHITE LINE @ 75' SPACING OR 5 MIN.
③	PROP. MODIFIED URETHANE PAVEMENT MARKING LINE, 4" DOUBLE SOLID YELLOW LINE, 2 @ 11" C-C	⑬	PROP. MODIFIED URETHANE PAVEMENT MARKING LETTERS & SYMBOLS, SOLID WHITE
④	PROP. MODIFIED URETHANE PAVEMENT MARKING LINE, 6" SOLID WHITE TURN LANE	⑭	PROP. MODIFIED URETHANE PAVEMENT MARKING LINE, 24" SOLID WHITE STOP BAR
⑤	PROP. MODIFIED URETHANE PAVEMENT MARKING LINE, 6" SKIP DASH WHITE TURN LANE @ 6' SKIP & 2' DASH	⑮	PROP. MODIFIED URETHANE PAVEMENT MARKING LINE, 6" SOLID WHITE GORE MARKING AND CHANNELIZING LINES
⑥	PROP. MODIFIED URETHANE PAVEMENT MARKING LINE, 6" SOLID WHITE CROSSWALK LINE, 2 @ 6' C-C		
⑦	PROP. MODIFIED URETHANE PAVEMENT MARKING LINE, 8" SOLID WHITE GORE MARKING AND CHANNELIZING LINES		
⑧	PROP. MODIFIED URETHANE PAVEMENT MARKING LINE, 12" SOLID WHITE GORE MARKINGS @ 45 DEG.		
⑨	PROP. MODIFIED URETHANE PAVEMENT MARKING LINE, 12" SOLID WHITE LONGITUDINAL BAR @ 90°, 2' SPACING		
⑩	PROP. MODIFIED URETHANE PAVEMENT MARKING LINE, 12" SOLID WHITE LONGITUDINAL BAR @ 45°, 2' SPACING		

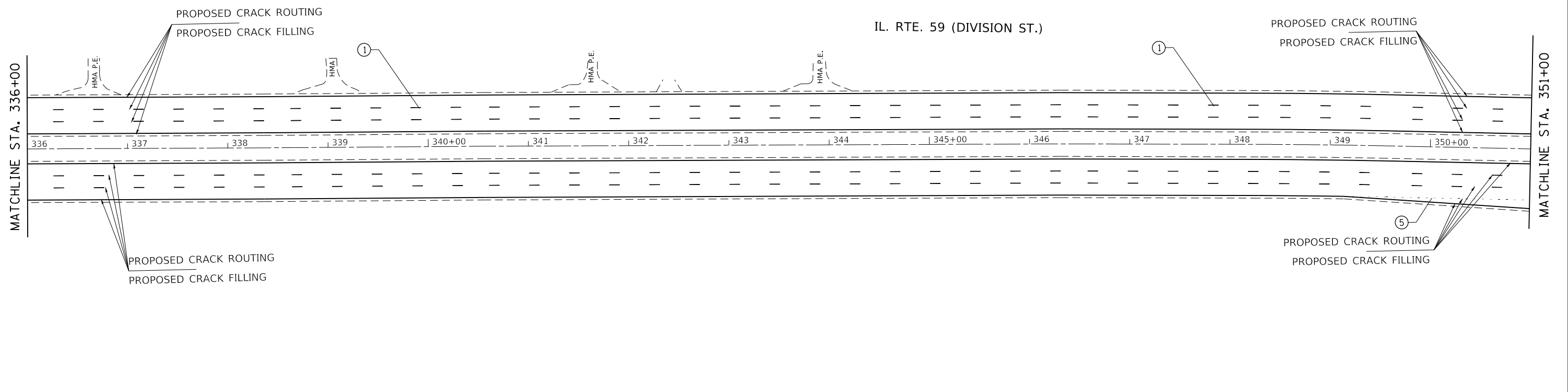

USER NAME = elkhatabaj	DESIGNED -	REVISED -
PLOT SCALE = 100.0000' / in.	DRAWN -	REVISED -
PLOT DATE = 8/14/2020	CHECKED -	REVISED -
	DATE -	REVISED -

**STATE OF ILLINOIS
 DEPARTMENT OF TRANSPORTATION**

**IL 59 (DUPAGE CO LINE TO N OF PHEASANT CHASE DR)
 PROPOSED ROADWAY AND PAVEMENT MARKING PLANS**

SCALE: 1"=50' SHEET OF SHEETS STA. 321+00 TO STA. 351+00

F.A.P. RTE.	SECTION	COUNTY	TOTAL SHEETS	SHEET NO.
338	2020-122-I	WILL	22	15
CONTRACT NO. 62M00				
ILLINOIS FED. AID PROJECT				

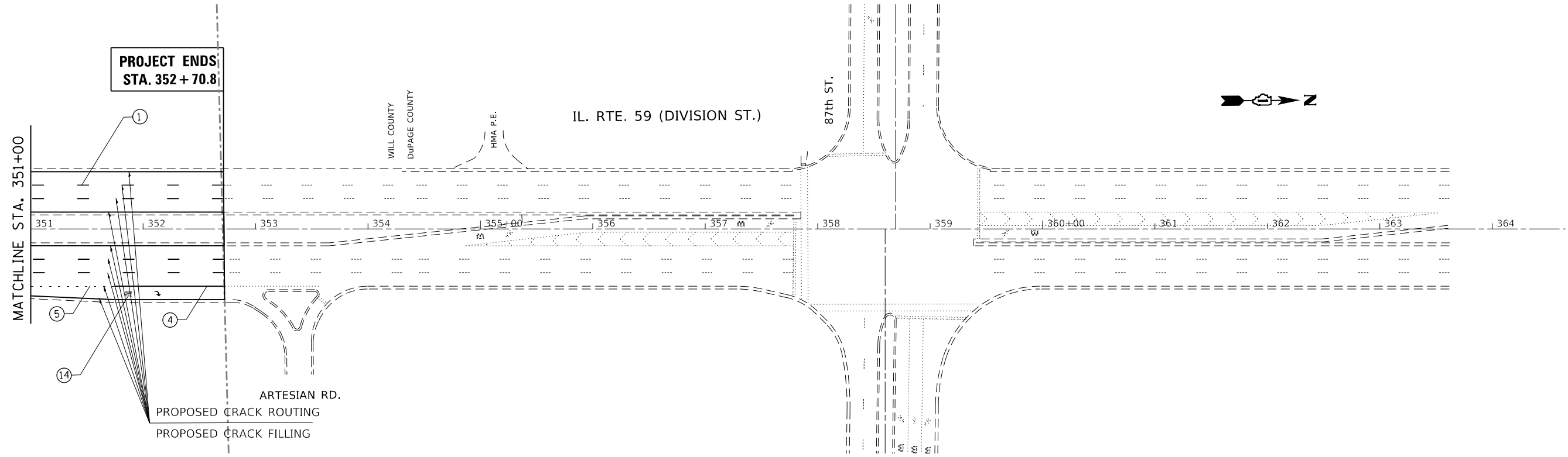

PAVEMENT MARKING LEGEND			
①	PROP. MODIFIED URETHANE PAVEMENT MARKING LINE, 4" SKIP DASH WHITE LANE LINE @ 30' SKIP & 10' DASH	⑪	PROP. MODIFIED URETHANE PAVEMENT MARKING LINE, 12" DIAGONAL SOLID YELLOW LINE @ 75' SPACING OR 5 MIN.
②	PROP. MODIFIED URETHANE PAVEMENT MARKING LINE, 4" SOLID WHITE LINE	⑫	PROP. MODIFIED URETHANE PAVEMENT MARKING LINE, 12" DIAGONAL SOLID WHITE LINE @ 75' SPACING OR 5 MIN.
③	PROP. MODIFIED URETHANE PAVEMENT MARKING LINE, 4" DOUBLE SOLID YELLOW LINE, 2 @ 11" C-C	⑬	PROP. MODIFIED URETHANE PAVEMENT MARKING LETTERS & SYMBOLS, SOLID WHITE
④	PROP. MODIFIED URETHANE PAVEMENT MARKING LINE, 6" SOLID WHITE TURN LANE	⑭	PROP. MODIFIED URETHANE PAVEMENT MARKING LINE, 24" SOLID WHITE STOP BAR
⑤	PROP. MODIFIED URETHANE PAVEMENT MARKING LINE, 6" SKIP DASH WHITE TURN LANE @ 6' SKIP & 2' DASH	⑮	PROP. MODIFIED URETHANE PAVEMENT MARKING LINE, 6" SOLID WHITE GORE MARKING AND CHANNELIZING LINES
⑥	PROP. MODIFIED URETHANE PAVEMENT MARKING LINE, 6" SOLID WHITE CROSSWALK LINE, 2 @ 6' C-C		
⑦	PROP. MODIFIED URETHANE PAVEMENT MARKING LINE, 8" SOLID WHITE GORE MARKING AND CHANNELIZING LINES		
⑧	PROP. MODIFIED URETHANE PAVEMENT MARKING LINE, 12" SOLID WHITE GORE MARKINGS @ 45 DEG.		
⑨	PROP. MODIFIED URETHANE PAVEMENT MARKING LINE, 12" SOLID WHITE LONGITUDINAL BAR @ 90°, 2' SPACING		
⑩	PROP. MODIFIED URETHANE PAVEMENT MARKING LINE, 12" SOLID WHITE LONGITUDINAL BAR @ 45°, 2' SPACING		

MODEL: Default
 FILE: \\nlsdot-pub\pubroom\dat\illinois.gov\PI\DOT\Documents\DOT_Offices\District_1\Projects\152220\CaddData\Design\152220-01-01-01.dgn

USER NAME = elkhatibaj	DESIGNED -	REVISED -
	DRAWN -	REVISED -
PLOT SCALE = 100,0000' / in.	CHECKED -	REVISED -
PLOT DATE = 8/14/2020	DATE -	REVISED -

STATE OF ILLINOIS
DEPARTMENT OF TRANSPORTATION

IL 59 (DUPAGE CO LINE TO N OF PHEASANT CHASE DR) PROPOSED ROADWAY AND PAVEMENT MARKING PLANS			
SCALE: 1"=50'	SHEET	OF	SHEETS
	STA. 351+00		TO STA. 354+30.1

F.A.P. RTE.	SECTION	COUNTY	TOTAL SHEETS	SHEET NO.
338	2020-122-1	WILL	22	16
CONTRACT NO. 62M00				
ILLINOIS FED. AID PROJECT				

LEGEND

- ① EXISTING PORTLAND CEMENT CONCRETE PAVEMENT
- ② EXISTING CURB AND GUTTER
- ③ EXISTING CONCRETE MEDIAN

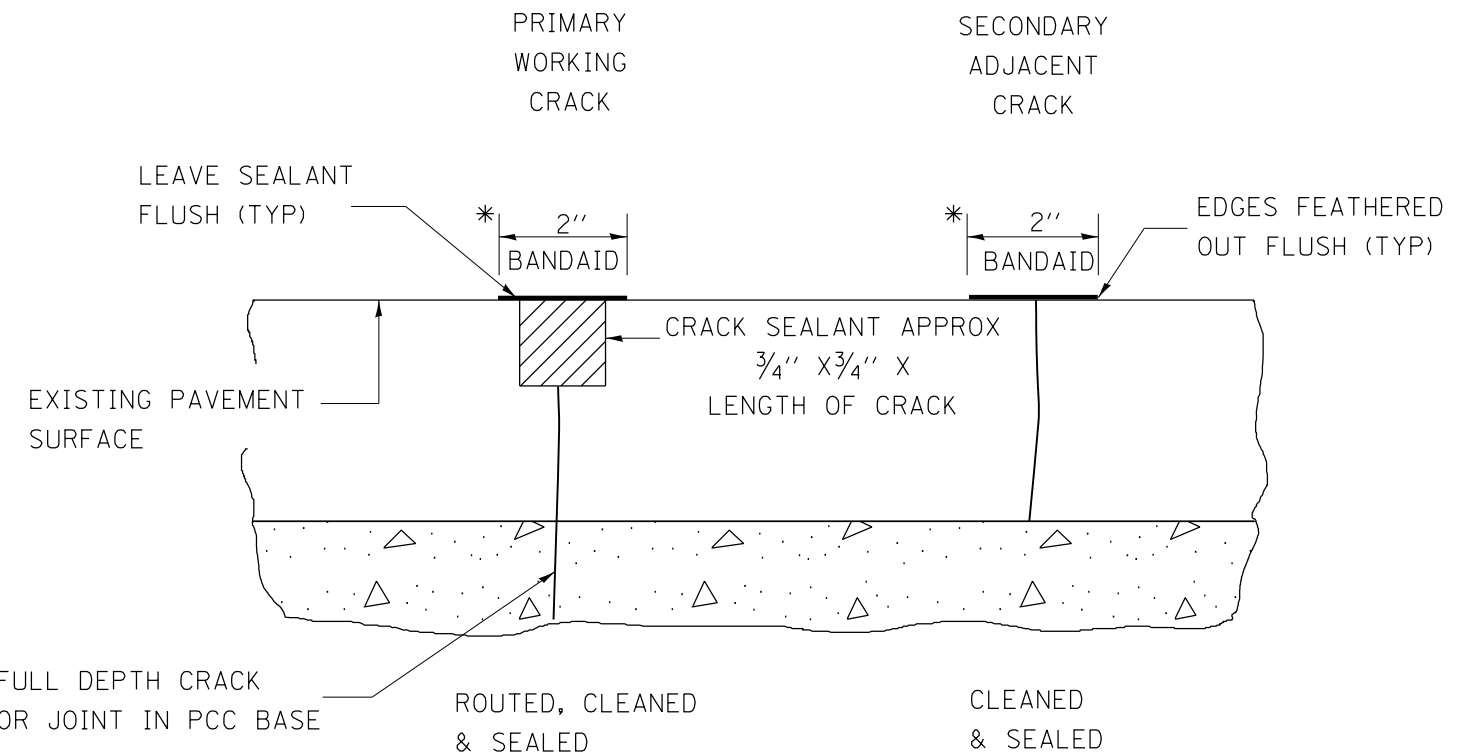
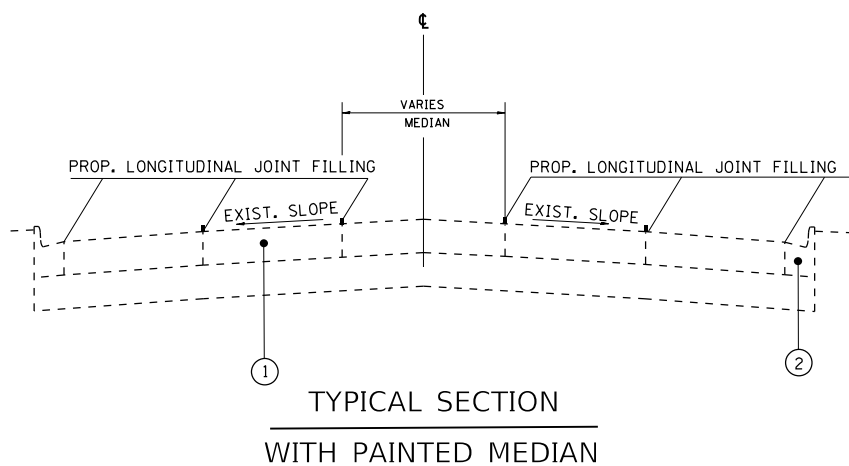
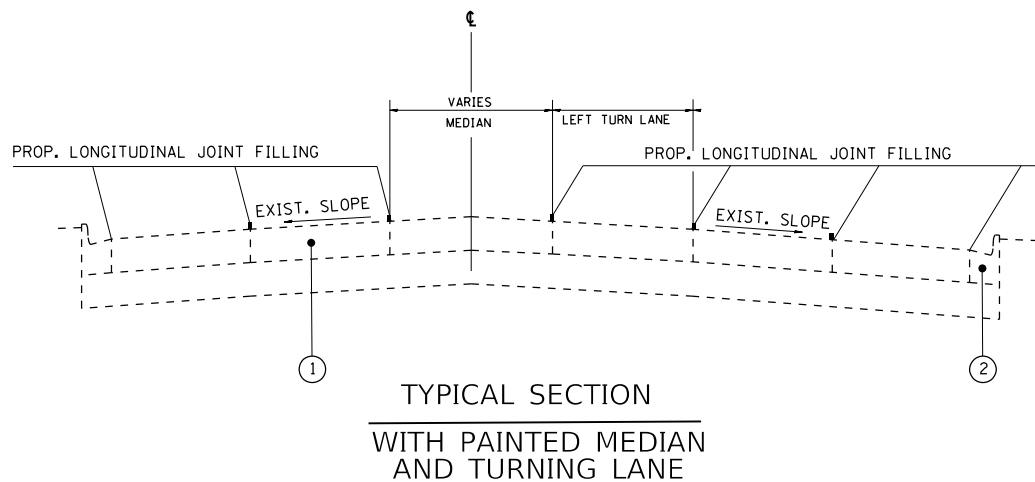
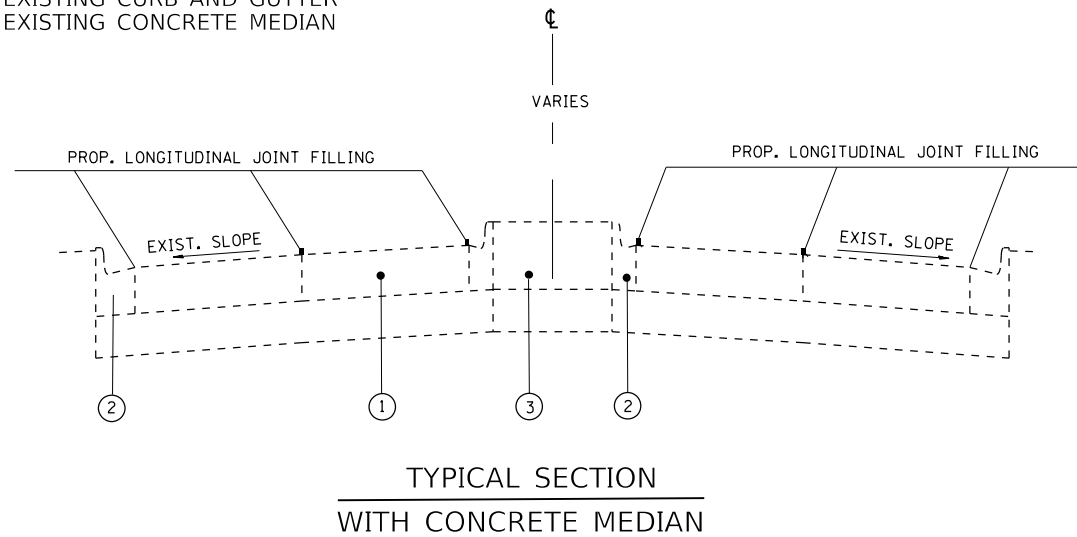

*

IN ALL LOCATIONS WHERE THE LONGITUDINAL CRACK CONFLICTS WITH EXISTING PAVEMENT MARKINGS (EITHER EDGE LINE OR LANE LINE) THE CRACK SHALL BE ROUTED & THE RESULTING RESERVOIR FILLED WITH SEALANT. ALL DAMAGES TO EXISTING RAISED REFLECTIVE PAVEMENT MARKERS SHALL BE REPLACED AT THE EXPENSE OF THE CONTRACTOR. ALL EXISTING PAVEMENT MARKINGS WITHIN THE PROJECT LIMITS SHALL BE RESTORED WITH MODIFIED URETHANE PAVEMENT MARKINGS.

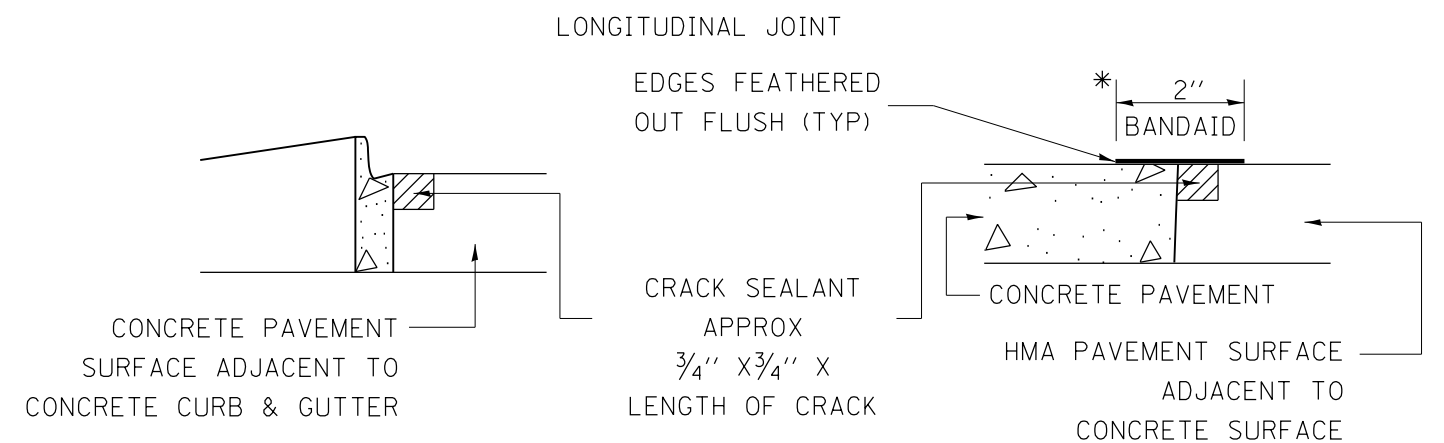

CRACK & JOINT SEALING DETAIL

USER NAME = elkhatibaj PLOT SCALE = 100.0000' / 1" = 1/8" PLOT DATE = 8/14/2020	DESIGNED - DRAWN - CHECKED - DATE -	REVISED - REVISED - REVISED - REVISED -	STATE OF ILLINOIS DEPARTMENT OF TRANSPORTATION	IL 59 (DUPAGE CO LINE TO N OF PHEASANT CHASE DR) CRACK AND JOINT SEALING DETAIL	F.A.P. RTE. 338 SECTION 2020-122-I COUNTY WILL TOTAL SHEETS 22 SHEET NO. 17 CONTRACT NO. 62M00 ILLINOIS FED. AID PROJECT
			SCALE:	SHEET NO. OF SHEETS STA. TO STA.	

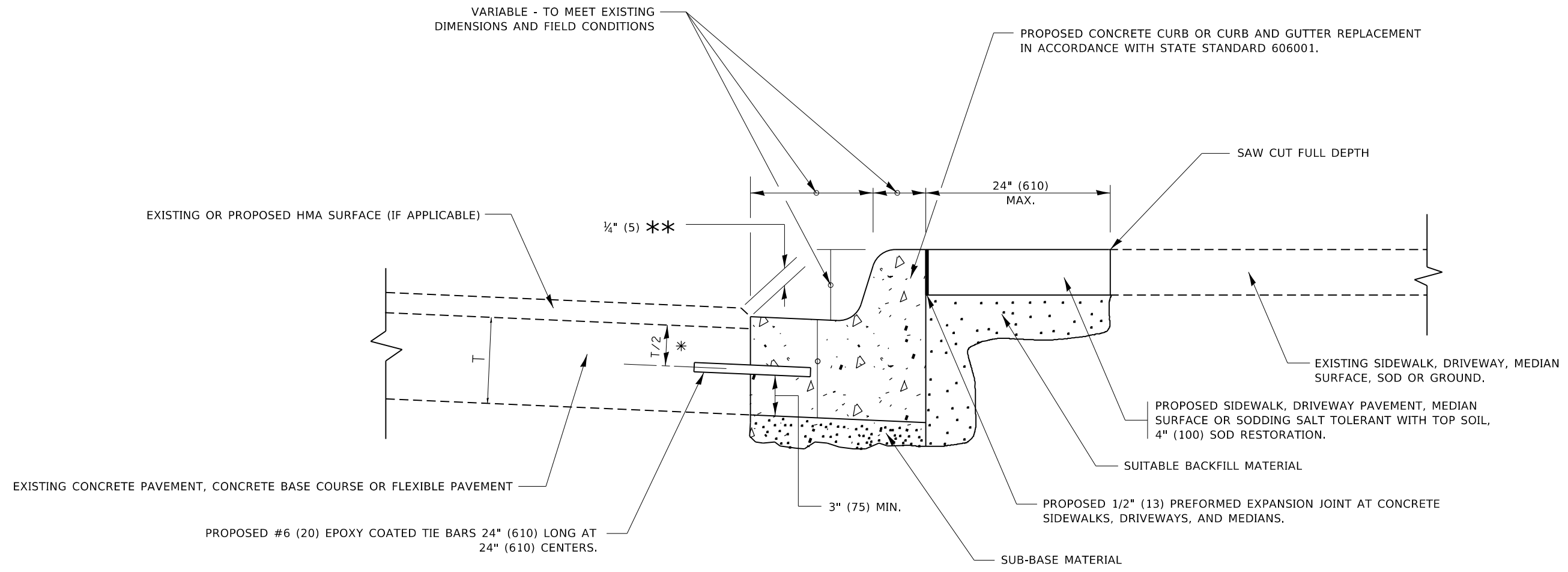

- * 3" (75) MINIMUM FROM TOP AND BOTTOM OF THE CONCRETE PAVEMENT OR BASE COURSE.
- ** IF THE FINAL SURFACE OF THE PAVEMENT IS CONCRETE, THE GUTTER IS TO BE FLUSH WITH THE PAVEMENT.

CURB OR CURB AND GUTTER REMOVAL AND REPLACEMENT

ALL DIMENSIONS ARE IN INCHES (MILLIMETERS) UNLESS OTHERWISE SHOWN.

MODEL: Default
FILE: Model: 338\plan\planroom.dwg\illinois.gov\pww\DOT\Documents\DOT_Offices\Ibirtet_1\Project\ID152720\CaddData\Design\BDS4.dwg

USER NAME = elkhatibaj	DESIGNED - A. HOUSEH	REVISED - A. ABBAS 03-21-97
	DRAWN -	REVISED - M. GOMEZ 01-22-01
PLOT SCALE = 100.0000' / in.	CHECKED -	REVISED - R. BORO 12-15-09
PLOT DATE = 8/14/2020	DATE - 03-11-94	REVISED - K. SMITH 07-11-19

**STATE OF ILLINOIS
DEPARTMENT OF TRANSPORTATION**

**CURB OR CURB AND GUTTER
REMOVAL AND REPLACEMENT**

SCALE: NONE SHEET 1 OF 1 SHEETS STA. TO STA.

F.A.P. RTE.	SECTION	COUNTY	TOTAL SHEETS	SHEET NO.
338	2020-122-I	WILL	22	18
BD600-06 (BD-24)			CONTRACT NO. 62M00	
ILLINOIS FED. AID PROJECT				

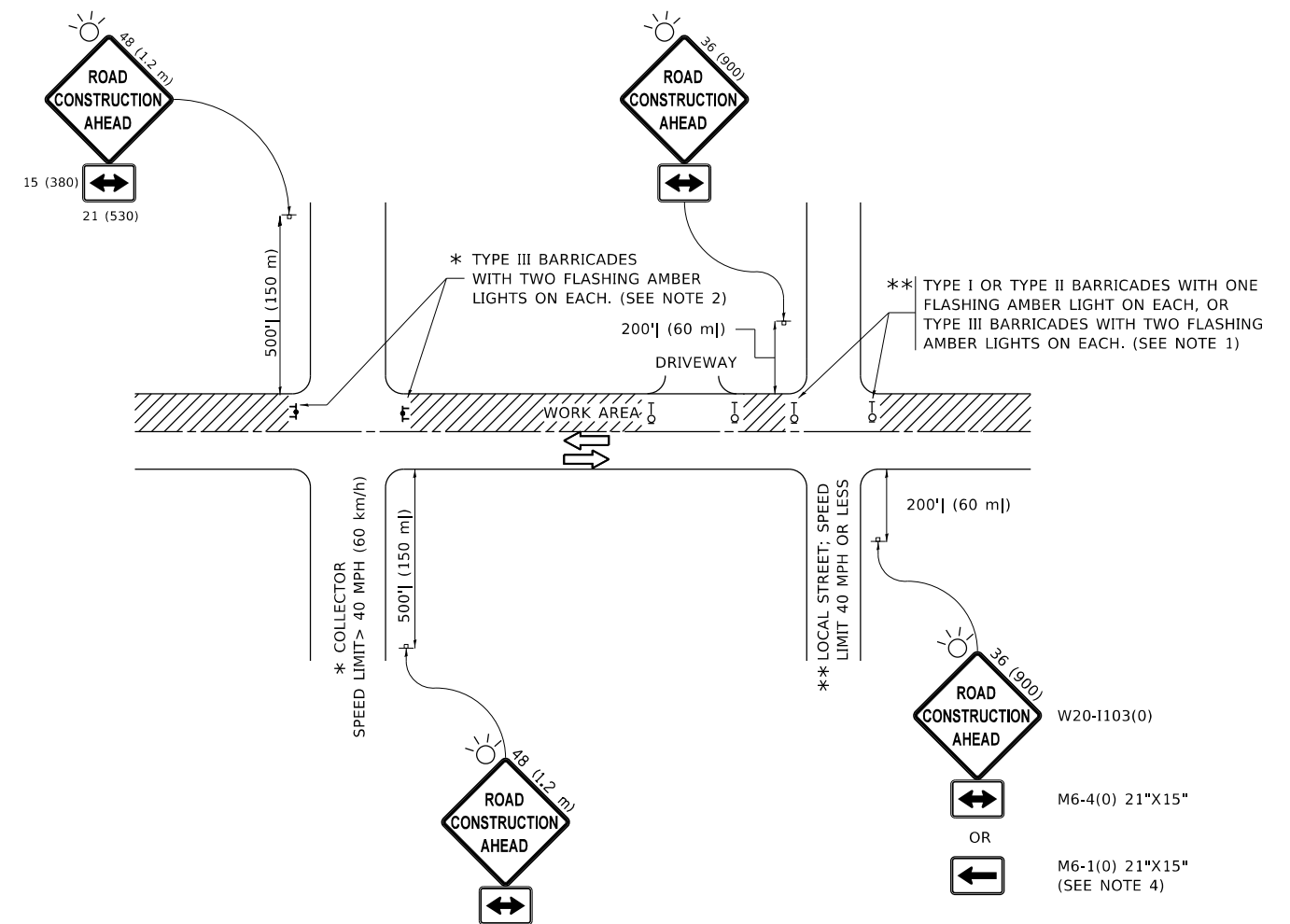

NOTES:

1. SIDE ROAD WITH A SPEED LIMIT OF 40 MPH (60 km/h) OR LESS AS SHOWN ON THE DRAWING AND AS DIRECTED BY THE ENGINEER:
 - a) ONE "ROAD CONSTRUCTION AHEAD" SIGN 36 x 36 (900x900) WITH A FLASHER MOUNTED ON IT APPROXIMATELY 200' (60 m) IN ADVANCE OF THE MAIN ROUTE.
 - b) THE CLOSED PORTION OF THE MAIN ROUTE SHALL BE PROTECTED BY BLOCKING WITH TYPE I, TYPE II OR TYPE III BARRICADES, 1/3 OF THE CROSS SECTION OF THE CLOSED PORTION.
2. SIDE ROAD WITH A SPEED LIMIT GREATER THAN 40 MPH (60 km/h) AS SHOWN ON THE DRAWING AND AS DIRECTED BY THE ENGINEER:
 - a) ONE "ROAD CONSTRUCTION AHEAD" SIGN 48 x 48 (1.2 m x 1.2 m) WITH A FLASHER MOUNTED ON IT APPROXIMATELY 500' (150 m) IN ADVANCE OF THE MAIN ROUTE.
 - b) BLOCKING WITH TYPE III BARRICADES, 1/2 OF THE CROSS SECTION OF THE CLOSED PORTION.
3. CONES MAY BE SUBSTITUTED FOR BARRICADES OR DRUMS AT HALF THE SPACING DURING DAY OPERATIONS. CONES SHALL BE A MINIMUM OF 28 (710) IN HEIGHT.
4. SIGNING AND THE WORK ZONE, A SINGLE HEADED ARROW (M6-1) SHALL BE USED IN LIEU OF THE DOUBLE HEADED ARROW (M6-4).
5. WHEN WORK IS BEING PERFORMED ON A SIDE ROAD OR DRIVEWAY, FOLLOW THE APPLICABLE STANDARD(S). THE DIRECTIONAL ARROW (M6-1 OR M6-4) SHALL BE COVERED OR REMOVED WHEN NO LONGER CONSISTENT WITH THE TRAFFIC CONTROL SET-UP.
6. ADVANCE WARNING SIGNS ARE TO BE OMITTED ON DRIVEWAYS UNLESS OTHERWISE SPECIFIED IN THE PLANS OR BY THE ENGINEER.
7. THE TRAFFIC CONTROL AND PROTECTION FOR SIDE ROADS, INTERSECTIONS, AND DRIVEWAYS SHALL BE INCLUDED IN THE COST OF SPECIFIED TRAFFIC CONTROL STANDARDS OR ITEMS.

All dimensions are in inches (millimeters) unless otherwise shown.

MODEL: Default
 FILE: \\nashville-prod\planroom\dat\illinois.gov\PWIDOT\Documents\DOT_Offices\Director_1\Projects\152720\CADD\Drawings\Design\DRS\4.dgn

USER NAME = elkhatibaj	DESIGNED - L.H.A.	REVISED - A. HOUSEH 10-15-96
PLOT SCALE = 100,0000 ' / in.	CHECKED -	REVISED - T. RAMMACHER 01-06-00
PLOT DATE = 8/14/2020	DATE - 06-89	REVISED - A. SCHUETZE 07-01-13
		REVISED - A. SCHUETZE 09-15-16

**STATE OF ILLINOIS
DEPARTMENT OF TRANSPORTATION**

**TRAFFIC CONTROL AND PROTECTION FOR
SIDE ROADS, INTERSECTIONS, AND DRIVEWAYS**

SCALE: NONE SHEET 1 OF 1 SHEETS STA. TO STA.

F.A.P. RTE.	SECTION	COUNTY	TOTAL SHEETS	SHEET NO.
338	2020-122-I	WILL	22	19
TC-10			CONTRACT NO. 62M00	
ILLINOIS FED. AID PROJECT				

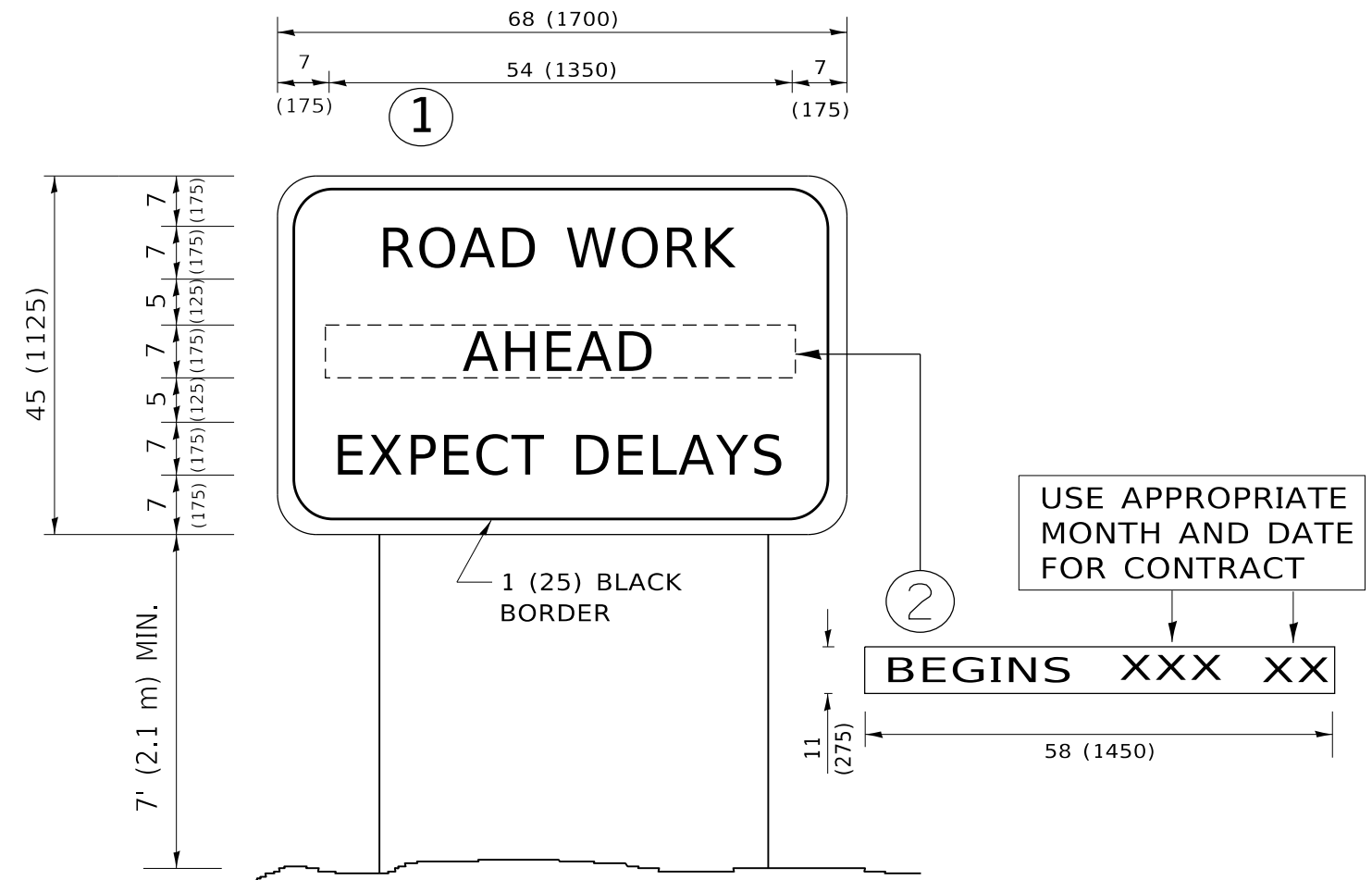

NOTES:

1. USE BLACK LETTERING ON ORANGE BACKGROUND.
2. ERECT SIGNS IN ADVANCE OF THE LOCATION FOR THE "ROAD CONSTRUCTION AHEAD" SIGN AT LOCATIONS AS DIRECTED BY THE ENGINEER.
3. ERECT SIGN ① WITH INSTALLED PANEL ② ONE WEEK PRIOR TO THE START OF CONSTRUCTION.
4. REMOVE PANEL ② SOON AFTER THE START OF CONSTRUCTION.
5. SEE SPECIAL PROVISION FOR "TEMPORARY INFORMATION SIGNING" FOR ADDITIONAL INFORMATION.
6. ONE SIGN ASSEMBLY EQUALS 25.70 SQ. FT. (2.3 SQ. M.)
7. SHALL BE PAID FOR AS TEMPORARY INFORMATION SIGNING.

ALL DIMENSIONS ARE IN INCHES (MILLIMETERS) UNLESS OTHERWISE SHOWN.

MODEL: Default
 FILE: \\harris-pc\pub\harris\room\dat\illinois.gov\PWIDOT\Documents\DOT_Offices\Dir\dtc_1\Projects\152720\Cadd\Drawings\Design\DRS54.dgn

USER NAME = elkhatibaj	DESIGNED -	REVISED - R. MIRS 09-15-97
	DRAWN -	REVISED - R. MIRS 12-11-97
PLOT SCALE = 100.0000 ' / in.	CHECKED -	REVISED - T. RAMMACHER 02-02-99
PLOT DATE = 8/14/2020	DATE -	REVISED - C. JUCIUS 01-31-07

**STATE OF ILLINOIS
DEPARTMENT OF TRANSPORTATION**

**ARTERIAL ROAD
INFORMATION SIGN**

SCALE: NONE SHEET 1 OF 1 SHEETS STA. TO STA.

F.A.P. RTE.	SECTION	COUNTY	TOTAL SHEETS	SHEET NO.
338	2020-122-I	WILL	22	22
TC-22			CONTRACT NO. 62M00	
		ILLINOIS	FED. AID PROJECT	