

INDEX OF SHEETS

- 1 COVER SHEET
- 2 INDEX OF SHEETS, GENERAL NOTES, HIGHWAY STANDARDS, MIXTURE REQUIREMENTS & COMMITMENTS
- 3 SUMMARY OF QUANTITIES
- 4 TYPICAL SECTIONS
- 5-6 SCHEDULE OF QUANTITIES
- 7 LOCATION MAP

HIGHWAY STANDARDS

000001-07	STANDARD SYMBOLS, ABBREVIATIONS AND PATTERNS
001006	DECIMAL OF AN INCH AND OF A FOOT
701011-04	OFF-ROAD MOVING OPERATIONS, 2L, 2W DAY ONLY
701201-05	LANE CLOSURES, 2L, 2W, DAY ONLY FOR SPEEDS \geq 45 MPH
701301-04	LANE CLOSURES, 2L, 2W, SHORT TIME OPERATIONS
701306-04	LANE CLOSURES, 2L, 2W, SLOW MOVING OPERATIONS DAY ONLY FOR SPEEDS \geq 45 MPH
701311-03	SLOW MOVING OPERATIONS DAY ONLY
701336-07	LANE CLOSURES, 2L, 2W, WORK AREAS IN SERIES FOR SPEEDS \geq 45 MPH
701901-08	TRAFFIC CONTROL DEVICES
780001-05	TYPICAL PAVEMENT MARKINGS
781001-04	TYPICAL APPLICATIONS RAISED REFLECTIVE PAVEMENT MARKERS

MIXTURE REQUIREMENTS

ROUTE	FAP 327 (US 50)
SECTION	14-15RS-2
COUNTIES	CLINTON
CONTRACT	76N12

DESCRIPTION	MICRO-SURFACING - 1 SINGLE PASS - US 50 FROM 0.3 MILES WEST OF FROGTOWN RD. TO 0.1 MILES WEST OF IL 127
-------------	---

ADT (CONSTRUCTION YR):	5550
MU%	7.66
SU%	3.42

	PARTIAL DEPTH PATCH
MIXTURE USE	SURFACE
AC/PG	PG 64-22
RAP % (MAX)	SEE SPECIAL PROVISION
DESIGN AIR VOIDS	4.0% @ Ndes=70
MIX COMPOSITION (GRADATION MIXTURE)	IL 9.5
FRICTION AGG	MIXTURE "D"
QUALITY MGMT PROGRAM	QC/QA

GENERAL NOTES

- ① UTILITIES KNOWN TO HAVE FACILITIES WITHIN THE PROJECT AREA ARE AS FOLLOWS:

	AERIAL	BURIED
*AMEREN ILLINOIS (GAS & ELECTRIC)	X	X
*AT&T ILLINOIS (COMMUNICATIONS)	X	X
*CITY OF CARLYLE (ELECTRIC)	X	X
*CITY OF CARLYLE (WATER & SANITARY SEWER)		X
*CARLYLE NORTH WATER COMPANY (WATER)		X
*CHARTER COMMUNICATIONS (CABLE TV)	X	X
*CLINTON COUNTY ELECTRIC COOPERATIVE, INC. (ELECTRIC)	X	X
*COUNTRYMARK COOPERATIVE, LLP. (PIPELINE)		X
*NATURAL GAS PIPELINE COMPANY OF AMERICA, (PIPELINE)		X

MEMBERS OF J.U.L.I.E. CALL TOLL FREE (800) 892-0123 OR 811 AND ARE INDICATED BY *. NON-J.U.L.I.E. MEMBERS MUST BE NOTIFIED INDIVIDUALLY.

- ② THE CONTRACTOR AND THE ENGINEER SHALL BE AWARE THAT NO SURVEY WAS PERFORMED FOR THIS PROJECT. THE STATIONING, TOPOGRAPHY, AND QUANTITIES SHOWN IN THE PLANS WERE CREATED USING MICROFILM AND FIELD MEASUREMENTS. ALL SHALL BE ASSUMED TO BE APPROXIMATE. THE CONTRACTOR SHALL VERIFY DIMENSIONS AND CONDITIONS IN THE FIELD PRIOR TO CONSTRUCTION AND ORDERING OF MATERIALS.



③

- ④ MICRO-SURFACING OVERLAY SHALL NOT FILL IN EXISTING RUMBLE STRIP IN THE SHOULDER.

- ⑤ NO OVERNIGHT LANE CLOSURES WILL BE PERMITTED.

- ⑥ THE PROPOSED PAVEMENT MARKINGS AND TEMPORARY PAVEMENT MARKINGS SHALL MATCH THE EXISTING PAVEMENT MARKINGS THROUGHOUT THE JOB AND TIE INTO THE EXISTING PAVEMENT MARKINGS AT THE END OF THE PROJECT.

- ⑦ TWO CHANGEABLE MESSAGE SIGNS SHALL BE PROVIDED ALONG US 50 TO ALERT DRIVERS OF THE ROAD CONSTRUCTION. CHANGEABLE MESSAGE SIGNS SHALL BE PLACED 14 DAYS PRIOR TO BEGINNING ANY WORK. EXACT LOCATIONS OF THE CHANGEABLE MESSAGE SIGNS SHALL BE DETERMINED BY THE ENGINEER.

- ⑧ THE RAISED REFLECTIVE PAVEMENT MARKERS SHALL NOT BE PLACED IN THE SAME LOCATION AS THEY WERE PREVIOUSLY INSTALLED.

- ⑨ PATCHING QUANTITIES HAVE BEEN PROVIDED WITH THIS CONTRACT AND SHALL BE USED AT THE DISCRETION OF THE ENGINEER. PATCHING QUANTITIES SHALL NOT EXCEED THE QUANTITY PROVIDED IN THE PLANS.

COMMITMENTS

NONE

△ REV. 10-29-2020

MODEL: \\MODELNAME
 FILE NAME: \\path\name.mxd
 PROJECT: \\path\project\projectname\DOT - Office\Drawings\76N12\CADData\CAD\Drawings\76N12-21c-covr.cgm

USER NAME = freimuchod	DESIGNED - _____	REVISED - _____
	DRAWN - _____	REVISED - _____
PLOT SCALE = 100,0000' / in.	CHECKED - _____	REVISED - _____
PLOT DATE = 10/28/2020	DATE - _____	REVISED - _____

**STATE OF ILLINOIS
DEPARTMENT OF TRANSPORTATION**

**INDEX OF SHEETS, GENERAL NOTES, HIGHWAY STANDARDS,
MIXTURE REQUIREMENTS & COMMITMENTS**

SCALE: _____ SHEET ____ OF ____ SHEETS STA. _____ TO STA. _____

F.A.P. RTE.	SECTION	COUNTY	TOTAL SHEETS	SHEET NO.
327	14-15RS-2	CLINTON	7	2
CONTRACT NO. 76N12				
ILLINOIS FED. AID PROJECT				

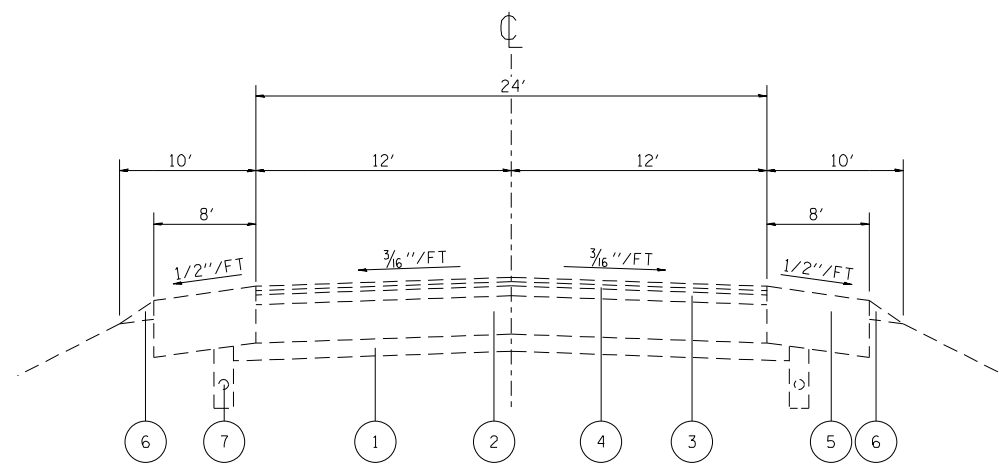

EXISTING TYPICAL SECTION

STA. 3215+00 TO STA. 3230+56.57
 STA. 3249+22.72 TO STA. 3262+00.17
 STA. 3283+00.15 TO STA. 3315+92
 *BRIDGE OMISSION STA. 3315+92 TO STA. 3322+08
 STA. 3322+08 TO STA. 3343+25.20
 STA. 3363+31.60 TO STA. 3519+15

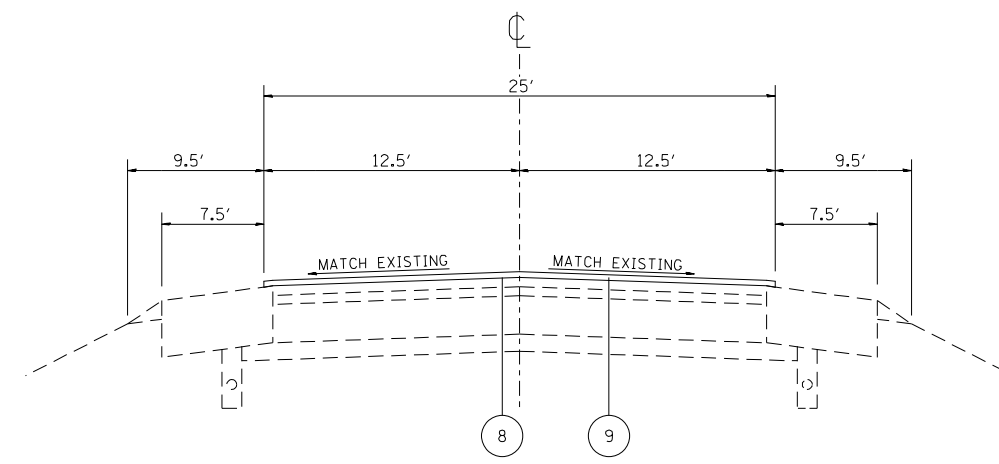

PROPOSED TYPICAL SECTION

STA. 3215+00 TO STA. 3230+56.57
 STA. 3249+22.72 TO STA. 3262+00.17
 STA. 3283+00.15 TO STA. 3315+92
 *BRIDGE OMISSION STA. 3315+92 TO STA. 3322+08
 STA. 3322+08 TO STA. 3343+25.20
 STA. 3363+31.60 TO STA. 3519+15

△ REV. 10-29-2020

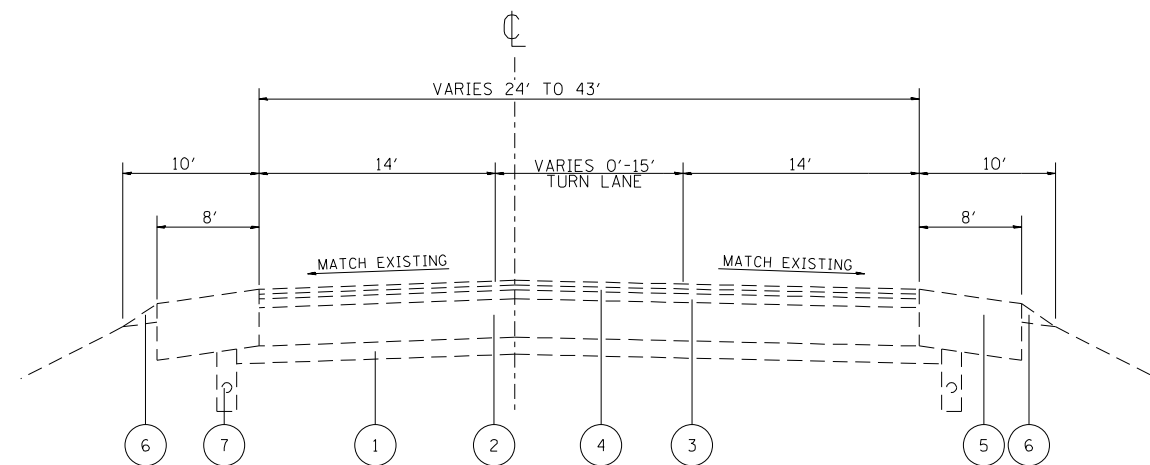

EXISTING TYPICAL SECTION

STA. 3262+00.17 TO STA. 3283+00.15
 STA. 3343+25.20 TO STA. 3363+31.60

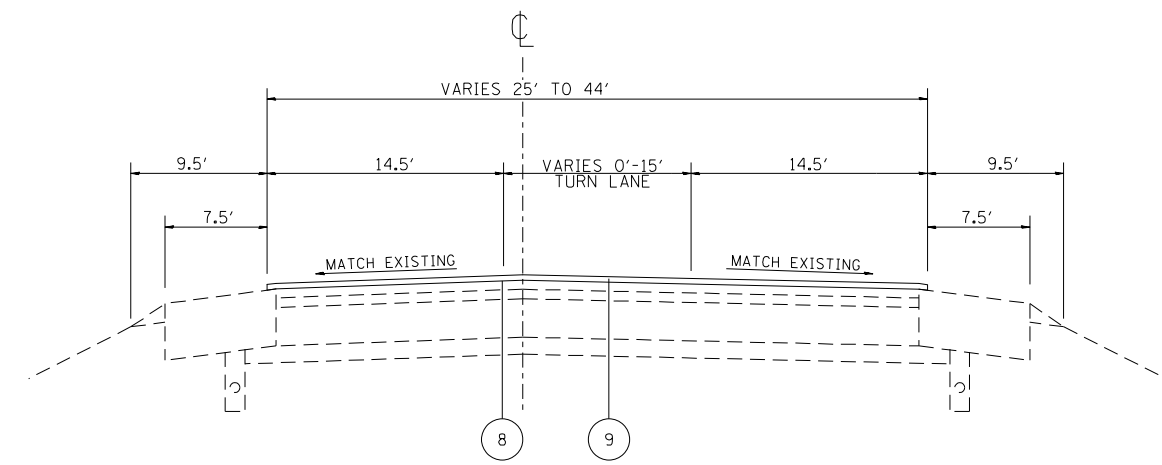

PROPOSED TYPICAL SECTION

STA. 3262+00.17 TO STA. 3283+00.15
 STA. 3343+25.20 TO STA. 3363+31.60

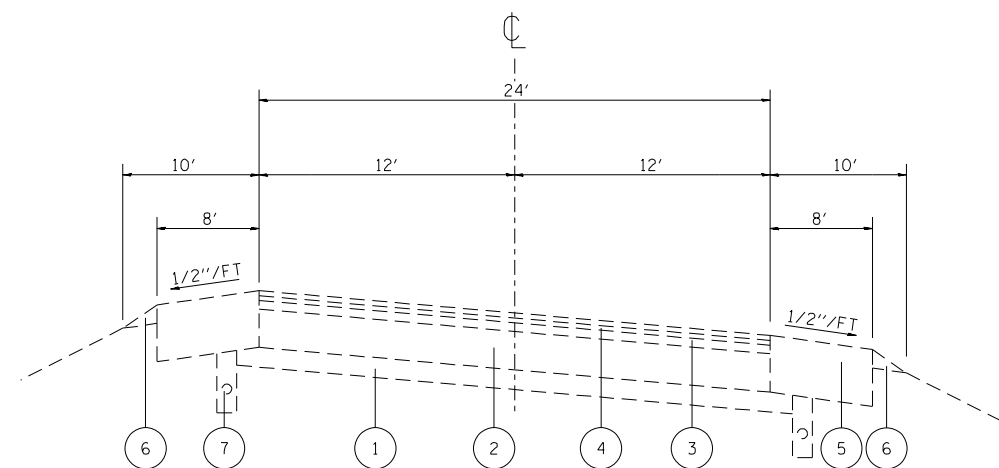

EXISTING SUPERELEVATED SECTION

STA. 3230+56.57 TO STA. 3249+22.72

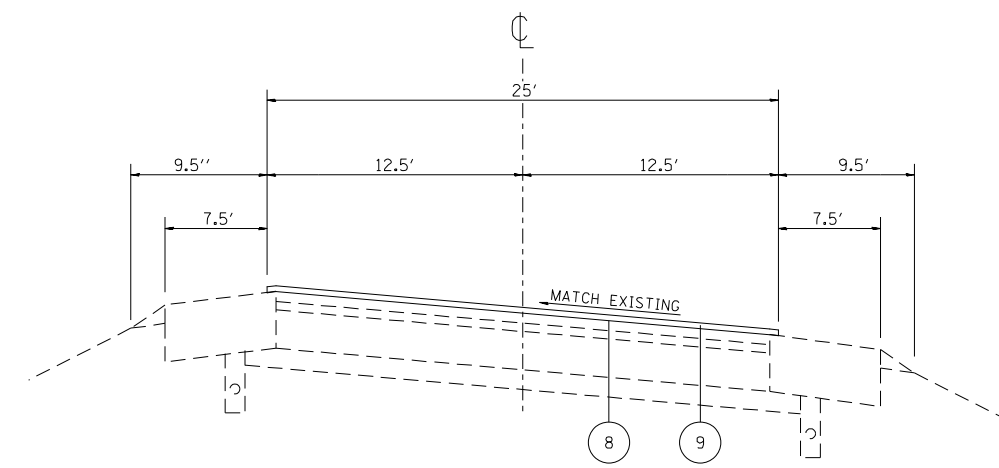

PROPOSED SUPERELEVATED SECTION

STA. 3230+56.57 TO STA. 3249+22.72

LEGEND

- ① EXISTING STABILIZED SUB-BASE 4"
- ② EXISTING PCC PAVEMENT 8"
- ③ EXISTING HMA BINDER COURSE, IL 19.0, N90, 2 1/4"
- ④ EXISTING HMA SURFACE COURSE, MIX "D", N90, 1 1/2 "
- ⑤ EXISTING HMA SHOULDERS
- ⑥ EXISTING AGGREGATE SHOULDER
- ⑦ EXISTING PIPE DRAINS 4"
- ⑧ PROPOSED BITUMINOUS MATERIAL (TACK COAT)
- ⑨ PROPOSED MICRO-SURFACING SINGLE PASS

**STATE OF ILLINOIS
 DEPARTMENT OF TRANSPORTATION**

TYPICAL SECTIONS

SCALE: NIS

SHEET 11 OF 12 SHEETS STA. _____ TO STA. _____

F.A.P. RTE.	SECTION	COUNTY	TOTAL SHEETS	SHEET NO.
327	14-15RS-2	CLINTON	7	4
			CONTRACT NO. 76N12	
			ILLINOIS FED. AID PROJECT	

MODEL: 140001.MXD FILE: 14-15RS-2.DWG PLOT DATE: 10/28/2020