

STATE OF ILLINOIS
DEPARTMENT OF TRANSPORTATION

F.A.P. RTE.	SECTION	COUNTY	TOTAL SHEETS	SHEET NO.
697	17,18)RS-4 & (127,127X)RS-3,SW	FORD	56	1
ILLINOIS			CONTRACT NO. 66K20	

D-93-086-19

INDEX OF SHEETS

- 1 COVER SHEET
- 2 GENERAL NOTES, STANDARDS & COMMITMENTS
- 3-10 SUMMARY OF QUANTITIES
- 11-12 TYPICAL SECTIONS
- 13-15 LOCATION MAP
- 16-26 SCHEDULES
- 27-31 PAVEMENT MARKING DETAILS
- 32-38 ADA DETAILS
- 39-45 GUARDRAIL & HMA STABILIZATION DETAILS
- 46 RAILROAD CROSSING DETAIL
- 47 DETECTOR LOOP DETAILS
- 48 APPROACH PAVEMENT DETAIL
- 49-54C DETAILS



PROPOSED HIGHWAY PLANS

FAP 326(IL 47), FAP 71(IL 54), FAP 697(IL 9)
SECTION ((17)SFY,Y,18)RS-4(127&X)RS-3
PROJECT NHPP-STP-HSIP-RJI5(362)
3P MILLING & RS, PATCHING ADA
FORD COUNTY

C-93-106-19



FUNCTIONAL CLASSIFICATION
RURAL MINOR ARTERIAL
2019 ADT = 2060
PV = 84.29% SU = 6.12% MU = 9.59%

STATE OF ILLINOIS
DEPARTMENT OF TRANSPORTATION

SUBMITTED August 14, 2020
James Ahmad
REGIONAL ENGINEER

October 2, 2020
Scott A. Elk
ENGINEER OF DESIGN AND ENVIRONMENT

October 2, 2020
James Ahmad
DIRECTOR OF HIGHWAYS PROJECT IMPLEMENTATION

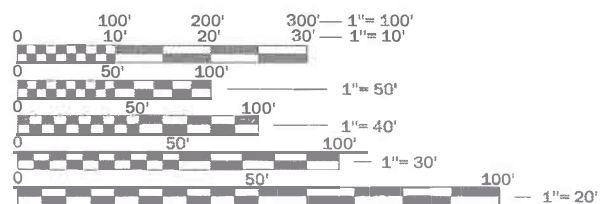
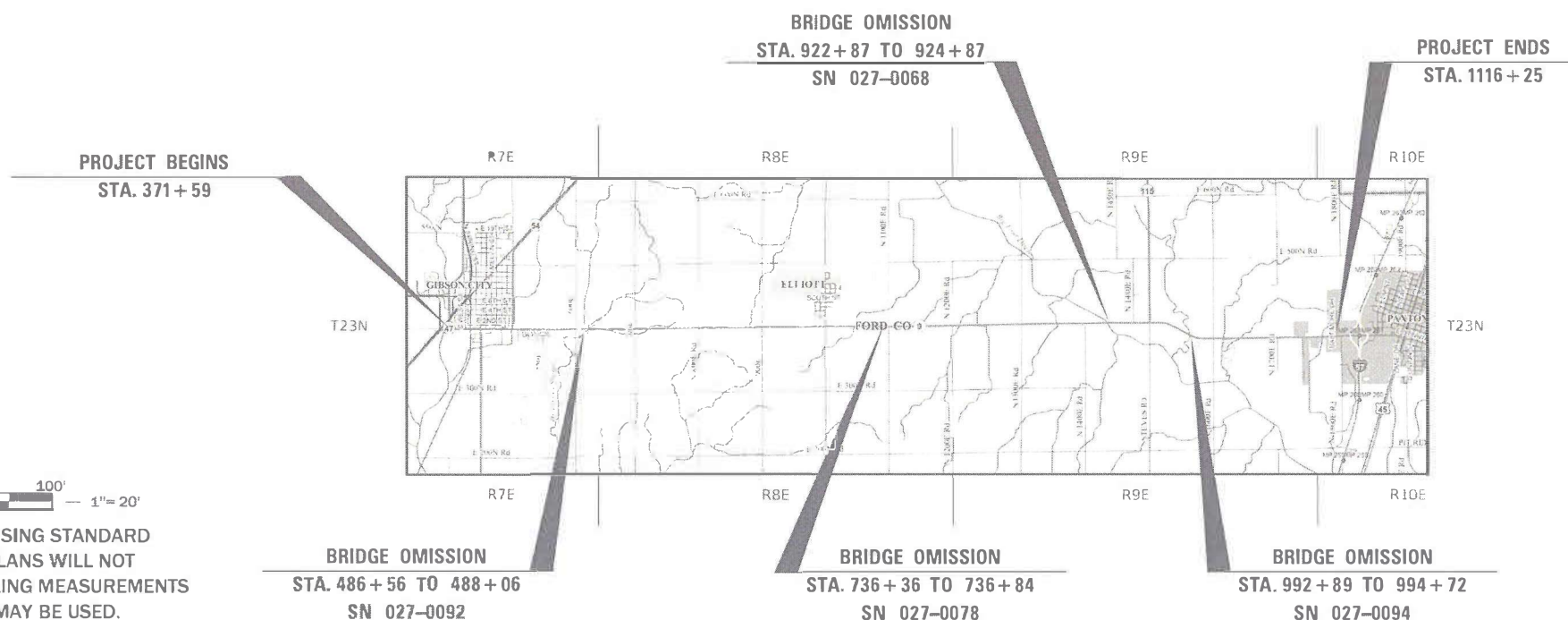

FULL SIZE PLANS HAVE BEEN PREPARED USING STANDARD ENGINEERING SCALES. REDUCED SIZED PLANS WILL NOT CONFORM TO STANDARD SCALES. IN MAKING MEASUREMENTS ON REDUCED PLANS, THE ABOVE SCALES MAY BE USED.

J.U.L.I.E.
JOINT UTILITY LOCATION INFORMATION FOR EXCAVATION
1-800-892-0123
OR 811

PROJECT ENGINEER: BRAD DUNCAN, P.E.
UNIT CHIEF: JOE ZAGAR
DISTRICT 3 NO. (815) 434-6131
CONTRACT NO. 66K20

GROSS LENGTH = 74,466 FT. = 14.10 MILE
NET LENGTH = 72,892 FT. = 13.80 MILE

PRINTED BY THE AUTHORITY OF THE STATE OF ILLINOIS

LIST OF ILLINOIS DOT HIGHWAY STANDARDS

00001-07	STANDARD SYMBOLS, ABBREVIATIONS AND PATTERNS
001006	DECIMAL OF AN INCH AND OF A FOOT
280001-07	TEMPORARY EROSION CONTROL SYSTEMS
406201-01	MAILBOX TURNOUT
420001-09	PAVEMENT JOINTS
424001-11	PERPENDICULAR CURB RAMPS FOR SIDEWALKS
424006-04	DIAGONAL CURB RAMPS FOR SIDEWALKS
424011-04	CORNER PARALLEL CURB RAMPS FOR SIDEWALKS
442101-09	CLASS B PATCHES
442201-03	CLASS C AND D PATCHES
482001-02	HMA SHOULDER ADJACENT TO FLEXIBLE PAVEMENT
482006-03	HMA SHOULDER ADJACENT TO RIGID PAVEMENT
606001-07	CONCRETE CURB TYPE B AND COMBINATION CONCRETE CURB AND GUTTER
630001-12	STEEL PLATE BEAM GUARDRAIL
630106-02	LONG-SPAN GUARDRAIL OVER CULVERT
630201-07	PCC/HMA STABILIZATION AT STEEL PLATE BEAM GUARDRAIL
630301-09	SHOULDER WIDENING FOR TYPE 1 (SPECIAL) GUARDRAIL TERMINALS
631026-06	TRAFFIC BARRIER TERMINAL, TYPE 5
631031-16	TRAFFIC BARRIER TERMINAL, TYPE 6
642006	SHOULDER RUMBLE STRIPS, 8 INCH
667101-02	PERMANENT SURVEY MARKERS
701001-02	OFF-ROAD OPERATIONS 2L, 2W, MORE THAN 15' (4.5 m) AWAY
701006-05	OFF-ROAD OPERATIONS 2L, 2W, 15' (4.5 m) TO 24" (600 mm) FROM
701201-05	LANE CLOSURE, 2L, 2W, DAY ONLY, FOR SPEEDS ≥ 45 MPH
701306-04	LANE CLOSURE, 2L, 2W, SLOW MOVING OPERATIONS DAY ONLY, FOR SPEEDS ≥ 45 MPH
701311-03	LANE CLOSURE, 2L, 2W, MOVING OPERATIONS - DAY ONLY
701326-04	LANE CLOSURE, 2L, 2W, PAVEMENT WIDENING, FOR SPEEDS ≥ 45 MPH
701501-06	URBAN LANE CLOSURE, 2L, 2W, UNDIVIDED
701801-06	SIDEWALK, CORNER OR CROSSWALK CLOSURE
701901-08	TRAFFIC CONTROL DEVICES
725001-01	OBJECT AND TERMINAL MARKERS
780001-05	TYPICAL PAVEMENT MARKINGS
781001-04	TYPICAL APPLICATIONS RAISED REFLECTIVE PAVEMENT MARKERS
782006-01	GUARDRAIL AND BARRIER WALL REFLECTOR MOUNTING DETAILS
876001-04	PEDESTRIAN PUSH BUTTON POST

GENERAL NOTES

THE THICKNESS OF HMA SHOWN ON THE PLANS IS THE NOMINAL THICKNESS. DEVIATIONS FROM THE NOMINAL THICKNESS WILL BE PERMITTED WHEN SUCH DEVIATIONS OCCUR DUE TO IRREGULARITIES IN THE EXISTING SURFACE OR BASE ON WHICH THE HMA IS PLACED.

THE HMA SURFACE OF ALL MAILBOX TURNOUTS, PRIVATE ENTRANCES, COMMERCIAL ENTRANCES, AND SIDE ROADS SHALL BE MADE NEATLY, IN A WORKMANLIKE MANNER, AND SHALL ACCURATELY CONFORM TO THE SHAPES AND DIMENSIONS SHOWN ON THE PLAN DETAILS. IF REQUIRED BY THE ENGINEER, THE CONTRACTOR SHALL SAW CUT THE HMA SURFACE TO CONFORM TO THE SHAPES AND DIMENSIONS SHOWN ON THE PLAN DETAILS. THIS WORK WILL BE INCLUDED IN THE COST OF THE HMA SURFACE.

EXCEPT AS NOTED ON THE PLANS, PAVEMENT GRADES SHOWN ARE AT THE TOP OF PAVEMENT SURFACES.

THE ENGINEER WILL BE THE SOLE JUDGE CONCERNING CURING TIME FOR THE VARIOUS HMA LIFTS.

SEEDING WILL NOT BE PERMITTED AT ANY TIME WHEN THE GROUND IS FROZEN, WET, OR IN AN UNTILLABLE CONDITION. LOCATIONS TO BE SEEDED WILL BE DETERMINED BY THE ENGINEER.

THE FINISHED EARTHWORK SHALL HAVE A VEGETATION SUSTAINING SOIL COVERING THE TOP FOUR INCHES (100 MILLIMETERS) IN AREAS TO BE SEEDED OR SODDED. THE VEGETATION SUSTAINING SOIL REQUIRED WILL NOT BE PAID FOR SEPARATELY BUT WILL BE INCLUDED IN THE COST OF GRADING AND SHAPING DITCHES.

DETECTABLE WARNING SURFACES SHALL EXTEND 2.0 FT MINIMUM IN THE DIRECTION OF PEDESTRIAN TRAVEL. AT CURB RAMPS AND BLENDED TRANSITIONS, DETECTABLE WARNING SURFACES SHALL EXTEND THE FULL WIDTH OF THE RAMP RUN (EXCLUDING ANY FLARES) OR BLENDED TRANSITIONS. SOME DETECTABLE WARNING PRODUCTS REQUIRE A CONCRETE BORDER FOR PROPER INSTALLATION. THE CONCRETE BORDER SHALL NOT EXCEED 2 INCHES.

ALL ELEVATIONS REFERRING TO U.S.G.S. MEAN SEA LEVEL DATUM.

ANY REFERENCE TO A STANDARD IN THESE PLANS SHALL BE INTERPRETED TO MEAN THE EDITION AS INDICATED BY THE SUBNUMBER SHOWN IN THE LIST OF STANDARDS OR THE COPY INCLUDED IN THESE PLANS.

THE FOLLOWING RATES OF APPLICATION HAVE BEEN USED IN CALCULATING PLAN QUANTITIES:

GRANULAR MATERIALS	2.05	TONS / CU YD
HMA RESURFACING	112	LBS / SQ YD / IN
SHORT TERM PAVEMENT MARKING	10	FT /100 FT OF APPLICATION
MIX FOR CRACKS, JTS & FLGWYS	0.0003	TONS / SQ YD
LEVEL BINDER (HAND METHOD)	0.0005	TONS / SQ YD
SUPPLEMENTAL WATERING	3	GAL / SQ YD / APPLICATION
CALCIUM CHLORIDE	2	LB / SQ YD / APPLICATION
AGGREGATE DITCH CHECKS	5	TONS AGGREGATE

THE CONTRACTOR'S ATTENTION IS DIRECTED TO THE PRESENCE OF DEPARTMENT-OWNED UNDERGROUND ELECTRICAL CABLE WITHIN THE LIMITS OF THE PROPOSED IMPROVEMENT. THE CONTRACTOR SHALL REQUEST THE ILLINOIS DEPARTMENT OF TRANSPORTATION IN OTTAWA (815-434-8417) TO LOCATE THE UNDERGROUND FACILITIES, PROVIDING A MINIMUM OF 72 HOURS NOTICE. THE DEPARTMENT IS NOT A MEMBER OF THE JOINT UTILITY LOCATING INFORMATION FOR EXCAVATORS (JULIE) SYSTEM.

ALL DAMAGE TO DEPARTMENT OWNED UNDERGROUND FACILITIES, CAUSED BY THE CONTRACTOR SHALL BE REPAIRED TO THE SATISFACTION OF THE DEPARTMENT AT THE CONTRACTOR'S EXPENSE. THIS SHALL INCLUDE ALL TEMPORARY REPAIRS REQUIRED TO KEEP THE FACILITY OPERATIONAL WHILE MATERIAL IS BEING OBTAINED TO MAKE PERMANENT REPAIRS. SPLICING OF ELECTRIC CABLE WILL NOT BE ALLOWED. ELECTRIC CABLE SHALL BE REPLACED FROM POLE TO POLE OR CONTROLLER.

MEMBERS OF JULIE KNOWN TO BE WITHIN THE LIMITS OF THE IMPROVEMENT ARE:
AT&T, AMEREN CIPS, METRO COMMUNICATIONS, NICOR, MEDIACOM, AND GIBSON CITY

THE CONTRACTOR SHALL CONTACT JULIE AT LEAST 48 HOURS PRIOR TO EXCAVATION TO DETERMINE WHICH UTILITIES ARE IN THE AREA.

STATE OF ILLINOIS
DEPARTMENT OF TRANSPORTATION
DISTRICT THREE
AS BUILT INFORMATION

SUPERVISING CONSTRUCTION FIELD ENGINEER

RESIDENT ENGINEER / TECHNICIAN

START & END DATES
OF CONSTRUCTION:

INSPECTORS:

STATE OF ILLINOIS
DEPARTMENT OF TRANSPORTATION
DISTRICT THREE

PREPARED BY: _____
DISTRICT STUDIES & PLANS ENGINEER

DATE: _____

EXAMINED BY: _____
DISTRICT CONSTRUCTION ENGINEER

DISTRICT MATERIALS ENGINEER

DISTRICT OPERATIONS ENGINEER

STATE OF ILLINOIS
DEPARTMENT OF TRANSPORTATION

GENERAL NOTES, STANDARDS & COMMITMENTS

SCALE: SHEET 2 OF 2 SHEETS STA. TO STA.

F.A.P. RTE.	SECTION	COUNTY	TOTAL SHEETS	SHEET NO.
697(17,18)RS-4 & (127,127X)RS-3,SW	FORD	54	2	
CONTRACT NO. 66K20				
ILLINOIS FED. AID PROJECT				

MOE:\1 - Default FILE NAME: p:\pub\barcom.dwt I:\roads\pwr\DOT\Documents\DOT - Offices\Dist3\1 - Projects\0366K20\CAD\Drawn\0366K20-shk-cover.dgn

CODE NO.	ITEM	UNIT	TOTAL QUANTITY	CONSTRUCTION CODE		
				STP-RURAL 80% FEDERAL/20% STATE	NHPP 80% FEDERAL/20% STATE	HSIP 90% FEDERAL/10% STATE
				ROADWAY	ROADWAY	SAFETY
				0005 RURAL	0005 RURAL	0021 RURAL
20400800	FURNISHED EXCAVATION	CU YD	70	70		
21400100	GRADING AND SHAPING DITCHES	FOOT	1350	1350		
25000210	SEEDING, CLASS 2A	ACRE	0.9	0.9		
25000400	NITROGEN FERTILIZER NUTRIENT	POUND	81	81		
25000500	PHOSPHORUS FERTILIZER NUTRIENT	POUND	81	81		
25000600	POTASSIUM FERTILIZER NUTRIENT	POUND	81	81		
25100630	EROSION CONTROL BLANKET	SQ YD	4356	4356		
28000250	TEMPORARY EROSION CONTROL SEEDING	POUND	126	126		
28000305	TEMPORARY DITCH CHECKS	FOOT	360	360		
40200800	AGGREGATE SURFACE COURSE, TYPE B	TON	167	167		
40600290	BITUMINOUS MATERIALS (TACK COAT)	POUND	132785	118701	5052	9032
40600400	MIXTURE FOR CRACKS, JOINTS, AND FLANGEWAYS	TON	60	58	2	
40600900	HOT-MIX ASPHALT BINDER COURSE (HAND METHOD), N50	TON	100	96	4	
40600990	TEMPORARY RAMP	SQ YD	4755	4130	625	
40602978	HOT-MIX ASPHALT BINDER COURSE, IL- 9.5, N50	TON	17692	16895	797	

MODEL: Default
 FILE NAME: p:\pub\barcom.dwg
 PROJECT: P:\DOT\Documents\DOT_Offices\Bartlett_3\Projects\0366K20\0366K20-01-500.dwg

USER NAME = ZAGARIK	DESIGNED -	REVISED -
PLOT SCALE = 100.0000' / in.	DRAWN -	REVISED -
PLOT DATE = 8/13/2020	CHECKED -	REVISED -
	DATE -	REVISED -

**STATE OF ILLINOIS
DEPARTMENT OF TRANSPORTATION**

SUMMARY OF QUANTITIES

SCALE: SHEET 1 OF 8 SHEETS STA. TO STA.

F.A.P. RTE.	SECTION	COUNTY	TOTAL SHEETS	SHEET NO.
697(17,18)RS-4 & (127,127X)RS-3,SW		FORD	54	3
CONTRACT NO. 66K20				
ILLINOIS FED. AID PROJECT				

CODE NO.	ITEM	UNIT	TOTAL QUANTITY	CONSTRUCTION CODE		
				STP-RURAL 80% FEDERAL/20% STATE	NHPP 80% FEDERAL/20% STATE	HSIP 90% FEDERAL/10% STATE
				ROADWAY	ROADWAY	SAFETY
				0005 RURAL	0005 RURAL	0021 RURAL
40604050	HOT-MIX ASPHALT SURFACE COURSE, IL-9.5, MIX "C", N50	TON	20158	19461	697	
40800050	INCIDENTAL HOT-MIX ASPHALT SURFACING	TON	804	722	82	
42400100	PORTLAND CEMENT CONCRETE SIDEWALK 4 INCH	SQ FT	1614	782	832	
* 42400800	DETECTABLE WARNINGS	SQ FT	158	80	78	
44000157	HOT-MIX ASPHALT SURFACE REMOVAL, 2"	SQ YD	48958	48958		
44000164	HOT-MIX ASPHALT SURFACE REMOVAL, 3 3/4"	SQ YD	173302	166188	7114	
44000500	COMBINATION CURB AND GUTTER REMOVAL	FOOT	263	126	137	
44000600	SIDEWALK REMOVAL	SQ FT	1506	759	747	
44200050	WELDED WIRE REINFORCEMENT	SQ YD	1091	442	649	
44200956	CLASS B PATCHES, TYPE II, 9 INCH	SQ YD	676	348	328	
44200962	CLASS B PATCHES, TYPE III, 9 INCH	SQ YD	281	64	217	
44200964	CLASS B PATCHES, TYPE IV, 9 INCH	SQ YD	134	30	104	
44201299	DOWEL BARS 1 1/2"	EACH	2384	1048	1336	
44213200	SAW CUTS	FOOT	5231	2220	3011	
44213201	TIE BARS 3/4"	EACH	547	222	325	

*= SPECIALTY ITEM

MOEEL: Default
FILE NAME: p:\pub\barcom.dwg
PROJECTS\DOT\Documents\DOT Office\Drawings\Projects\366K20\366K20-INT-500.dwg

USER NAME = ZAGARIK	DESIGNED -	REVISED -
PLOT SCALE = 100.0000' / in.	CHECKED -	REVISED -
PLOT DATE = 8/13/2020	DATE -	REVISED -

**STATE OF ILLINOIS
DEPARTMENT OF TRANSPORTATION**

SUMMARY OF QUANTITIES

SCALE: SHEET 2 OF 8 SHEETS STA. TO STA.

F.A.P. RTE.	SECTION	COUNTY	TOTAL SHEETS	SHEET NO.
697(17,18)RS-4 & (127,127X)RS-3,SW	FORD		54	4
CONTRACT NO. 66K20			ILLINOIS FED. AID PROJECT	

SIDEROAD SCHEDULE														
STATION	LOCATION	SIDE	TYPE	MATERIAL	LENGTH	WIDTH AT MAINLINE	WIDTH	HMA SURFACE	INC	HMA	HMA	BIT.	TEMP.	FURN
								REMOVAL VARIABLE DEPTH	HMA SURF	SURF REM 2"	SC IL-9.5 C N50 (2")	MAT. (TACK COAT)	RAMP	EXC
					FOOT	FOOT	FOOT	SQ YD	TON	SQ YD	TON	POUND	SQ YD	CU YD
NHPP														
373+59	IL-9/IL-47	LT	SR	HMA	52	208	30	447	66			201	331	
387+06	WEST ST	LT	SR	HMA	30	71	26	111	16			50	135	
400+02	SANGAMON AVE	LT	SR	PCC										
400+02	S SANGAMON AVE/IL-47	RT	SR	PCC										
NHPP SUB TOTAL								558	82			251	466	
STP-RURAL														
404+40	CHURCH ST	LT	SR	PCC										
408+72	LOTT BLVD	LT	SR	HMA	30	86	40	100	15			45	175	
408+72	S LOTT BLVD	RT	SR	PCC										
417+32	WOOD ST	LT	SR	HMA	30	71	26	111	16			50	135	
417+32	WOOD ST	RT	SR	HMA	30	71	26	111	16			50	135	
426+42	LAWRENCE ST/IL-54	LT	SR	HMA				SEE MAINLINE SCHEDULE						
430+90	ILLINOIS DR	RT	SR	HMA	30	73.5	26	139	20			63	138	2
439+14	CHAPEL DR	RT	SR	HMA	30	50	21	102	15			46	99	2
447+21	FULTON ST	RT	SR	HMA	30	47	21	99	15			45	94	2
452+42	N 550 E RD	RT	SR	HMA	30	54	20	104	15			47	103	2
479+12	N 600 E RD	LT	SR	HMA	30	49	20	99	15			45	96	2
479+12	N 600 E RD	RT	SR	HMA	30	55	21	108	16			49	106	2
528+77	N 700 E RD	LT	SR	HMA	30	50	18	96	14			43	94	2
528+77	N 700 E RD	RT	SR	HMA	30	58	20	109	16			49	108	2
581+92	N 800 E RD	LT	SR	HMA	30	50	18	96	14			43	94	2
581+92	N 800 E RD	RT	SR	HMA	30	54	20	104	15			47	103	2
634+79	N 900 E RD	LT	SR	HMA	30	44	18	89	13			40	86	2
634+79	N 900 E RD	RT	SR	HMA	30	54	18	100	15			45	100	2
687+64	N 1000 E RD/ELLIOT RD	LT	SR	HMA	30	82	32	162	24			73	158	
687+64	N 1000 E RD	RT	SR	HMA	30	80	42	182	27			82	169	4
741+02	N 1100 E RD	LT	SR	HMA	30	38	20	87	13			39	81	2
741+02	N 1100 E RD	RT	SR	HMA	30	52	20	102	15			46	100	2
794+00	N 1200 E RD	LT	SR	HMA	30	51	20	101	15			45	99	2
794+00	N 1200 E RD	RT	SR	HMA	10	43	20	31	5			14	88	2
851+31	N 1300 E RD	LT	SR	HMA	30	57	18	103	15			46	104	4
851+31	N 1300 E RD	RT	SR	HMA	30	65	20	117	17			53	118	4
901+71	N 1400 E RD	RT	SR	HMA	30	53	24	112	16			50	107	2
944+87	N 1480 E RD	LT	SR	HMA	30	52	22	107	16			48	103	2
958+26	IL-115	LT	SR	HMA	30	157	40			263	29	0	116	10
958+26	N 1500 E RD	RT	SR	HMA	30	72	22	129	13			58	53	4
1014+16	N 1600 E RD	LT	SR	HMA	30	59	20	110	11			50	44	2
1014+16	N 1600 E RD	RT	SR	HMA	30	73	22	130	13			59	54	4
1067+25	N 1700 E RD	RT	SR	HMA	30	53	14	90	9			41	39	2
1101+55	INDUSTRIAL PARK DR	RT	SR	PCC										
STP-RURAL SUB TOTAL								3,130	439	263	29	1,411	3,099	70
NHPP TOTAL								558	82			251	466	
STP-RURAL TOTAL								3,130	439	263	29	1,411	3,099	70
GRAND TOTAL								3,688	521	263	29	1,662	3,565	70

ENTRANCE SCHEDULE													
STATION	SIDE	TYPE	MATERIAL	LENGTH	WIDTH AT MAINLINE	WIDTH	HMA SURF	INCIDENTAL	AGG	BIT			
							REM VAR DP	HMA SURF	SURF CSE B (1")	MATLS TACK CT			
				FOOT	FOOT	FOOT	SQ YD	TON	TON	POUND			
IL-9 STP-RURAL													
433+20	RT	PE	HMA	10	44	20	31	5		14			
433+44	RT	MBTO	HMA				21	3		9			
434+26	RT	PE	HMA	10	35	23	30	4		14			
434+48	RT	MBTO	HMA				19	3		9			
435+23	RT	PE	HMA	10	45	26	36	5		16			
435+45	RT	MBTO	HMA				7	1		3			
435+72	RT	PE	HMA	10	30	15	22	3		10			
435+87	RT	MBTO	HMA				5	1		2			
437+17	RT	PE	HMA	15	34	20	41	6		18			
437+42	LT	FE	AGG	21	54	24			5.0				
442+64	RT	PE	HMA	10	32	15	23	3		10			
443+50	RT	PE	HMA	10	34	19	27	4		12			
444+70	RT	PE	HMA	10	27	12	19	3		9			
450+29	RT	PE	HMA	10	30	19	25	4		11			
452+69	LT	FE	AGG	24	54	24			5.0				
456+48	RT	PE	HMA	10	25	13	19	3		9			
482+37	LT	PE	HMA	10	37	18	27	4		12			
491+53	RT	FE	AGG	17	54	24			4.0				
498+84	LT	FE	AGG	24	54	24			5.0				
511+57	LT	FE	AGG	21	54	24			5.0				
539+16	LT	PE	AGG	10	35	15			1.0				
549+83	RT	PE	HMA	10	38	21	30	4		14			
565+35	LT	FE	AGG	17	54	24			4.0				
571+39	LT	PE	HMA	10	36	16	25	4		11			
616+97	LT	FE	AGG	17	54	24			4.0				
619+64	LT	PE	HMA	30	37	17	79	12		36			
627+64	LT	FE	AGG	22	54	24			5.0				
641+77	LT	CE	AGG	10	52	40			3.0				
641+77	RT	FE	AGG	18	54	24			4.0				
650+59	RT	CE	HMA	10	60	40	52	8		23			
680+80	LT	FE	AGG	20	54	24			4.0				
685+86	RT	CE	HMA	10	72	43	59	9		27			
713+70	LT	FE	AGG	18	54	24			4.0				
722+97	RT	MBTO	HMA				12	2		5			
723+20	RT	PE	HMA	10	80	19	44	6		20			
725+12	RT	FE	AGG	17	54	24			4.0				
732+02	RT	FE	AGG	17	54	24			4.0				
733+98	LT	FE	AGG	18	54	24			4.0				
744+55	RT	MBTO	HMA				26	4		12			
744+70	LT	PE	HMA	10	36	17	26	4	2.0	9			
746+99	RT	PE	AGG										
747+13	RT	MBTO	AGG										
748+14	RT	FE	AGG	15	50	20			3.0				
759+17	LT	FE	AGG	18	45	15			3.0				
761+96	RT	MBTO	HMA				9	1		4			
762+11	RT	PE	HMA	10	87	16	44	6		15			
763+61	RT	FE	AGG	17	54	24			4.0				
768+15	LT	FE	AGG	20	54	24			4.0				
777+18	RT	FE	AGG	16	54	24			4.0				
780+57	RT	MBTO	HMA				40	6		18			
781+21	RT	PE	HMA	10	43	20	31	5		14			
782+11	RT	FE	AGG	18	54	24			4.0				
782+34	LT	PE	AGG	10	40	15			1.0				
799+00	LT	FE	AGG	37	54	24			7.0				
801+60	LT	FE	AGG	44	54	24			8.0				
808+95	RT	PE	HMA	10	52	33	44	6		20			
816+58	LT	FE	AGG	44	54	24			8.0				
824+66	RT	FE	AGG	12	54	24			3.0				
831+41	LT	FE	AGG	24	54	24			5.0				
838+01	LT	FE	AGG	19	54	24			4.0				
838+01	RT	FE	AGG	14	54	24			4.0				
854+32	LT	PE	HMA	10	35	18	26	4		12			
854+57	LT	MBTO	HMA				20	3		9			
855+95	LT	FE	AGG	18	54	24			4.0				

MOE:\1\Defult FILE NAME: Proj\pub\arcom.dwg I:\bids\pwr\DOT\Documents\DOT Office\Bartlett_3\Projects\036620\036620-schedules.dwg

USER NAME = ZAGARIK	DESIGNED -	REVISED -
	DRAWN -	REVISED -
PLOT SCALE = 100.0000' / in.	CHECKED -	REVISED -
PLOT DATE = 10/16/2020	DATE -	REVISED -

**STATE OF ILLINOIS
DEPARTMENT OF TRANSPORTATION**

SCHEDULES			
SCALE:	SHEET 2	OF 11 SHEETS	STA. TO STA.

F.A.P. RTE.	SECTION	COUNTY	TOTAL SHEETS	SHEET NO.
697(17,18)RS-4 & (127,127X)RS-3,SW	FORD		54	17
CONTRACT NO. 66K20				
ILLINOIS FED. AID PROJECT				

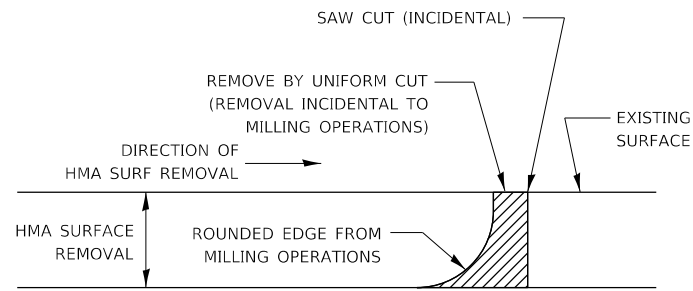

NOTE:
 WHEN MILLING OPERATIONS PRODUCE A ROUNDED EDGE, THEN A SAW CUT SHALL BE USED TO MANUFACTURE A PERPENDICULAR EDGE AS SHOWN IN THE DETAIL. THE ENGINEER SHALL BE THE SOLE JUDGE CONCERNING THE USE OF THIS DETAIL

HMA DETAIL AT BUTT JOINTS

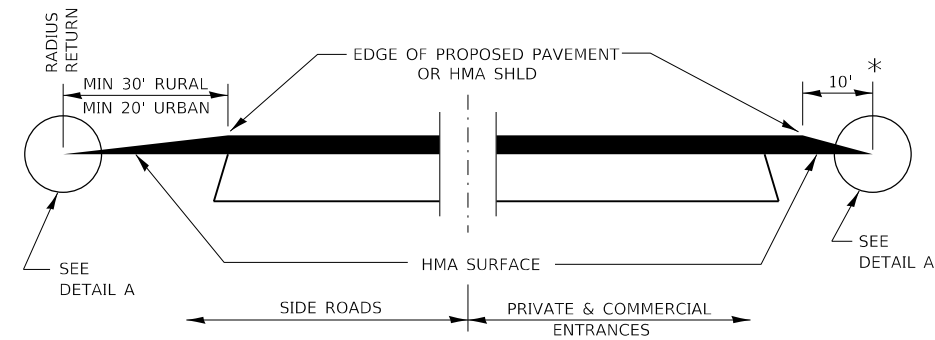
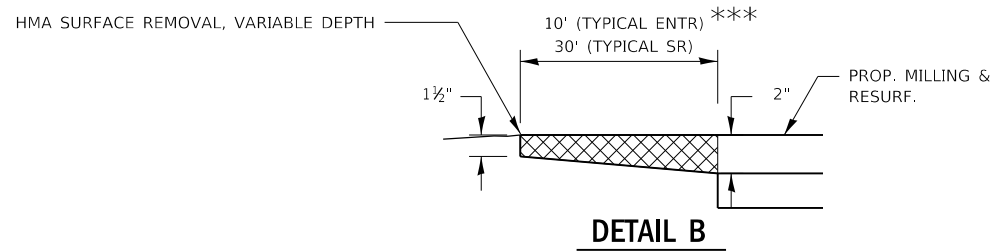

**SECTION A-A
 DETAILS AT ENTRANCES & SIDE ROADS**

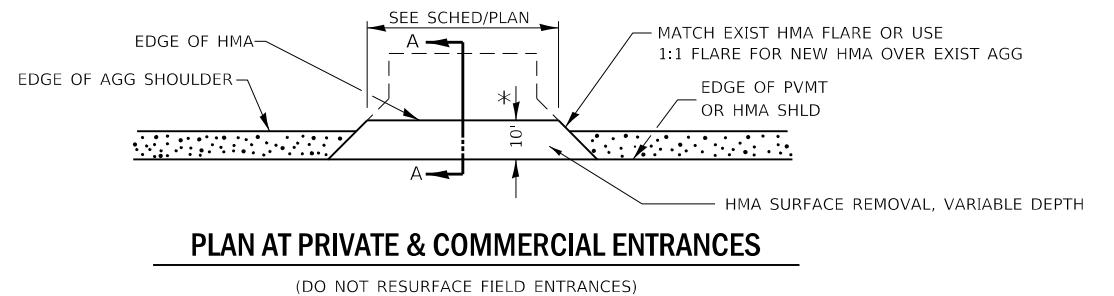
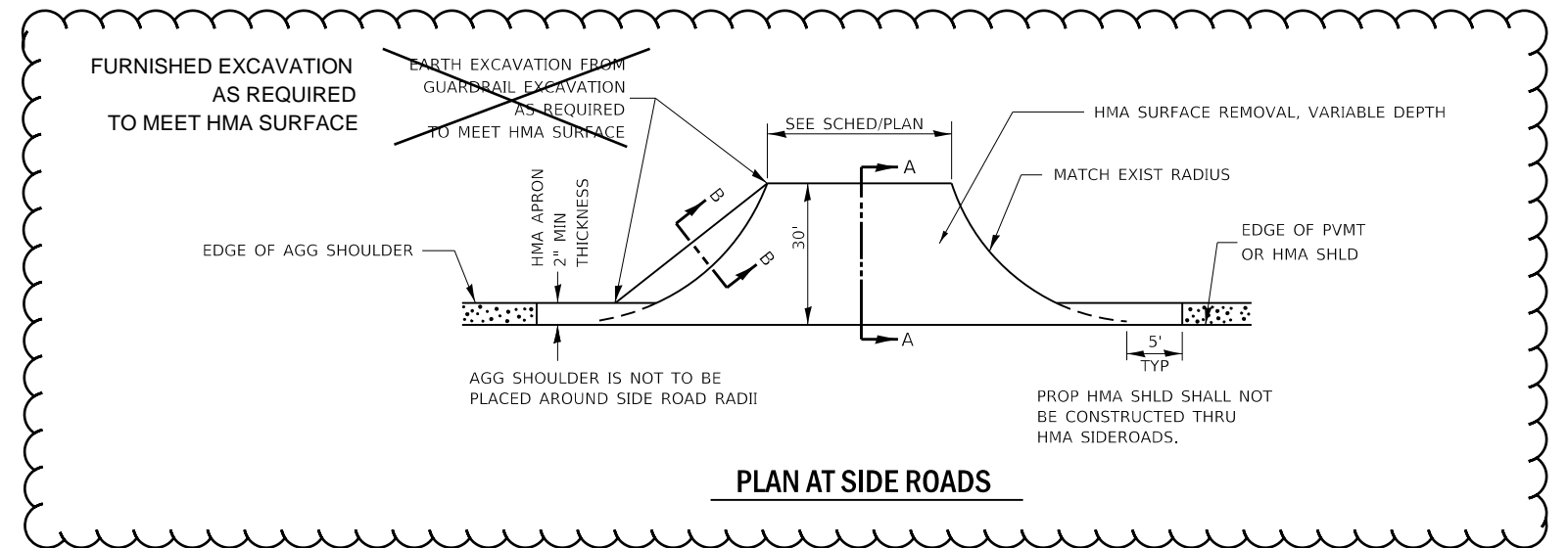
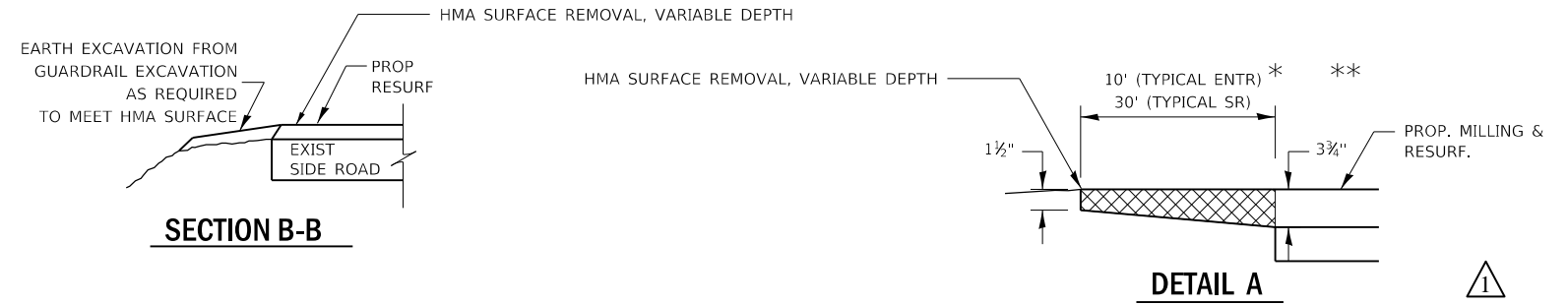

PLAN AT PRIVATE & COMMERCIAL ENTRANCES

(DO NOT RESURFACE FIELD ENTRANCES)

- ** PROPOSED HMA RESURFACING AT SIDEROADS & ENTRANCES STA 371+59 TO 957+56.
- *** PROPOSED HMA RESURFACING AT SIDEROADS & ENTRANCES STA 957+56 TO 1116+25.

**STATE OF ILLINOIS
 DEPARTMENT OF TRANSPORTATION**

DETAILS

SCALE: SHEET 1 OF 6 SHEETS STA. TO STA.

F.A.P. RTE.	SECTION	COUNTY	TOTAL SHEETS	SHEET NO.
697(17,18)RS-4 & (127,127X)RS-3,SW	FORD		54	49
CONTRACT NO. 66K20				
ILLINOIS FED. AID PROJECT				

MOEFL Default
 FILE NAME: p:\pub\planroom.dwt
 I:\projects\66K20\Documents\DOT_Offices\Detailt_3\Projects\66K20\CADD\plan\66K20-entr-detail1.dgn

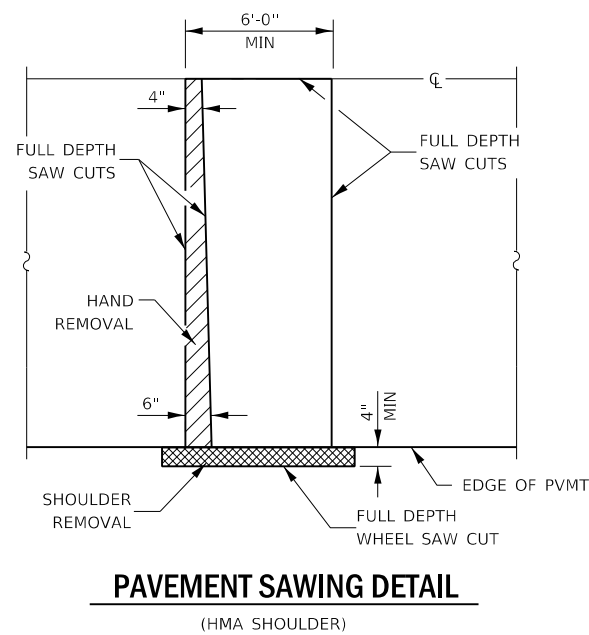

PAVEMENT SAWING DETAIL
(HMA SHOULDER)

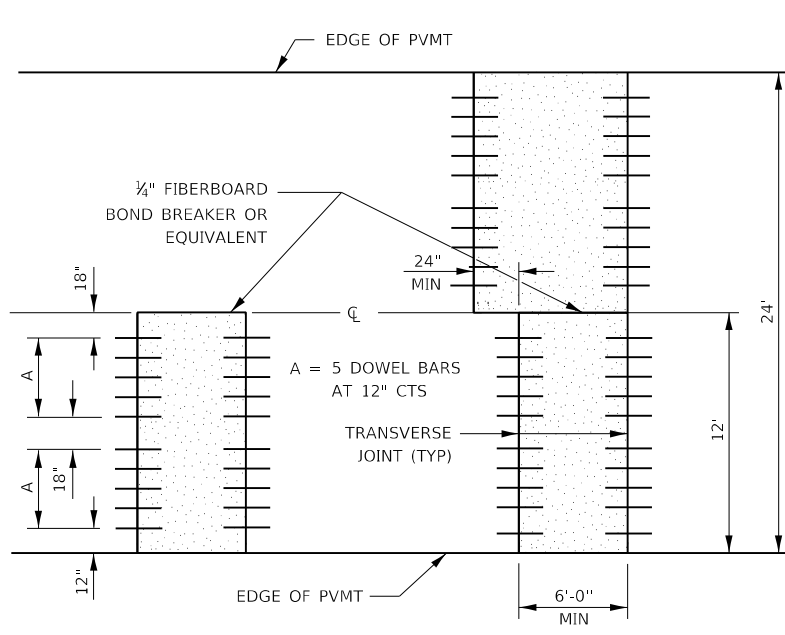

12' WIDE LANES

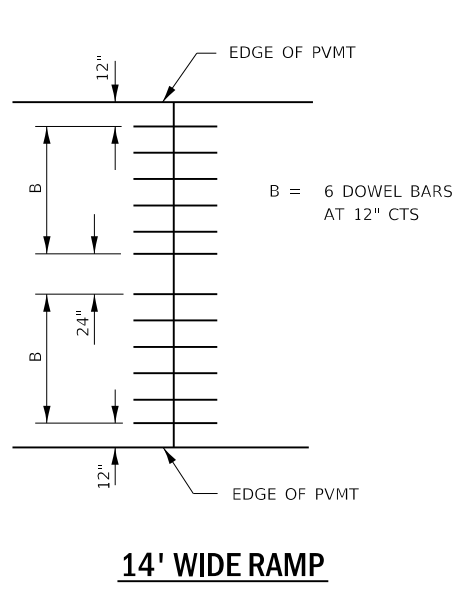

14' WIDE RAMP

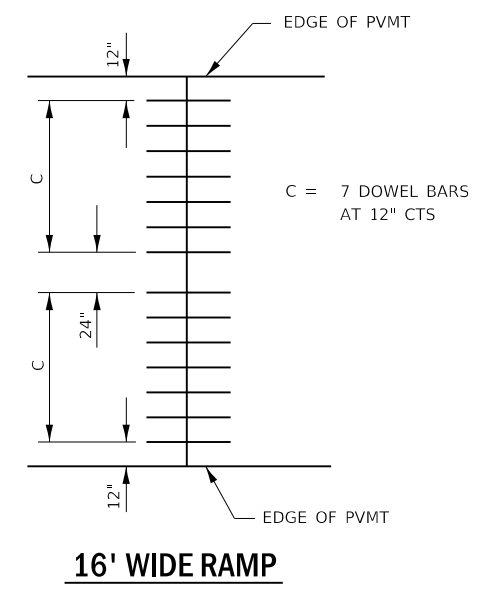

16' WIDE RAMP

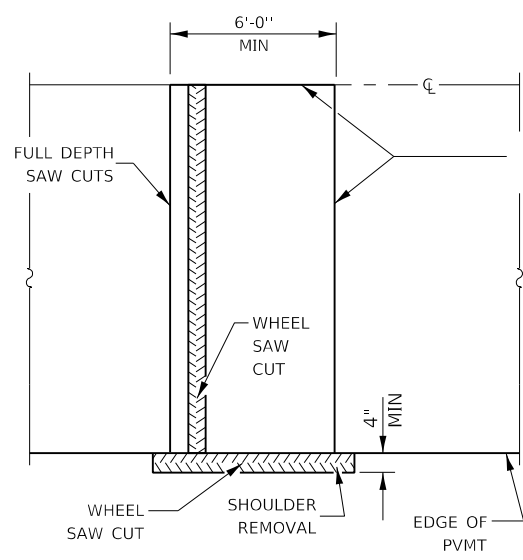

ALTERNATE SAWING DETAIL
(HMA SHOULDER)

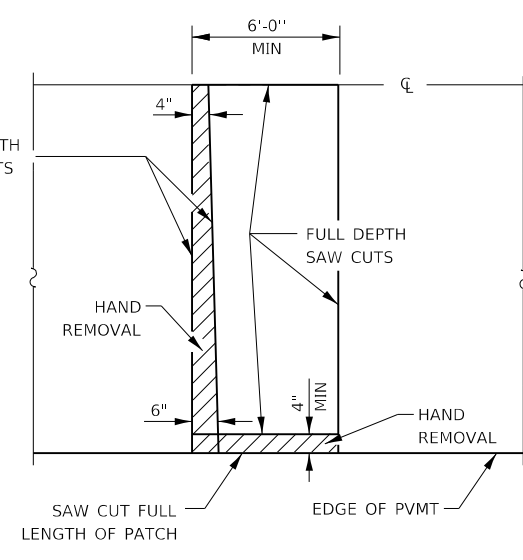

PAVEMENT SAWING DETAIL
(PCC SHOULDER)

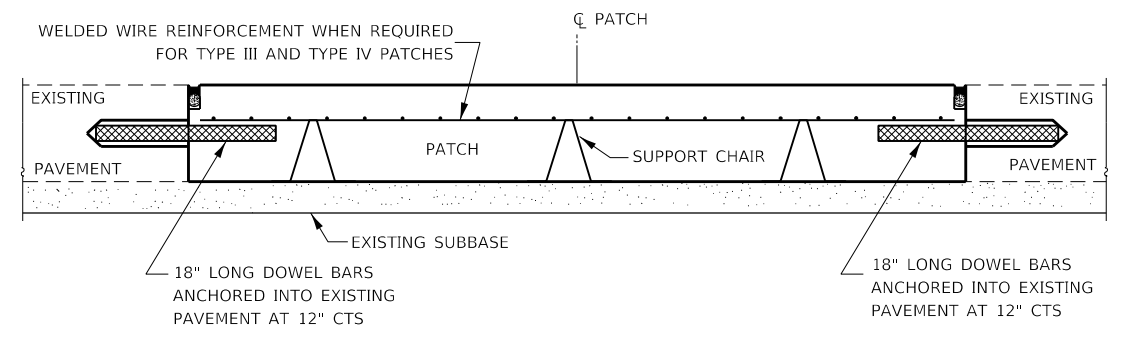

PATCHING WITHOUT HMA OVERLAY

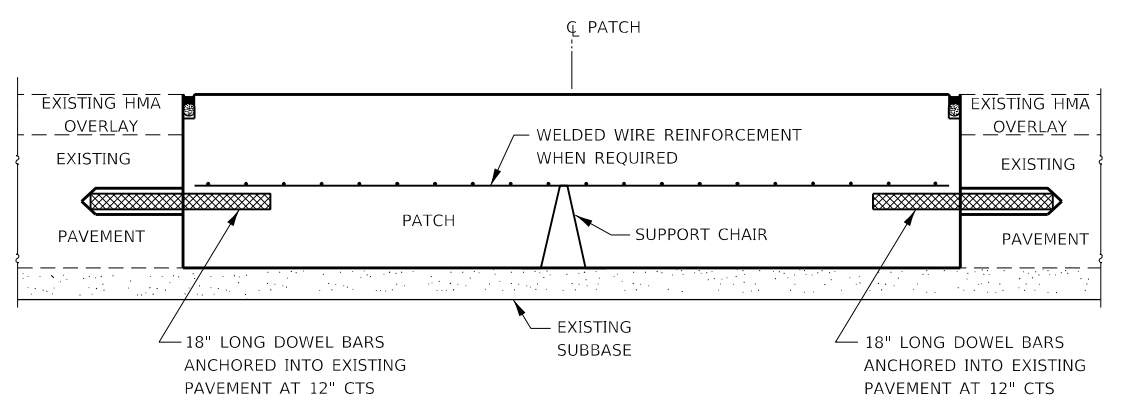

PATCHING WITH HMA OVERLAY

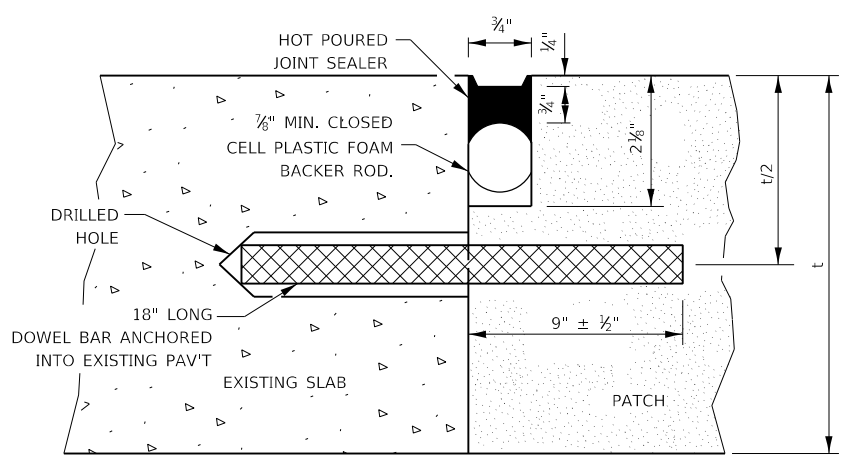

TRANSVERSE JOINT

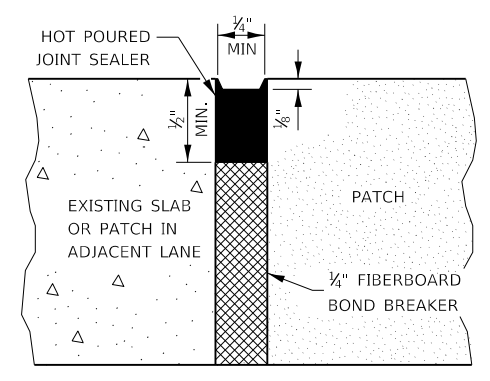

CENTERLINE JOINT

DOWEL BAR TABLE		
PAVEMENT THICKNESS	DOWEL BAR DIAMETER	HOLE DIAMETER
8" OR GREATER	1 1/2"	1 3/8"
7" THRU 7.99"	1 1/4"	1 3/8"
LESS THAN 7"	1"	1 1/8"

GENERAL NOTES

THE TRANSVERSE JOINTS FOR CLASS B PATCHES SHALL ALIGN WITH JOINTS OR CRACKS IN THE ADJACENT LANE WHENEVER POSSIBLE.
SEE STANDARD 420701 FOR DETAILS OF PAVEMENT WELDED WIRE REINFORCEMENT.

MODEL: Default
 FILE NAME: p:\pub\barcom\dat\illinois\pav\DOT\Documents\DOT Office\Detail\3\Projects\136620\CD\Drawn\136620-01-01.dwg
 PLOT DATE = 10/16/2020

USER NAME = ZAGARIK	DESIGNED -	REVISED -
PLOT SCALE = 100.0000' / in.	DRAWN -	REVISED -
PLOT DATE = 10/16/2020	CHECKED -	REVISED -
	DATE -	REVISED -

**STATE OF ILLINOIS
DEPARTMENT OF TRANSPORTATION**

DETAILS

SCALE: SHEET 6 OF 6 SHEETS STA. TO STA.

F.A.P. RTE.	SECTION	COUNT	TOTAL SHEETS	SHEET NO.
697(17,18)RS-4 & (127,127X)RS-3,SW		FORD	56	54A
CONTRACT NO. 66X20				
ILLINOIS FED. AID PROJECT				

ADDED SHEET 10/19/20

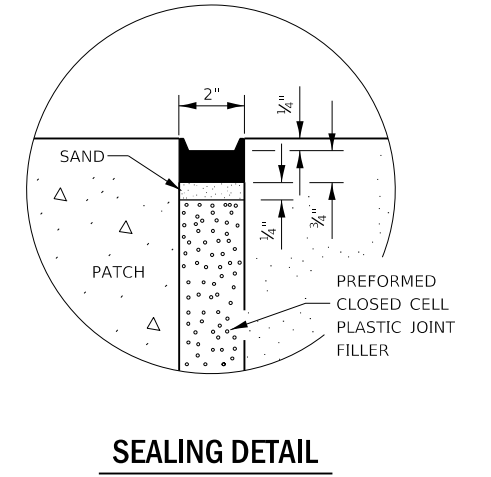
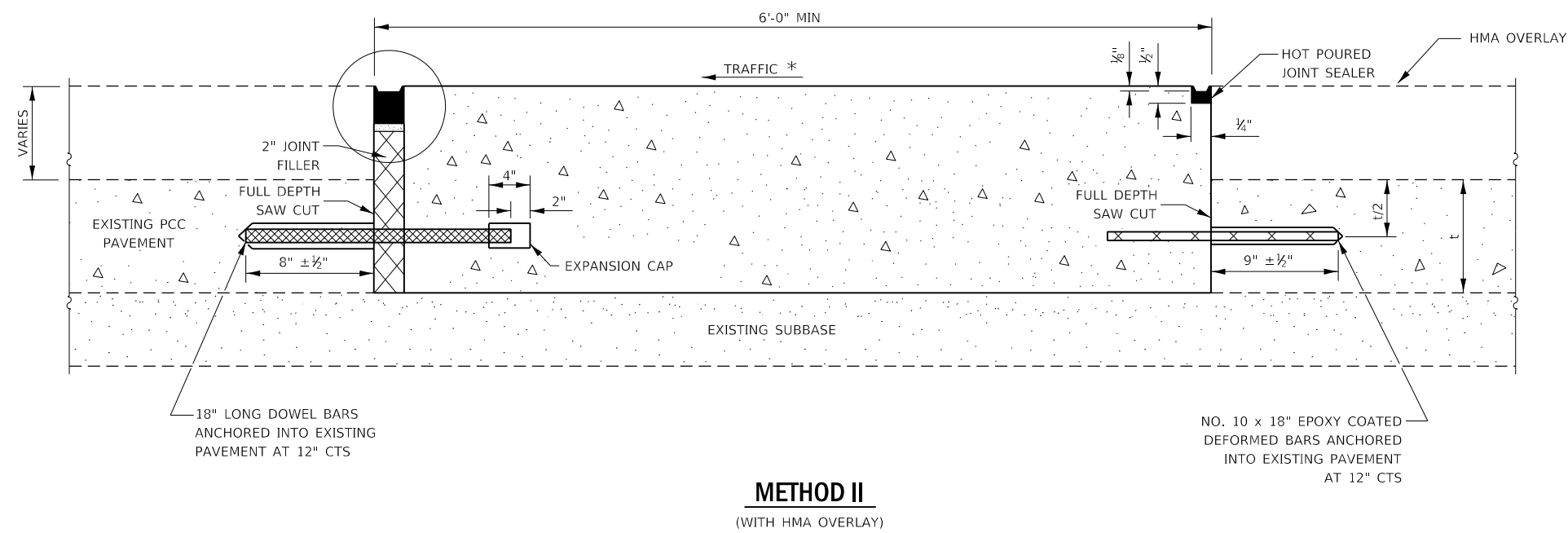
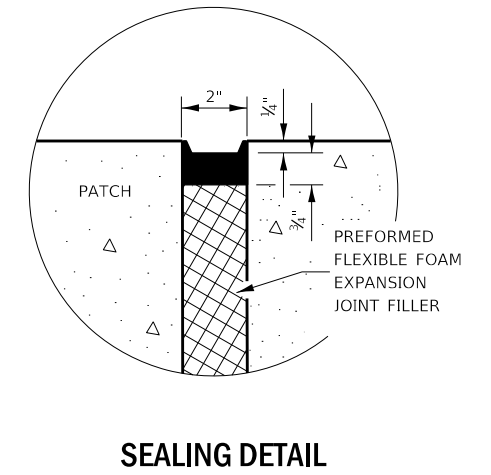
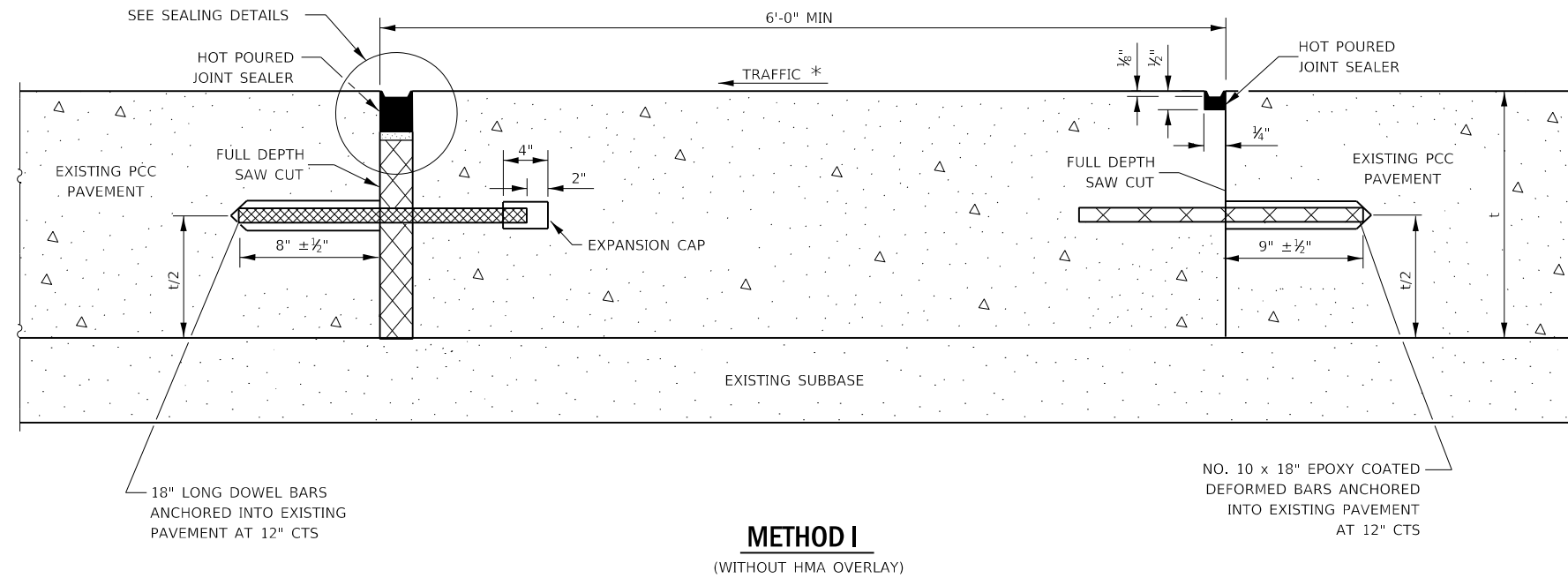

NOTE

* WHEN RE-ESTABLISHING A TRANSVERSE EXPANSION JOINT ON A TWO-WAY ROAD, REVERSE THE ORIENTATION OF THE DOWEL BARS WITH RESPECT TO TRAFFIC FOR ONE OF THE PATCHES SUCH THAT THE JOINT WILL BE CONTINUOUS ACROSS BOTH LANES.

MODEL: Default
 FILE: hma16_10112020.ctb
 PROJECT: P:\Projects\66K20\Drawings\DOT Office\Detail\66K20-10112020.dwg
 PLOT DATE: 10/16/2020

USER NAME = ZAGARIK	DESIGNED -	REVISED -
PLOT SCALE = 100.0000' / in.	DRAWN -	REVISIED -
PLOT DATE = 10/16/2020	CHECKED -	REVISIED -
	DATE -	REVISIED -

STATE OF ILLINOIS
DEPARTMENT OF TRANSPORTATION

DETAILS			
SCALE:	SHEET 6	OF 6 SHEETS	STA. TO STA.

F.A.P. RTE.	SECTION	COUNTY	TOTAL SHEETS	SHEET NO.
69717,18 RS-4 & (127,127X)RS-3,SW FOR			56	54B
CONTRACT NO. 66K20				
ILLINOIS FED. AID PROJECT				