

**TEMP PAVEMENT MARKINGS AND TRAFFIC CONTROL DEVICES FROM PREVIOUS STAGE TO REMAIN**

- AA TEMP EPOXY PVT MK LINE 4 (SOLID WHITE)
- BB TEMP EPOXY PVT MK LINE 4 (SOLID YELLOW)
- CC TEMP EPOXY PVT MK LINE 8 (SOLID WHITE)
- DD TEMP EPOXY PVT MK LINE 12 (WHITE CHEVRONS) (TYP)
- EE TEMP EPOXY PVT MK LINE 5 (10' DASH 30' SKIP, WHITE)
- FF TYPE II BARRICADE OR DRUMS WITH STEADY BURN MONODIRECTIONAL LIGHT @ 50' C-C (TYP) ON TAPERS AND @ 100' C-C (TYP) ON TANGENTS
- GG TYPE II BARRICADE OR DRUMS WITH STEADY BURN MONODIRECTIONAL LIGHT @ 50' C-C (TYP) ON RAMP TAPERS
- HH TEMP CONC BARRIER
- II IMP ATTN TEMP FRN TL3
- JJ DIRECTIONAL INDICATOR BARRICADE WITH STEADY BURN MONODIRECTIONAL LIGHT @ 50' C-C

**PROPOSED TEMP PAVEMENT MARKINGS AND TRAFFIC CONTROL DEVICES**

- A TEMP EPOXY PVT MK LINE 4 (SOLID WHITE)
- B TEMP EPOXY PVT MK LINE 4 (SOLID YELLOW)
- C TEMP EPOXY PVT MK LINE 8 (SOLID WHITE)
- D TEMP EPOXY PVT MK LINE 12 (WHITE CHEVRONS) (TYP)
- E TEMP EPOXY PVT MK LINE 5 (10' DASH 30' SKIP, WHITE)
- F TYPE II BARRICADE OR DRUMS WITH STEADY BURN MONODIRECTIONAL LIGHT @ 50' C-C (TYP) ON TAPERS AND @ 100' C-C (TYP) ON TANGENTS
- G TYPE II BARRICADE OR DRUMS WITH STEADY BURN MONODIRECTIONAL LIGHT @ 50' C-C (TYP) ON RAMP TAPERS
- H TEMP CONC BARRIER
- I IMP ATTN TEMP FRN TL3
- J DIRECTIONAL INDICATOR BARRICADE WITH STEADY BURN MONODIRECTIONAL LIGHT @ 50' C-C

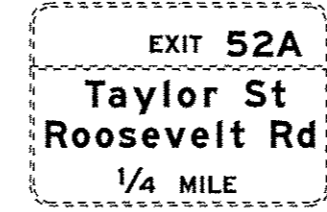
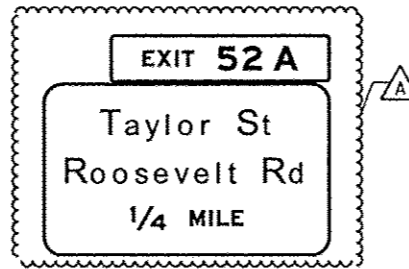

2 SIGN PANEL - TYPE 3 WITH STRUCTURAL STEEL SIGN SUPPORT - BREAKAWAY AND CONCRETE FOUNDATIONS (SEE GROUND MOUNTED SIGN PANEL PLACEMENT) (FROM PREVIOUS STAGE TO REMAIN)

- 1A RELOCATE SIGN PANEL - TYPE 3 (FROM BRIDGE MOUNTED) (FROM PREVIOUS STAGE TO REMAIN)
- 1B WITH STRUCTURAL STEEL SIGN SUPPORT BREAKAWAY AND CONCRETE FOUNDATIONS (SEE GROUND MOUNTED SIGN PANEL PLACEMENT) (FROM PREVIOUS STAGE TO REMAIN)

NOTE:  
 1. UNLESS NOTED OTHERWISE, ALL STATIONS AND OFFSETS USED ARE TAKEN FROM SB I-90/94 BASELINE.  
 2. FOR LEGEND SEE SHEET NO. 65

TEMPORARY SOIL RETENTION SYSTEM (SEE STRUCTURAL PLANS FOR DETAIL, TYP)

MATCH LINE STA 203+00.00 NB I-90/94 SEE SHEET NO. 92

MATCH LINE STA 11+00.00 NB I-90/94 SEE SHEET NO. 89

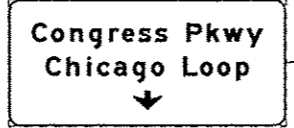
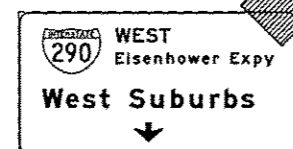
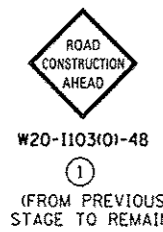
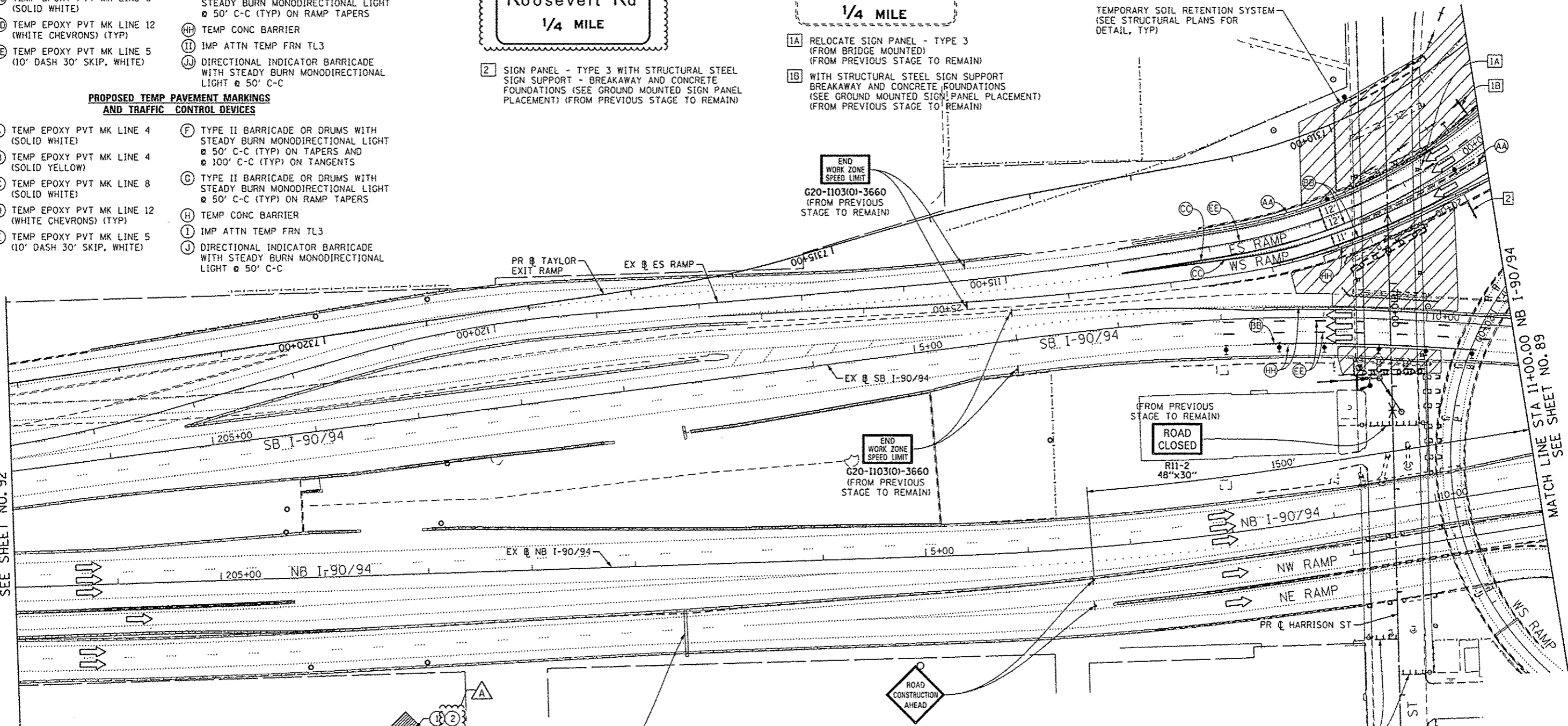

W20-1103(0)-48 (FROM PREVIOUS STAGE TO REMAIN)

ROAD CLOSED TO THRU TRAFFIC R11-4 60"x30" (FROM PREVIOUS STAGE TO REMAIN)

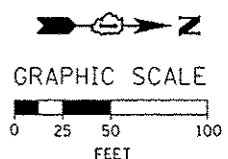

<b>AECOM</b> <i>Trans</i> Systems	D168W26-Sh1-Staging2A-ML-05	DESIGNED - OPS	REVISED - 10/15/2013	STATE OF ILLINOIS DEPARTMENT OF TRANSPORTATION	SUGGESTED STAGES OF CONSTRUCTION AND TRAFFIC CONTROL PLAN MAINLINE STAGING 2A			F.A.I. RTE. 90/94/290	SECTION 2013-008R	COUNTY COOK	TOTAL SHEETS 559	SHEET NO. 91	
	USER NAME = PIMSARNO	DRAWN - PHP	REVISED -		SCALE: 1" = 50'	SHEET 5 OF 8 SHEETS	STA. TO STA.	CONTRACT NO. 60W26					
	PLOT SCALE = 50.0000' / 1"	CHECKED - DBM	REVISED -		ILLINOIS FED. AID PROJECT								
	PLOT DATE = 10/15/2013	DATE - 9/15/13	REVISED -										