

1 EXISTING OVERHEAD SIGN TO REMAIN

EXIT 28B
Ashland Ave
 1/2 MILE

NOTE:

- UNLESS NOTED OTHERWISE, ALL STATIONS AND OFFSETS USED ARE TAKEN FROM EXISTING EB AND WB I-290 BASELINES.
- FOR LEGEND SEE SHEET NO. #MOT06

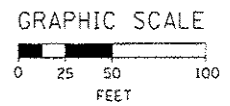

MATCH LINE STA 332+00 EB I-290 SEE SHEET NO. 94A

MATCH LINE STA 347+00 EB I-290 SEE SHEET NO. 94C

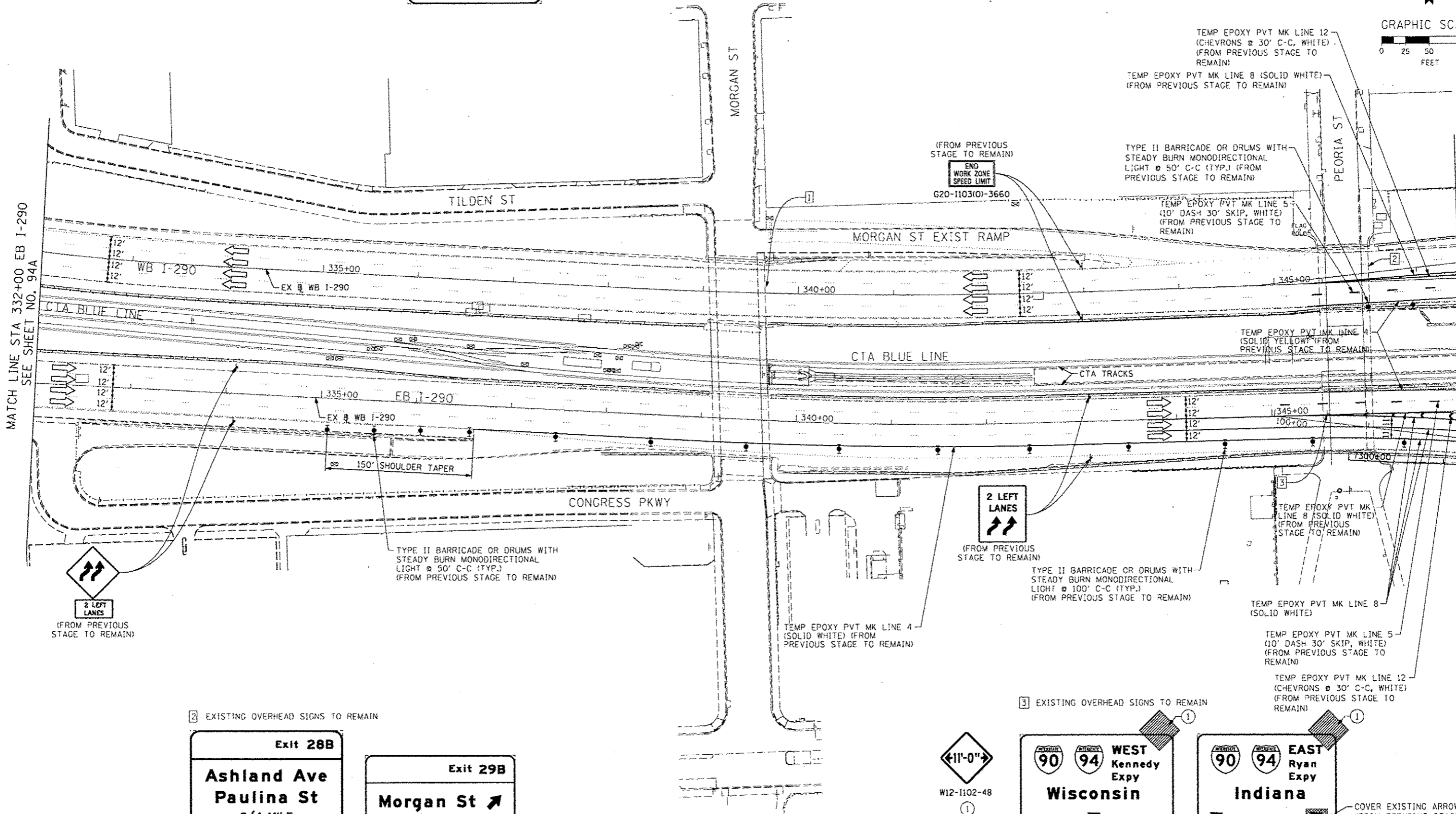

2 EXISTING OVERHEAD SIGNS TO REMAIN

Exit 28B
Ashland Ave
Paulina St
 3/4 MILE

Exit 29B
Morgan St ↗
 1000 W

3 EXISTING OVERHEAD SIGNS TO REMAIN

W12-1102-48
 11'-0"

WEST Kennedy Expy
Wisconsin

EAST Ryan Expy
Indiana

COVER EXISTING ARROW (FROM PREVIOUS STAGE TO REMAIN)

	D:\6026-Sht-Staging2A-1M-02.dgn USER NAME: potaip2 PLOT SCALE: 1/8" = 100'-0" PLOT DATE: 10/15/2013	DESIGNED - OPS DRAWN - OPS CHECKED - DBM DATE - 9/15/13	REVISED - 10/15/2013 REVISED - REVISED - REVISED -
--	--	--	--

STATE OF ILLINOIS
 DEPARTMENT OF TRANSPORTATION

SUGGESTED STAGES OF CONSTRUCTION AND TRAFFIC CONTROL PLAN
MAINLINE STAGING 2A-1
 SCALE: 1" = 50' SHEET 2 OF 3 SHEETS STA. TO STA.

F.A.I. RTE.	SECTION	COUNTY	TOTAL SHEETS	SHEET NO.
90/94/290	2013-00BR	COOK	94B	94B
CONTRACT NO. 60W26			ILLINOIS FED. AID PROJECT	