

NOTE:

1. UNLESS NOTED OTHERWISE, ALL STATIONS AND OFFSETS USED ARE TAKEN FROM EXISTING EB AND WB I-290 BASELINES.
2. FOR LEGEND SEE SHEET NO. #MOT06

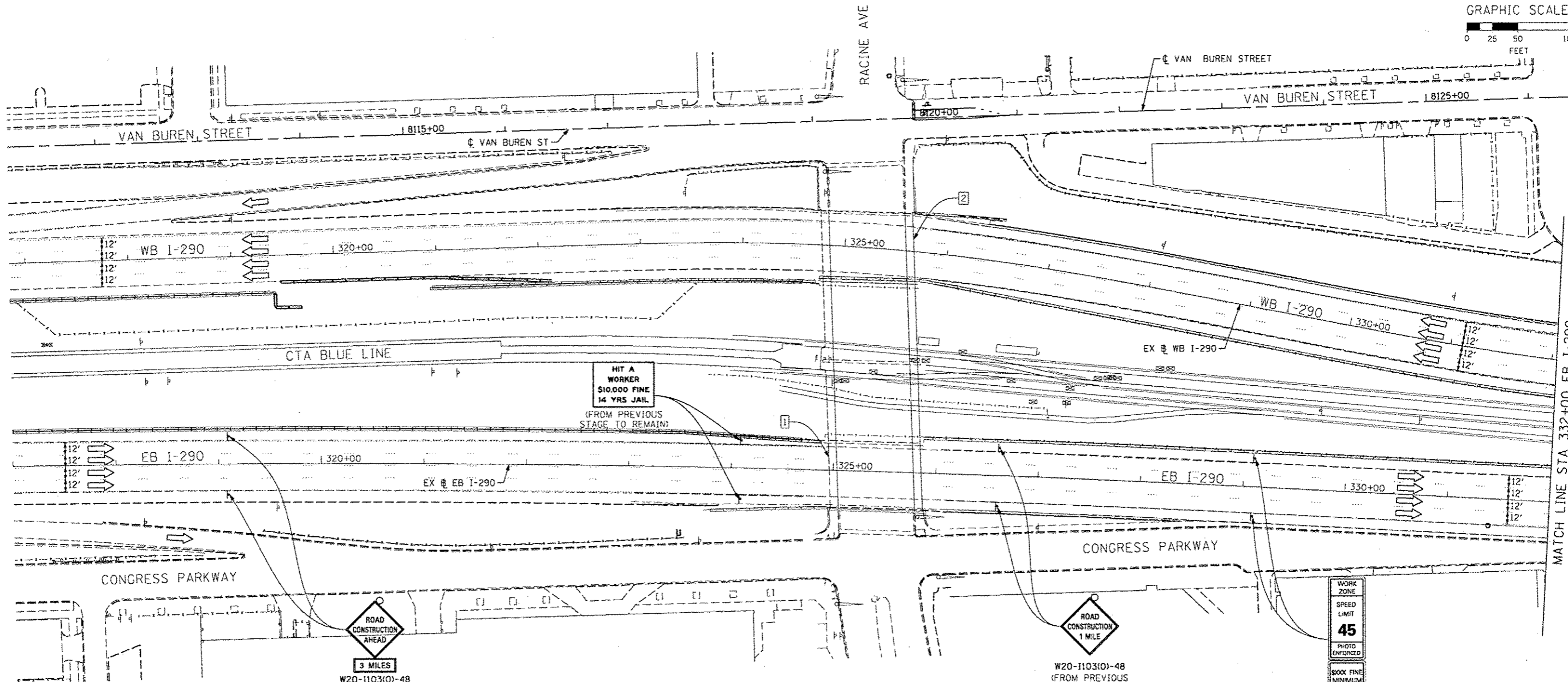
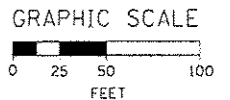
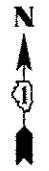

MATCH LINE STA 332+00 EB I-290
SEE SHEET NO. #MOT2A2

HIT A WORKER
\$10,000 FINE
14 YRS JAIL
(FROM PREVIOUS STAGE TO REMAIN)

ROAD CONSTRUCTION AHEAD
3 MILES
W20-1103(O)-48
W16-3A(O)-3612
(FROM PREVIOUS STAGE TO REMAIN)

ROAD CONSTRUCTION 1 MILE
W20-1103(O)-48
(FROM PREVIOUS STAGE TO REMAIN)

WORK ZONE
SPEED LIMIT 45
PHOTO ENFORCED
BOOK FINE MINIMUM
W2-1115(O)-3618
R2-1-3648
R10-19aP-3618
R2-1106-3618
(FROM PREVIOUS STAGE TO REMAIN)

1 EXISTING OVERHEAD SIGNS TO REMAIN

2 EXISTING OVERHEAD SIGNS TO REMAIN

Congress Pkwy
Chicago Loop

WEST Kennedy Expy
Wisconsin

EAST Ryan Expy
Indiana

ROAD CONSTRUCTION AHEAD
W20-1103(O)-48
(FROM PREVIOUS STAGE TO REMAIN)

EXIT 28A
Damen Ave
3/4 MILE

EXIT 28B
Ashland Ave
1/4 MILE

AECOM TransSystems	DESIGNED - OPS	REVISED - 10/15/2013
	DRAWN - PHP	REVISED -
	CHECKED - DBM	REVISED -
	DATE - 9/15/13	REVISED -

STATE OF ILLINOIS
DEPARTMENT OF TRANSPORTATION

SUGGESTED STAGES OF CONSTRUCTION AND TRAFFIC CONTROL PLAN	
MAINLINE STAGING 2A-2	
SCALE: 1" = 50'	SHEET 1 OF 3 SHEETS
STA.	TO STA.

F.A.I. RTE.	SECTION	COUNTY	TOTAL SHEETS	SHEET NO.
90/94/290	2013-008R	COOK	#TOTAL	940
CONTRACT NO. 60W26			ILLINOIS FED. AID PROJECT	