

NOTES

1. PULL FIBER OPTIC AND COPPER COMMUNICATION CABLES FROM THE COMMUNICATIONS HUT AND MCD CROSS CONNECT CABINET NEAR HALSTED ST. BACK TO THIS JUNCTION BOX. PROVIDE ACCESS TO THE EXISTING JUNCTION BOX THROUGH THE BACK OF THE CTA WALL. SEE THE ITS DETAIL SHEET FOR ACCESS DETAILS.

2. PULL EXISTING CABLES THROUGH THE BACK OF THE EXISTING JUNCTION BOX. SPLICE EXISTING AND PROPOSED 96 SMF AND 25 PR. #19 IN PROPOSED JUNCTION BOX ON CTA SIDE OF MEDIAN BARRIER. COIL 25 FT. MINIMUM OF SLACK OF EACH COMMUNICATION CABLE IN THE JUNCTION BOX.

3. ATTACH CONDUIT TO THE CTA SIDE OF THE MEDIAN BARRIER, THE PIERS, OR RETAINING WALLS, AS NECESSARY. UTILIZE SCREWS OR ANOTHER APPROPRIATE ATTACHMENT METHOD THAT WILL ALLOW FOR THE CONDUIT TO BE UNATTACHED AND REATTACHED TO THE STRUCTURE AS NEEDED TO FACILITATE PIER REMOVAL AND CONSTRUCTION.

4. ALL WORK REQUIRED TO MAINTAIN AND RELOCATE ITS INFRASTRUCTURE AS DEPICTED IN THESE PLANS OR OTHERWISE NECESSARY SHALL BE PAID FOR UNDER THE MAINTAINING AND RELOCATION OF ITS INFRASTRUCTURE DURING CONSTRUCTION PAY ITEM. SEE THE ASSOCIATED SPECIAL PROVISION FOR ADDITIONAL INFORMATION.

5. WORK OVER CTA TRACKS WILL REQUIRE A PROCESS PLAN AND FLAGGERS TO PROTECT THE WORK ZONE. CTA REQUESTS THE CONTRACTOR PROVIDE THIS INFORMATION AT LEAST 3 WEEKS PRIOR TO THE START OF WORK. WORK SHALL BE COORDINATED AND EXECUTED PER THE CTA FLAGGING AND COORDINATION SPECIAL PROVISION.

6. WORK SHALL NOT OBSTRUCT OR ALTER ANY CTA SIGNAGE OR EQUIPMENT WITHIN CTA RIGHT OF WAY.

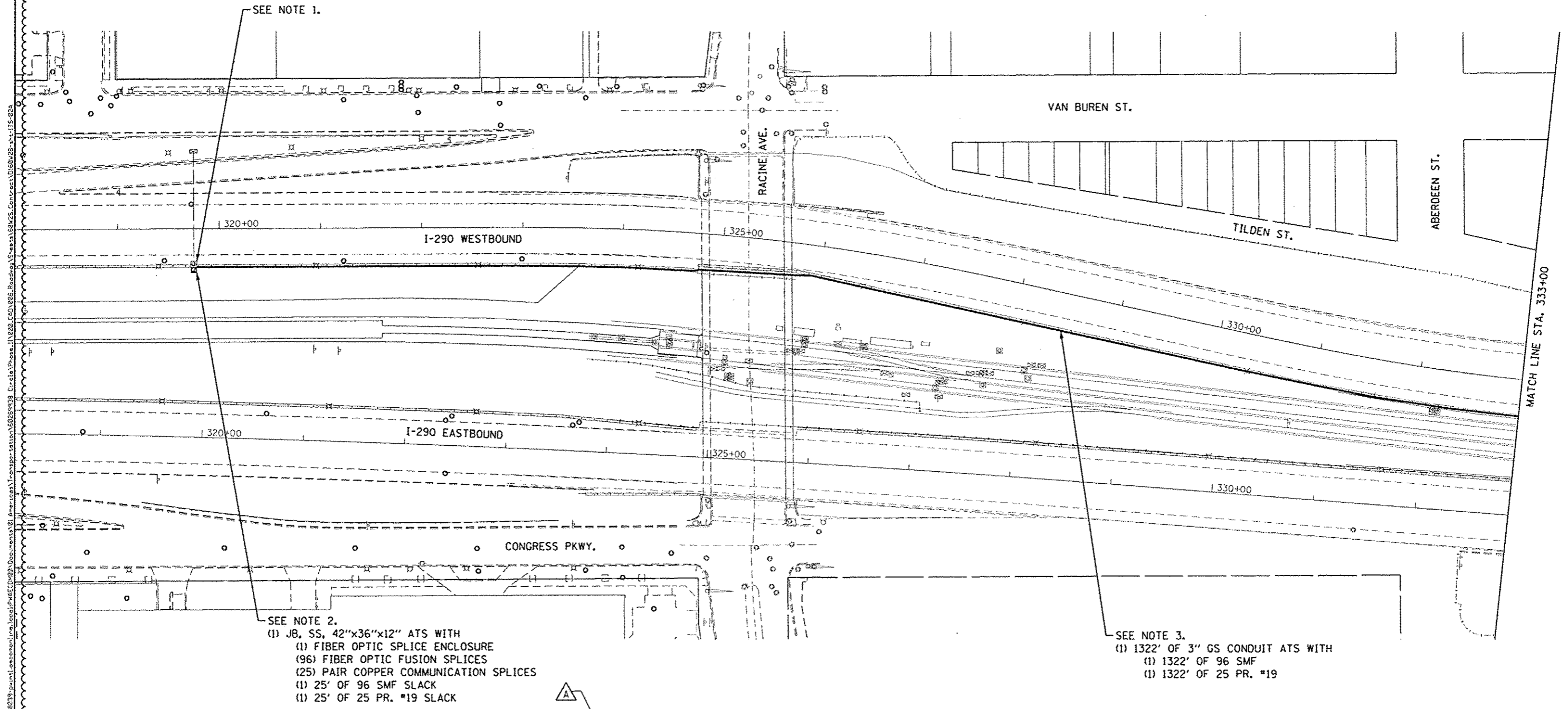
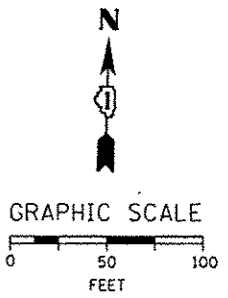

SEE NOTE 1.

SEE NOTE 2.
 (1) JB, SS, 42"x36"x12" ATS WITH
 (1) FIBER OPTIC SPLICE ENCLOSURE
 (96) FIBER OPTIC FUSION SPLICES
 (25) PAIR COPPER COMMUNICATION SPLICES
 (1) 25' OF 96 SMF SLACK
 (1) 25' OF 25 PR. #19 SLACK

SEE NOTE 3.
 (1) 1322' OF 3" GS CONDUIT ATS WITH
 (1) 1322' OF 96 SMF
 (1) 1322' OF 25 PR. #19

FILE PATH: \\A:\986239\p\int\onac\onlin\log\p445\CD\92\Documents\21\americas\T-concor\station\60269938_Circle\Phase_1\1\822_F00\985_Roadway\Sheet\60269938-1\ITS-026



DWG NO: 60269938-1	DESIGNED - JML	REVISED - 10/15/2013
USER NAME: jacharj	DRAWN - JML	REVISED -
PLOT SCALE: 50.0000 1" =	CHECKED - WDS	REVISED -
PLOT DATE: 10/15/2013	DATE - 9/15/13	REVISED -

DESIGNED - JML	REVISED - 10/15/2013
DRAWN - JML	REVISED -
CHECKED - WDS	REVISED -
DATE - 9/15/13	REVISED -

**STATE OF ILLINOIS
DEPARTMENT OF TRANSPORTATION**

**ITS PLANS - HALSTED STREET AND HARRISON STREET
ITS REROUTING**

SCALE: 1" = 50' SHEET 2 OF 5 SHEETS STA. 318+00 TO STA. 333+00

F.A.I. RTE. 90/94/290	SECTION 2013-008R	COUNTY COOK	TOTAL SHEETS 559	SHEET NO. 247
CONTRACT NO. 60W26			ILLINOIS FED. AID PROJECT	