

NOTES:

1. Work this sheet with sheets S1-04 and S1-05.
2. V.I.F. Indicates Verify in Field.
3. A cantilever sheet piling design does not appear feasible and additional members or other retention systems may be necessary. The Contractor shall submit a temporary soil retention system design including plan details and calculations for review and acceptance by the Engineer.

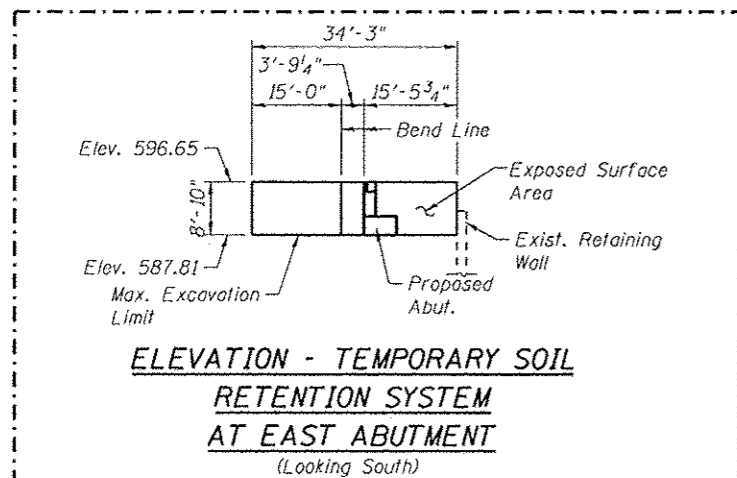

ELEVATION - TEMPORARY SOIL RETENTION SYSTEM AT EAST ABUTMENT (Looking South)

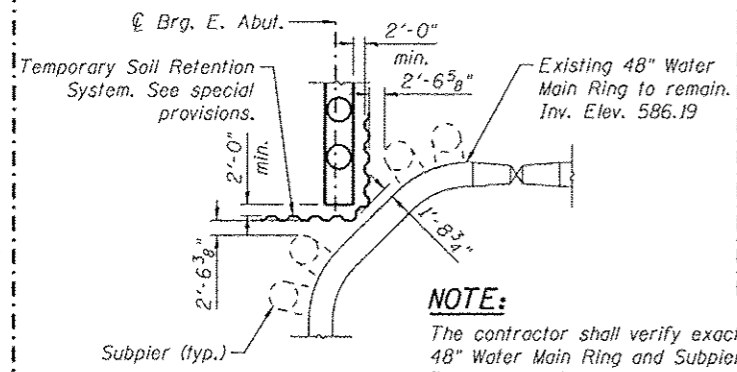

PLAN - TEMPORARY SOIL RETENTION SYSTEM AT EAST ABUTMENT

NOTE:
The contractor shall verify exact location of existing 48" Water Main Ring and Subpiers prior to installing Temporary Soil Retention System.

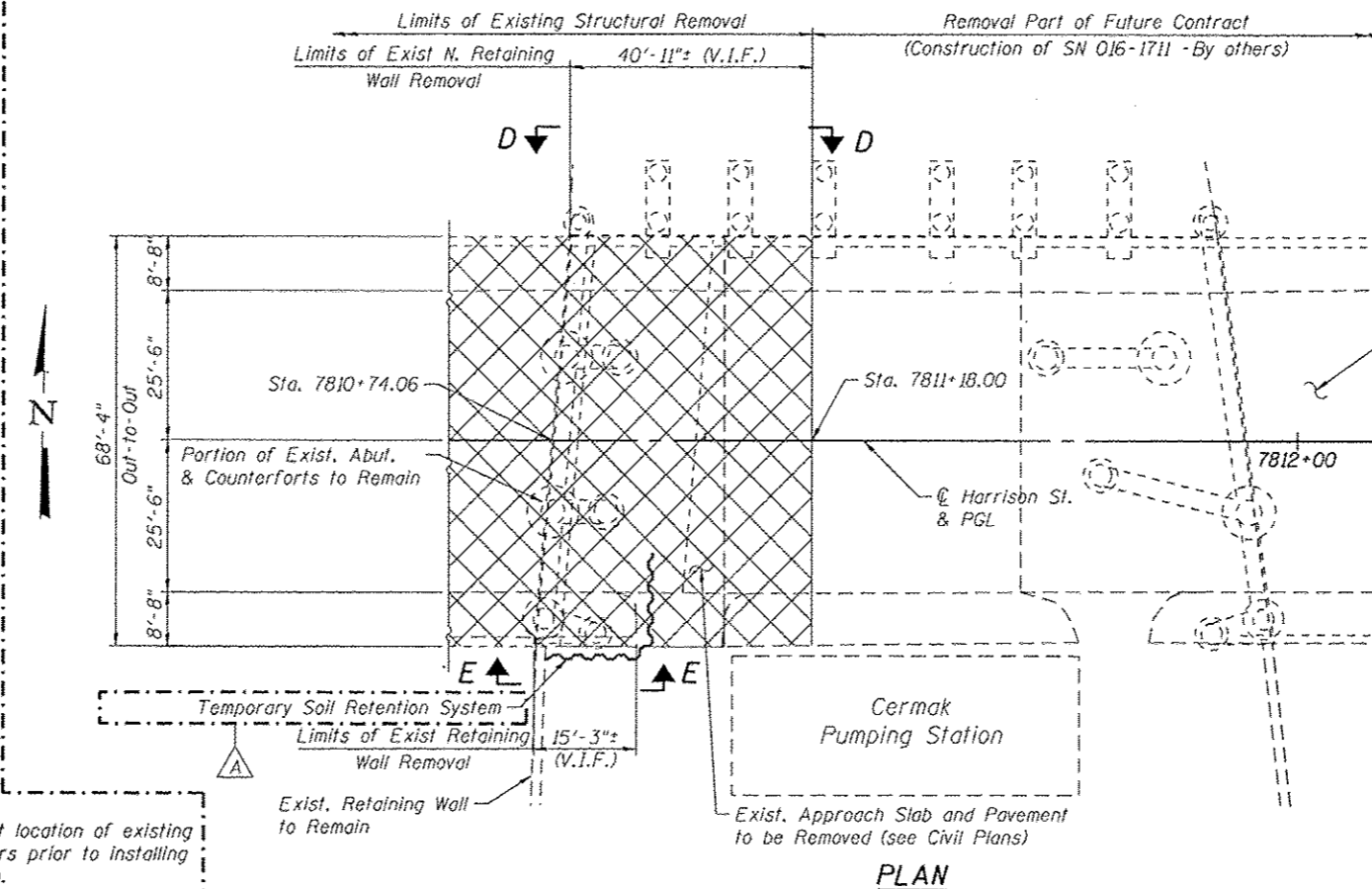

PLAN

BILL OF MATERIAL

Item	Unit	Total
Removal of Existing Structures, No. 1	Each	1
Protective Shield	Sq. Yd.	1431

LEGEND:
 Removal of Existing Structure

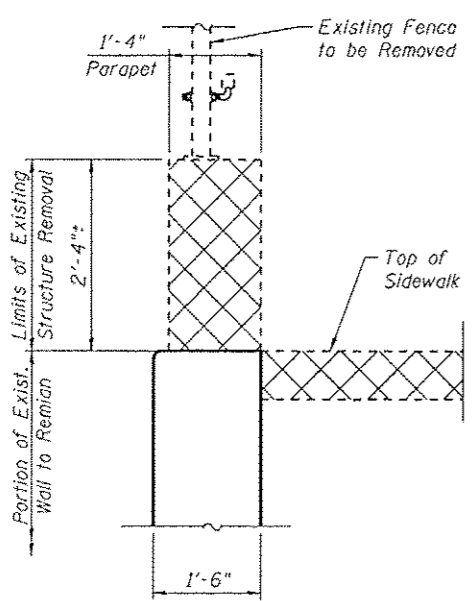

SECTION F-F

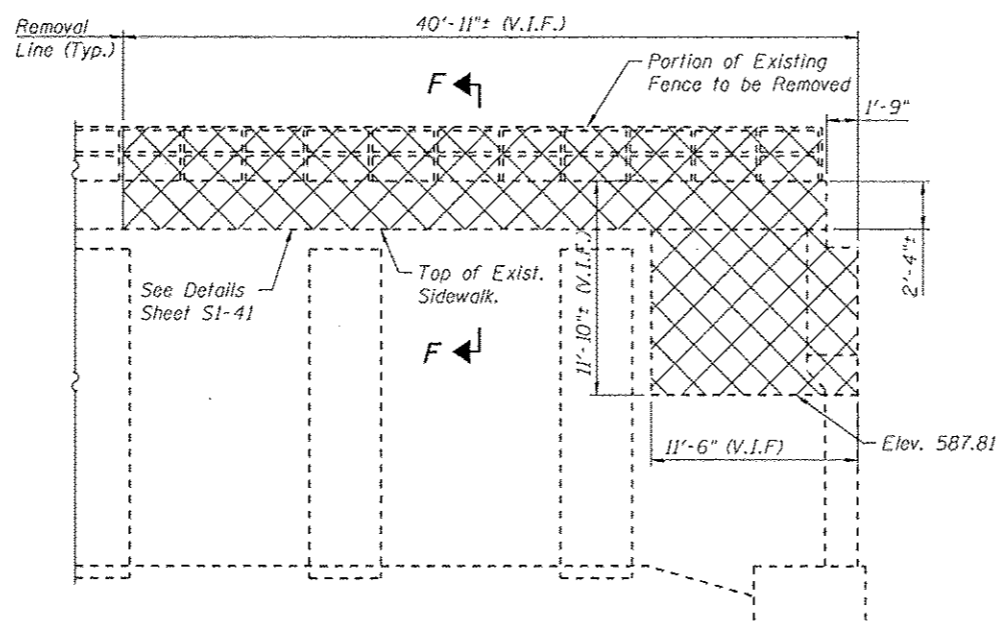

SECTION D-D

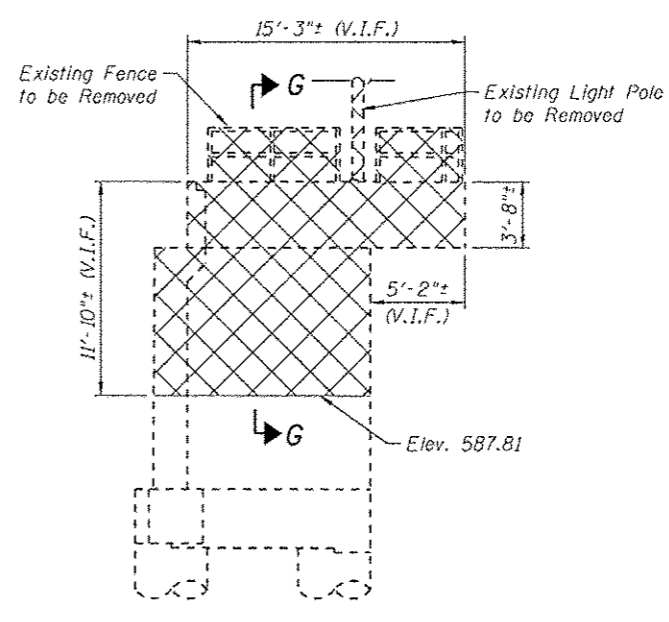

SECTION E-E

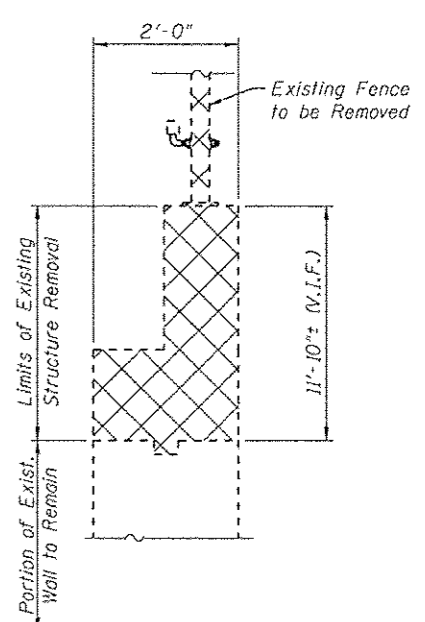

SECTION G-G

016173-60N26-506-Removal



USER NAME = krltzm	DESIGNED - EJO	REVISED 10/15/2013 EJO, BRD
PLLOT SCALE = N.T.S.	CHECKED - ATB	REVISED
PLLOT DATE = 9/15/2013	DRAWN - MRK	REVISED
	CHECKED - EJO	REVISED

STATE OF ILLINOIS
DEPARTMENT OF TRANSPORTATION

EXISTING STRUCTURAL REMOVAL (3 OF 3)
STRUCTURE NO. 016-1713
SHEET NO. S1-06 OF S1-48 SHEETS

F.A.I. RTE. 90/94/290	SECTION 2013-008R	COUNTY COOK	TOTAL SHEETS 559	SHEET NO. 256
CONTRACT NO. 60W26				ILLINOIS FED. AID PROJECT