

Bench Mark: A "T" cut in the SE anchor bolt at the 11th street light N. of Roosevelt on the W. side of Halsted Elev. = 594.06

Existing Structure: SN 016-2081. Constructed in 1950 under F.A. Route 131, Section 2525.1-2B. The bridge was extended to the south and north in 1958 under Section 2525.2-3B. Seven span bridge that measures 436'-11 1/8" from back to back of abutments. Out-to-out width of 69'-4". The spans are supported by 36" wide flange steel I-beams. Substructure is reinforced concrete closed abutments and multi-column piers founded on timber piles or drilled shafts. The existing bridge is to be removed and replaced.

Traffic to be maintained utilizing Staged Construction.

No Salvage.

Construction of Pier 3 is adjacent to the EB CTA Blue Line track. Construction activities required on the EB CTA Blue Line track will be allowed during track closures only. Overnight track closures are allowed between 22:00 hours and 04:00 hours. Weekend track closures are allowed from 22:00 hours Friday to 04:00 hours on Monday. See Special Provision

LOADING HL-93

Allow 50#/sq. ft. for future wearing surface.

DESIGN SPECIFICATIONS

2012 AASHTO LRFD Bridge Design Specifications
6th Edition, with 2013 Interim Revisions

DESIGN STRESSES

FIELD UNITS

f'c = 3,500 psi
fy = 60,000 psi (Reinforcement)
fy = 50,000 psi (M270 Grade 50)
fy = 36,000 psi (M270 Grade 36)

SEISMIC DATA

Seismic Performance Zone (SPZ) = 1
Design Spectral Acceleration at 1.0 sec. (S_{D1}) = 0.085g
Design Spectral Acceleration at 0.2 sec. (S_{D5}) = 0.144g
Soil Site Class = D

APPROVED

For Structural Adequacy Only

J. Cal Perry
Engineer of Bridges & Structures

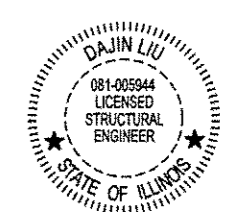

Dajin Liu
DAJIN LIU, P.E., S.E.
NO. 081-005944
EXP. DATE 11/30/2014
8/20/13

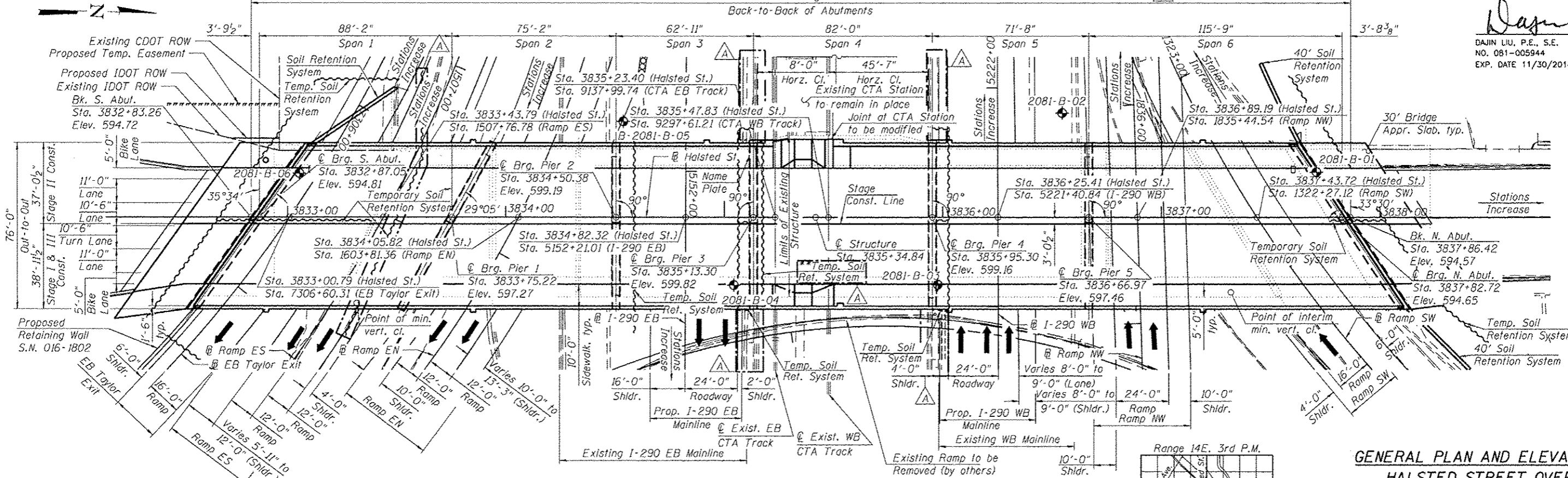
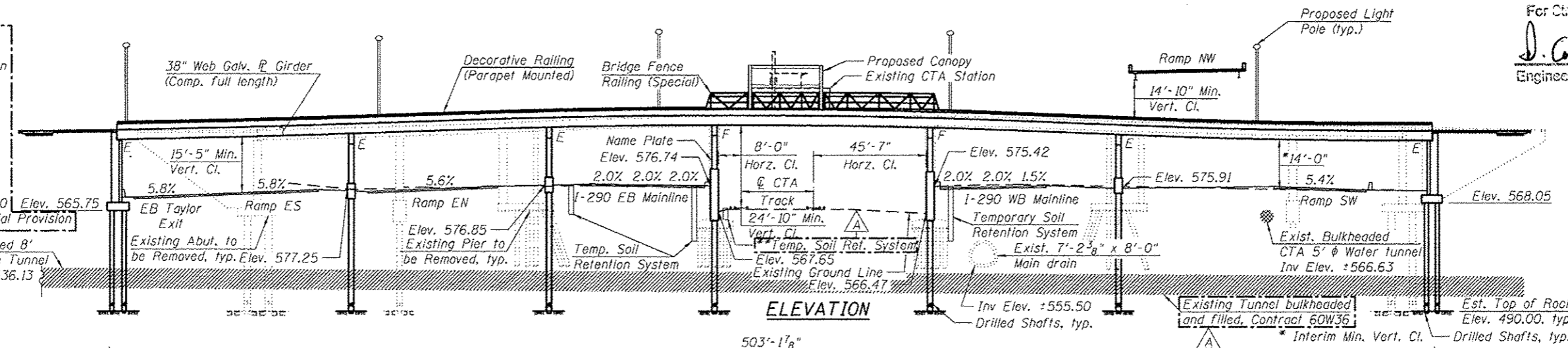

GENERAL PLAN AND ELEVATION
HALSTED STREET OVER
F.A.I. RTE. 290
(EISENHOWER EXPRESSWAY) AND CTA
F.A.U. RTE. 3730 - SECTION 2013-008R
COOK COUNTY
STATION 3835+34.84
STRUCTURE NO. 016-1716

Note:
For Limits of Protective Shield, see Sheet S2-12 of S2-81.

10:43:00 AM 0161716-60W26-S001-CPE



USER NAME: BAWHort	DESIGNED: KAH	REVISED: 10/15/2013 KAH
PLOT SCALE: 48:0 "/td> <td>CHECKED: DL</td> <td>REVISED:</td>	CHECKED: DL	REVISED:
PLOT DATE:	DRAWN: RLS/MTS	REVISED:
	CHECKED: DL	REVISED:

STATE OF ILLINOIS
DEPARTMENT OF TRANSPORTATION

SHEET NO. S2-01 OF S2-81 SHEETS

F.A.U. RTE.	SECTION	COUNTY	TOTAL SHEETS	SHEET NO.
3730	2013-008R	COOK	559	361
CONTRACT NO.			60W26	
ILLINOIS FED. AID PROJECT				