

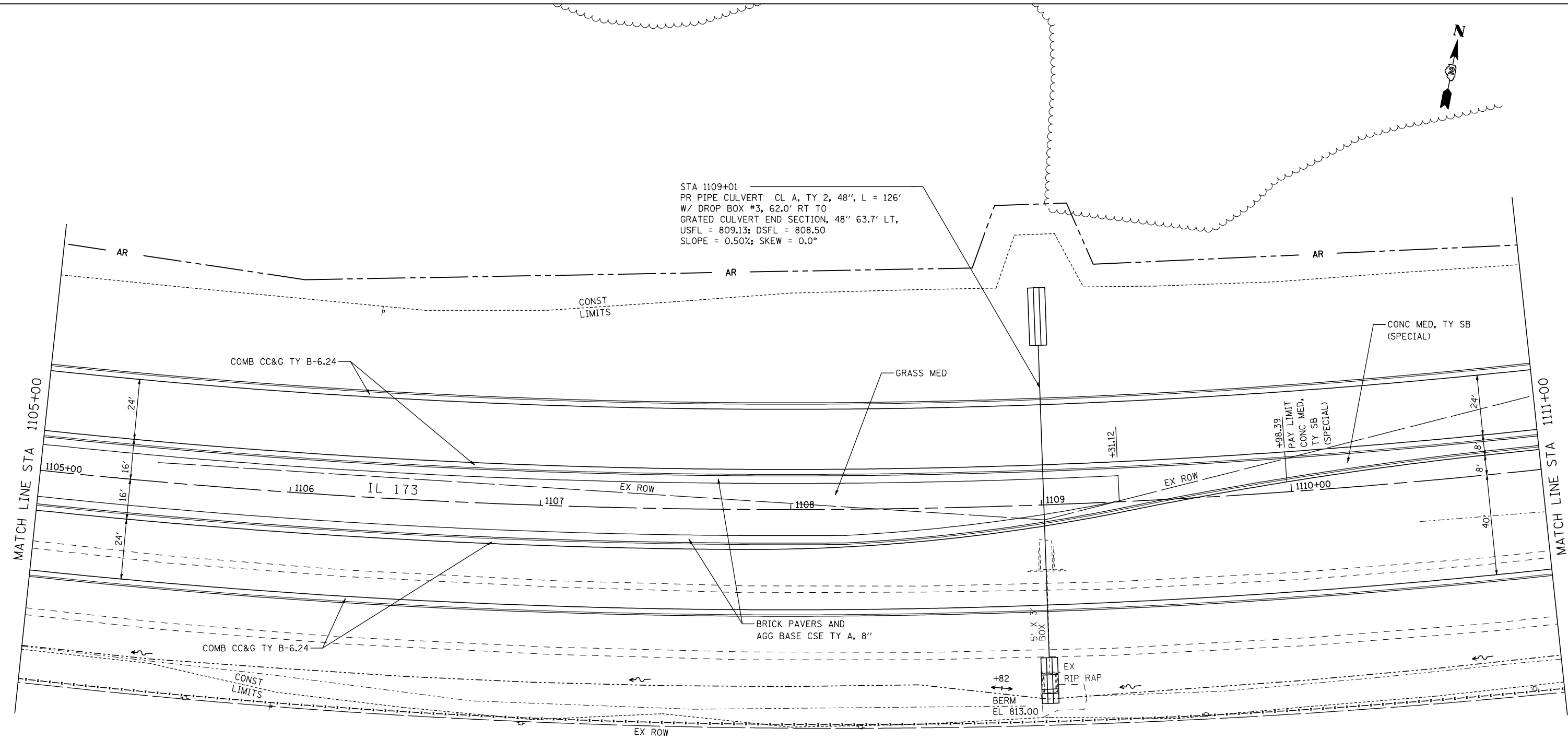

STA 1109+01  
 PR PIPE CULVERT CL A, TY 2, 48", L = 126'  
 W/ DROP BOX #3, 62.0' RT TO  
 GRATED CULVERT END SECTION, 48" 63.7' LT,  
 USFL = 809.13; DSFL = 808.50  
 SLOPE = 0.50%; SKEW = 0.0°



STA 1109+01

DRAINAGE AREA = 23.0		ACRES	
EXISTING LOW GRADE ELEVATION: 813.00		FT. @ 1108+70	
PROPOSED LOW GRADE ELEVATION: 813.00		FT. @ 1108+70	
FLOOD	FREQUENCY YEAR	DISCHARGE CFS	HEADWATER ELEV. (FT)
			EXISTING
			PROPOSED
TEN-YEAR	10	35	812.55
QVT (EXISTING)	45	48	813.00
DESIGN	50	49	812.24
BASE	100	57	812.60
QVT (PROPOSED)	193	65	813.00

10-YEAR VELOCITY THROUGH EXISTING CULVERT= 10.2 FPS  
 10-YEAR VELOCITY THROUGH PROPOSED CULVERT= 7.4 FPS



FILE NAME = ...\\cadd sheets\200793PLN18.dgn	USER NAME = Elgin 110	DESIGNED - MJS	REVISED -
		DRAWN - RMH	REVISED -
		CHECKED - RLH	REVISED -
		DATE - APRIL 30, 2013	REVISED -
PLOT SCALE = 40.0000' / IN.			
PLOT DATE = 5/3/2013 8:55:40 AM			

**STATE OF ILLINOIS  
 DEPARTMENT OF TRANSPORTATION**

**ROADWAY PLANS  
 IL 173 FROM ALPINE ROAD TO I-90**

SCALE: 1"=20' SHEET NO. OF SHEETS STA. 1105+00 TO STA. 1111+00

F.A.P. RTE.	SECTION	COUNTY	TOTAL SHEETS	SHEET NO.
303	129R	WINNEBAGO	968	163
			CONTRACT NO. 64988	
ILLINOIS FED. AID PROJECT				

**THE UPCHURCH GROUP, INC.**