

STAGE 3 - TYPICAL SECTION

STA 1035+25 TO STA 1036+79
 STA 1041+50 TO STA 1046+00
 STA 1052+60 TO STA 1059+39

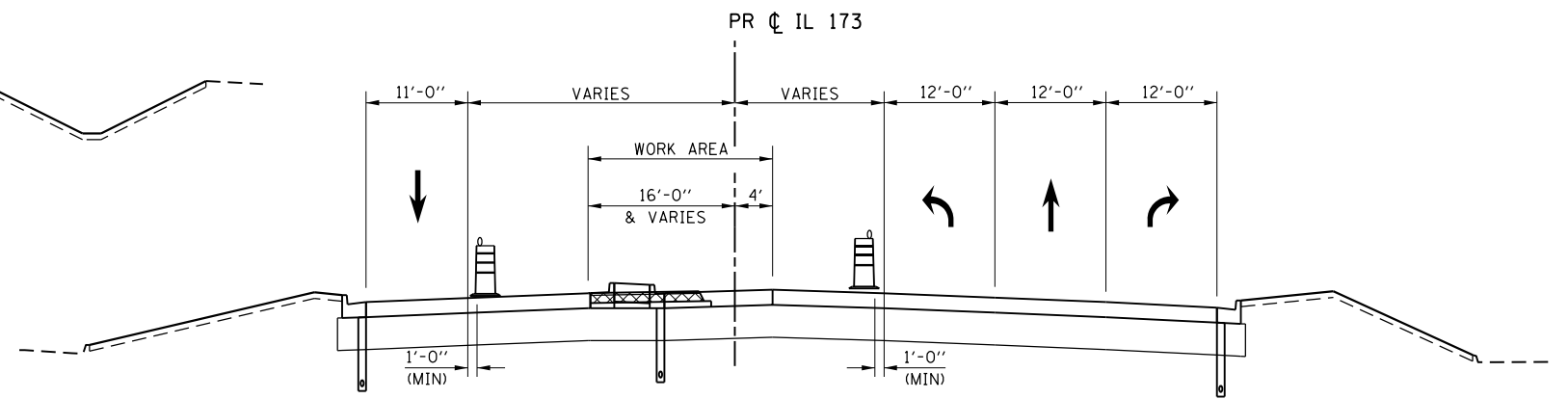

STAGE 3 - TYPICAL SECTION

STA 1066+88 TO STA 1074+34

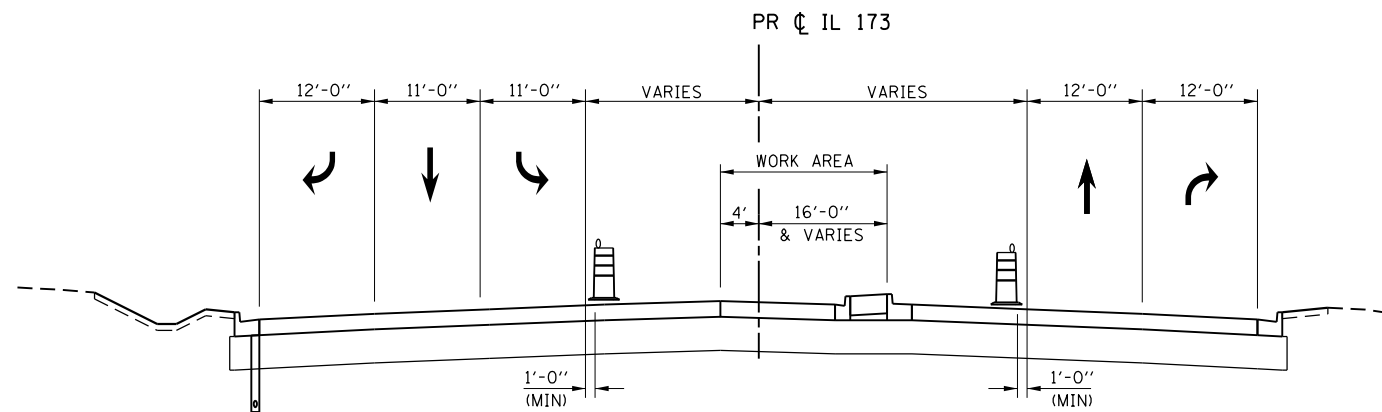

STAGE 3 - TYPICAL SECTION



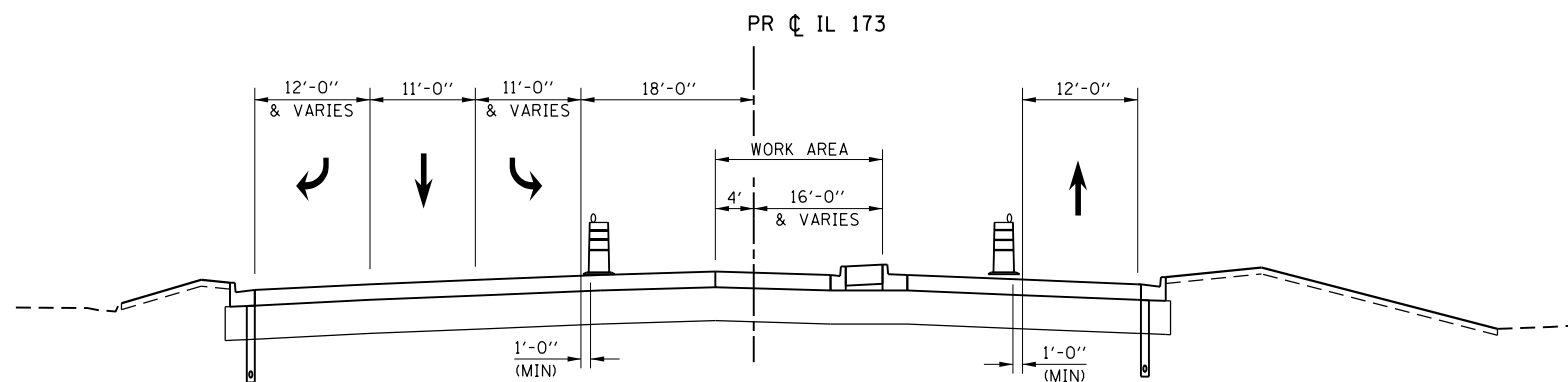

STA 1036+79 TO STA 1041+50
 STA 1046+00 TO STA 1052+60



STAGE 3 - TYPICAL SECTION

STA 1059+39 TO STA 1066+88
 STA 1074+34 TO STA 1079+00

LEGEND

-  VERTICAL PANEL
-  TYPE II BARRICADE OR DRUM WITH STEADY BURN BI-DIRECTIONAL LIGHT
-  TEMPORARY CONCRETE BARRIER
-  EX PAVEMENT, EX SHOULDER, OR TEMPORARY PAVEMENT REMOVAL

NOTES:

1. SEE "STAGING PLANS - STAGE 3" FOR LANE CONFIGURATION & TEMPORARY STRIPING.

FILE NAME = Z007935TG-TYP-IL173.01.dgn
 MODEL = Default
 PLOT DRIVER = V8...IDOT...PDF...1x17.pltcf9



USER NAME = rgoertz	DESIGNED - RG	REVISED -
PLOT SCALE = 240.0000' / ft.	DRAWN - TRF	REVISED -
PLOT DATE = 5/3/2013	CHECKED - CMS	REVISED -
	DATE - APRIL 30, 2013	REVISED -

**STATE OF ILLINOIS
 DEPARTMENT OF TRANSPORTATION**

**STAGING TYPICAL SECTIONS - STAGE 3
 IL 173**

SCALE: NONE SHEET NO. OF SHEETS STA. TO STA.

F.A.P. RTE.	SECTION	COUNTY	TOTAL SHEETS	SHEET NO.
303	129R	WINNEBAGO	968	309
CONTRACT NO. 64988				
FED. ROAD DIST. NO. 2 ILLINOIS FED. AID PROJECT				