

STAGE 3 - TYPICAL SECTION
STA 380+96.00 TO STA 386+50.97

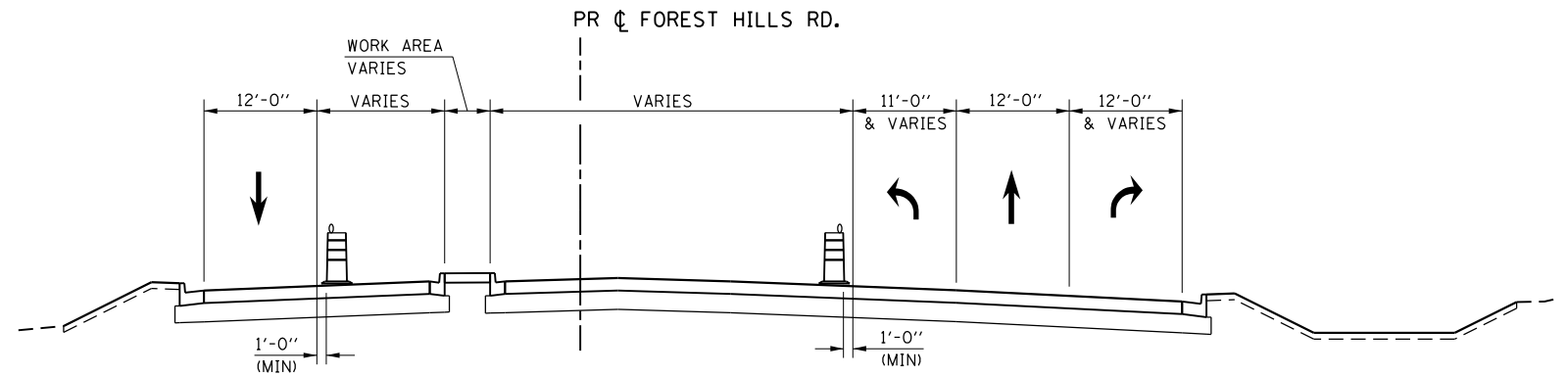

STAGE 3 - TYPICAL SECTION
STA 393+58.44 TO STA 400+00.00 NB
STA 395+74.00 TO STA 400+00.00 SB

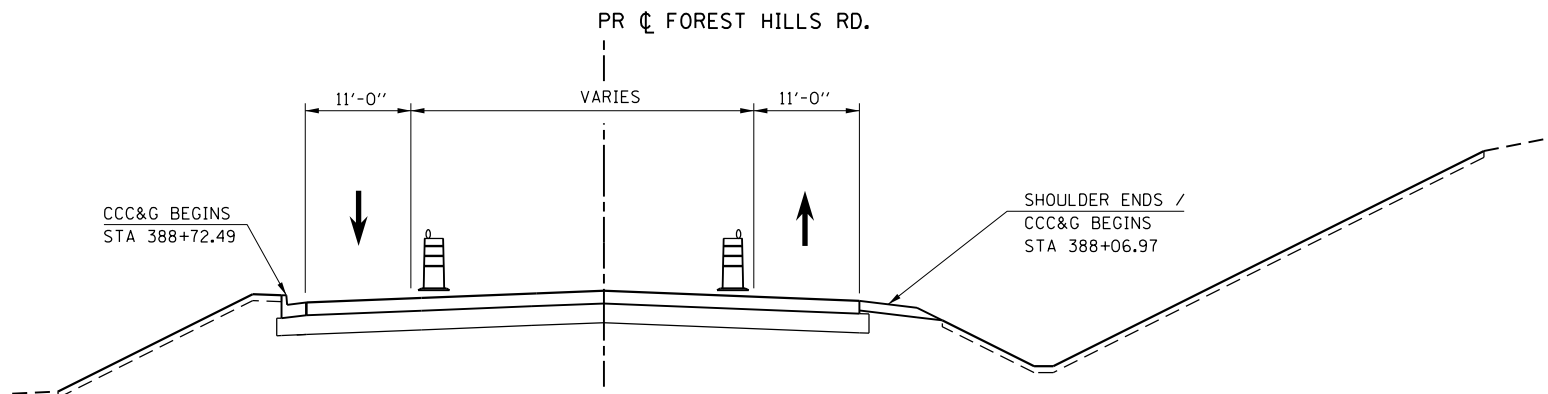

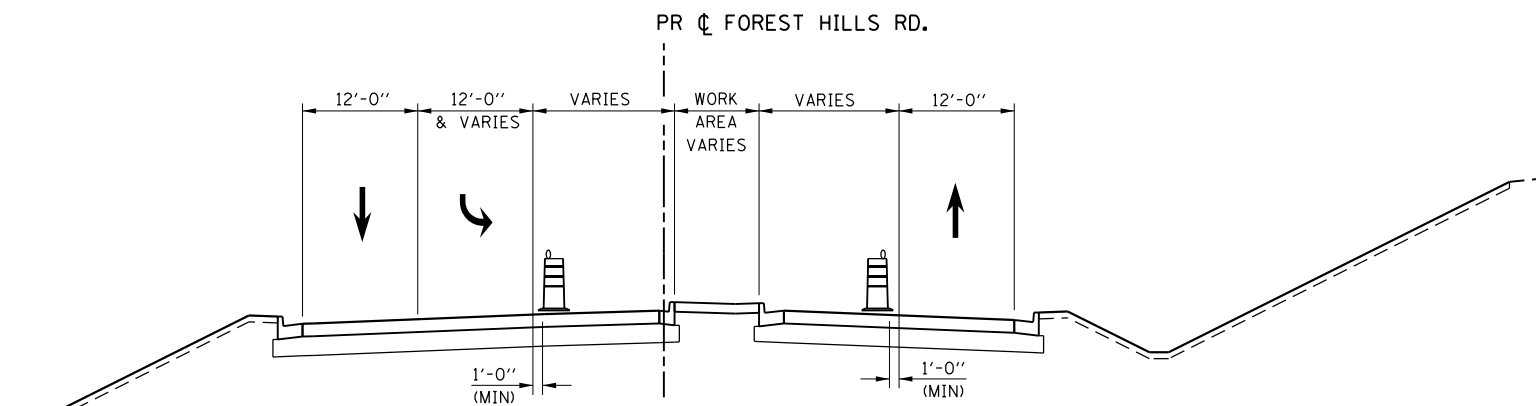

STAGE 3 - TYPICAL SECTION
STA 386+50.97 TO STA 389+65.00



STAGE 3 - TYPICAL SECTION
STA 389+65.00 TO STA 393+58.44 NB
STA 389+65.00 TO STA 395+74.00 SB

LEGEND

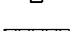
-  VERTICAL PANEL
-  TYPE II BARRICADE OR DRUM WITH STEADY BURN BI-DIRECTIONAL LIGHT
-  TEMPORARY CONCRETE BARRIER
-  EX PAVEMENT, EX SHOULDER, OR TEMPORARY PAVEMENT REMOVAL

NOTES:

1. SEE "STAGING PLANS - STAGE 3" FOR LANE CONFIGURATION & TEMPORARY STRIPING.

FILE NAME = Z007935TG.TYP-IL173.01.dgn
MODEL = Default
PLOT DRIVER = V8...IDOT...PDF...11x17.plt



USER NAME = rgoertz	DESIGNED - RG	REVISED -
PLOT SCALE = 240.0000' / ft.	DRAWN - TRF	REVISED -
PLOT DATE = 5/3/2013	CHECKED - CMS	REVISED -
	DATE - APRIL 30, 2013	REVISED -

**STATE OF ILLINOIS
DEPARTMENT OF TRANSPORTATION**

**STAGING TYPICAL SECTIONS - STAGE 3
FOREST HILLS RD**

SCALE: NONE SHEET NO. OF SHEETS STA. TO STA.

F.A.P. RTE.	SECTION	COUNTY	TOTAL SHEETS	SHEET NO.
303	129R	WINNEBAGO	968	310
CONTRACT NO. 64988				
FED. ROAD DIST. NO. 2 ILLINOIS FED. AID PROJECT				