

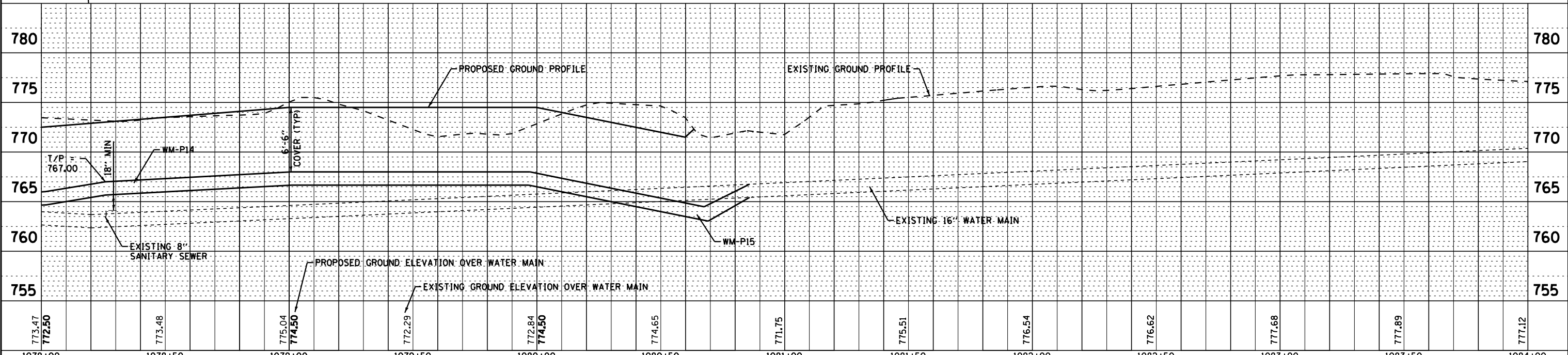

- WATER MAIN PIPES**
- WM-P14  
243 LF OF 16" WATER MAIN
  - WM-P15  
65 LF OF 16" WATER MAIN  
RJT PIPE  
STA 1080+42 TO STA 1080+86
- WATER MAIN FITTINGS**
- WM-F19  
16" X 45° BEND  
STA 1080+63, 140' LT
  - WM-F20  
16" X 45° BEND  
STA 1080+86, 116' LT
  - WM-F21  
16" CAP  
ROD CAP TO MAIN  
STA 1080+74, 105' LT
- WATER VALVE VAULTS**
- WM-VV5  
VALVE VAULT, TYPE A,  
6' DIA, TYPE I, CL  
STA 1080+86, 105' LT
- WATER MAIN LINE STOPS**
- WM-LS4  
WATER MAIN LINE STOP, 16"  
STA 1080+80, 105' LT

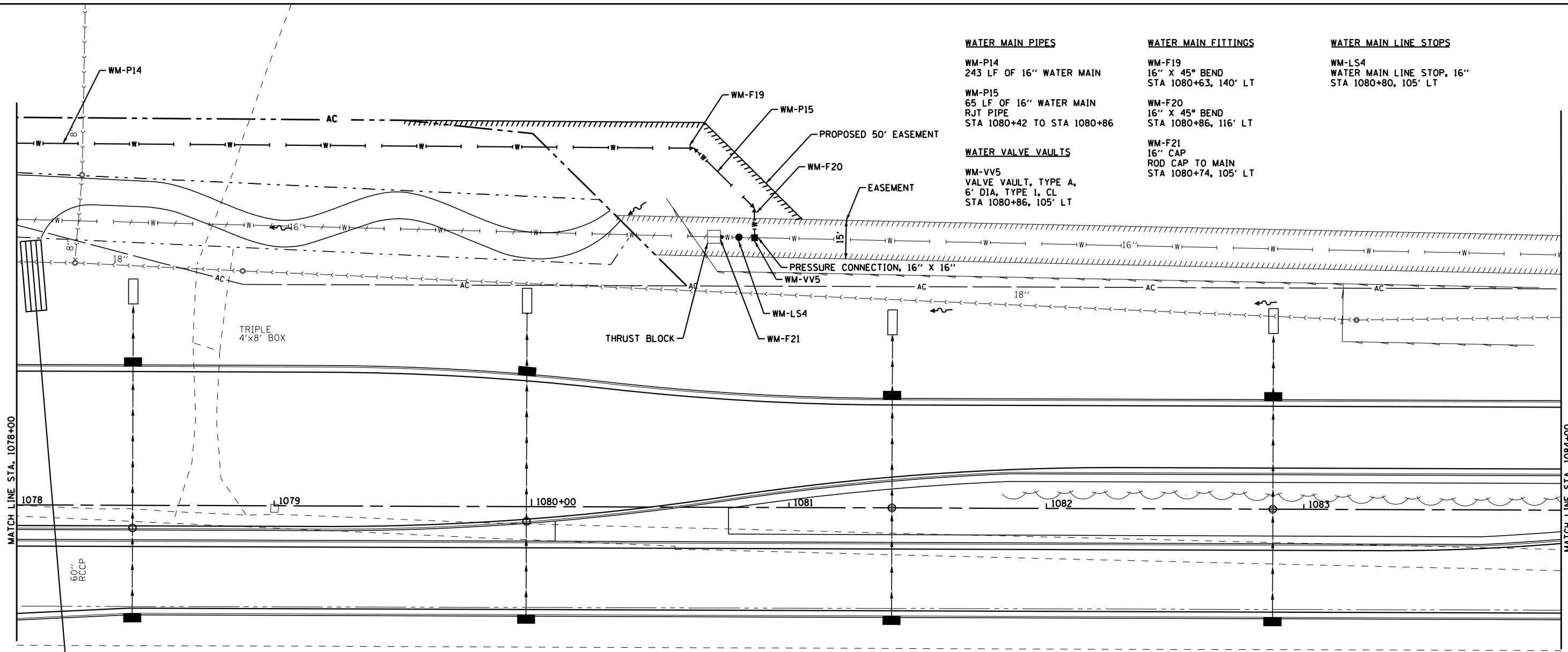

COPYRIGHT © 2012 BY BAXTER & WOODMAN, INC.  
 STATE OF ILLINOIS - PROFESSIONAL DESIGN FIRM  
 LICENSE NO. 184-001271, EXPIRES 4/30/2015  
 505 S. STATE ST., SUITE 200, CHICAGO, IL 60607  
 ...\\dotpdr\vdof-BM\_300dplp1t  
 ...\\CAD\Projects\10789-WaterMain-PPI11.shp  
 5/13/2013 10:09:59 AM



DESIGNED - MPK	REVISED -
DRAWN - KAR	REVISED -
CHECKED - MPK	REVISED -
DATE - APRIL 30, 2013	FILE - 110789-WaterMain-PPI11.shp

**STATE OF ILLINOIS**  
**DEPARTMENT OF TRANSPORTATION**

**NORTH PARK PUBLIC WATER DISTRICT**  
**ROUTE 173**  
**WATER MAIN RELOCATION**

SCALE: H: 1"=20' V: 1"=5'

STA. 1078+00 TO STA. 1084+00

F.A.P. RTE. 303	SECTION 129R	COUNTY WINNEBAGO	TOTAL SHEETS 968	SHEET NO. 465
CONTRACT NO. 64988			ILLINOIS FED. AID PROJECT	