

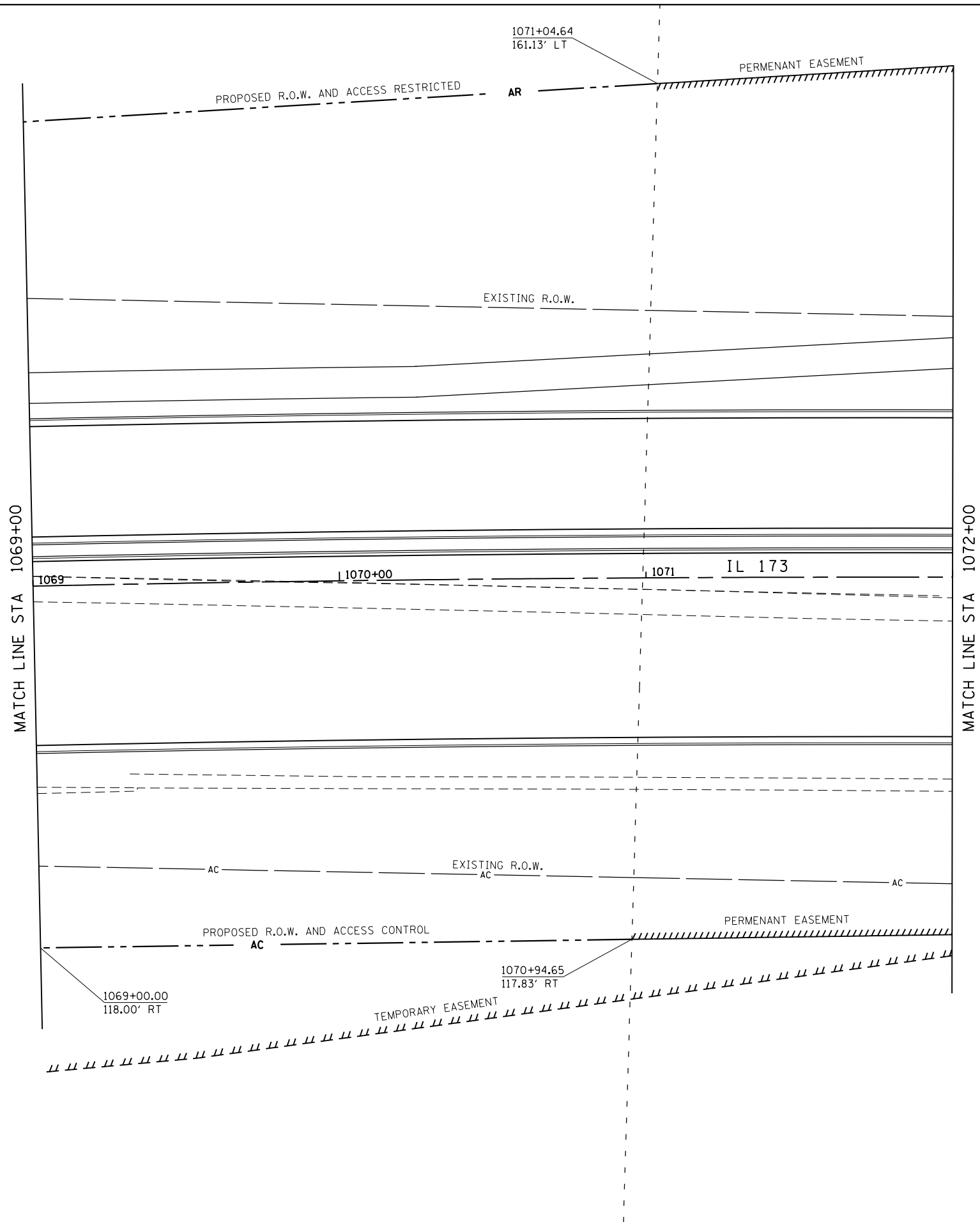

PROP. CURVE 74330
 PI STA. = 1070+60.92
 Δ = 3° 13' 46" (RT)
 D = 0° 26' 00"
 R = 13,225.13'
 T = 372.80'
 L = 745.40'
 E = 5.25'
 e = -----
 T.R. = -----
 S.E. RUN = -----
 P.C. STA = 1066+88.12
 P.T. STA = 1074+33.52



FILE NAME = Z00793RWES11.dgn
 MODEL = Untitled Sheet
 PLOT DRIVER = V8i_PDF_11x17.pltcf9



USER NAME = rgoertz	DESIGNED - KEC	REVISED -
	DRAWN - KEC	REVISED -
PLOT SCALE = 40.0000' / in.	CHECKED - MTM	REVISED -
PLOT DATE = 5/2/2013 11:02:08 AM	DATE - APRIL 30, 2013	REVISED -

STATE OF ILLINOIS
DEPARTMENT OF TRANSPORTATION

RIGHT OF WAY PLANS	
IL 173 FROM ALPINE ROAD TO I-90	
PROJECT	JOB NO.
SCALE: 1"=20'	SHEET NO. 9 OF 41 SHEETS
STA. 1069+00 TO STA. 1072+00	

F.A.P. RTE.	SECTION	COUNTY	TOTAL SHEETS	SHEET NO.
303	129R	WINNEBAGO	968	497
CONTRACT NO. 64988				
ILLINOIS FED. AID PROJECT				