

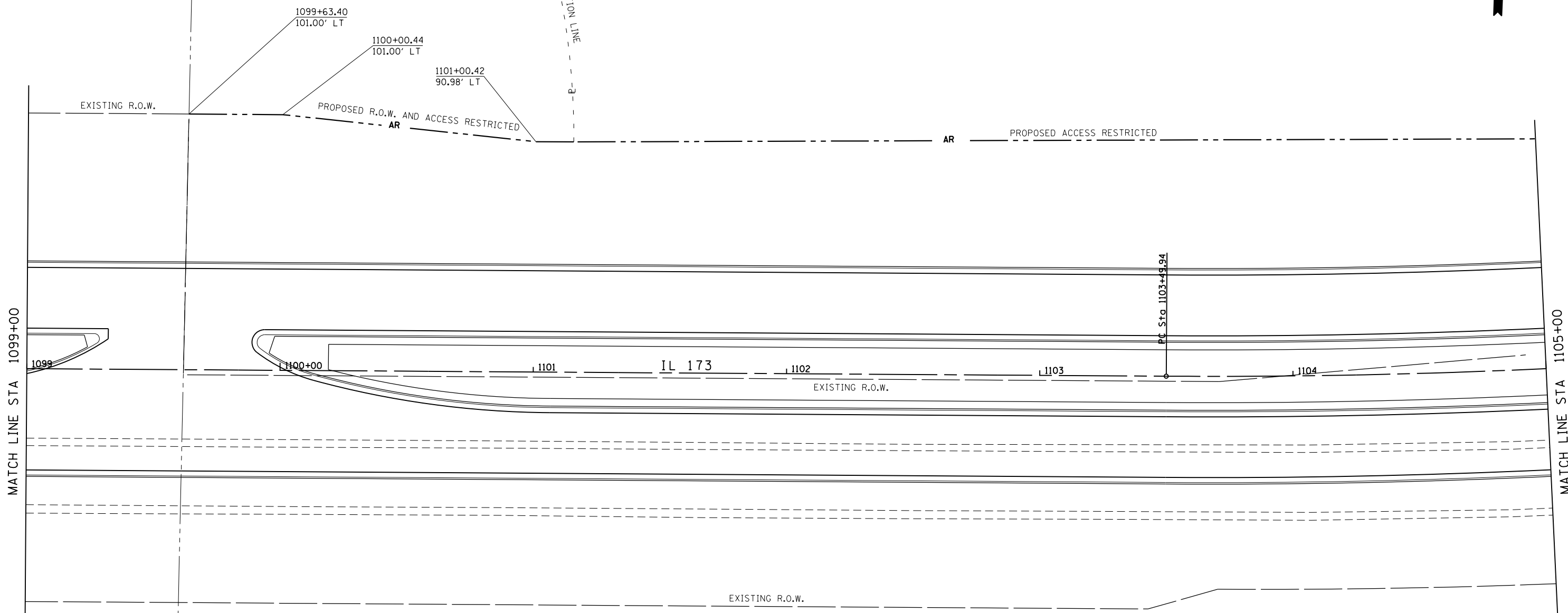

THIS AREA ACQUIRED BY IDOT
SEE ROW PLATS



PROP. CURVE 74340
 PI STA. = 1112+42.74
 $\Delta = 34^\circ 56' 57''$ (LT)
 $D = 2^\circ 01' 13''$
 $R = 2,836.00'$
 $T = 892.80'$
 $L = 1,729.89'$
 $E = 137.21'$
 $e = \text{-----}$
 $T.R. = \text{-----}$
 $S.E. \text{ RUN} = \text{-----}$
 $P.C. \text{ STA} = 1103+49.94$
 $P.T. \text{ STA} = 1120+79.83$



FILE NAME = Z00793RWES17.dgn
 MODEL = Untitled Sheet
 PLOT DRIVER = V8...PDF...11x17.pltcf9



USER NAME = rgoertz	DESIGNED - KEC	REVISED -
	DRAWN - KEC	REVISED -
PLOT SCALE = 40.0000' / in.	CHECKED - MTM	REVISED -
PLOT DATE = 5/2/2013 11:02:10 AM	DATE - APRIL 30, 2013	REVISED -

**STATE OF ILLINOIS
DEPARTMENT OF TRANSPORTATION**

RIGHT OF WAY PLANS	
IL 173 FROM ALPINE ROAD TO I-90	
PROJECT	JOB NO.
SCALE: 1"=20'	SHEET NO. 15 OF 41 SHEETS
STA. 1099+00 TO STA. 1105+00	

F.A.P. RTE.	SECTION	COUNTY	TOTAL SHEETS	SHEET NO.
303	129R	WINNEBAGO	968	503
CONTRACT NO. 64988				
ILLINOIS FED. AID PROJECT				