

PROP. CURVE 51200
 PI STA. = 97+61.85
 $\Delta = 18^\circ 24' 55''$ (LT)
 $D = 19^\circ 05' 55''$
 $R = 300.00'$
 $T = 48.63'$
 $L = 96.42'$
 $E = 3.92'$
 $e = \text{-----}$
 $T.R. = \text{-----}$
 $S.E. RUN = \text{-----}$
 $P.C. STA = 97+13.22$
 $P.T. STA = 98+09.64$

PROP. CURVE 51210
 PI STA. = 98+57.24
 $\Delta = 18^\circ 01' 46''$ (RT)
 $D = 19^\circ 05' 55''$
 $R = 300.00'$
 $T = 47.59'$
 $L = 94.40'$
 $E = 3.75'$
 $e = \text{-----}$
 $T.R. = \text{-----}$
 $S.E. RUN = \text{-----}$
 $P.C. STA = 98+09.64$
 $P.T. STA = 99+04.04$

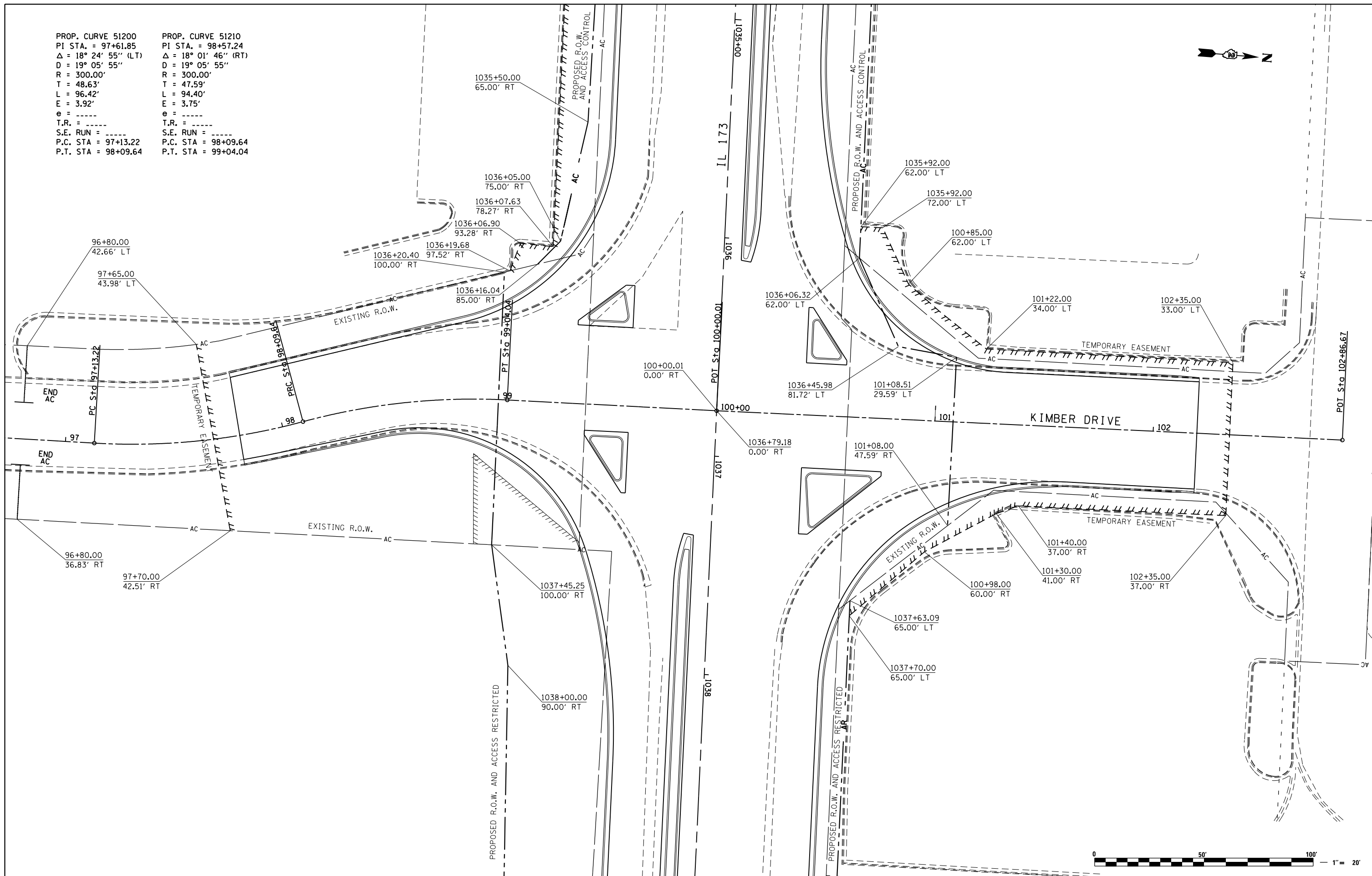

FILE NAME = Z00793RWES2B.dgn
 MODEL = Untitled Sheet
 PLOT DRIVER = V8i_PDF...11x17.pltcf9



USER NAME = rgoertz	DESIGNED - KEC	REVISED -
	DRAWN - KEC	REVISED -
PLOT SCALE = 40.0000' / in.	CHECKED - MTM	REVISED -
PLOT DATE = 5/2/2013 11:02:14 AM	DATE - APRIL 30, 2013	REVISED -

STATE OF ILLINOIS
DEPARTMENT OF TRANSPORTATION

RIGHT OF WAY PLANS
KIMBER DRIVE

PROJECT	JOB NO.
SHEET NO. 26 OF 41 SHEETS	STA. 95+68.88 TO STA. 102+86.67

F.A.P. RTE.	SECTION	COUNTY	TOTAL SHEETS	SHEET NO.
303	129R	WINNEBAGO	968	514
CONTRACT NO. 64988				
ILLINOIS FED. AID PROJECT				