

CORNER RADIUS DATA

PC = 382+71.59, 18.25' LT
 C = 382+69.89, 68.22' LT
 PT = 383+19.89, 68.22' LT
 R = 50'

CORNER RADIUS DATA

PC = 383+41.89, 82.73' LT
 C = 384+01.89, 82.73' LT
 PT = 384+03.93, 22.76' LT
 R = 60'

STA 00+00.00 \downarrow TORQUE ROAD =
 STA 383+30.89 \downarrow FOREST HILLS ROAD (SOUTH)

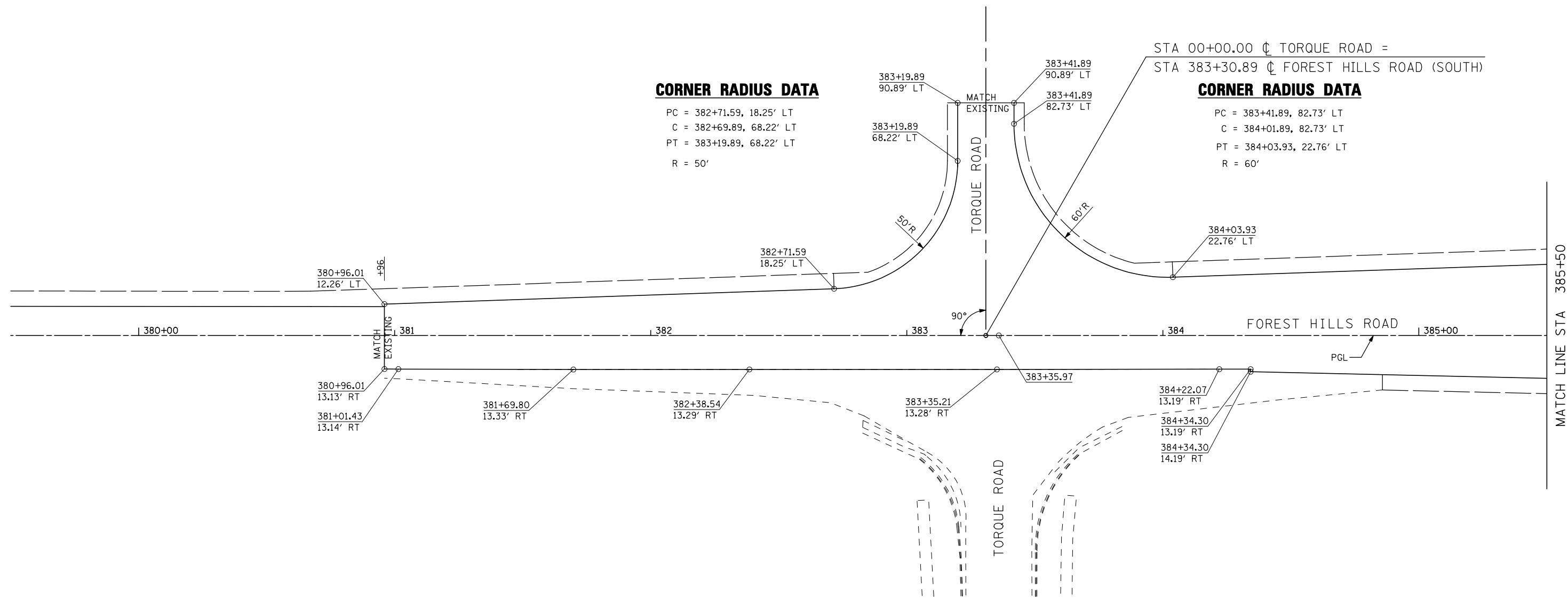

FILE NAME = ...load sheets\2007931VPPLN27.dgn	USER NAME = Elgin 110	DESIGNED - MJS	REVISED -
		DRAWN - LMP	REVISED -
		CHECKED - RMH	REVISED -
		DATE - APRIL 30, 2013	REVISED -
THE UPCHURCH GROUP, INC.	PLOT SCALE = 40.0000' / IN. PLOT DATE = 5/1/2013 1:59:07 PM		

**STATE OF ILLINOIS
 DEPARTMENT OF TRANSPORTATION**

**INTERSECTION AND VARIABLE WIDTH PAVEMENT PLANS
 FOREST HILLS ROAD**

SCALE: 1"=20' SHEET NO. OF SHEETS STA. 380+96.01 TO STA. 385+50

F.A.P. RTE.	SECTION	COUNTY	TOTAL SHEETS	SHEET NO.
303	129R	WINNEBAGO	968	556
ILLINOIS FED. AID PROJECT			CONTRACT NO. 64988	