

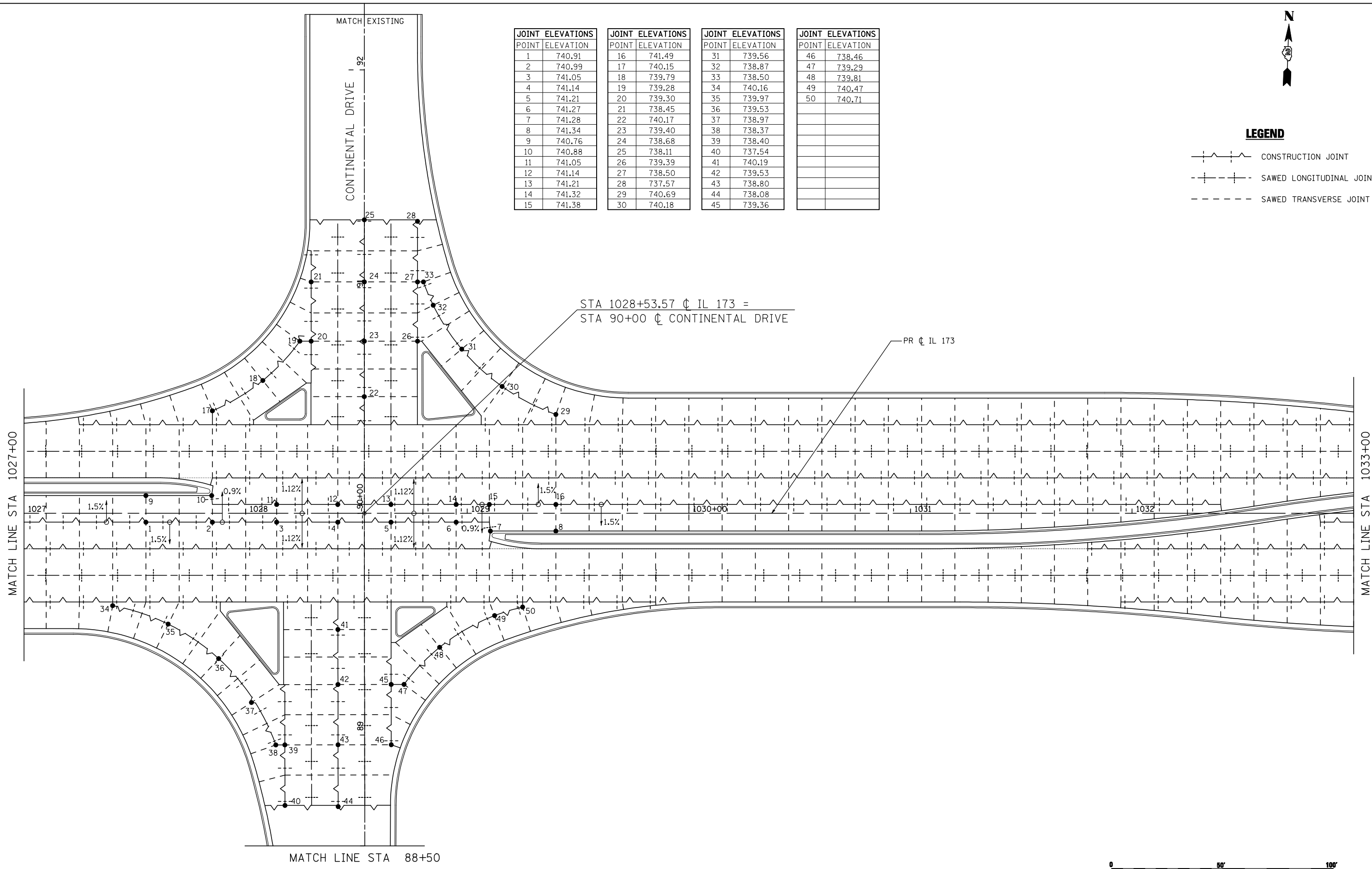

LEGEND

- CONSTRUCTION JOINT
- SAWED LONGITUDINAL JOINT
- SAWED TRANSVERSE JOINT

JOINT ELEVATIONS		JOINT ELEVATIONS		JOINT ELEVATIONS		JOINT ELEVATIONS	
POINT	ELEVATION	POINT	ELEVATION	POINT	ELEVATION	POINT	ELEVATION
1	740.91	16	741.49	31	739.56	46	738.46
2	740.99	17	740.15	32	738.87	47	739.29
3	741.05	18	739.79	33	738.50	48	739.81
4	741.14	19	739.28	34	740.16	49	740.47
5	741.21	20	739.30	35	739.97	50	740.71
6	741.27	21	738.45	36	739.53		
7	741.28	22	740.17	37	738.97		
8	741.34	23	739.40	38	738.37		
9	740.76	24	738.68	39	738.40		
10	740.88	25	738.11	40	737.54		
11	741.05	26	739.39	41	740.19		
12	741.14	27	738.50	42	739.53		
13	741.21	28	737.57	43	738.80		
14	741.32	29	740.69	44	738.08		
15	741.38	30	740.18	45	739.36		



FILE NAME = ... \CADD SHEETS\Z00793PJE01.dgn	USER NAME = Elgin 110	DESIGNED - RLH	REVISED -
		DRAWN - RMH	REVISED -
		CHECKED - MJS	REVISED -
		DATE - APRIL 30, 2013	REVISED -

**STATE OF ILLINOIS
DEPARTMENT OF TRANSPORTATION**

PAVEMENT JOINT ELEVATIONS IL 173 FROM ALPINE ROAD TO I-90			
SCALE: 1"=20'	SHEET NO. OF SHEETS	STA. 1027+00 TO STA. 1033+00	

F.A.P. RTE. 303	SECTION 129R	COUNTY WINNEBAGO	TOTAL SHEETS 968	SHEET NO. 591
ILLINOIS FED. AID PROJECT				CONTRACT NO. 64988

THE UPCHURCH GROUP, INC.