

JOINT ELEVATIONS		JOINT ELEVATIONS		JOINT ELEVATIONS		JOINT ELEVATIONS	
POINT	ELEVATION	POINT	ELEVATION	POINT	ELEVATION	POINT	ELEVATION
1	774.35	16	774.75	31	776.88	46	775.86
2	774.57	17	774.97	32	774.39	47	776.04
3	774.79	18	776.30	33	774.57	48	776.24
4	775.04	19	776.47	34	774.84	49	776.47
5	775.25	20	776.70	35	774.96	50	776.70
6	775.43	21	774.99	36	774.93	51	773.87
7	775.49	22	775.12	37	774.35	52	774.13
8	775.67	23	775.37	38	774.57	53	774.43
9	775.85	24	774.35	39	774.79	54	774.57
10	776.04	25	775.62	40	774.90	55	774.75
11	776.20	26	775.79	41	775.04	56	775.01
12	776.26	27	775.97	42	775.25	57	775.19
13	776.47	28	776.18	43	775.43	58	775.28
14	776.70	29	776.42	44	775.51	59	775.38
15	774.53	30	776.65	45	775.67	60	775.44

JOINT ELEVATIONS		JOINT ELEVATIONS		JOINT ELEVATIONS		JOINT ELEVATIONS		JOINT ELEVATIONS		JOINT ELEVATIONS		JOINT ELEVATIONS	
POINT	ELEVATION	POINT	ELEVATION	POINT	ELEVATION	POINT	ELEVATION	POINT	ELEVATION	POINT	ELEVATION	POINT	ELEVATION
61	775.62	76	774.69	91	774.19	106	775.61	121	774.82	137	775.08	151	775.65
62	775.90	77	774.42	92	773.79	107	775.76	122	774.89	138	774.76	152	775.69
63	776.04	78	774.27	93	775.97	108	775.90	123	774.78	139	774.49	153	775.76
64	776.22	79	775.11	94	775.58	109	776.04	124	774.56	140	774.26	154	775.83
65	773.82	80	774.82	95	775.10	110	776.22	125	774.39	141	774.26	155	775.98
66	773.93	81	774.79	96	774.72	111	773.97	126	774.57	142	775.09	156	776.08
67	774.04	82	774.47	97	774.40	112	774.15	127	774.94	143	774.70	157	-
68	774.15	83	774.27	98	773.87	113	774.24	128	774.70	144	774.60	158	-
69	774.03	84	775.16	99	774.13	114	774.27	129	774.44	145	773.78	159	-
70	773.94	85	774.82	100	774.43	115	774.17	130	774.26	146	774.11	160	-
71	774.72	86	774.80	101	775.01	116	774.08	131	774.45	147	774.39	161	-
72	774.37	87	774.49	102	775.19	117	774.68	132	775.06	148	774.82	162	-
73	774.02	88	774.27	103	775.24	118	774.42	133	774.80	149	774.82	163	-
74	773.79	89	775.22	104	775.33	119	774.14	134	774.59	150	775.42	164	-
75	774.96	90	774.72	105	775.42	120	773.91	135	774.44	151	775.42	165	-

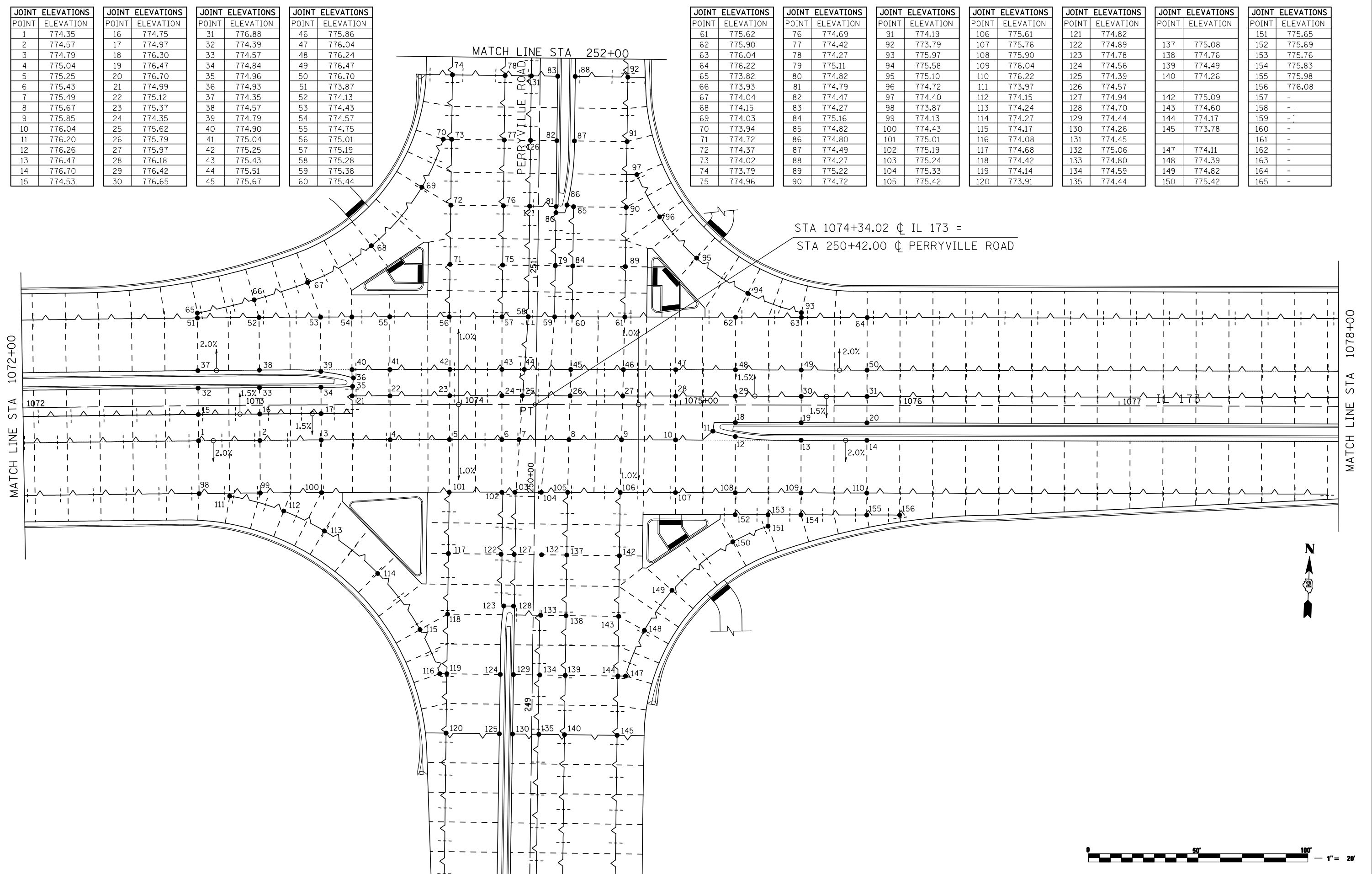

FILE NAME = ...\\CADD SHEETS\200793PJE05.dgn  
 USER NAME = Elgin 110  
 PLOT SCALE = 40.0000' / IN.  
 PLOT DATE = 5/3/2013 8:44:31 AM

DESIGNED - RLH  
 DRAWN - RMH  
 CHECKED - MJS  
 DATE - APRIL 30, 2013

REVISED -  
 REVISED -  
 REVISED -  
 REVISED -

**STATE OF ILLINOIS  
 DEPARTMENT OF TRANSPORTATION**

**PAVEMENT JOINT ELEVATIONS  
 IL 173 FROM ALPINE ROAD TO I-90**  
 SCALE: 1"=20' SHEET NO. OF SHEETS STA. 1072+00 TO STA. 1078+00

F.A.P. RTE.	SECTION	COUNTY	TOTAL SHEETS	SHEET NO.
303	129R	WINNEBAGO	968	595
ILLINOIS FED. AID PROJECT			CONTRACT NO. 64988	