

210 200 190 180 170 160 150 140 130 120 110 100 90 80 70 60 50 40 30 20 10 0 10 20 30 40 50 60 70 80 90 100 110

| | |
|------------------|--|
| DATE | |
| BY | |
| FINAL SURVEY | |
| PLOTTED TEMPLATE | |
| NOTE BOOK | |
| AREAS CHECKED | |
| NO. | |

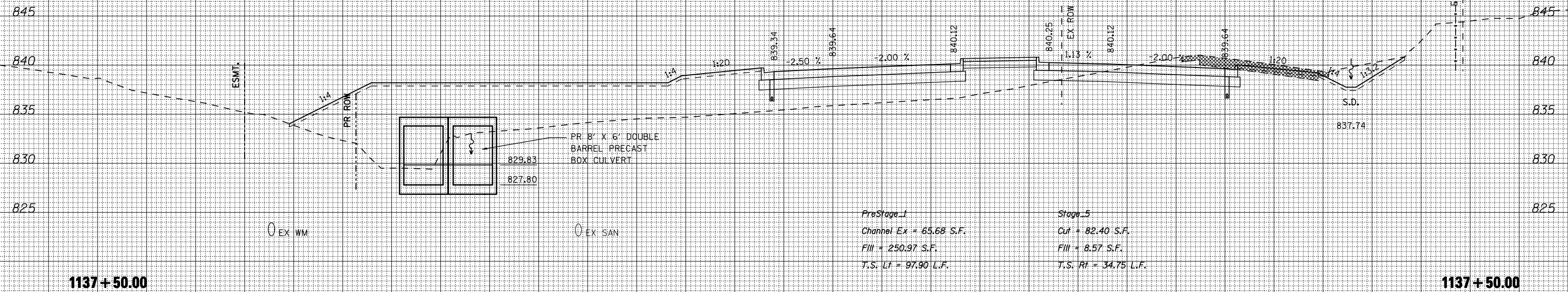

| | |
|------------------|--|
| DATE | |
| BY | |
| ORIGINAL SURVEY | |
| PLOTTED TEMPLATE | |
| NOTE BOOK | |
| AREAS CHECKED | |
| NO. | |

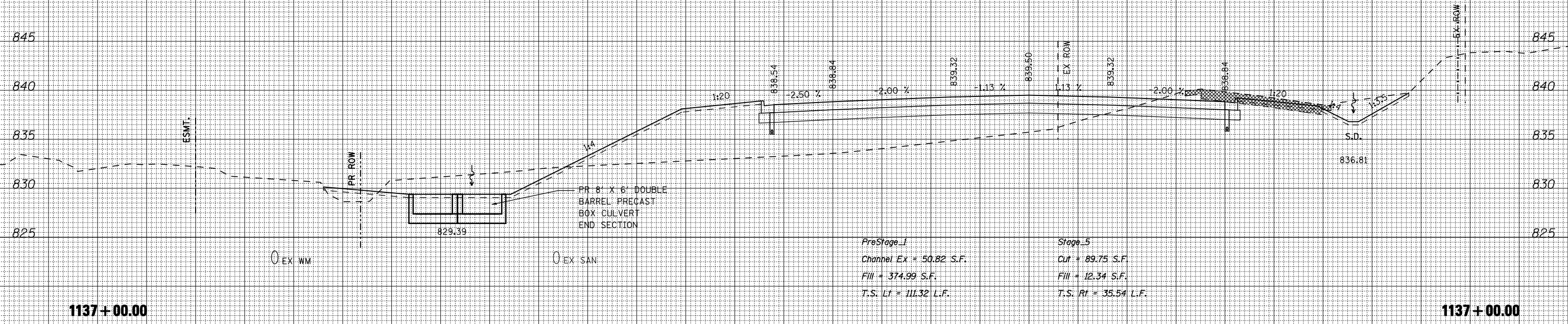

210 200 190 180 170 160 150 140 130 120 110 100 90 80 70 60 50 40 30 20 10 0 10 20 30 40 50 60 70 80 90 100 110

FILE NAME = ... \CADD SHEETS\Z007933MISHT.DGN
THE UPCHURCH GROUP, INC.

USER NAME = Elgin 110
 DESIGNED - SJF
 DRAWN - SAE
 CHECKED - RMH
 DATE - APRIL 30, 2013

REVISED -
 REVISED -
 REVISED -
 REVISED -

**STATE OF ILLINOIS
 DEPARTMENT OF TRANSPORTATION**

CROSS SECTIONS IL 173

SCALE: SHEET NO. OF SHEETS STA. 1137+00.00 TO STA. 1137+50.00

| | | | | |
|---------------------------|---------|-----------|--------------------|-----------|
| F.A.P. RTE. | SECTION | COUNTY | TOTAL SHEETS | SHEET NO. |
| 303 | 129R | WINNEBAGO | 968 | 878 |
| | | | CONTRACT NO. 64988 | |
| ILLINOIS FED. AID PROJECT | | | | |