

DATE	
BY	
SURVEYED	
PLOTTED	
TEMPLATE	
NOTE BOOK	
AREAS CHECKED	
NO.	

DATE	
BY	
SURVEYED	
PLOTTED	
TEMPLATE	
NOTE BOOK	
AREAS CHECKED	
NO.	

**RECONSTRUCTION ENDS STA 132+00**

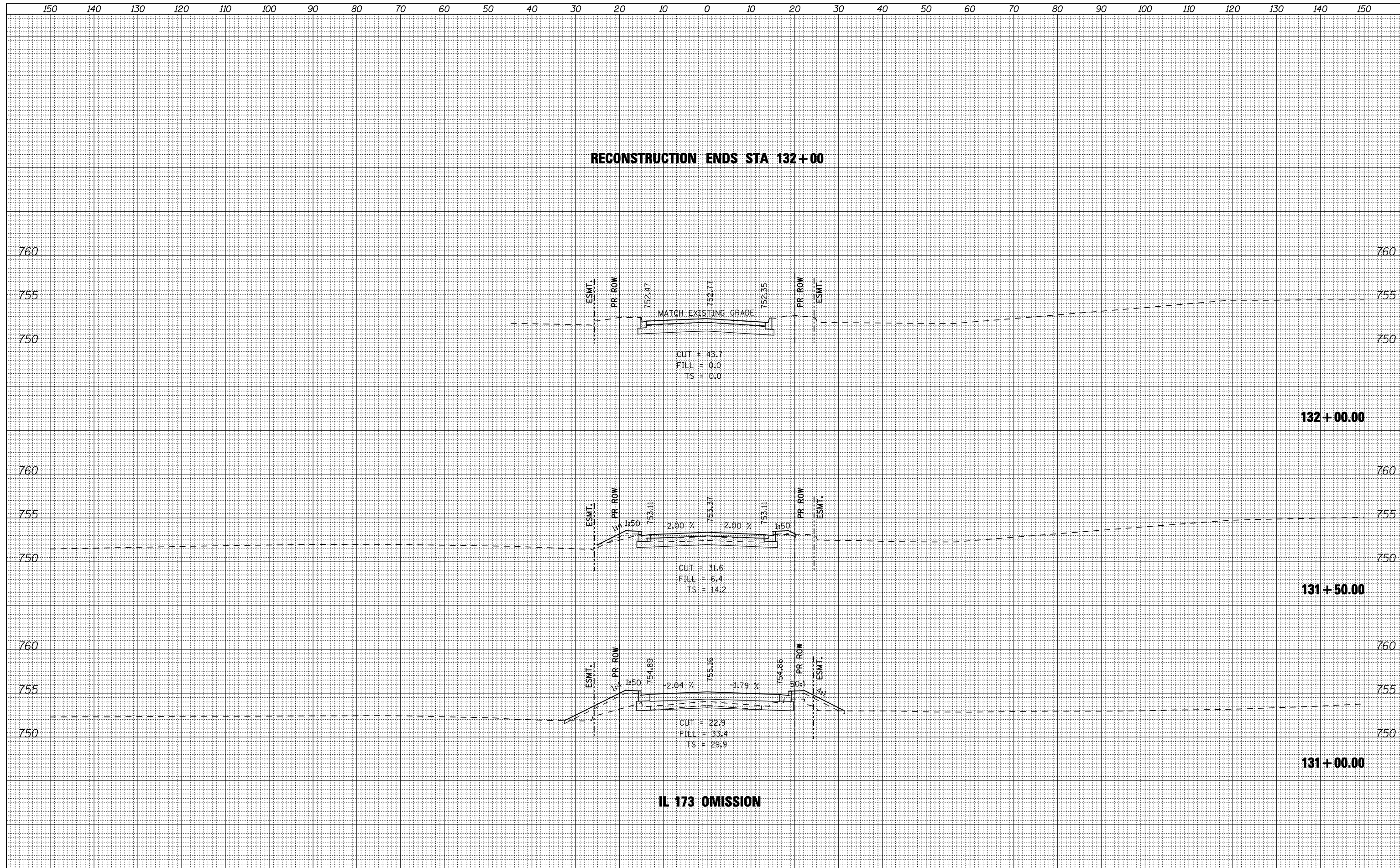

**IL 173 OMISSION**

FILE NAME = ...\\cadd sheets\200793X55SH1.dgn  
**THE UPCHURCH GROUP, INC.**

USER NAME = Elgin 110	DESIGNED - RLH	REVISED -
	DRAWN - LMP	REVISED -
PLOT SCALE = 20.0000' / IN.	CHECKED - MJS	REVISED -
PLOT DATE = 5/3/2013	DATE - APRIL 30, 2013	REVISED -

**STATE OF ILLINOIS  
DEPARTMENT OF TRANSPORTATION**

<b>CROSS SECTIONS MENARDS SOUTH ENTRANCE</b>			
SCALE:	SHEET NO.	OF SHEETS	STA. 131+00.00 TO STA. 132+00.00

F.A.P. RTE. 303	SECTION 129R	COUNTY WINNEBAGO	TOTAL SHEETS 968	SHEET NO. 904
			CONTRACT NO. 64988	
ILLINOIS FED. AID PROJECT				