

DATE	
BY	
SURVEYED	
PLOTTED	
TEMPLATE	
AREAS	
CHECKED	
FINAL SURVEY	
NOTE BOOK	
NO.	

DATE	
BY	
SURVEYED	
PLOTTED	
TEMPLATE	
AREAS	
CHECKED	
ORIGINAL SURVEY	
NOTE BOOK	
NO.	

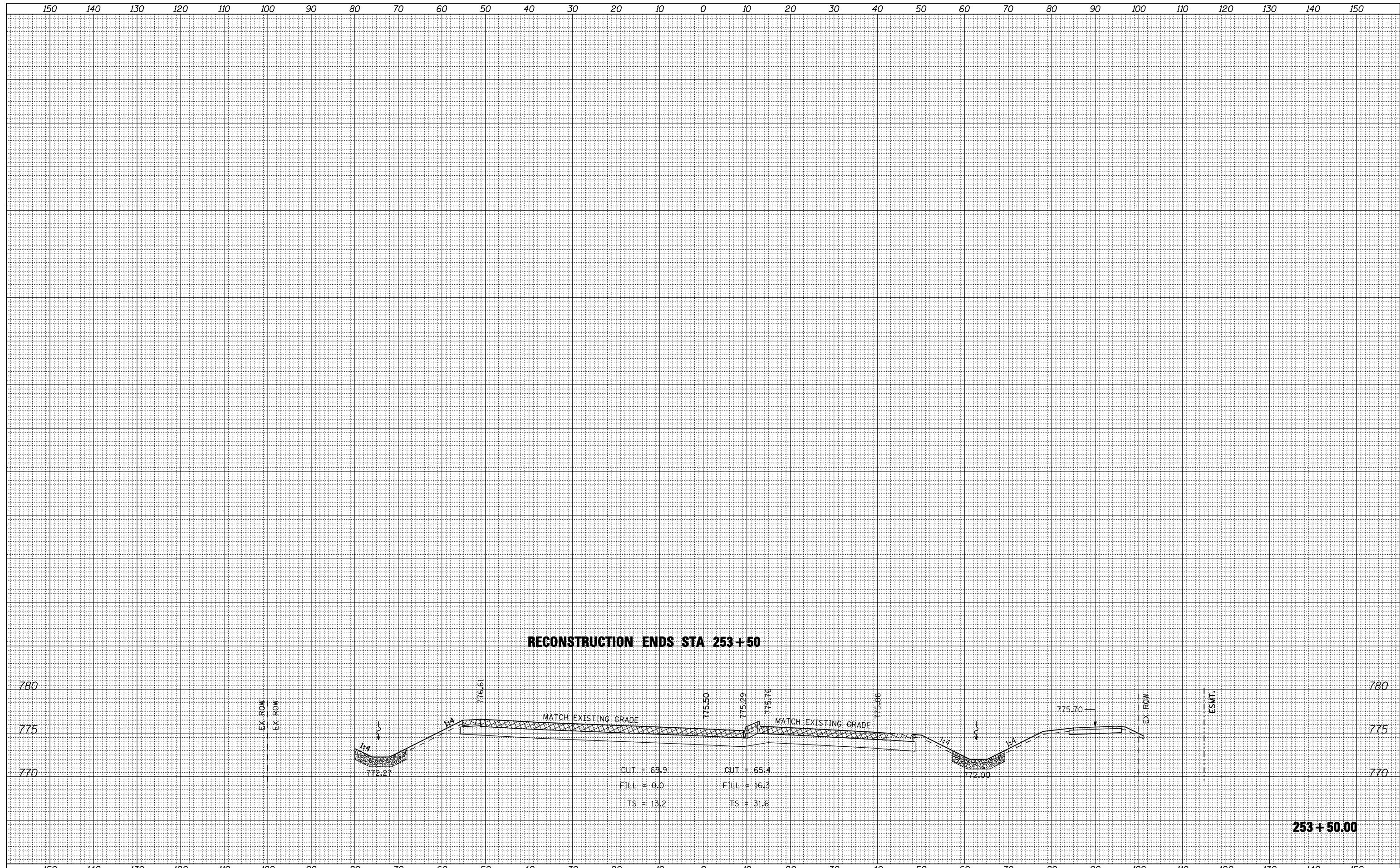

RECONSTRUCTION ENDS STA 253+50

CUT = 69.9
 FILL = 0.0
 TS = 13.2

CUT = 65.4
 FILL = 16.3
 TS = 31.6

253 + 50.00

FILE NAME = ...cadd sheets\200793X585HT.dgn	USER NAME = Elgrn 110	DESIGNED - DRAWN - SJF	REVISED - REVISED -	<p align="center">STATE OF ILLINOIS DEPARTMENT OF TRANSPORTATION</p>	<p align="center">CROSS SECTIONS PERRYVILLE ROAD</p>			F.A.P. RTE. 303	SECTION 129R	COUNTY WINNEBAGO	TOTAL SHEETS 968	SHEET NO. 938
THE UPCHURCH GROUP, INC.	PLOT SCALE = 20.0000' / IN.	CHECKED - MJS	REVISED -		SCALE:	SHEET NO.	OF SHEETS	STA. 253+50.00	TO STA. 253+50.00	CONTRACT NO. 64988		
	PLOT DATE = 5/3/2013	DATE - APRIL 30, 2013	REVISED -		ILLINOIS FED. AID PROJECT							