

HORIZONTAL CONTROL POINTS							
POINT	NORTHING	EASTING	ELEVATION	CHAIN	STATION	OFFSET	DESCRIPTION
42	2024183.4510	2582748.6500	747.6200	BYPASS20	890+56.39	64.8311' RT	GPS CONTROL POINT, PIN
43	2024205.4920	2583619.5690	742.5440	BYPASS20	899+27.56	58.359' RT	GPS CONTROL POINT, RAIL ROAD SPIKE
44	2024336.8650	2584062.8890	731.6030	BYPASS20	903+73.16	65.0699' LT	GPS CONTROL POINT, PIN

HORIZONTAL CONTROL POINTS							
POINT	NORTHING	EASTING	ELEVATION	CHAIN	STATION	OFFSET	DESCRIPTION
40	2023522.8180	2583180.8560	723.8430	IL2	241+98.19	51.8448' RT	GPS CONTROL POINT, PIN
41	2024702.9160	2583045.1100	728.3440	IL2	253+80.76	60.3935' LT	GPS CONTROL POINT, PIN

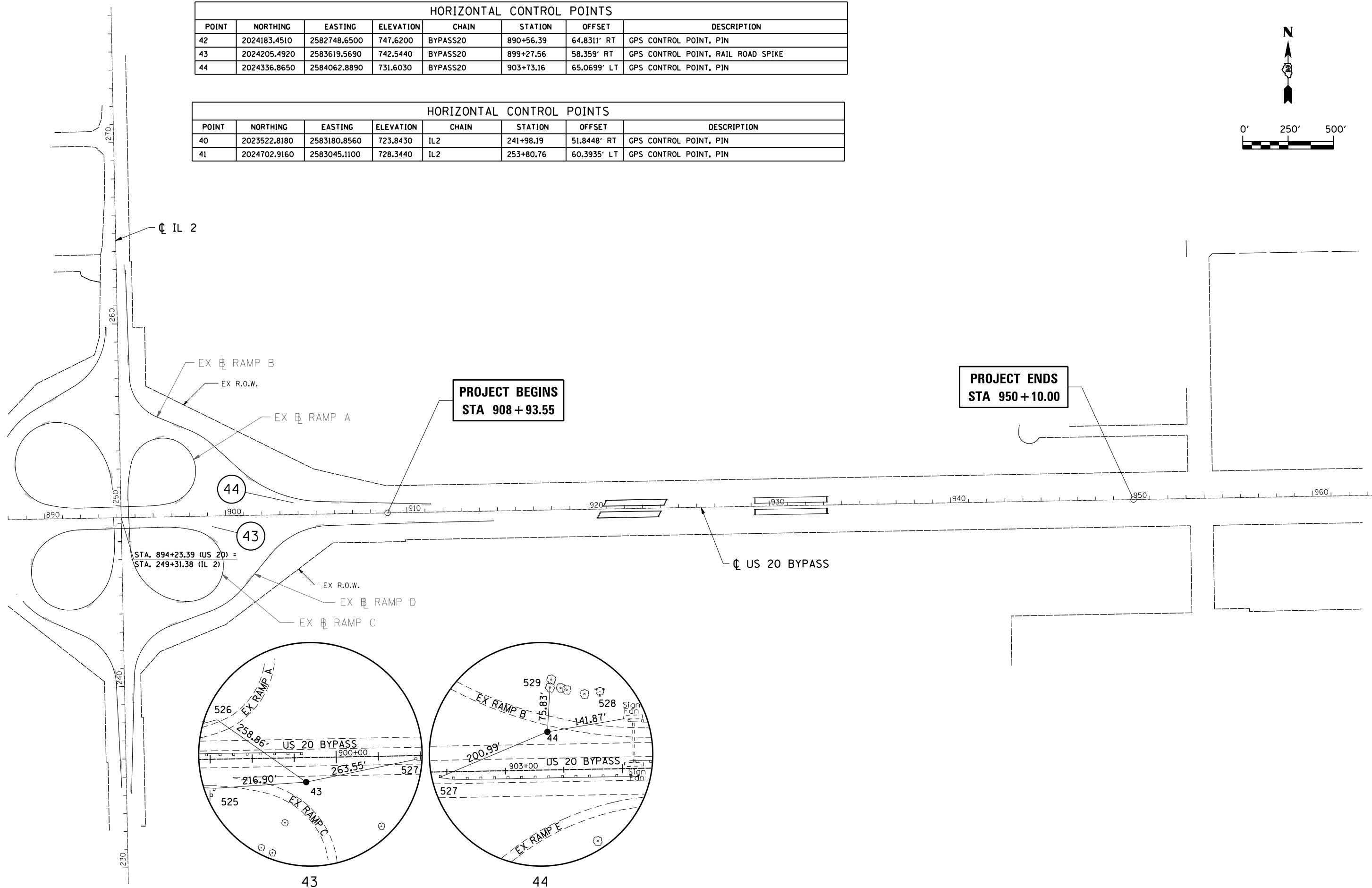

FILE NAME = D:\264019-ah-t-HV-Control-01.dgn
 MODEL = Default
 PLOT DRIVER = VBA_IIDOT_PDF_11x17.pltcfgr

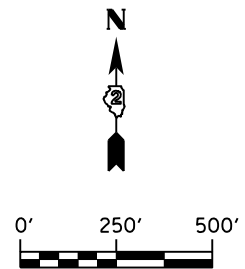

USER NAME = rgoertz	DESIGNED - ES	REVISED -
PLOT SCALE = 500.0000' / in.	DRAWN - TRF	REVISED -
PLOT DATE = 8/16/2013	CHECKED - CMS	REVISED -
	DATE - 07/01/2013	REVISED -

STATE OF ILLINOIS
DEPARTMENT OF TRANSPORTATION

HORIZONTAL & VERTICAL CONTROL			
US 20 BYPASS			
SCALE: 1" = 250'	SHEET NO.	OF SHEETS	STA. TO STA.

F.A.P. RTE.	SECTION	COUNTY	TOTAL SHEETS	SHEET NO.
301	3BR & 3BR-1	WINNEBAGO	290	28
CONTRACT NO. 64D19				
FED. ROAD DIST. NO. ILLINOIS FED. AID PROJECT				