

NOTE

- SEE 701101, 701400, 701401, 701411, & 704001 FOR ADDITIONAL INFORMATION

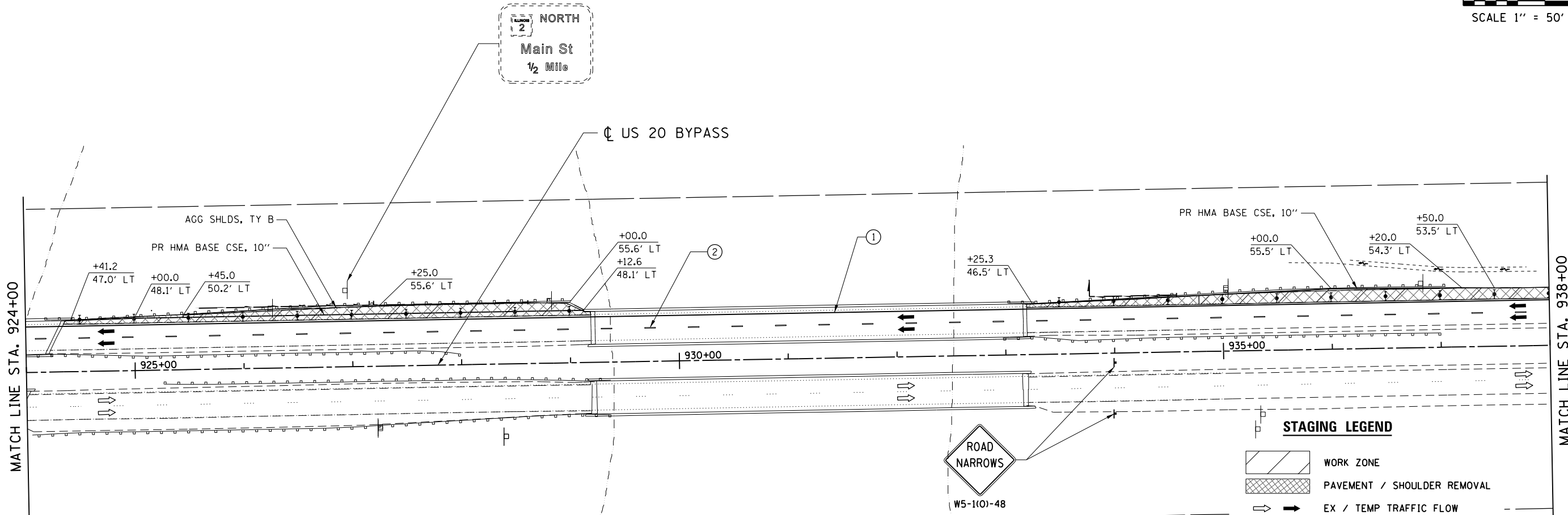
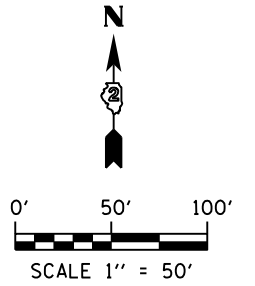

STAGING LEGEND

	WORK ZONE
	PAVEMENT / SHOULDER REMOVAL
	EX / TEMP TRAFFIC FLOW
	SIGN
	DIRECTIONAL INDICATOR BARRICADE W/ STEADY BURN MONODIRECTIONAL LIGHT
	TYPE II BARRICADE, DRUM W/ STEADY BURN MONODIRECTIONAL LIGHT
	TYPE III BARRICADE
	TEMPORARY CONCRETE BARRIER WALL
①	SOLID WHITE, 4"
②	SKIP DASH WHITE, 4"
③	SOLID YELLOW, 4"
④	LETTERS AND SYMBOLS
⑤	SOLID WHITE, 24"
⑥	SOLID WHITE, 8"
⑦	DOTTED WHITE, 8"
⑧	SOLID WHITE, 12"
⑨	SOLID YELLOW, 12"
⑩	LETTERS & SYMBOLS

FILE NAME = D264019-ahh-Staging-Pre1.05.dgn
 MODEL = Default
 PLOT DRIVER = V8i, IDOT, PDF, Ix17, plot19



USER NAME = rgoertz	DESIGNED - RG	REVISED -
DRAWN - TRF	REVISIONS -	
PLOT SCALE = 100.0000' / in.	CHECKED - CMS	REVISIONS -
PLOT DATE = 8/16/2013	DATE - 07/01/2013	REVISIONS -

STATE OF ILLINOIS
DEPARTMENT OF TRANSPORTATION

STAGING PLAN
PRESTAGE 1 - US 20 BYPASS

F.A.P. RTE. 301	SECTION 3BR & 3BR-1	COUNTY WINNEBAGO	TOTAL SHEETS 290	SHEET NO. 42
CONTRACT NO. 64D19				
FED. ROAD DIST. NO. ILLINOIS FED. AID PROJECT				

SCALE: 1" = 50' SHEET NO. OF SHEETS STA. 924+00 TO STA. 938+00