

Note:  
See sheets 23 & 24 of 50 for additional details.  
Bars indicated thus 14 x 2-#4 etc. indicates 14 lines of bars with 2 lengths per line.

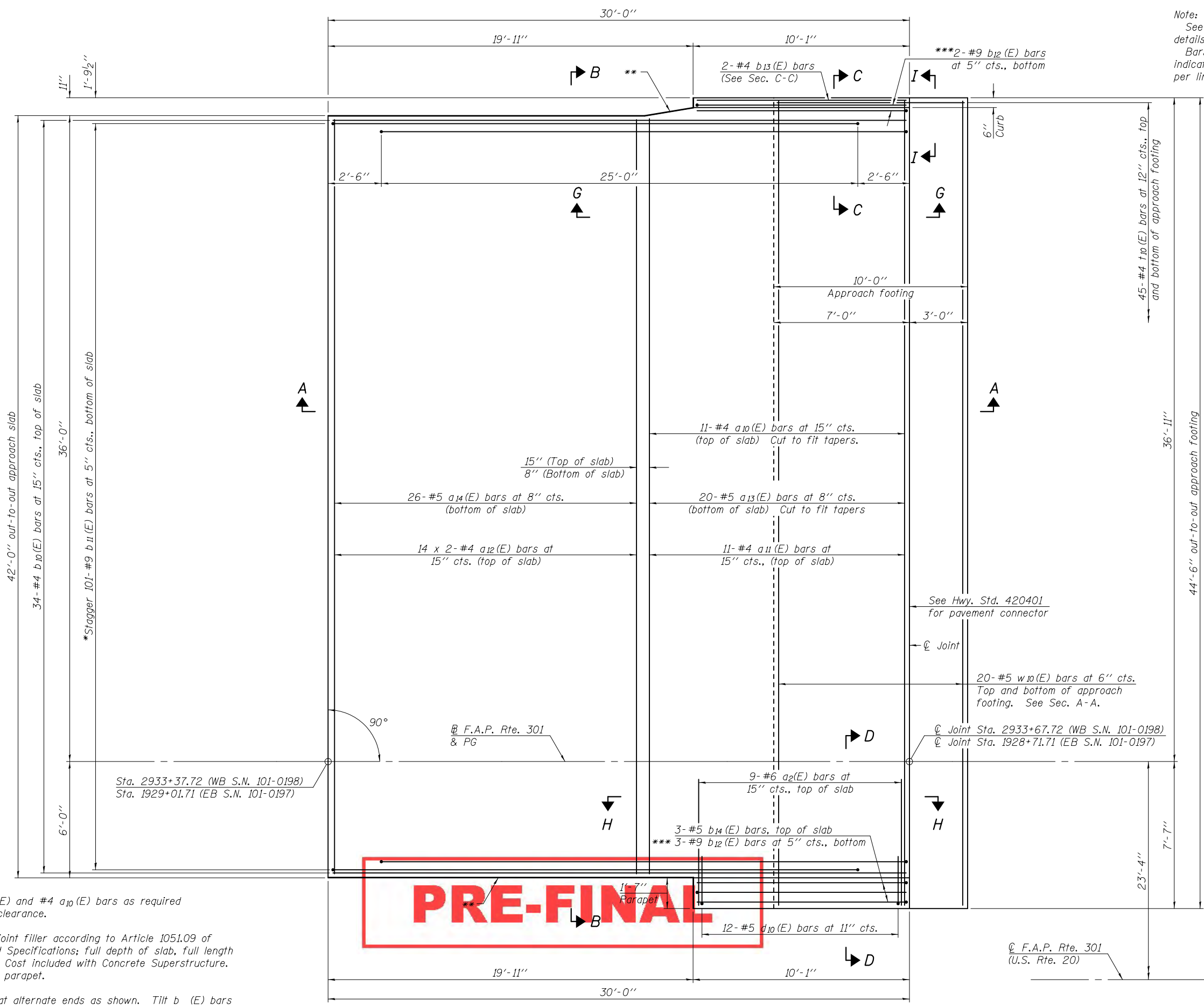
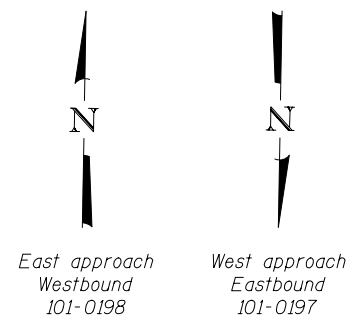

**MINIMUM BAR LAP**  
#4 Bar = 2'-7"

- \* Tilt #9 b<sub>11</sub>(E) and #4 a<sub>10</sub>(E) bars as required to maintain clearance.
- \*\* Closed cell joint filler according to Article 1051.09 of the Standard Specifications; full depth of slab, full length of parapet. Cost included with Concrete Superstructure. Typical each parapet.
- \*\*\* Place hook at alternate ends as shown. Tilt b (E) bars as required to maintain clearance.

PRE-FINAL

PLAN

DESIGNED - NICHOLAS R. BARNETT	EXAMINED - _____ ACTING ENGINEER OF BRIDGE DESIGN	DATE - _____	<b>STATE OF ILLINOIS DEPARTMENT OF TRANSPORTATION</b>	<b>BRIDGE APPROACH SLAB DETAILS - EAST (WB) - WEST (EB) STRUCTURE NO. 101 - 0197 (EB) &amp; 101 - 0198 (WB)</b>	F.A.P. RTE. 301	SECTION 3BR & 3BR-1	COUNTY WINNEBAGO	TOTAL SHEETS	SHEET NO.	
CHECKED - FRANK W. SHARP	PASSED - _____ ACTING ENGINEER OF BRIDGES AND STRUCTURES	REVISED - _____			CONTRACT NO. 64D19					
DRAWN - MICHAEL B. MOSSMAN		REVISED - _____			SHEET NO. 22 OF 50 SHEETS					
CHECKED - NRB/FWS/GRA					ILLINOIS FED. AID PROJECT					