

ROUTE NO.	SEC.	COUNTY	SYMBOL	DATE
P.A. 194	3B1	WINNEBAGO	25	4
STA.	TO STA.			
P.C.D. ROAD DIST. NO. VILLINOIS				

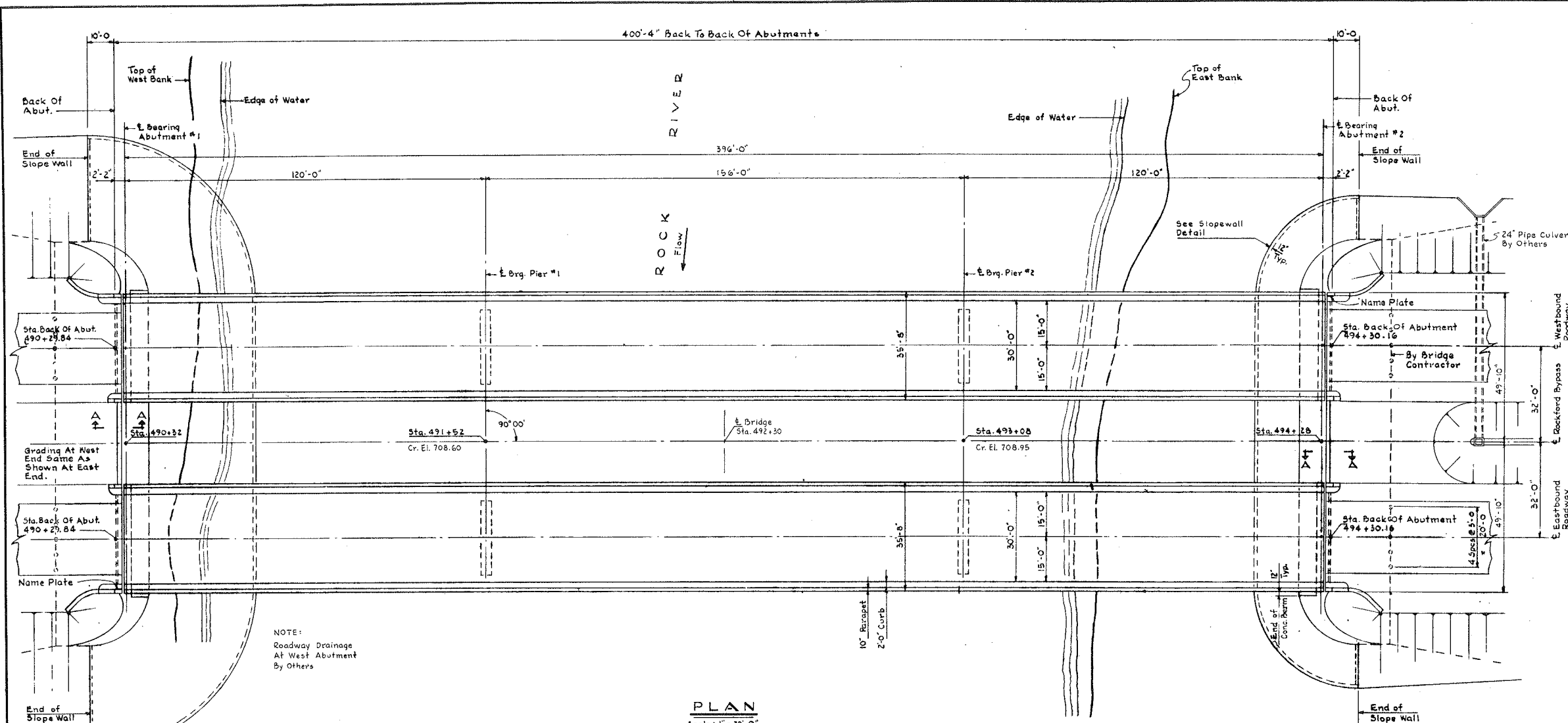

PLAN
Scale: 1" = 20'-0"

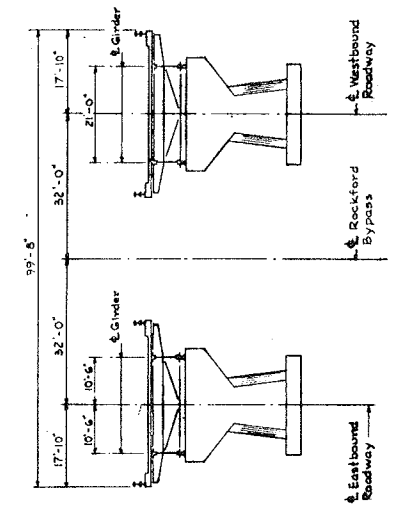

TYPICAL CROSS SECTION
Scale: 1" = 20'-0"

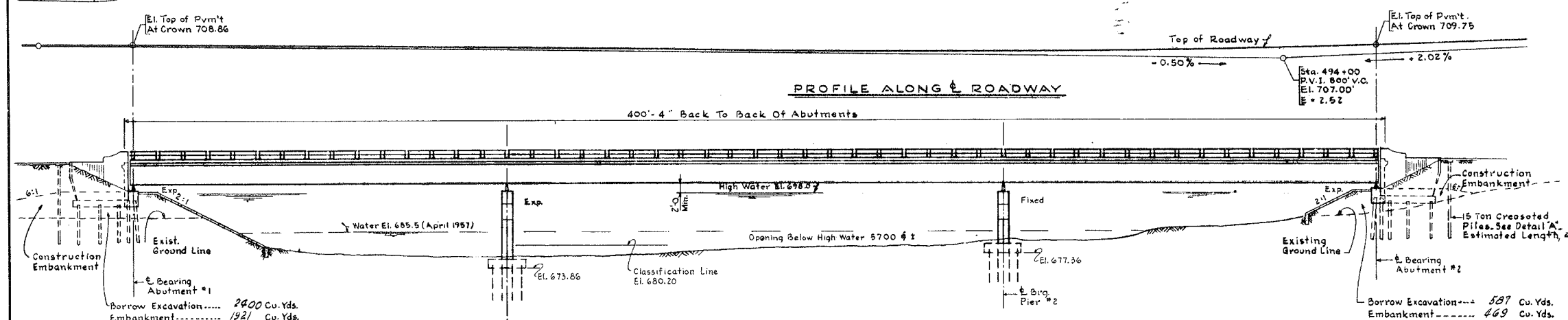

PROFILE ALONG ROADWAY
Scale: 1" = 20'-0"

STATION 492+30
BUILT 195 BY
STATE OF ILLINOIS
F.A. RT. 194 SEC. 3B1
F.A. PROJ. U-284(5)
LOADING H20-S16
SEE STATE OF ILL. STD. 2133

NAME PLATE
(TWO REQ'D)

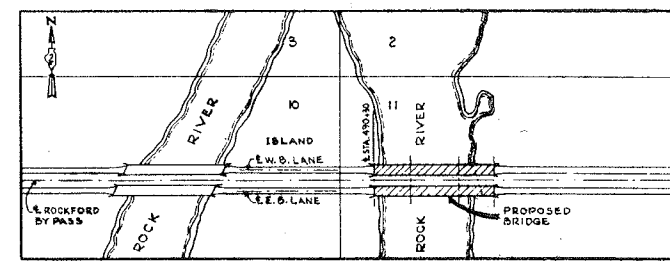

VICINITY MAP
T43N., R1E., 3E2 P.M.

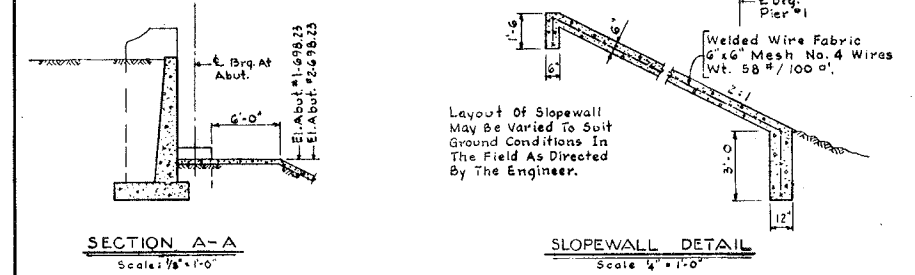

SECTION A-A
Scale: 1/8" = 1'-0"

Layout of Slope Wall
May Be Varied To Suit
Ground Conditions In
The Field As Directed
By The Engineer.

SLOPEWALL DETAIL
Scale: 1/4" = 1'-0"

ELEVATION
Scale: 1" = 20'-0"

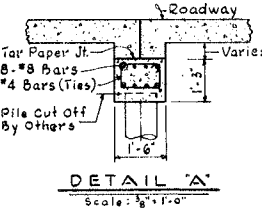

DETAIL 'A'
Scale: 1/4" = 1'-0"

DRAINAGE DATA

Drainage Area	6400 Sq. Miles
Character	Rolling Hilly
Required Opening	8566 Sq. Ft.
Proposed Opening	
Bridge 3B	3500 Sq. Ft.
Bridge 3B1	5700 Sq. Ft.
Total	9200 Sq. Ft.

DESIGN DATA

LOADING:
Live Load H20 - S16 - 44
20 p.s.f. Future Wearing Surface

STRESSES:
Concrete:
fc = 1400 P.S.I. Superstructure, n = 10
fc = 1000 P.S.I. Substructure (With Earth Pressure)
fc = 1400 P.S.I. Substructure (Without Earth Pressure)
75 P.S.I. Max. Allowable V in Pier Footings.

Steel:
Structural Reinforcing fs = 18,000 3/8"
fs = 20,000 1/2"

FOR INFORMATION ONLY

MCCABEE, CAMPBELL & ASSOCIATES CONSULTING ENGINEERS
WE BUILT IT ON TREATMENT CHICAGO, ILLINOIS

ILLINOIS DIVISION OF HIGHWAYS
ROCKFORD BYPASS

PROJECT F. A. ROUTE 194 SECTION 3B1
WINNEBAGO COUNTY

GENERAL PLAN

Designed by E.S. Drawn by G.G. Checked by: