

Bench Mark: Chiseled Square on Northeast corner of East Railway Bridge at top of wingwall 47.192 ft left of Station 933+27.579. Elevation 709.838

Existing Structures: SN 101-0059 (E.B.) and SN 101-0060 (W.B.) over East (Main) Channel of Rock River. Built in 1961 as F.A. RT, 194 Section 3B1, F.A. PROJ U-284 (5) at station 492+30. Existing dual structures each consist of 3-spans, reinforced concrete deck on two riveted steel plate girders supported by closed Pile bent abutments and the two piers are solid hammerhead type. All substructure units are supported by concrete piles, 400'-4" back to back of abutments. The main span is 156ft long and both the end spans are 120ft long. The out to out width of deck is 35'-8". The structure is straight no skew. Structures to be removed and replaced, new substructure to accommodate future expansion to inside. Traffic to be maintained utilizing crossovers. No Salvage.

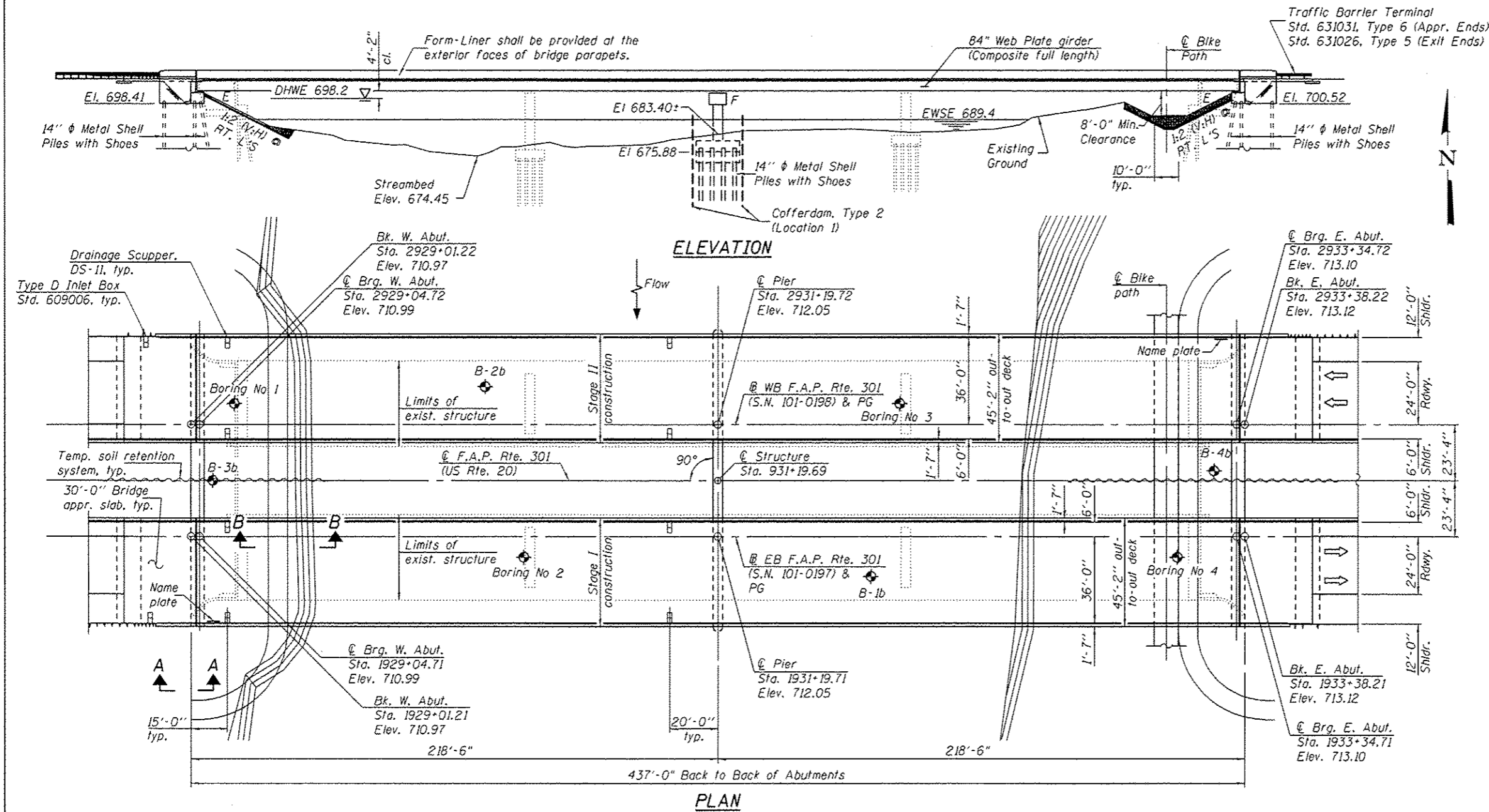

STATION 931+19.69
 BUILT 20 BY
 STATE OF ILLINOIS
 F.A.P. RTE. 301 SEC. 3BR & 3BR-1
 LOADING HL-93
 STRUCTURE NO. 101-0197 (E.B.)

STATION 931+19.69
 BUILT 20 BY
 STATE OF ILLINOIS
 F.A.P. RTE. 301 SEC. 3BR & 3BR-1
 LOADING HL-93
 STRUCTURE NO. 101-0198 (W.B.)

NAME PLATE
 See Std. 515001

LOADING HL-93
 Allow 50#/sq. ft. for future wearing surface.

DESIGN SPECIFICATIONS

2012 AASHTO LRFD Bridge Design Specifications, 6th Edition

DESIGN STRESSES

FIELD UNITS

f_c = 3,500 psi
 f_y = 60,000 psi (Reinforcement)
 f_y = 50,000 psi (M270 Grade 50)

SEISMIC DATA

Seismic Performance Zone (SPZ) = 1
 Design Spectral Acceleration at 1.0 sec. (S_{D1}) = 0.079g
 Design Spectral Acceleration at 0.2 sec. (S_{D5}) = 0.134g
 Soil Site Class = D

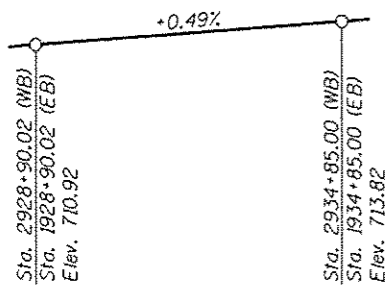

PROFILE GRADE
 (along EB & WB @'s F.A.P. Rte. 301)

Note: For Sections A-A and B-B, see sheet 2 of 50.

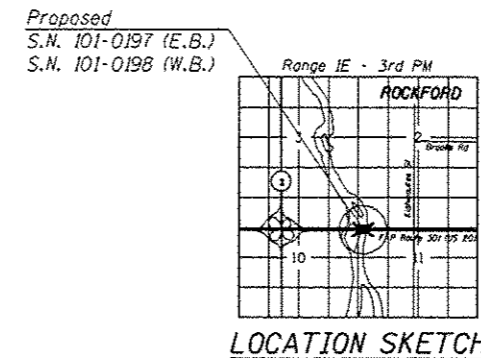

EXPIRES 11-30-2014

DESIGNED - *Michael R. Brown*
 CHECKED - *Mark W. Stora*
 DRAWN - h.f. duong
 CHECKED - *NRP/MS/GPA*

EXAMINED - *Jay F. Smith*
 REGISTERED ENGINEER OF BRIDGE DESIGN
 PASSED
 REGISTERED ENGINEER OF BRIDGES AND STRUCTURES

DATE - OCTOBER 4, 2013

REVISED

STATE OF ILLINOIS
 DEPARTMENT OF TRANSPORTATION

GENERAL PLAN & ELEVATION
 STRUCTURE NO. 101-0197 (E.B.) & 101-0198 (W.B.)

SHEET NO. 1 OF 50 SHEETS

F.A.P. RTE.	SECTION	COUNTY	TOTAL SHEETS	SHEET NO.
301	3BR & 3BR-1	WINNEBAGO	290	176
				CONTRACT NO. 64D19
ILLINOIS FED. AID PROJECT				