

**NORTH CURB LINE**

Location	Station	Offset	Theoretical Grade Elevations
West end of W. Appr. Slab	374+61.38	-20.00	613.03
A	374+71.38	-20.00	612.79
B	374+81.38	-20.00	612.55
East end of W. Appr. Slab	374+91.38	-20.00	612.32

**NORTH EDGE OF ROADWAY**

Location	Station	Offset	Theoretical Grade Elevations
West end of W. Appr. Slab	374+61.38	-12.00	613.20
A	374+71.38	-12.00	612.95
B	374+81.38	-12.00	612.72
East end of W. Appr. Slab	374+91.38	-12.00	612.49

**☉ ROADWAY & PROFILE GRADE**

Location	Station	Offset	Theoretical Grade Elevations
West end of W. Appr. Slab	374+61.38	0.00	613.38
A	374+71.38	0.00	613.14
B	374+81.38	0.00	612.90
East end of W. Appr. Slab	374+91.38	0.00	612.68

**SOUTH EDGE OF ROADWAY**

Location	Station	Offset	Theoretical Grade Elevations
West end of W. Appr. Slab	374+61.38	12.00	613.20
A	374+71.38	12.00	612.95
B	374+81.38	12.00	612.72
East end of W. Appr. Slab	374+91.38	12.00	612.49

**SOUTH CURB LINE**

Location	Station	Offset	Theoretical Grade Elevations
West end of W. Appr. Slab	374+61.38	20.00	613.03
A	374+71.38	20.00	612.79
B	374+81.38	20.00	612.55
East end of W. Appr. Slab	374+91.38	20.00	612.32

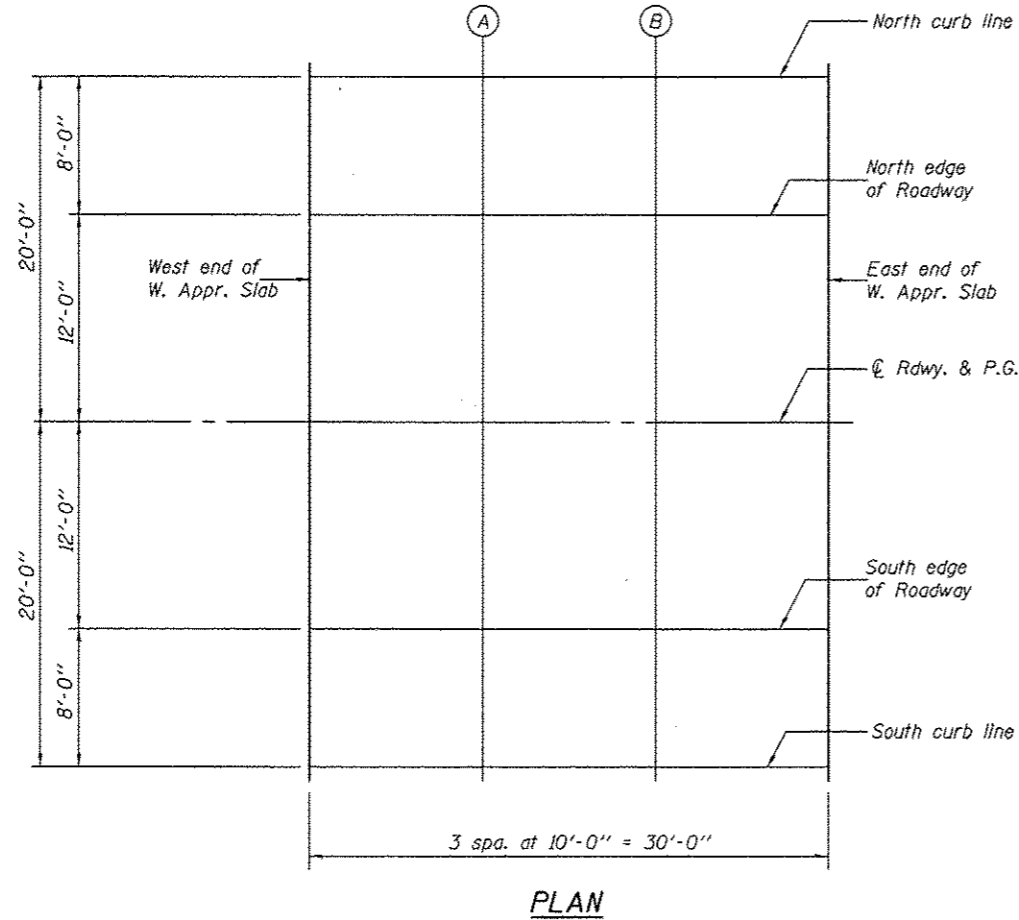

DESIGNED - FESSEHA TEKLEHAIMANOT  
 CHECKED - STEPHEN M. RYAN  
 DRAWN - h.t. duong  
 CHECKED - GRA/FT

EXAMINED  
 PASSED

DATE - December 4, 2012

ACTING ENGINEER OF BRIDGE DESIGN  
 ACTING ENGINEER OF BRIDGES AND STRUCTURES

REVISED  
 REVISED

STATE OF ILLINOIS  
 DEPARTMENT OF TRANSPORTATION

TOP OF WEST APPROACH SLAB ELEVATIONS  
 STRUCTURE NO. 037-0178

SHEET NO. 5 OF 15 SHEETS

F.A.S. RTE.	SECTION	COUNTY	TOTAL SHEETS	SHEET NO.
226	3T & 3BR-1	HENRY	210	46
CONTRACT NO. 64F25				
ILLINOIS FED. AID PROJECT				