

MATCH LINE STA. 5+590
SEE SHEET 56

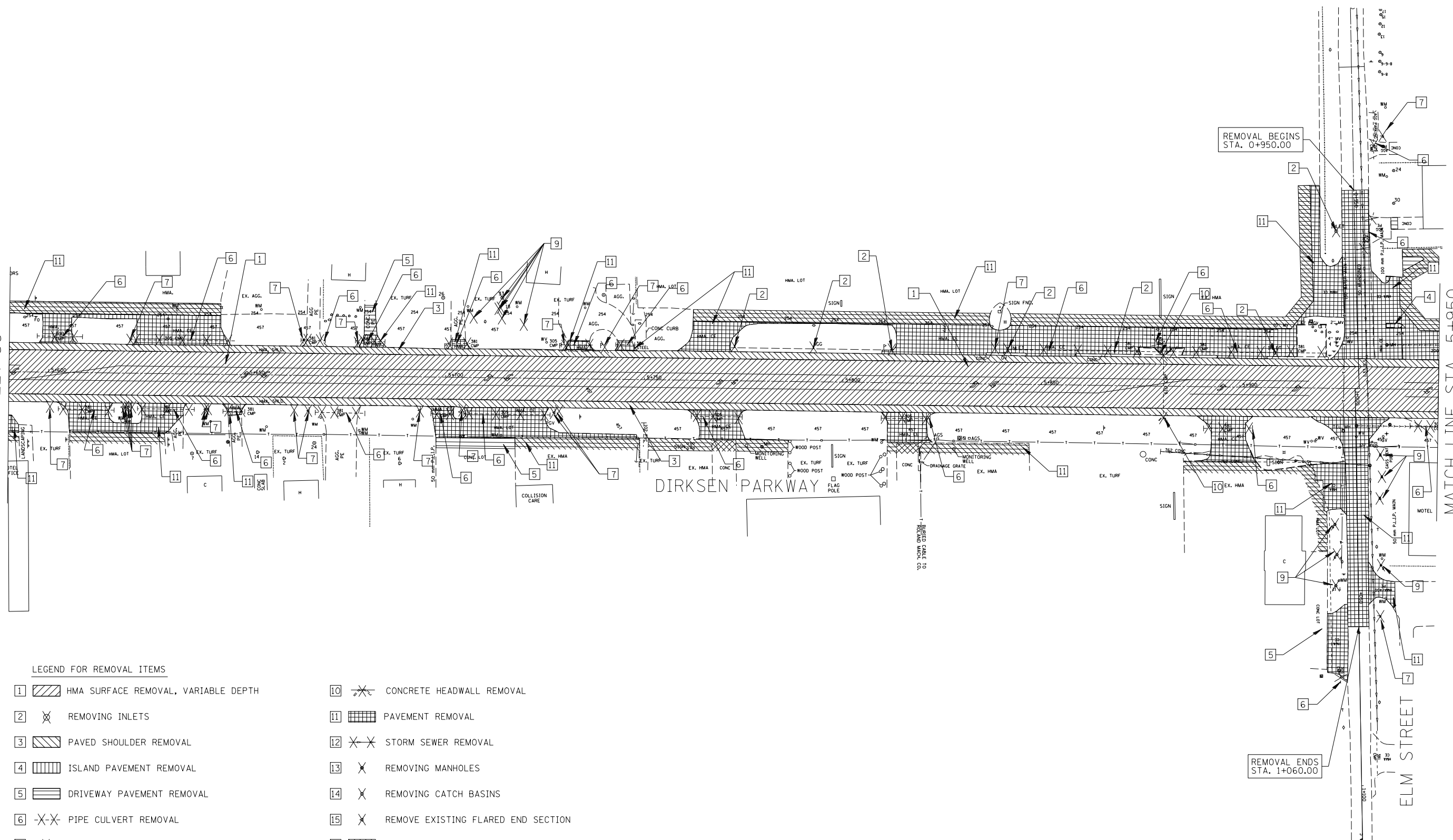

MATCH LINE STA. 5+950
SEE SHEET 58

- LEGEND FOR REMOVAL ITEMS**
- | | |
|---|---|
| 1 [Hatched Box] HMA SURFACE REMOVAL, VARIABLE DEPTH | 10 [Crossed Box] CONCRETE HEADWALL REMOVAL |
| 2 [Crossed Box] REMOVING INLETS | 11 [Grid Box] PAVEMENT REMOVAL |
| 3 [Hatched Box] PAVED SHOULDER REMOVAL | 12 [Crossed Box] STORM SEWER REMOVAL |
| 4 [Grid Box] ISLAND PAVEMENT REMOVAL | 13 [Crossed Box] REMOVING MANHOLES |
| 5 [Hatched Box] DRIVEWAY PAVEMENT REMOVAL | 14 [Crossed Box] REMOVING CATCH BASINS |
| 6 [Crossed Box] PIPE CULVERT REMOVAL | 15 [Crossed Box] REMOVE EXISTING FLARED END SECTION |
| 7 [Crossed Box] RELOCATE EXISTING MAILBOX | 16 [Hatched Box] HMA SURFACE REMOVAL - BUTT JOINT |
| 8 [Crossed Box] COMBINATION CURB AND GUTTER REMOVAL | 17 [Crossed Box] PCC SURFACE REMOVAL - BUTT JOINT |
| 9 [Crossed Box] TREE REMOVAL | |

NOTES:
1. REMOVAL OF AGGREGATE DRIVEWAYS IS INCLUDED IN EARTH EXCAVATION.

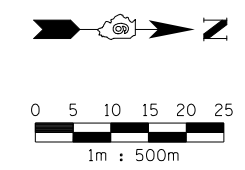

REVISIONS	
NAME	DATE

ILLINOIS DEPARTMENT OF TRANSPORTATION
REMOVAL ITEMS
F.A.P. ROUTE 668 (DIRKSEN PARKWAY)
SECTION 28R-1
SANGAMON COUNTY

SCALE 1 : 500
DATE 06/2013
DRAWN BY RK
CHECKED BY FML