

NOTES:

REFER TO HIGHWAY STANDARD 701602-06 FOR THE PLACEMENT OF TRAFFIC CONTROL SIGNING DURING CONSTRUCTION.

PAINT SHALL BE USED FOR TEMPORARY PAVEMENT STRIPING AT:
 - THE INSIDE LEFT TURN LANE FOR EASTBOUND CLEARLAKE AVE. ONTO NORTHBOUND DIRKSEN PKWY.
 - ALONG DIRKSEN PKWY., FROM STA. 166+55.00 TO 172+67.26 (ENGLISH) AND STA. 5+210.414 TO 5+250.000 (METRIC)

EXISTING PAVEMENT MARKINGS THAT CONFLICT WITH WORK ZONE TRAFFIC CONTROL ALONG DIRKSEN PKWY. FROM STA. 166+55.00 TO 172+67.26 (ENGLISH) AND STA. 5+210.414 TO 5+250.000 (METRIC) SHALL BE REMOVED BY WATER BLASTING / VACUUM RECOVERY AND PAYED FOR AT THE UNIT PRICE PER SQUARE FOOT / SQUARE METER FOR "PAVEMENT MARKING REMOVAL" (SECTION 783, STANDARD SPECIFICATIONS).

WORK ZONE PAVEMENT MARKING REMOVAL ALONG DIRKSEN PKWY. FROM STA. 166+55.00 TO 172+67.26 (ENGLISH) AND STA. 5+210.414 TO 5+250.000 (METRIC) SHALL BE REMOVED BY WATER BLASTING / VACUUM RECOVERY AND PAYED FOR AT THE UNIT PRICE PER SQUARE FOOT / SQUARE METER FOR "WORK ZONE PAVEMENT MARKING REMOVAL" (SECTION 703, STANDARD SPECIFICATIONS).





THE CONTRACTOR SHALL MAINTAIN ALL TEMPORARY PAVEMENT MARKINGS THROUGHOUT THE CONSTRUCTION STAGES OF THIS PROJECT.

ACCESS TO ALL BUSINESS AND RESIDENTIAL PROPERTIES SHALL BE PRESERVED DURING ALL STAGES OF PROPOSED CONSTRUCTION WITH APPROPRIATE SIGNAGE FOR BUSINESS ENTRANCES POSTED.

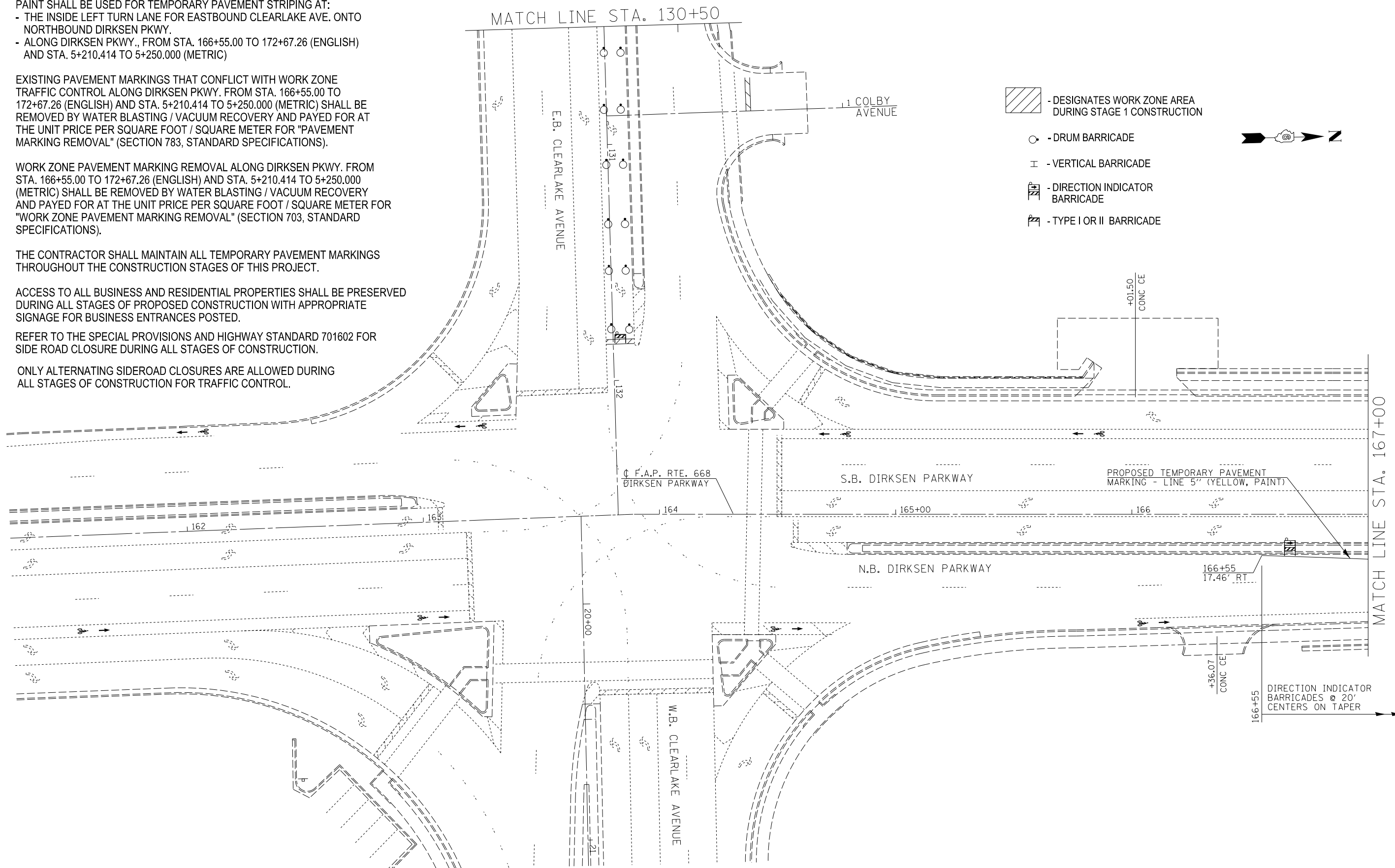
REFER TO THE SPECIAL PROVISIONS AND HIGHWAY STANDARD 701602 FOR SIDE ROAD CLOSURE DURING ALL STAGES OF CONSTRUCTION.

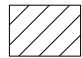
ONLY ALTERNATING SIDEROAD CLOSURES ARE ALLOWED DURING ALL STAGES OF CONSTRUCTION FOR TRAFFIC CONTROL.

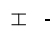
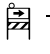

-  - DESIGNATES WORK ZONE AREA DURING STAGE 1 CONSTRUCTION
-  - DRUM BARRICADE
-  - VERTICAL BARRICADE
-  - DIRECTION INDICATOR BARRICADE
-  - TYPE I OR II BARRICADE

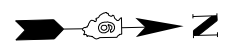

FILE NAME =	USER NAME = Plotted by Scott	DESIGNED - RTS	REVISED -
...Temp Pavement Marking Sheets, Stage 2b.dgn		DRAWN -	REVISED -
\$MODELNAME\$	PLOT SCALE = 48.0000' / in.	CHECKED -	REVISED -
	PLOT DATE	DATE - 05-20-13	REVISED -

**STATE OF ILLINOIS
DEPARTMENT OF TRANSPORTATION**

STAGE CONSTRUCTION, STAGE 2b

SCALE: SHEET 2 OF 10 SHEETS STA. TO STA.

F.A.P. RTE.	SECTION	COUNTY	TOTAL SHEETS	SHEET NO.
668	28R-1	SANGAMON	354	92
			CONTRACT NO. 72501	
ILLINOIS FED. AID PROJECT				