

F.A.U. RTE.	SECTION	COUNTY	TOTAL SHEETS	SHEET NO.
668	28R-1	SANGAMON	354	271
STA. 6+412.500		TO STA. 6+412.500		
FED. ROAD DIST. NO. 6		ILLINOIS	FED. AID PROJECT	
CONTRACT NO. 72501				

FINAL SURVEY	SURVEYED	DATE
NOTE BOOK	FOOTED	
NO.	AREAS	
	CHECKED	

ORIGINAL SURVEY	SURVEYED	DATE
NOTE BOOK	FOOTED	
NO.	AREAS	
	CHECKED	

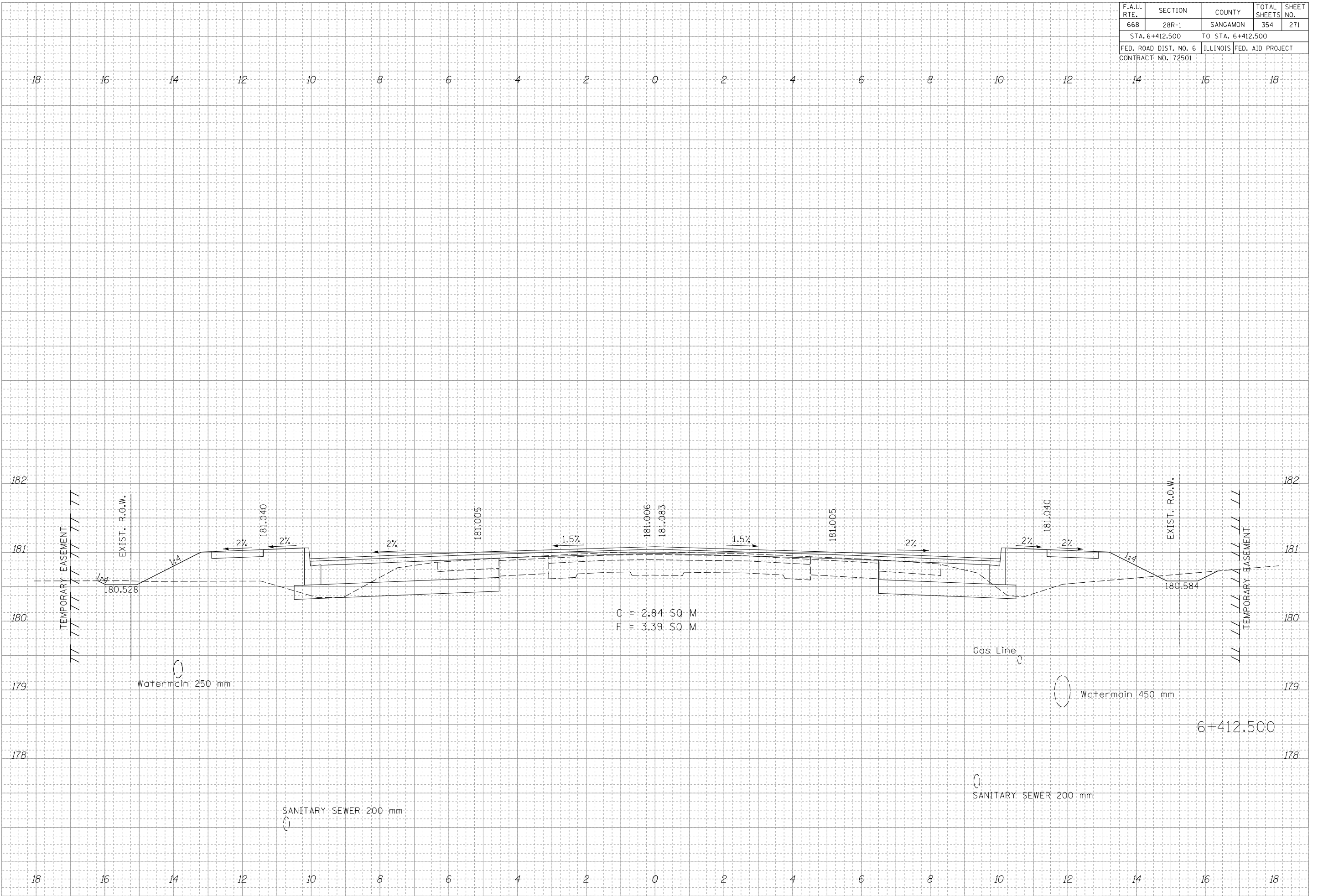

C = 2.84 SQ. M  
 F = 3.39 SQ. M