

DATE	
BY	
FINAL SURVEY	SURVEYED
NOTE BOOK NO.	PLOTTED
	TEMPLATE
	AREAS CHECKED
	AREAS CHECKED

DATE	
BY	
ORIGINAL SURVEY	SURVEYED
NOTE BOOK NO.	PLOTTED
	TEMPLATE
	AREAS CHECKED
	AREAS CHECKED

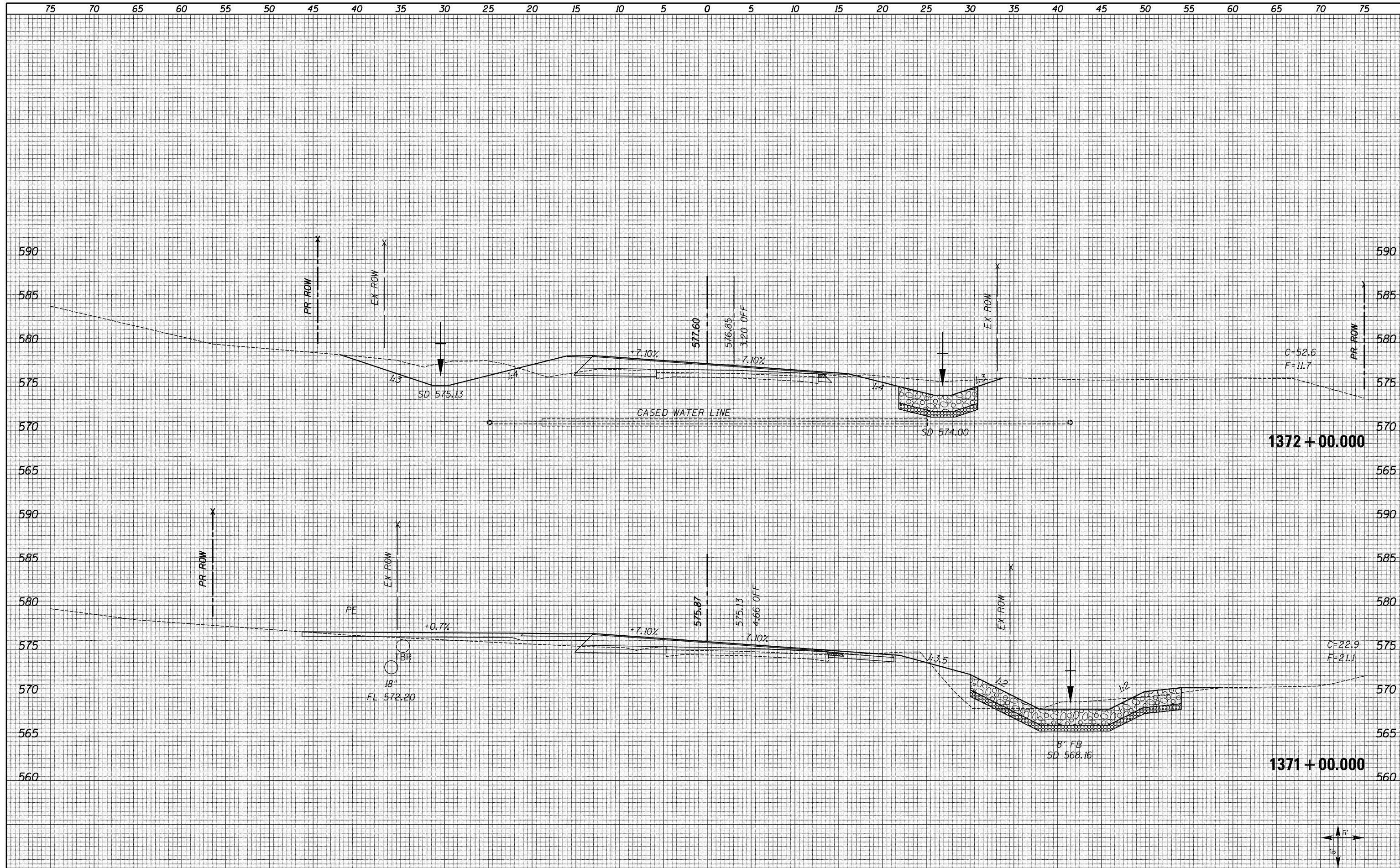

FILE NAME = XS_SHEETS-NEW.dgn	USER NAME = notel	DESIGNED -	REVISD -	<b>STATE OF ILLINOIS DEPARTMENT OF TRANSPORTATION</b>	<b>FAS 1597 (IL 96) CROSS SECTIONS</b>		F.A.S. RTE. 1597	SECTION 14 (W, RS-7)	COUNTY ADAMS/PIKE	TOTAL SHEETS 152	SHEET NO. 112	
	PLOT SCALE = 10.0000' / in.	CHECKED -	REVISD -		SCALE: SHOWN	SHEET NO. 37 OF 72 SHEETS	STA. 1371+00.000	STA. 1372+00.000	CONTRACT NO. 72781			
	PLOT DATE = 8/16/2013	DATE -	REVISD -		ILLINOIS FED. AID PROJECT							
<div style="display: flex; justify-content: space-between;"> <span>1372+00.000</span> <span>1371+00.000</span> </div>												