

DATE	
BY	
FINAL SURVEY	SURVEYED
NOTE BOOK	PLOTTED
NO.	TEMPLATE
	AREAS
	CHECKED

DATE	
BY	
ORIGINAL SURVEY	SURVEYED
NOTE BOOK	PLOTTED
NO.	TEMPLATE
	AREAS
	CHECKED

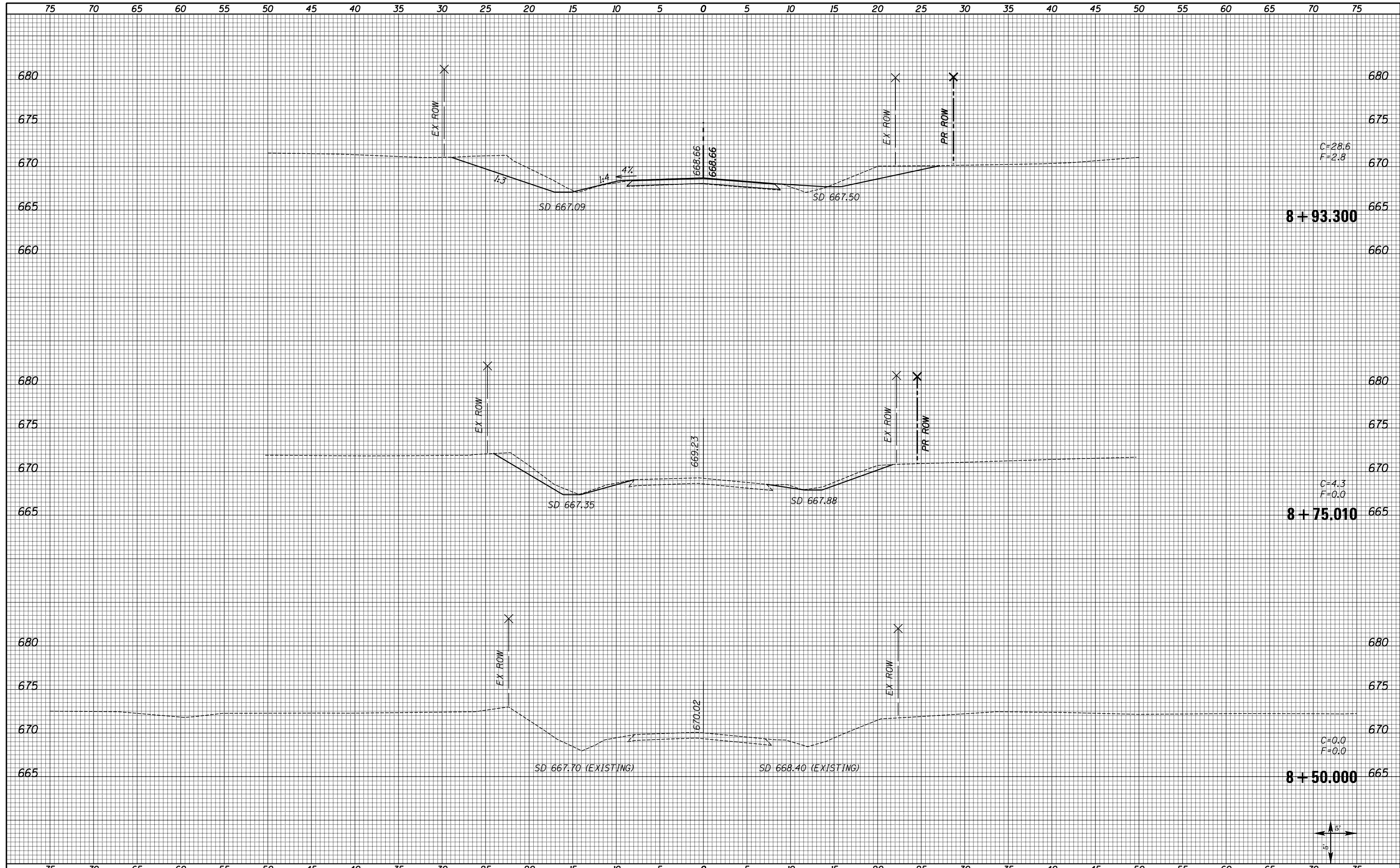

C=28.6  
F=2.8

**8+93.300**

C=4.3  
F=0.0

**8+75.010**

C=0.0  
F=0.0

**8+50.000**



FILE NAME = XS_SHEETS SIDE 0003.dgn	USER NAME = notel	DESIGNED -	REVISÉ -	<b>STATE OF ILLINOIS DEPARTMENT OF TRANSPORTATION</b>	<b>TR 95 (0003 N) CROSS SECTIONS</b>		F.A.S. RTE. 1597	SECTION 14 (W, RS-7)	COUNTY ADAMS/PIKE	TOTAL SHEETS 152	SHEET NO. 151	
	PLOT SCALE = 10.0000' / in.	CHECKED -	REVISÉ -		SCALE: SHOWN	SHEET NO. 1 OF 2 SHEETS	STA. 8+50.000	STA. 8+93.300	CONTRACT NO. 72781			
	PLOT DATE = 8/16/2013	DATE -	REVISÉ -		ILLINOIS FED. AID PROJECT							