

DATE	
BY	
FINAL SURVEY	
SURVEYED	
PLOTTED	
TEMPLATE	
NOTE BOOK	
AREAS CHECKED	
AREAS CHECKED	

DATE	
BY	
ORIGINAL SURVEY	
SURVEYED	
PLOTTED	
TEMPLATE	
NOTE BOOK	
AREAS CHECKED	
AREAS CHECKED	

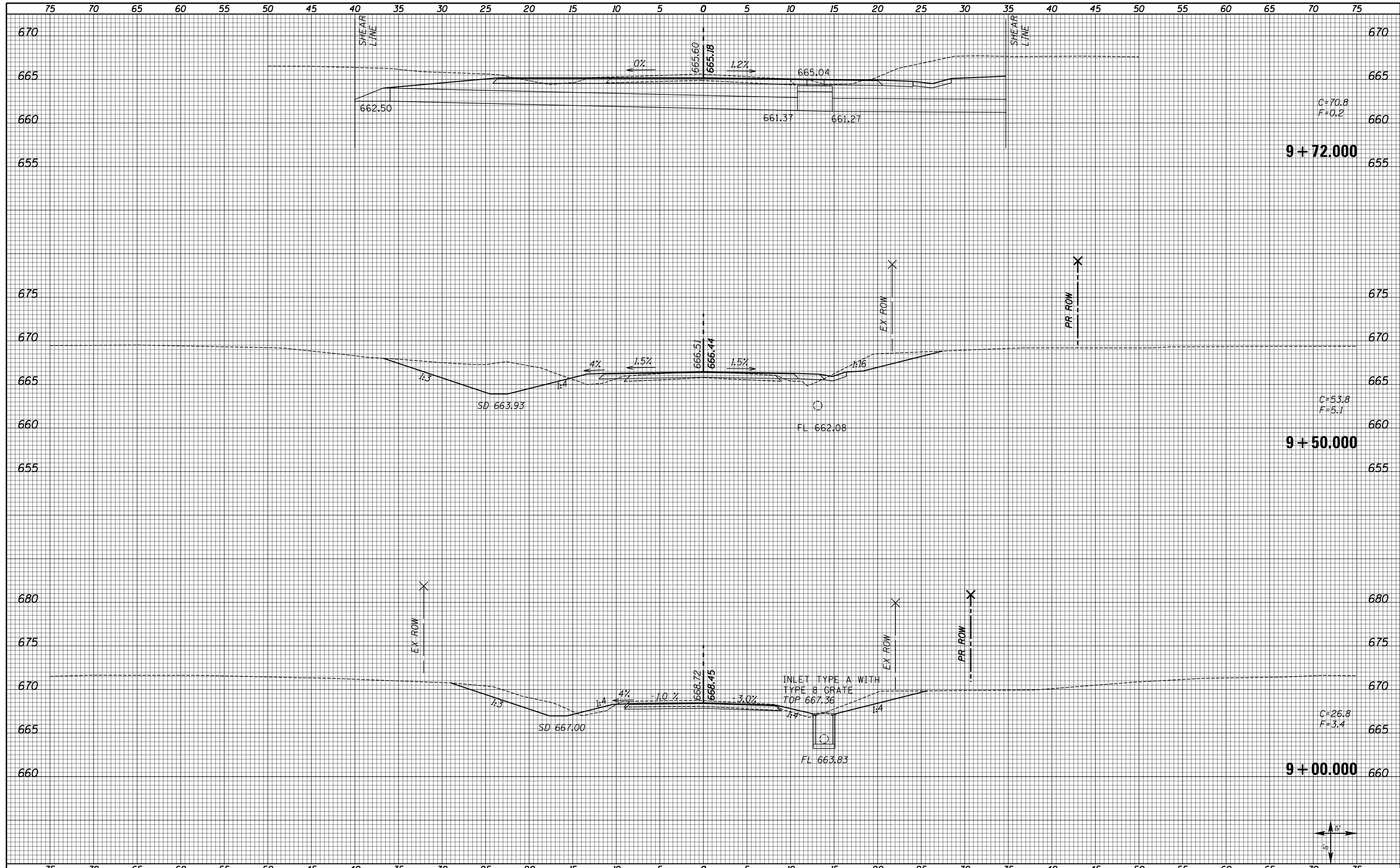

FILE NAME = XS_SHEETS SIDE 0003.dgn	USER NAME = notel	DESIGNED -	REVISD -	<b>STATE OF ILLINOIS DEPARTMENT OF TRANSPORTATION</b>	<b>TR 95 (0003 N) CROSS SECTIONS</b>		F.A.S. RTE. 1597	SECTION 14 (W, RS-7)	COUNTY ADAMS/PIKE	TOTAL SHEETS 152	SHEET NO. 152	
	PLOT SCALE = 10.0000' / 1"	CHECKED -	REVISD -		SCALE: SHOWN	SHEET NO. 2 OF 2 SHEETS	STA. 9+00.000	STA. 9+72.000	CONTRACT NO. 72781			
	PLOT DATE = 8/16/2013	DATE -	REVISD -		ILLINOIS FED. AID PROJECT							