

Notes:
 See sheet 12 of 21 for Sections C-C & D-D and View E-E.
 $a_4(E)$ and $a_5(E)$, and $a_6(E)$ bar spacings measured along \bar{C} Rdwy.
 The joint opening shall be determined per Article 520.04 except that on jointless structures, the distance described as the bridge length between the nearest fixed bearings each way from the joint shall be taken as half the bridge length plus the approach slab length. The minimum dimension shall be $1\frac{1}{2}$ " for installation purposes.

*** Cost included with Concrete Superstructure.

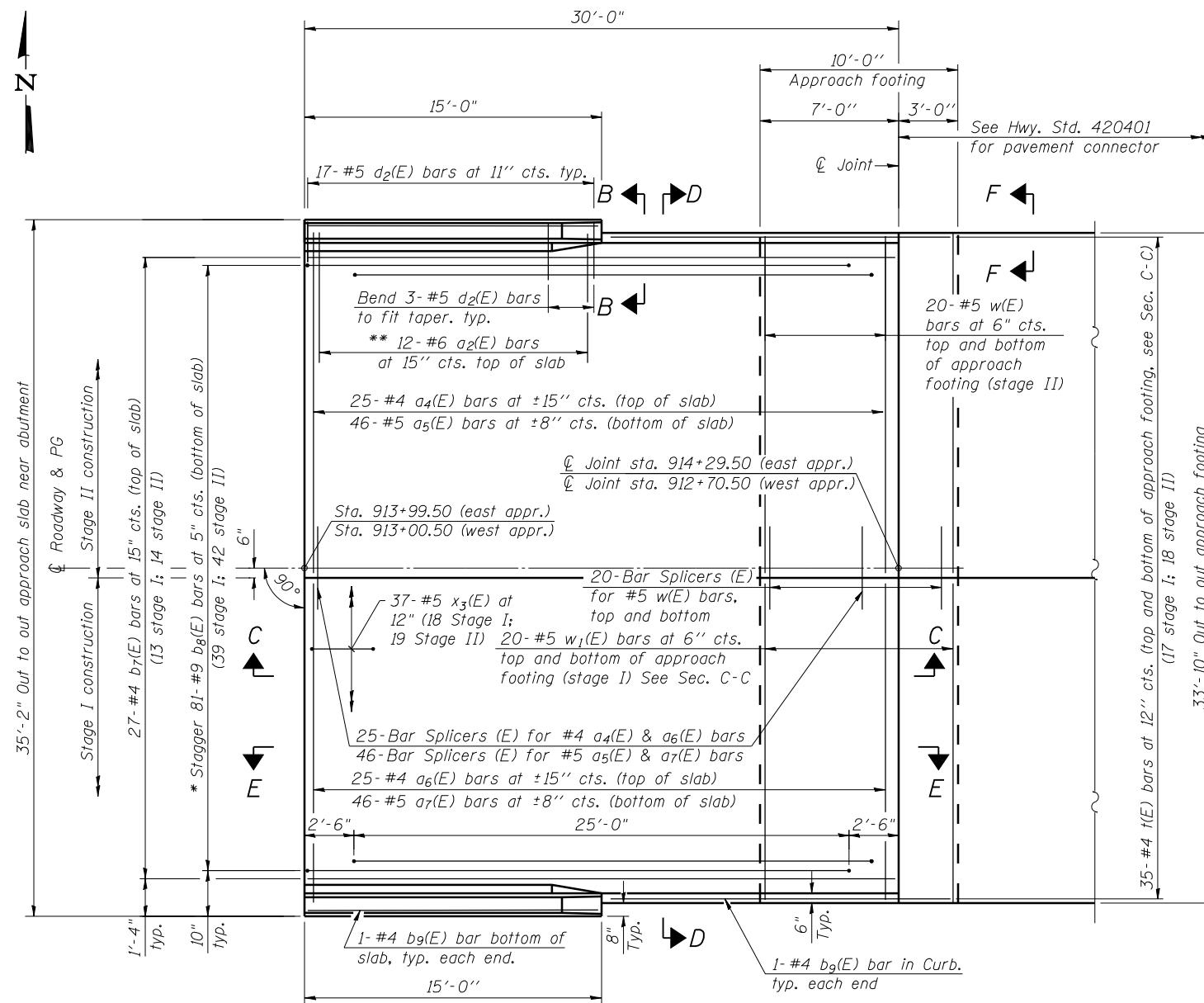

PLAN
 (East approach slab shown; west approach slab similar)

* Tilt #9 $b_8(E)$ bars as required to maintain clearance.
 ** Space between $a_4(E)$ and $a_6(E)$ bars, typ. ea. parapet.

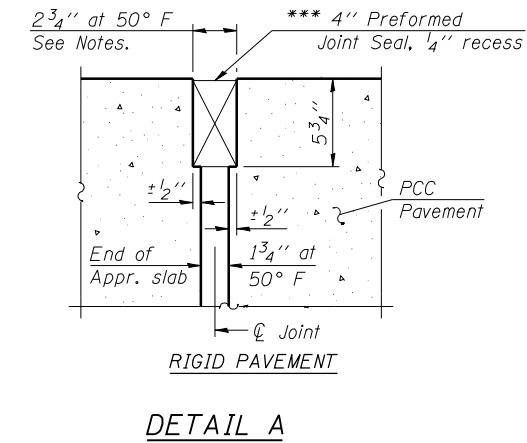

DETAIL A

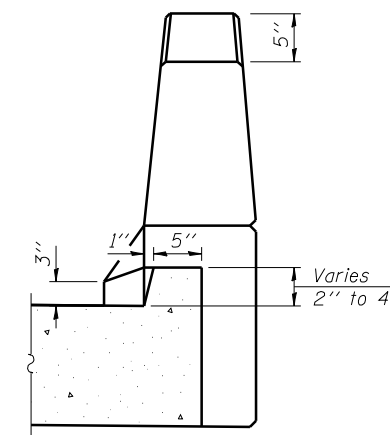
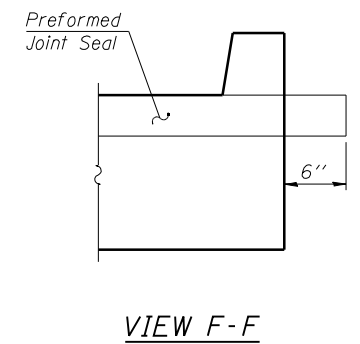
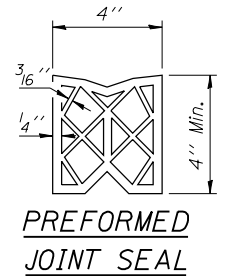

VIEW B-B

(Sheet 1 of 2)

PRINT DRIVER = L:\05-ESCA\PLT
 SCALE NAME = PLOT
 FILE NAME = 8/2/2013-11:38:26 AM



USER NAME = has	DESIGNED - SHL 12/12	REVISED -
ESCA PROJECT NO. 988.12	CHECKED - RDP 03/13	REVISED -
PLOT SCALE = 0/2' = 1/4" IN.	DRAWN - HAS 12/12	REVISED -
PLOT DATE = 8/2/2013 11:38:26 AM	CHECKED - RDP 07/13	REVISED -

**STATE OF ILLINOIS
 DEPARTMENT OF TRANSPORTATION**

**BRIDGE APPROACH SLAB DETAILS
 STRUCTURE NO. 076-0032**

SHEET NO. 11 OF 21 SHEETS

F.A.P. RTE.	SECTION	COUNTY	TOTAL SHEETS	SHEET NO.
885	112B-1	POPE	56	33
CONTRACT NO. 78230				
ILLINOIS FED. AID PROJECT AID				