

STATE OF ILLINOIS  
DEPARTMENT OF TRANSPORTATION

F.A.P. RTE.	SECTION	COUNTY	TOTAL SHEETS	SHEET NO.
726	130CLV-2;41CLV-2	WILLIAMSON	5	1
			ILLINOIS	CONTRACT NO. 78732

FOR INDEX OF SHEETS, SEE SHEET NO. 3  
FOR SUMMARY OF QUANTITIES, SEE SHEET NO. 4  
FOR STRUCTURAL PAVEMENT DESIGN INFORMATION, SEE SHEET NO.

**PROPOSED  
HIGHWAY PLANS**

FAP ROUTE 726 (IL 148) FAP 821 (IL 15)  
SECTION 41CLV-2, 15-2(CLV-1)  
PROJECT NHPP-STP-F54Y(270)  
CULVERT LINING  
WILLIAMSON/JEFFERSON COUNTY

C-99-070-19

**TRAFFIC DATA**

**TOWNSHIPS**

**MARION  
MT VERNON**

DESIGN DESIGNATION : N/A  
COORDINATE SYSTEM : N/A  
POSTED SPEED : 55 MPH

J.U.L.I.E.  
JOINT UTILITY LOCATION INFORMATION FOR EXCAVATION  
1-800-892-0123  
OR 811

PROJECT ENGINEER: VALERIE ROLLA (618)-351-5214  
PROJECT DESIGNER: MICHAELA DOLLINS (618)-351-5215

CONTRACT NO. 78732

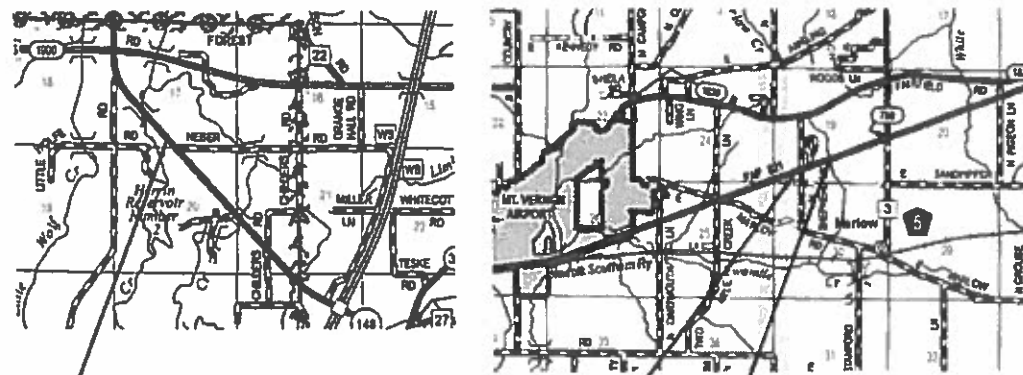

CULVERT LOCATION  
STATION 241+80

CULVERT LOCATION  
STATION 405+30

CULVERT LOCATION  
STATION 266+65

GROSS LENGTH = 500.00 FT. = 0.095 MILES  
NET LENGTH = 500.00 FT. = 0.095 MILES

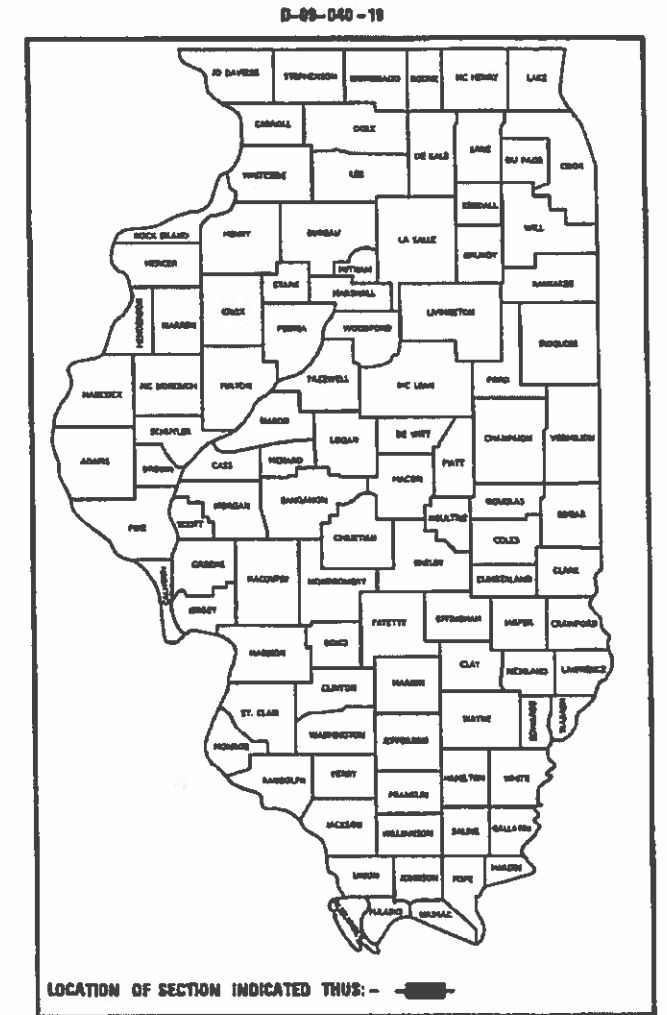

LOCATION OF SECTION INDICATED THUS: -

STATE OF ILLINOIS  
DEPARTMENT OF TRANSPORTATION

SUBMITTED August 13, 2019

Keith Roberts  
REGION FIVE ENGINEER

Oct 4 2019  
S. A. Etk  
ENGINEER OF DESIGN AND ENVIRONMENT

Oct 4 2019  
Paul P. Chaf  
DIRECTOR OF HIGHWAYS PROJECT IMPLEMENTATION

PRINTED BY THE AUTHORITY  
OF THE STATE OF ILLINOIS

MODEL: Default  
FILE NAME: p:\m\johnson.dwg  
C:\Program Files\Autodesk\AutoCAD 2011\acad.dwg  
C:\Program Files\Autodesk\AutoCAD 2011\acad.dwg

Prepared By: Charles Stein  
DISTRICT STUDIES & PLANS ENGINEER

Examined By: Nancy Lee  
DISTRICT LAND ACQUISITION ENGINEER

Examined By: Cam Nelson  
DISTRICT PROGRAM DEVELOPMENT ENGINEER

Examined By: Kel Mely  
DISTRICT OPERATIONS ENGINEER

Examined By: [Signature]  
DISTRICT PROJECT IMPLEMENTATION ENGINEER

Examined By: Douglas J. Sullivan  
DISTRICT CONSTRUCTION ENGINEER

Examined By: [Signature]  
DISTRICT MATERIALS ENGINEER

USER NAME = DOLLINSML	DESIGNED -	REVISED -
	DRAWN -	REVISED -
PLOT SCALE = 100.0000" / in.	CHECKED -	REVISED -
PLOT DATE = 7/15/2019	DATE -	REVISED -

**STATE OF ILLINOIS  
DEPARTMENT OF TRANSPORTATION**

SCALE:	SHEET	OF	SHEETS	STA.	TO	STA.
--------	-------	----	--------	------	----	------

F.A.P. RTE.	SECTION	COUNTY	TOTAL SHEETS	SHEET NO.
726	130CLV-2;41CLV-2	WILLIAMSON	5	2
CONTRACT NO. 78732				
ILLINOIS FED. AID PROJECT				



# SUMMARY OF QUANTITIES

	STP	NHPP
COUNTY:	WILLIAMSON	JEFFERSON
ROUTE:	IL 148	IL 15
FUNDING:	80% FED / 20% STATE	80% FED / 20% STATE
LOCATION:	RURAL	RURAL
TOTAL QUANTITY	ROADWAY 0004	ROADWAY 0004

CODE NUMBER	ITEM DESCRIPTION	UNIT	TOTAL QUANTITY	STP	NHPP
54390330	INSERTION CULVERT LINER 72"	FOOT	276	116	160
54390350	INSERTION CULVERT LINER 84"	FOOT	162		162
67100100	MOBILIZATION	L SUM	1	0.5	0.5
70100450	TRAFFIC CONTROL AND PROTECTION, STANDARD 701201	L SUM	1	0.5	0.5

MODEL: Default  
 FILE NAME: P:\pjancom.dwt\illinois.gov\PWIDOT\Documents\DOT\_Offices\District 9\Projects\7873\CADD\Set\CAD\Sheet\057873-Sheets.dgn

REV. - MS

USER NAME = DOLLINSML PLOT SCALE = 100.0000' / in. PLOT DATE = 8/20/2019	DESIGNED - DRAWN - CHECKED - DATE -	REVISED - REVISED - REVISED + REVISED +	<b>STATE OF ILLINOIS DEPARTMENT OF TRANSPORTATION</b>	SCALE:      SHEET      OF      SHEETS      STA.      TO      STA.	F.A.P. RTE. 726	SECTION 130CLV-2;41CLV-2	COUNTY WILLIAMSON	TOTAL SHEETS 4	SHEET NO. 4
ILLINOIS FED. AID PROJECT      CONTRACT NO. 78732									

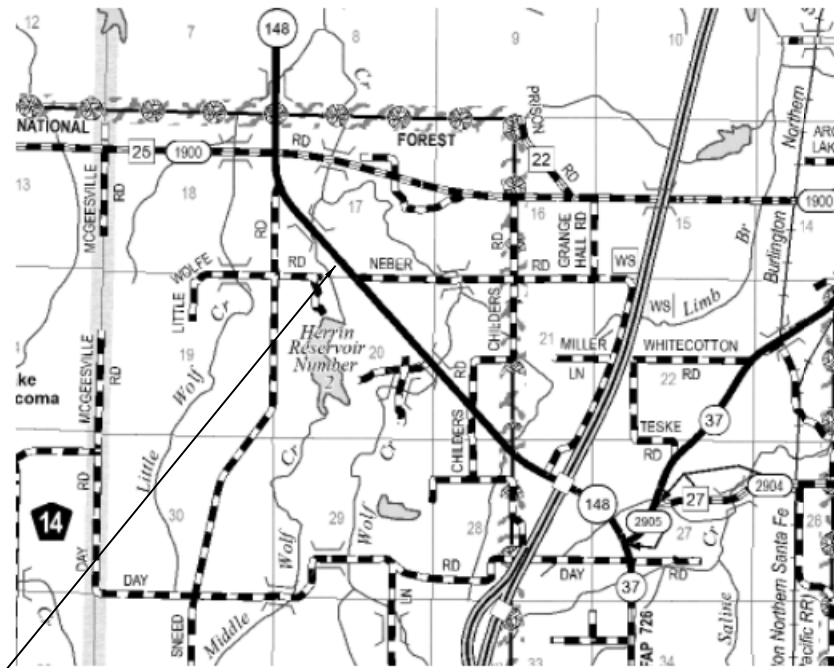

SN 100-7039 IL 148  
 STA. 405+30  
 INSERTION CULVERT LINER 72"

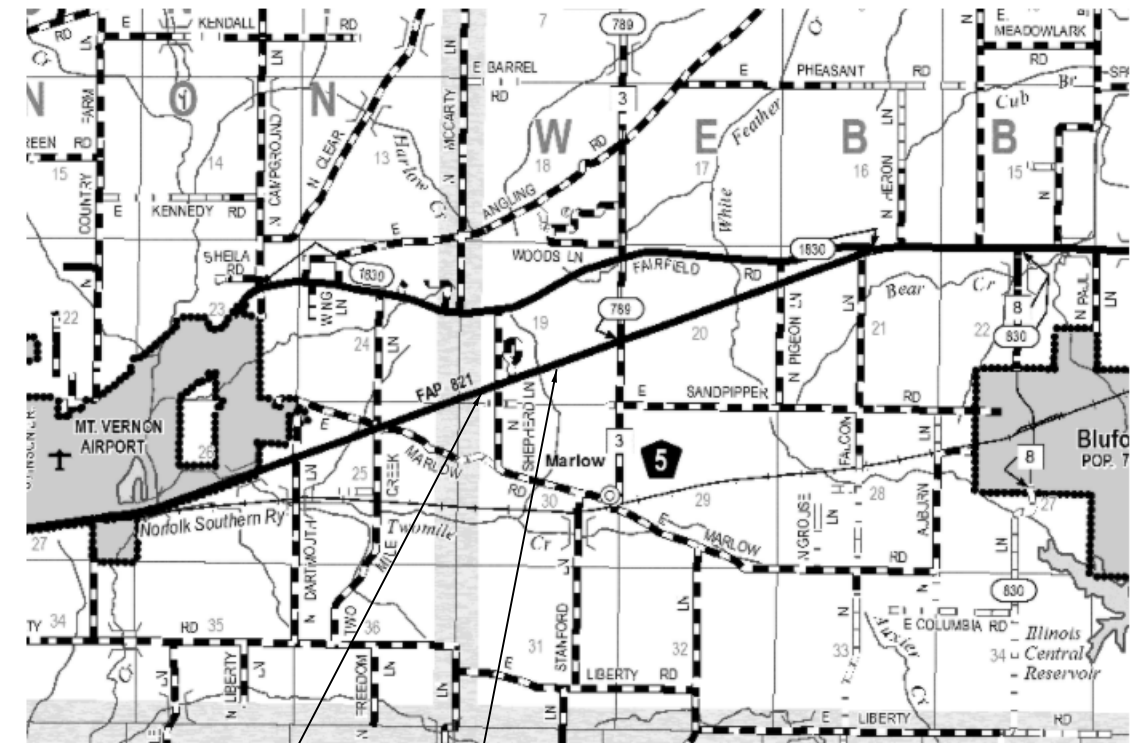

SN 041-7076 IL 15  
 STA. 266+65  
 INSERTION CULVERT LINER 84"

SN 041-7075 IL 15  
 STA. 241+80  
 INSERTION CULVERT LINER 72"

MODEL: Default  
 FILE: \\bluffton.com\data\illinois\pww\DOT\Documents\DOT\_Offices\District\_9\Projects\78732\CADD\data\CADD\Sheets\078732\_Sheets.dgn

USER NAME = DOLLINSML	DESIGNED -	REVISED -
	DRAWN -	REVISED -
PLOT SCALE = 100,0000' / in.	CHECKED -	REVISED -
PLOT DATE = 8/2/2019	DATE -	REVISED -

**STATE OF ILLINOIS  
 DEPARTMENT OF TRANSPORTATION**

SCALE: SHEET OF SHEETS STA. TO STA.

F.A.P. RTE.	SECTION	COUNTY	TOTAL SHEETS	SHEET NO.
726	130CLV-2;41CLV-2	WILLIAMSON	5	5
CONTRACT NO. 78732				
ILLINOIS FED. AID PROJECT				