

**BILL OF MATERIAL
FOUNDATION ONLY *****

Bar	No.	Size	Length	Shape
h ₁₀	20	#5	40'-8"	—
h ₁₁	20	#5	41'-9"	—
n	340	#5	3'-11"	□
s	170	#5	13'-5"	□
t	348	#6	7'-8"	—
t ₁	122	#7	9'-2"	—
t ₂	30	#8	10'-8"	—
t ₃	32	#6	8'-8"	—
t ₄	32	#6	6'-8"	—
w	32	#5	37'-3"	—
w ₁	32	#5	47'-2"	—
w ₂	40	#5	17'-9"	—
w ₃	20	#5	24'-4"	—
w ₄	24	#5	19'-2"	—
w ₅	10	#5	18'-0"	—
w ₆	10	#5	18'-1"	—
w ₇	8	#5	16'-3"	—
w ₈	8	#5	11'-9"	—
w ₉	10	#5	7'-5"	—
Structure Excavation			Cu. Yd.	486
Concrete Structures			Cu. Yd.	199.0
Bar Splicers			Each	52
Reinforcement Bars			Pound	18,610

- Notes:**
- * 1" Initial grout (2:1 sand and Portland cement, very dry mix).
 - ** Varies depending on thickness of leg of Precast Unit.
 - *** Includes Pedestals and footings of the wingwalls and the Three-Sided Structure.

The quantity of Structure Excavation is for the foundations of wingwalls only. The cost of structure excavation for the three-sided structure is included in the pay item "Three-Sided Precast Concrete Structures, 28'x10'".

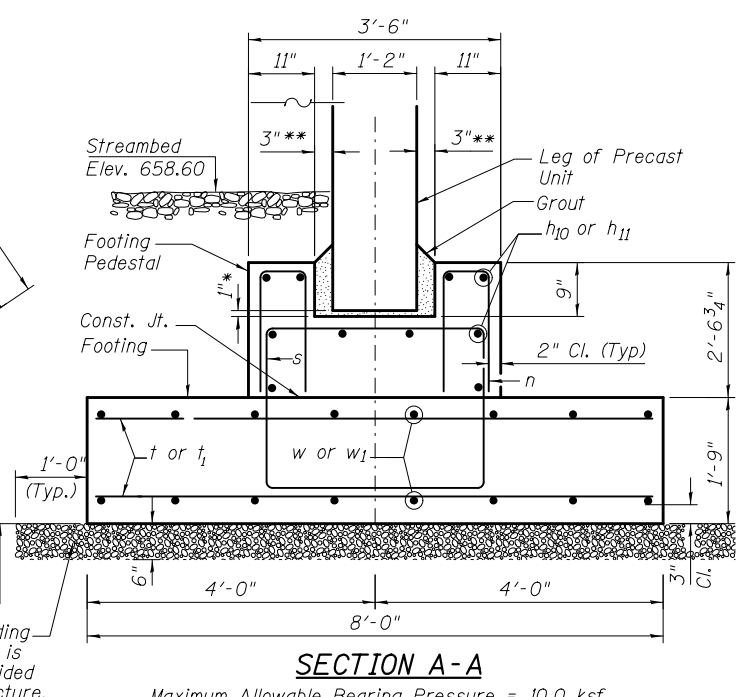
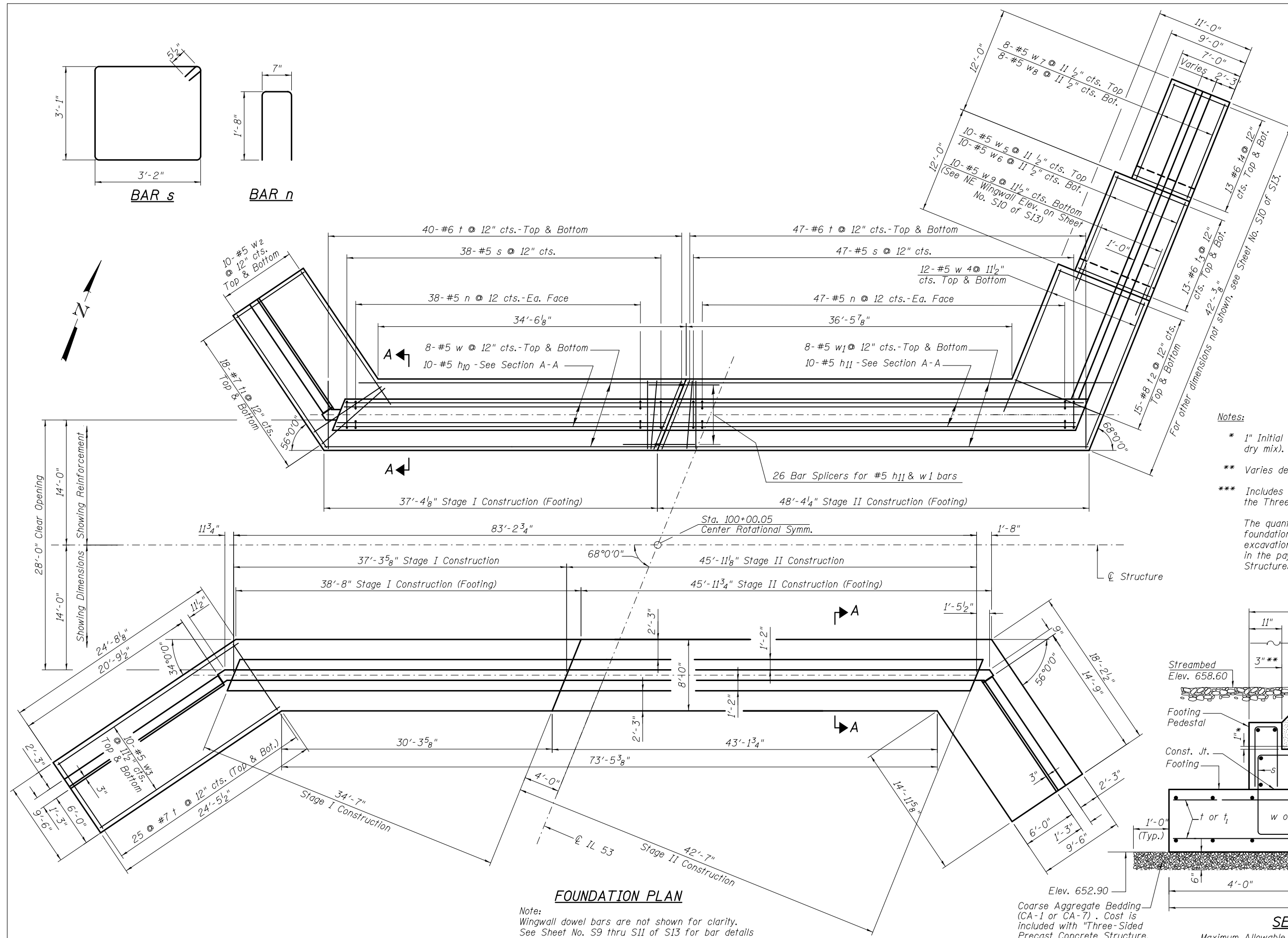

FOUNDATION PLAN

Note:
Wingwall dowel bars are not shown for clarity.
See Sheet No. S9 thru S11 of S13 for bar details



USER NAME =	DESIGNED - JPM	REVISED -
	CHECKED - JXH	REVISED -
PLOT SCALE =	DRAWN - MPS	REVISED -
PLOT DATE =	CHECKED - JPM/JXH/TPG	REVISED -

**STATE OF ILLINOIS
DEPARTMENT OF TRANSPORTATION**

**FOUNDATION PLAN AND DETAILS
STRUCTURE NO. 022-3054 STA. 100 + 00.15**

F.A.P. RTE.	SECTION	COUNTY	TOTAL SHEETS	SHEET NO.
870	534R-B	DUPAGE	53	37
CONTRACT NO. 60M83				
DATE: AUGUST 03, 2012 ILLINOIS FED. AID PROJECT				

SHEET NO. 58 OF S13 SHEETS