

**BILL OF MATERIAL**

**WINGWALLS ONLY**

(Excluding Footings)

Bar	No.	Size	Length	Shape
h (E)	40	#5	14'-5"	—
h <sub>1</sub> (E)	10	#5	14'-10"	—
h <sub>2</sub> (E)	4	#5	15'-8"	—
h <sub>3</sub> (E)	20	#5	20'-6"	—
h <sub>4</sub> (E)	5	#5	21'-3"	—
h <sub>5</sub> (E)	2	#5	21'-4"	—
h <sub>6</sub> (E)	32	#5	13'-0"	—
h <sub>7</sub> (E)	44	#5	14'-6"	—
n <sub>1</sub> (E)	120	#8	8'-8"	⌋
n <sub>2</sub> (E)	32	#9	9'-4"	⌋
n <sub>3</sub> (E)	26	#7	6'-0"	⌋
n <sub>4</sub> (E)	26	#6	4'-5"	⌋
v(E)	30	#6	18'-5"	—
v <sub>1</sub> (E)	21	#6	18'-1"	—
v <sub>2</sub> (E)	18	#6	15'-1"	—
v <sub>3</sub> (E)	32	#7	15'-3"	—
v <sub>4</sub> (E)	26	#6	11'-9"	—
v <sub>5</sub> (E)	26	#6	8'-3"	—
Concrete Structures			Cu. Yd	54.4
Reinforcement Bars, Epoxy Coated			Pound	10,380
Bar Splicer (E)			Each	26

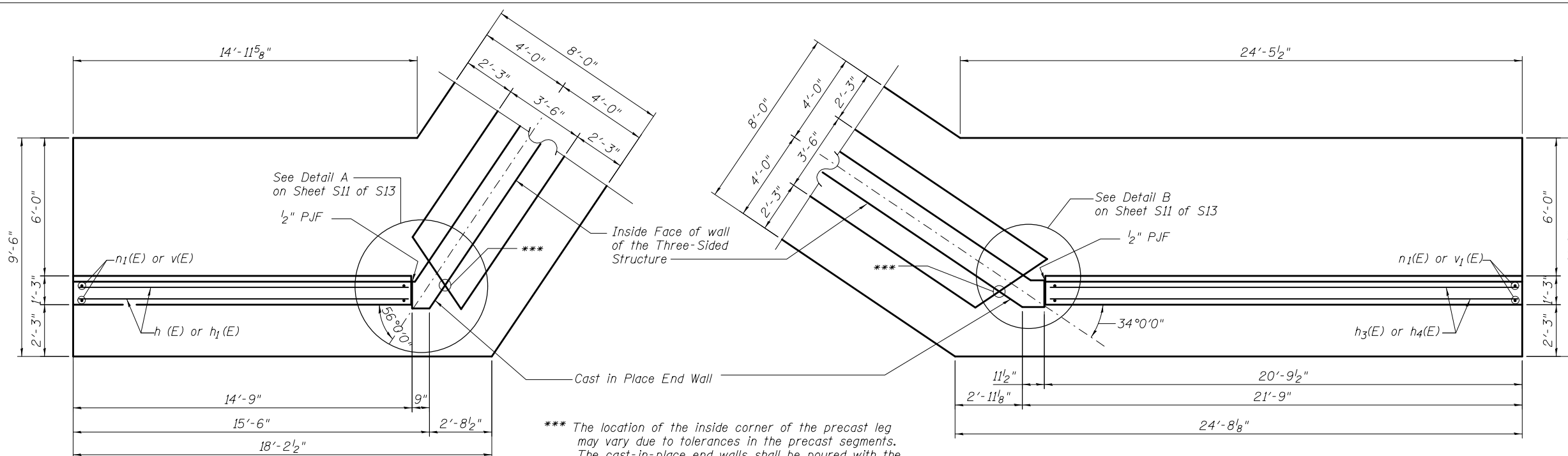

**NW & SE WINGWALL PLAN**

Note: See Foundation Plan on Sheet No. S8 of S13 for reinforcement not shown.

**SW WINGWALL PLAN**

Notes: See Foundation Plan on Sheet No. S8 of S13 for reinforcement not shown. See NE Wingwall Plan on Sheet No. S10 of S13.

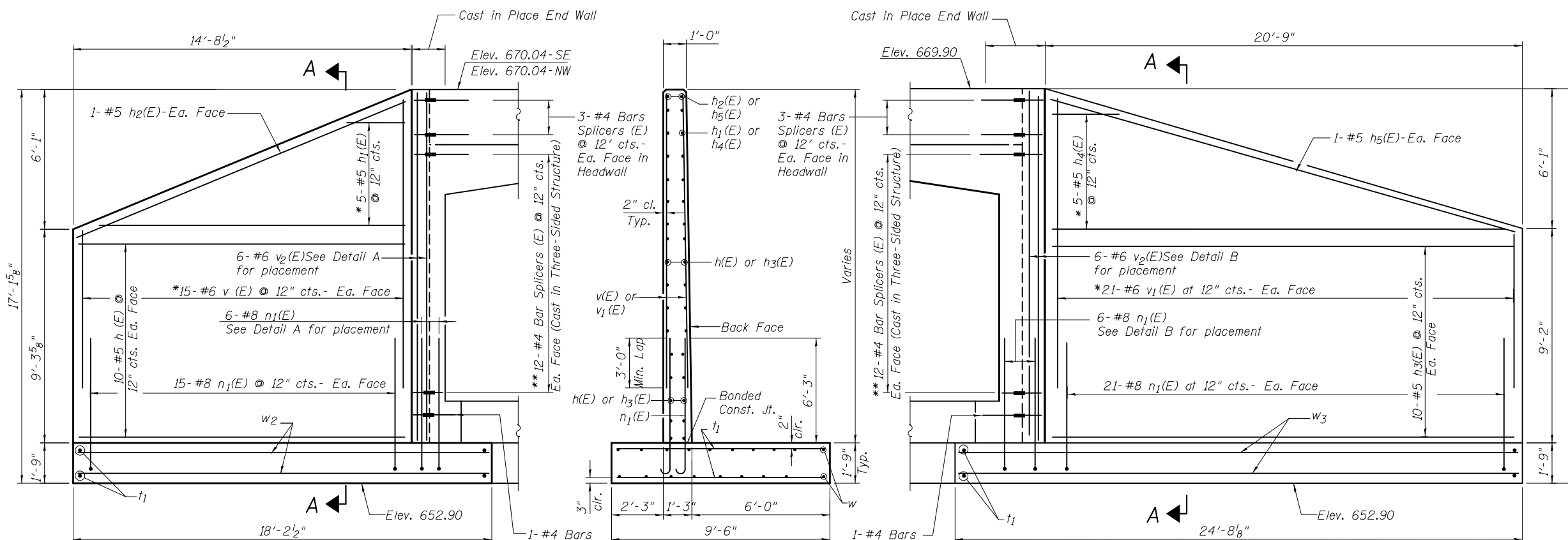

**NW & SE WINGWALL FRONT FACE ELEVATION**

\* Order h<sub>1</sub>(E) and v(E) bars in full length. Cut bars in field and use the remainder in the other face.

**SECTION A-A**

\*\* Cost of Bar Splicers is included in the cost of the Three-Sided Structure.

**SW WINGWALL FRONT FACE ELEVATION**

\* Order h<sub>4</sub>(E) and v<sub>1</sub>(E) bars in full length. Cut bars in field and use the remainder in the other face.



USER NAME =	DESIGNED - JPM	REVISED -
PLOT SCALE =	CHECKED - JXH	REVISED -
PLOT DATE =	DRAWN - MPS	REVISED -
	CHECKED - JPM/JXH/TPG	REVISED -

STATE OF ILLINOIS  
DEPARTMENT OF TRANSPORTATION

WINGWALL PLAN AND DETAILS 1  
STRUCTURE NO. 022-3054 STA. 100 + 00.15

SHEET NO. S9 OF S13 SHEETS

F.A.P. RTE.	SECTION	COUNTY	TOTAL SHEETS	SHEET NO.
870	534R-B	DUPAGE	53	38
CONTRACT NO. 60M83				
DATE: AUGUST 03, 2012 ILLINOIS FED. AID PROJECT				