

* Order $a_{30}(E)$, $a_{31}(E)$ & $a_{32}(E)$ bars full length. Cut to fit skew and use remainder of bars in South end.

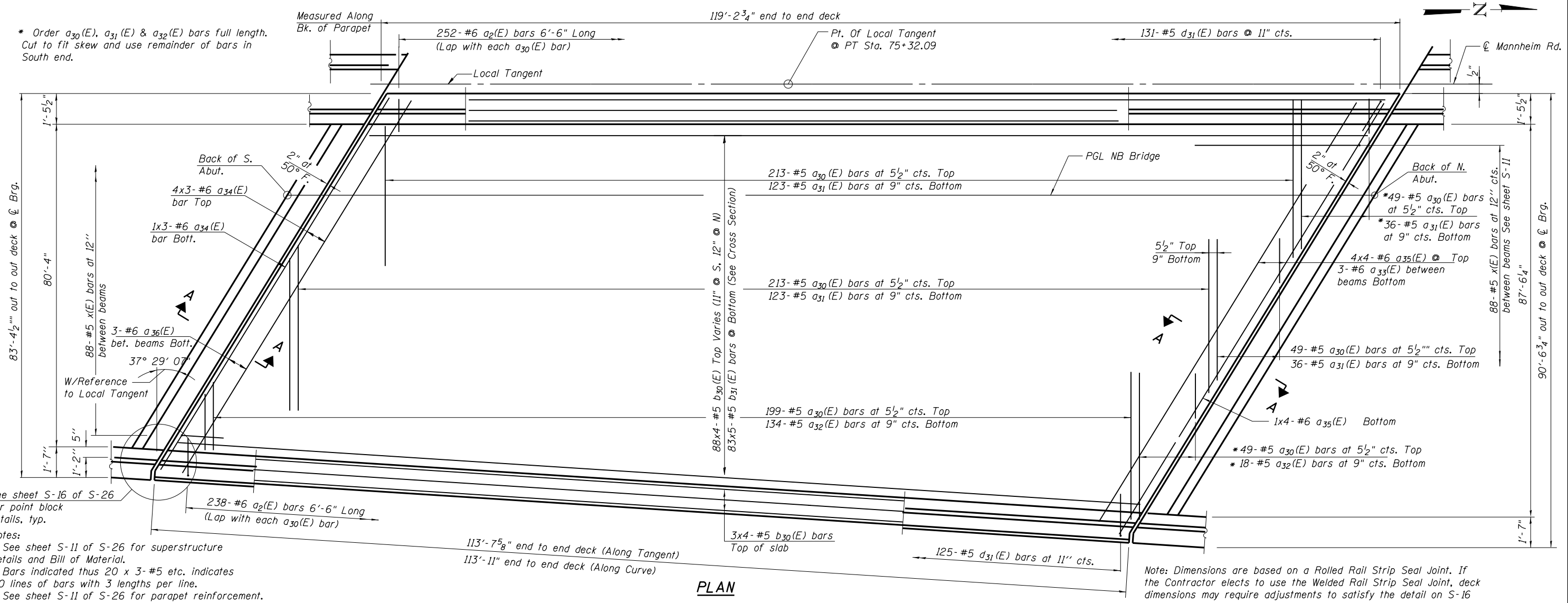

See sheet S-16 of S-26 for point block details, typ.

Notes:
 See sheet S-11 of S-26 for superstructure details and Bill of Material.
 Bars indicated thus 20 x 3-#5 etc. indicates 20 lines of bars with 3 lengths per line.
 See sheet S-11 of S-26 for parapet reinforcement.

Note: Dimensions are based on a Rolled Rail Strip Seal Joint. If the Contractor elects to use the Welded Rail Strip Seal Joint, deck dimensions may require adjustments to satisfy the detail on S-16

PLAN

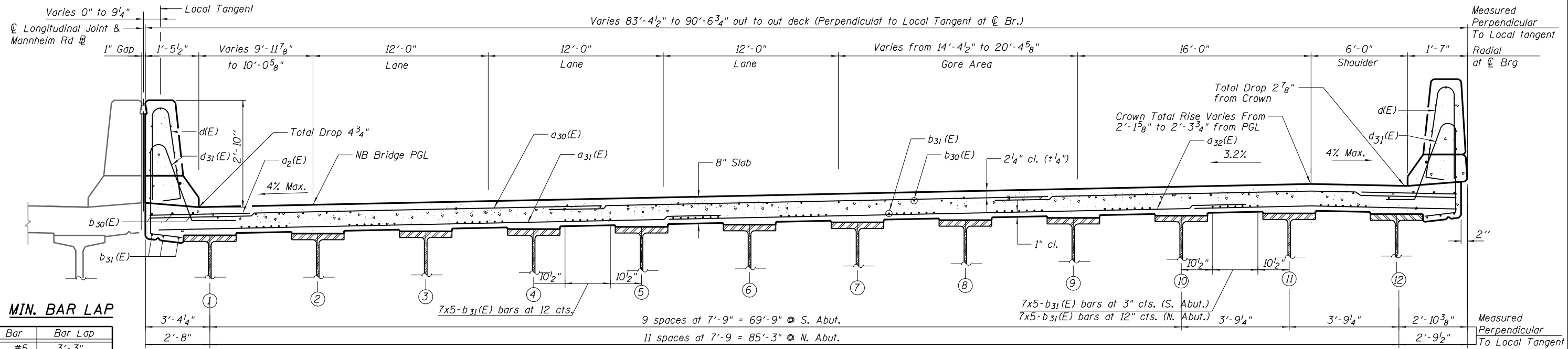

CROSS SECTION
(Looking North)

MIN. BAR LAP

Bar	Bar Lap
#5	3'-3"
#6	3'-10"

THIS SHEET IS FOR INFORMATION ONLY

N:\ROSEMONT\11000\CADD\Sheets\Fabrication_CADD_Sheets\12-0167943-0168037-010-DECK.dgn

CHRISTOPHER B. BURKE ENGINEERING, LTD. 8375 W. Higgins Road, Suite 600 Rosemont, Illinois 60018 (847) 924-8900	USER NAME =	DESIGNED - MM	REVISED	STATE OF ILLINOIS DEPARTMENT OF TRANSPORTATION	SUPERSTRUCTURE PLAN AND CROSS SECTION NB MANNHEIM ROAD BRIDGE - STRUCTURE NO. 016-7943	F.A. RTE. = 330	SECTION = 0105-F	COUNTY = COOK	TOTAL SHEETS = 55	SHEET NO. = 12
	PLOT SCALE =	DRAWN - PDR	REVISED			SHEET NO. S-10 OF S-26 SHEETS	CONTRACT NO. 60V68		ILLINOIS FED. AID PROJECT	
	PLOT DATE =	CHECKED - MM	REVISED							